

Warning :

- Be sure to check all packing material carefully for small parts, which may have come loose inside the carton during shipment.
- To prevent possible scratches and damage, this furniture **MUST BE ASSEMBLED BY TWO PEOPLE** on a soft surface such as a blanket or carpet.

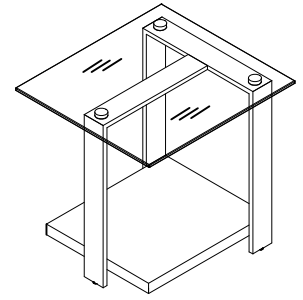

82209
End Table

Components and Hardware List

<p>Glass Top</p> <p>(A) 1 pc.</p>	<p>Side Leg Frame</p> <p>(B) 1 pc.</p>	<p>Middle Leg Frame</p> <p>(C) 1 pc.</p>	<p>Shelf</p> <p>(D) 1 pc.</p>	<p>Allen Head Bolt 1/4" x 20 x 5/8"</p> <p>(E) 3 pcs.</p>	<p>Allen Head Bolt 1/4" x 20 x 1"</p> <p>(F) 3 pcs.</p>	<p>Allen Head Bolt 1/4" x 20 x 1-1/4"</p> <p>(G) 2 pcs.</p>
<p>Spring Washer 1/4" x 12 x 1mm</p> <p>(H) 8 pcs.</p>	<p>Flat Washer 1/4" x 16 x 2mm</p> <p>(I) 8 pcs.</p>	<p>Allen Key 4 mm</p> <p>(K) 1 pc.</p>				

Step 1: Assembly the Leg frame.

Step 2: Move the Shelf.

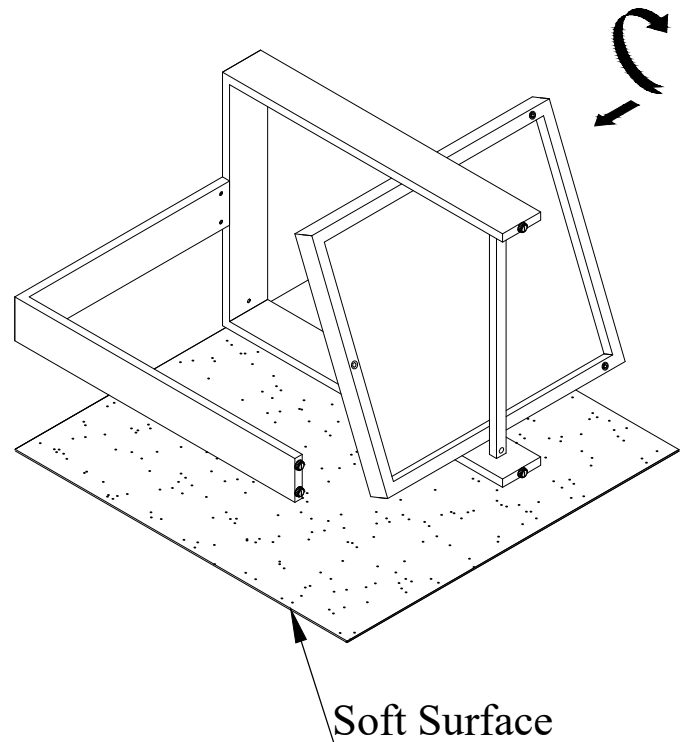
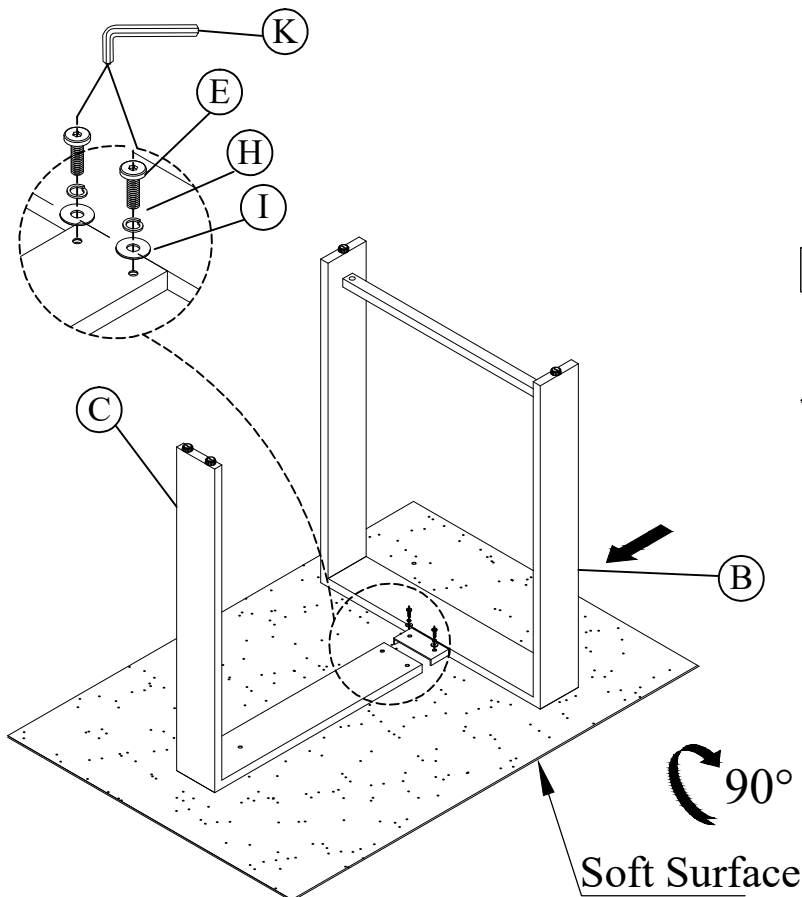

Step 3: Using the Allen key to tighten bolts.

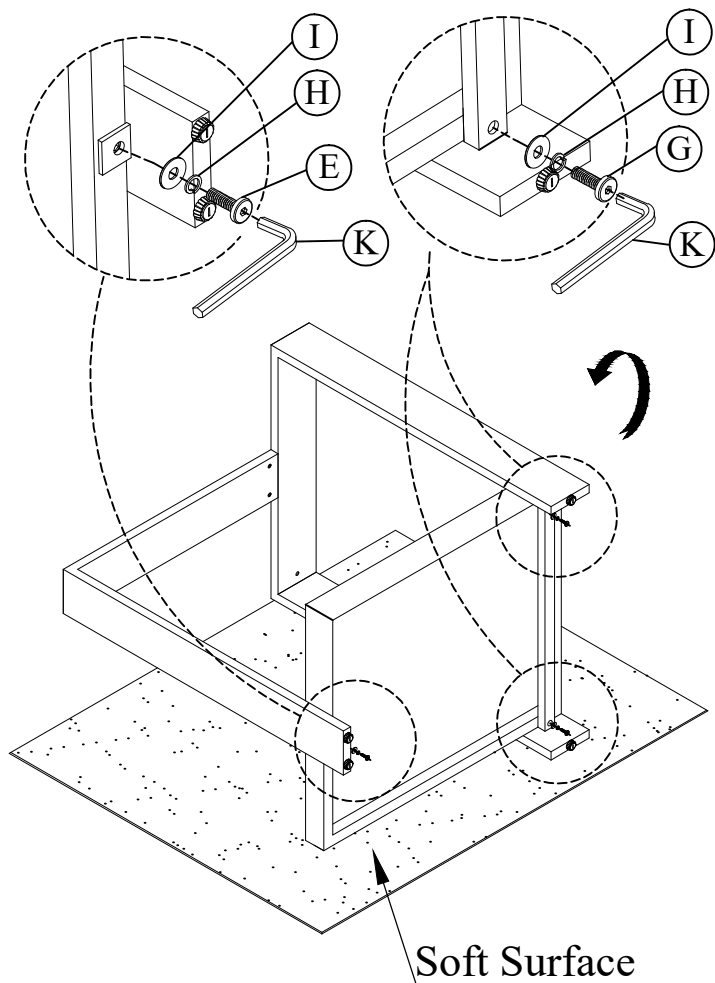

Step 4: Assembly the Glass top.

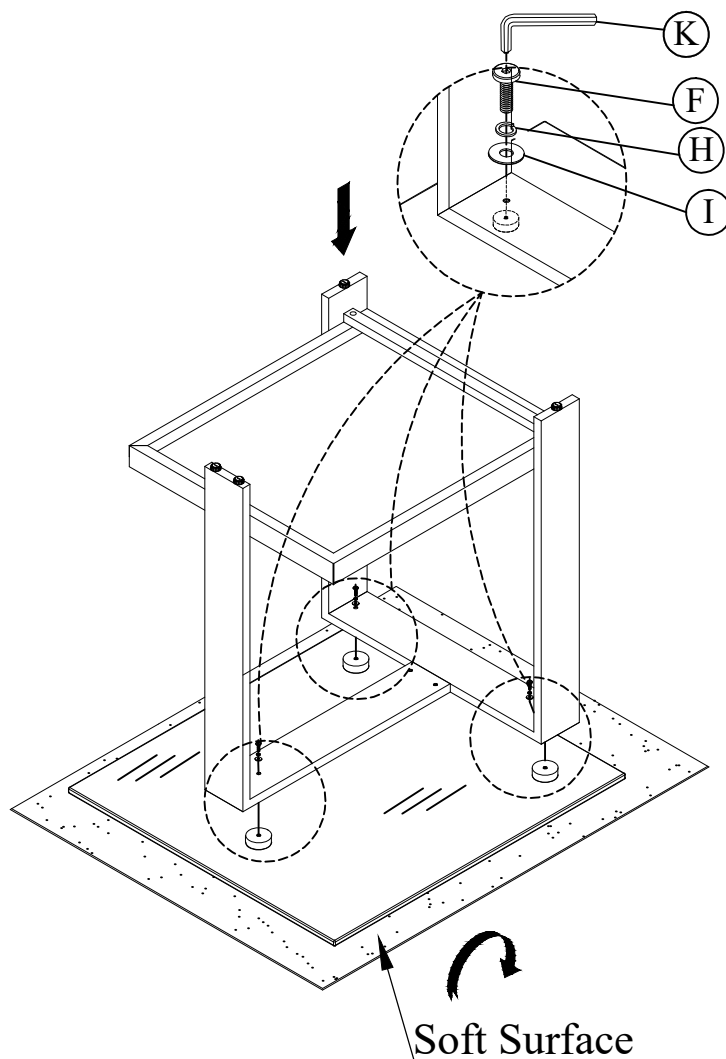

Step 4:

