

Read this instruction carefully. See hardware and furniture part list for guidance. Be sure all parts are complete, before you assemble. Place all wooden furniture parts on a clean and flat soft surface to prevent from being scratched.

Follow the figure to start assembling.

**CAUTIONS :**

1. Do not FULLY - TIGHTEN the nut or nut bolt until all nut or bolt is ready assembled.
2. Do not OVER - TIGHTEN the nut or bolt to avoid causing damages to the thread.
3. Keep all hardware parts out of reach of children.

**NOTE :** THE LIST AND QUANTITY SHOWN ARE FOR 1 UNIT ASSEMBLY.

Tool needed : Screwdriver (not provider).

PART LIST			
ITEM	DESCRIPTION	BOX	QTY
A	BODY	1	1 PC
B	HANDLE	1	2 PCS
C	HANDLE SCREW	1	4 PCS
D	FLAT WASHER	1	4 PCS
E	DRAWER	1	2 PCS

HARDWARE LIST (BOX : -)		
ITEM	DESCRIPTION	QTY
-	-	-

## STEP 1

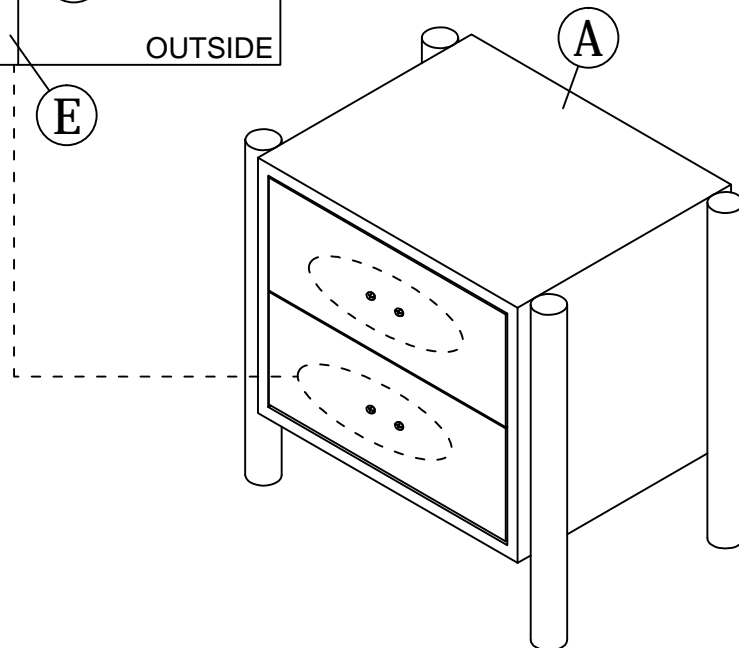
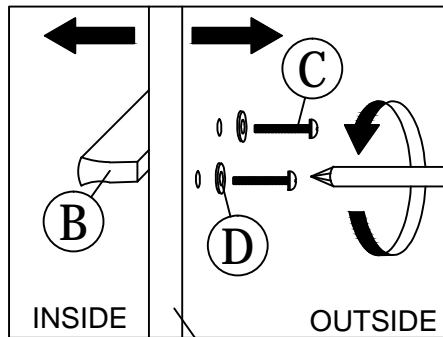

## STEP 2

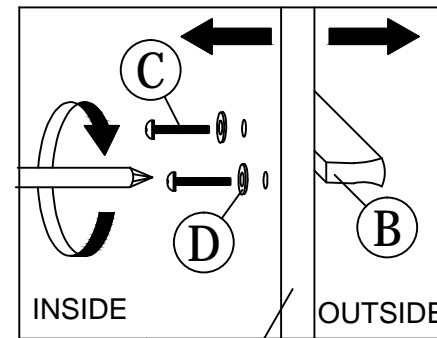

**Note :**  
Hold the handle flat and  
then tighten the screws

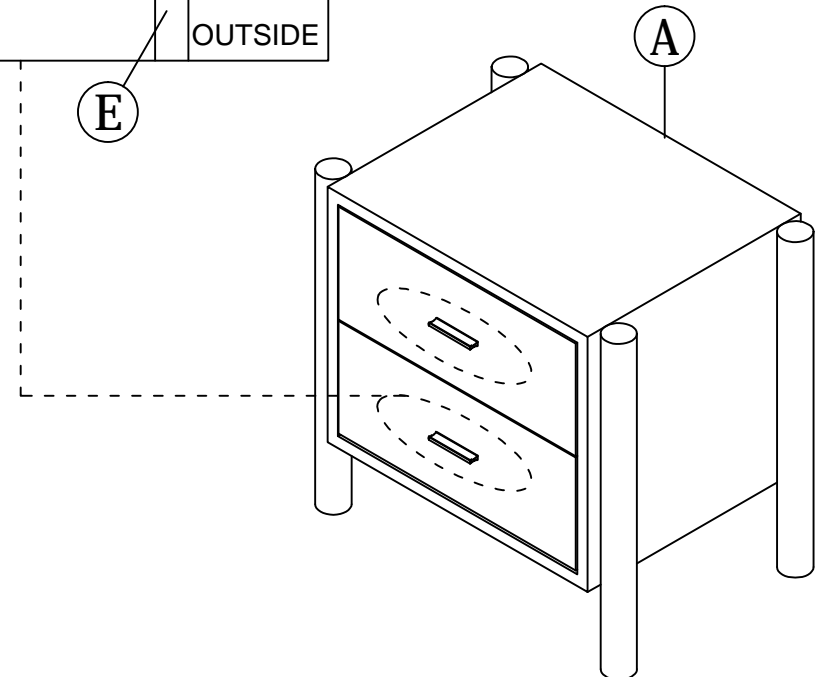

## STEP 3

