

# 5 Leg Bed Frame Assembly

USE WITH MODELS STQG5, DTQG5, DTQRR5, DTQSG5

**NEED HELP?**

1-800-444-8444

warranty@risehome.com

## INCLUDED PARTS

### FOR ALL MODELS

Side Rail Assembly with Cross Arms  
2 pcs

Center Rail  
(not used for Twin)  
1 pcs

End Caps  
2 pcs

Screws

Nuts

### FOR MODELS STQG5, DTQG5

Plastic Glides  
5 pcs

### FOR MODEL DTQRR5

Plastic Sockets  
4 pcs

Rollers  
4 pcs

Plastic Glides  
1 pcs

### FOR MODEL DTQSG5

Plastic Sockets  
4 pcs

Spin Glides  
4 pcs

Plastic Glides  
1 pcs

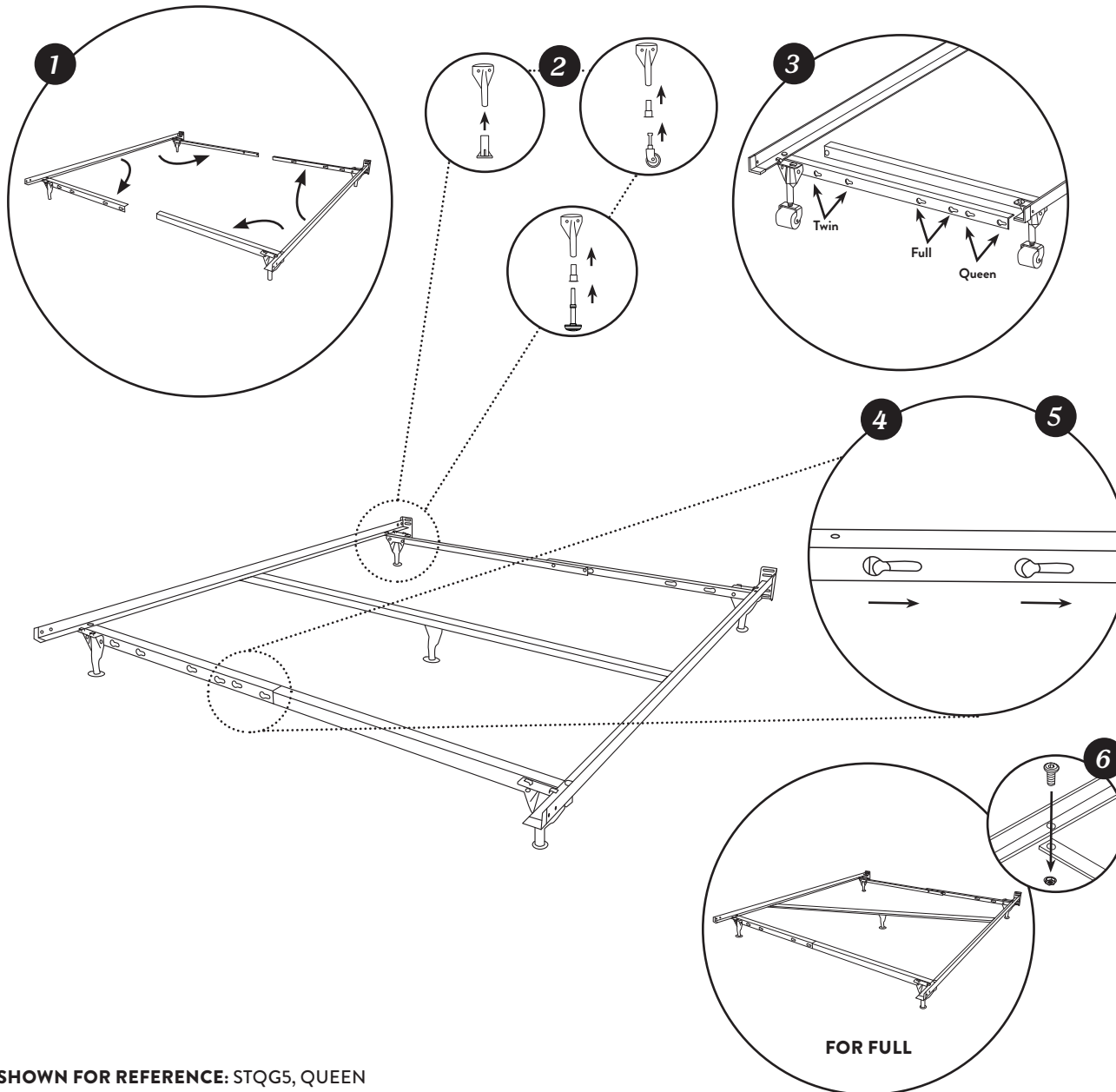

1. Set side rail assemblies out with headboard brackets at the same end. Swing out cross arms from the side rails to a 90° angle.
2. Depending on the model purchased, install glides **OR** rollers with plastic sockets **OR** spin glide with plastic sockets onto the legs, including the leg on the center rail. The locking rollers should be at the foot end
3. Locate the keyholes on the cross arms needed for your appropriate size bed.

### FOR TWIN

4. Inset rivets into key hole slots, then slide to lock in place. Continue to Step #9.

### FOR FULL

5. Insert rivets into key hole slots, then slide to lock in place.
6. Align the center rail's holes with the holes to the right of the middle of the side rail. Center rail should be diagonal. Secure with screws and nuts. Continue to Step #9.

SHOWN FOR REFERENCE: STQG5, QUEEN

REV: 03.28.24

# 5 Leg Bed Frame Assembly

USE WITH MODELS STQG5, DTQRR5, DTQG5

**NEED HELP?**

1-800-444-8444

warranty@risehome.com

## INCLUDED PARTS

### FOR ALL MODELS

Side Rail Assembly with Cross Arms  
2 pcs

Center Rail  
(not used for Twin)  
1 pcs

End Caps  
2 pcs

Screws

Nuts

### FOR MODEL STQG5, DTQG5

Plastic Glides  
5 pcs

### FOR MODEL DTQRR5

Plastic Sockets  
4 pcs

Rollers  
4 pcs

Plastic Glides  
1 pcs

### FOR MODEL DTQSG5

Plastic Sockets  
4 pcs

Spin Glides  
4 pcs

Plastic Glides  
1 pcs

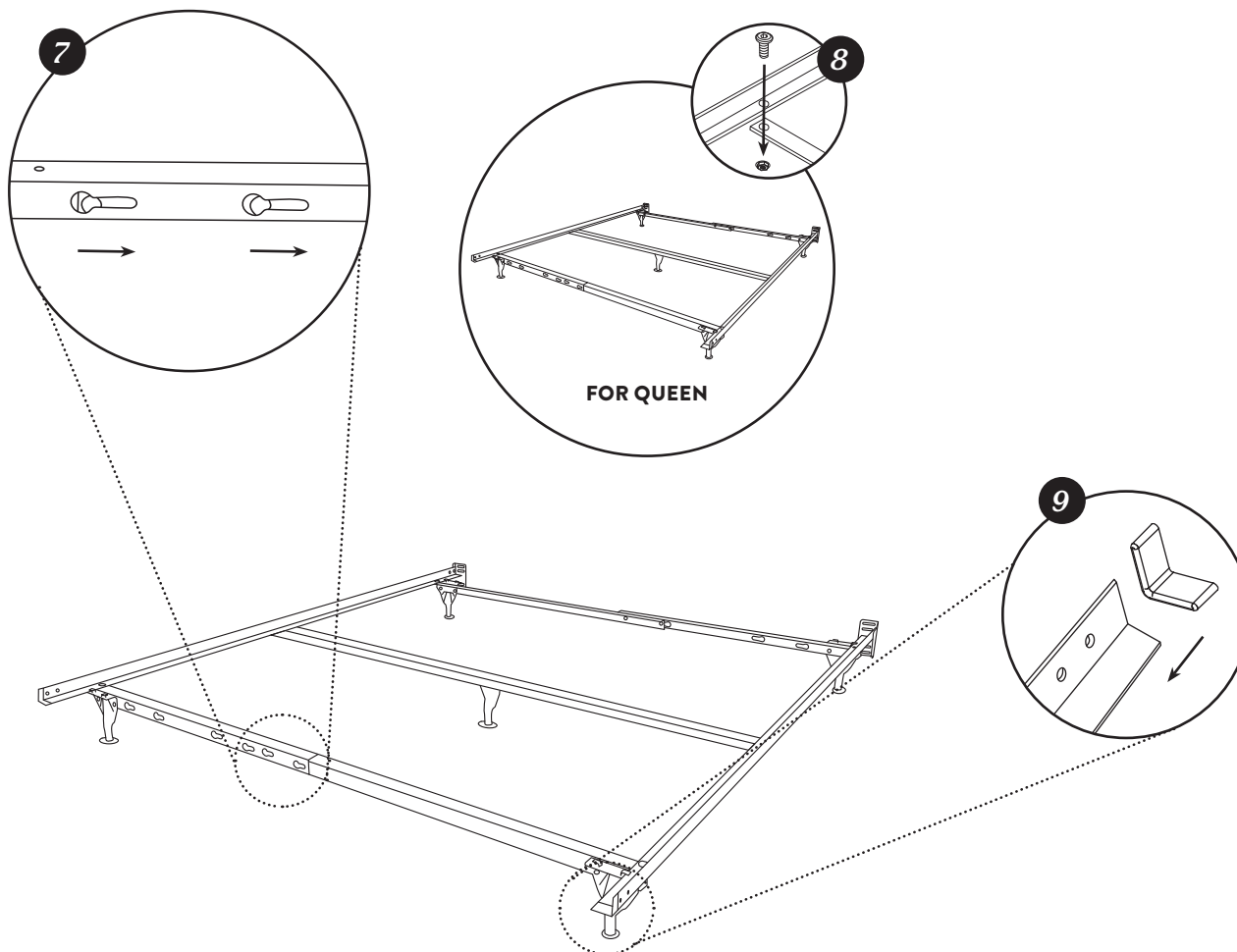

## FOR QUEEN

7. Insert rivets into key hole slots, then slide to lock in place.
8. Align the center rail's holes with the middle of the side rails. Secure with screws and nuts.
9. Slip end caps over the foot ends of the side rails. Your bed frame is now ready to use.

SHOWN FOR REFERENCE: STQG5, QUEEN

REV: 03.28.24