

vtech®

Instruction Manual

# Up & Down Activity Town™



# INTRODUCTION

Thank you for purchasing the **Up & Down Activity Town™**! Drop on by the **Up & Down Activity Town™** and meet some new friends! Hear about colors, letters and music with the push of a button. Open windows or the door, slide moving pieces, sort shapes and shoot some hoops. Get up and get down all over this town!

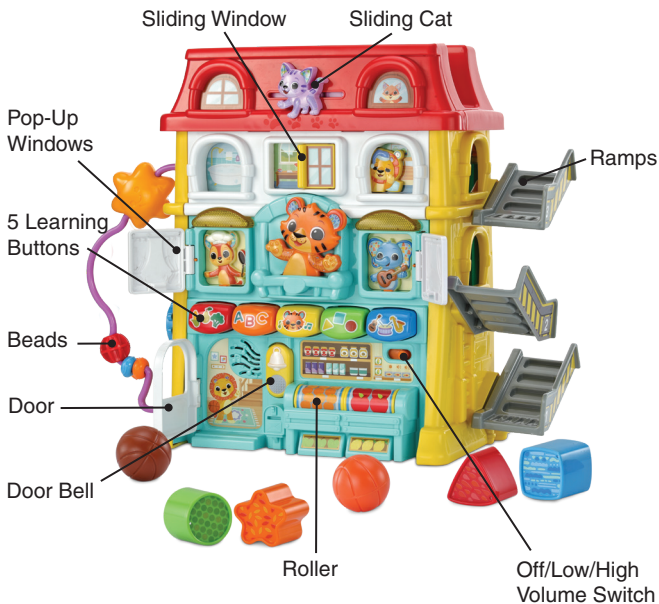

# INCLUDED IN THE PACKAGE

- Up & Down Activity Town™



Electronic Panel



Shape Sorter Panel



Gears Panel



Ramps Panel



Roof



Bottom Panel

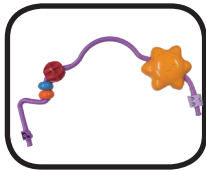

Bead Handle



3 Ramps



2 Balls



4 Shape Blocks



3 Label Sheets

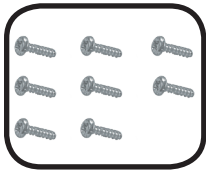

8 Screws

- Quick Start Guide

## **WARNING**

All packing materials such as tape, plastic sheets, packaging locks, removable tags, cable ties, cords and packaging screws are not part of this toy, and should be discarded for your child's safety.

## **NOTE**

Please save this Instruction Manual as it contains important information.

## **ATTENTION**

Pour la sécurité de votre enfant, débarrassez-vous de tous les produits d'emballage tels que rubans adhésifs, feuilles de plastique, attaches, étiquettes, cordons et vis d'emballage. Ils ne font pas partie du jouet.

## **NOTE**

Il est conseillé de sauvegarder ce manuel d'instructions car il comporte des informations importantes.



### **CAUTION:**

Adult assembly required.

This package contains small parts.

For your child's safety, do not let your child play with the toy until it is fully assembled.



### **ATTENTION :**

Ce jouet doit être assemblé par un adulte.

Ce jouet contient des petites pièces.

Pour la sécurité de votre enfant, ne pas le laisser jouer avec le jouet tant que ce dernier n'est pas complètement assemblé par un adulte.

# GETTING STARTED

## Battery Removal and Installation

1. Make sure the unit is turned **Off**.
2. Locate the battery cover on the bottom of the unit, use a screwdriver to loosen the screw and then open the battery cover.
3. Remove the old batteries by pulling up on one end of the batteries.
4. Install 2 new 1.5V AA (LR6) batteries following the diagram inside the battery box (for best performance, alkaline batteries or fully charged Ni-MH rechargeable batteries are recommended).
5. Replace the battery cover and tighten the screw to secure.

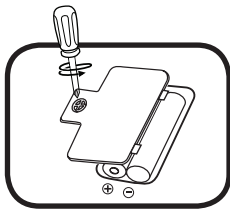

### WARNING:

Adult assembly required for battery installation.  
Keep batteries out of reach of children.



### ATTENTION :

Les piles ou accumulateurs doivent être installés par un adulte.  
Tenir les piles ou accumulateurs hors de portée des enfants.

## IMPORTANT: BATTERY INFORMATION

- Insert batteries with the correct polarity (+ and -).
- Do not mix old and new batteries.
- Do not mix alkaline, standard (carbon-zinc) or rechargeable batteries.
- Only batteries of the same or equivalent type as recommended are to be used.
- Do not short-circuit the supply terminals.
- Remove batteries during long periods of non-use.
- Remove exhausted batteries from the toy.
- Dispose of batteries safely. Do not dispose of batteries in fire.

## **RECHARGEABLE BATTERIES:**

- Rechargeable batteries are only to be charged under adult supervision.
- Do not charge non-rechargeable batteries.

## **IMPORTANT : INFORMATIONS CONCERNANT LES PILES**

- Mettre en place les piles ou les accumulateurs en respectant les polarités + et –.
- Ne pas mélanger des piles ou des accumulateurs neufs avec des usagés.
- Ne pas mélanger différents types de piles : alcalines, zinc-carbone et rechargeables.
- Seules des piles du type recommandé doivent être utilisées.
- Ne pas mettre les bornes d'une pile ou d'un accumulateur en court-circuit (en reliant directement le + et le –).
- Retirer les piles ou les accumulateurs en cas de non-utilisation prolongée.
- Enlever les piles ou les accumulateurs usagés du jouet.
- Ne les jeter ni au feu ni dans la nature.

## **PILES RECHARGEABLES :**

- Les accumulateurs ne doivent être chargés que sous la surveillance d'un adulte.
- Ne pas tenter de recharger des piles non rechargeables.

# ASSEMBLY INSTRUCTIONS

With the VTech® Up & Down Activity Town™, safety comes first. To ensure your child's safety, adult assembly is required. For your child's safety, do not let your child play with the toy until it is fully assembled.

1. Place the **Gears Panel** on the left side of the **Electronic Panel**. Press down until you hear the **Gears Panel** click into place.

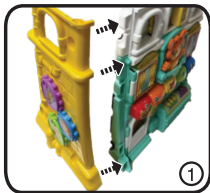

2. Turn the unit and place the **Shape Sorter Panel** on the right side of the **Gears Panel**. Press down until you hear the **Shape Sorter Panel** click into place.

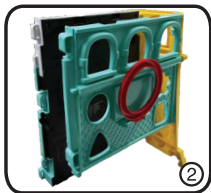
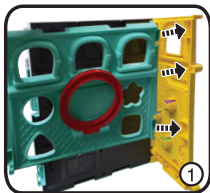

3. Place the **Ramps Panel** between the **Electronic Panel** and the **Shape Sorter Panel**. Press down until you hear the **Ramps Panel** click into place.

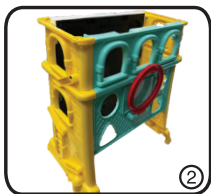
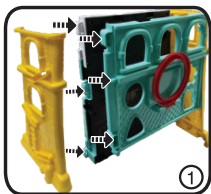

4. Turn the unit upside down. Align the **Bottom Panel** with the six slots on the underside of the unit. Press down firmly until the **Bottom Panel** clicks into place. Secure the **Bottom Panel** with four screws.

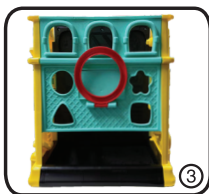
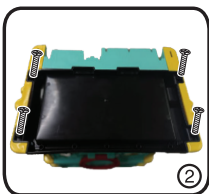
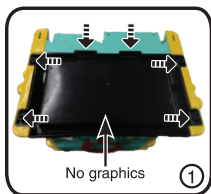

5. Turn the unit upright. Place the **Roof** on top of the assembled unit. Align the screw holes. Secure the **Roof** with four screws.

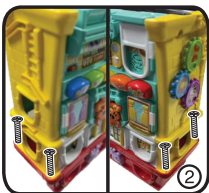

6. The bottom of each **Ramp** is labeled 1, 2, or 3. Match each ramp to the groove with the same number. Press down until the **Ramp** clicks into place.

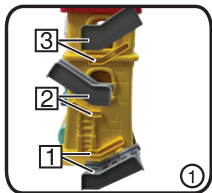

7. Insert the **Bead Handle** into the **Gears Panel**. Press down until you hear the **Bead Handle** click into place.

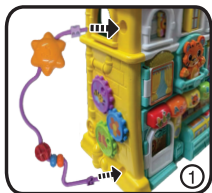

## LABEL APPLICATION

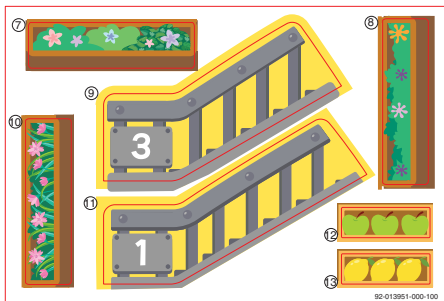
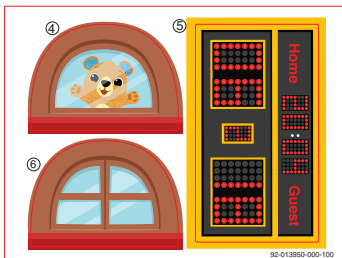
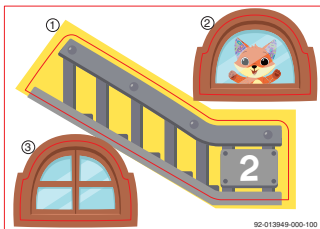

Firmly apply the labels to the panels as shown below.

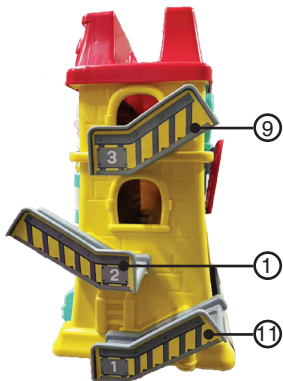



# PRODUCT FEATURES

## 1. Off/Low/High Volume Switch

To turn the unit On, slide the **Off/Low/High Volume Switch** to the **Low Volume** (  ) or **High Volume** (  ) position. You will hear sounds, phrases and a song. To turn the unit Off, slide the **Off/Low/High Volume Switch** to the **Off** (  ) position.



## 2. Automatic Shut-Off

To preserve battery life, the **Up & Down Activity Town™** will automatically power down after approximately 50 seconds of inactivity. Press any button to turn the unit back on.

## NOTE

If the unit powers down or if the light fades out during play, please install a new set of batteries.

# ACTIVITIES

## 1. 5 Learning Buttons

Press the **5 Learning Buttons** to explore letters, colors, animals, shapes, and hear melodies and sounds. The lights will flash along with the sounds.



## 2. Sliding Window

Slide the window left or right to reveal the peek-a-boo **Lion** and hear fun phrases. The lights flash along with the sounds.



## 3. Pop-Up Windows

Press the **Red Button** to open the left **Pop-Up Window**, or the **Blue Button** to open the right **Pop-Up Window**.



## 4. Door

Open or close the **Door** to interact with the **Lion**. The lights flash along with the sound effects.



## 5. Doorbell and Roller

Press the **Doorbell** or roll the **Roller** to hear fun sounds and phrases. The lights flash along with the sounds.



## 6. Sliding Cat

Slide the **Cat** left and right along the track for simple cause-and-effect play.



## 7. Bead Play

Slide the beads up and down and twist the sun to explore movement.

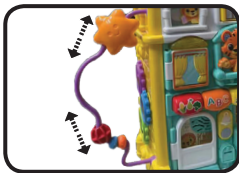

## 8. Basketball Hoop

Lower the hoop for play, then raise it up for storage.



## 9. Shape Sorter

Match and place the four different shapes into the correct openings.



## 10. Ramp Play

Place balls at the top and watch them roll down through all three ramps.



## 11. Storage Area

Shapes and balls can be easily tucked inside the building for quick and tidy storage.



# MELODY LIST

1. Ants Go Marching
2. A-Ticket A-Tasket
3. Bear Went Over the Mountain
4. Entertainer
5. Girls and Boys Come Out to Play
6. Hey Diddle Diddle
7. Hickory Dickory Dock

8. Hot Cross Buns
9. Humpty Dumpty
10. Incy Wincy Spider
11. Little Miss Muffet
12. MacNamara's Band
13. Muffin Man
14. Mulberry Bush
15. One, Two, Buckle My Shoe

## SONG LYRICS

### Song 1

Ding dong, open the door,  
Slide the window, hear the roar!  
Roll the ball, the gears go 'round  
Fun and friends are all around!

### Song 2

A B C D E F G H I J K L M N  
O P Q R S T U V W X Y Z.

### Song 3

Triangle, square, circle too,  
Lots of shapes for me and you!

# CARE & MAINTENANCE

1. Keep the unit clean by wiping it with a slightly damp cloth.
2. Keep the unit out of direct sunlight and away from any direct heat sources.
3. Remove the batteries if the unit will not be in use for an extended period of time.
4. Do not drop the unit on hard surfaces and do not expose the unit to moisture or water.

# TROUBLESHOOTING

If for some reason the unit stops working or malfunctions, please follow these steps:

1. Turn the unit **Off**.
2. Interrupt the power supply by removing the batteries.
3. Let the unit stand for a few minutes, then replace the batteries.
4. Turn the unit **On**. The unit should now be ready to use again.
5. If the unit still does not work, install a new set of batteries.

## **IMPORTANT NOTE:**

If the problem persists, please call our **Consumer Services Department** at **1-800-521-2010** in the U.S. or **1-877-352-8697** in Canada, or by going to our website at **vtechkids.com** and filling out our **Contact Us** form located under the **Customer Support** link. Creating and developing VTech products is accompanied by a responsibility that we take very seriously. We make every effort to ensure the accuracy of the information, which forms the value of our products. However, errors sometimes can occur. It is important for you to know that we stand behind our products and encourage you to contact us with any problems and/or suggestions that you might have. A service representative will be happy to help you.

## **NOTE**

This equipment has been tested and found to comply with the limits for a Class B digital device, pursuant to Part 15 of the FCC Rules. These limits are designed to provide reasonable protection against harmful interference in a residential installation. This equipment generates, uses and can radiate radio frequency energy and, if not installed and used in accordance with the instructions, may cause harmful interference to radio communications. However, there is no guarantee that interference will not occur in a particular installation. If this equipment does cause harmful interference to radio or television reception, which can be determined by turning the equipment off and on, the user is encouraged to try to correct the interference by one or more of the following measures:

- Reorient or relocate the receiving antenna.
- Increase the separation between the equipment and receiver.
- Connect the equipment into an outlet on a circuit different from that to which the receiver is connected.
- Consult the dealer or an experienced radio/TV technician for help.

## **CAUTION**

Changes or modifications not expressly approved by the party responsible for compliance could void the user's authority to operate the equipment.

### **Supplier's Declaration of Conformity**

Trade Name: VTech®  
Model: 5932  
Product name: Up & Down Activity Town™  
Responsible Party: VTech Electronics North America, LLC  
Address: 1156 W. Shure Drive, Suite 200,  
Arlington Heights, IL 60004  
Website: vtechkids.com

THIS DEVICE COMPLIES WITH PART 15 OF THE FCC RULES. OPERATION IS SUBJECT TO THE FOLLOWING TWO CONDITIONS: (1) THIS DEVICE MAY NOT CAUSE HARMFUL INTERFERENCE, AND (2) THIS DEVICE MUST ACCEPT ANY INTERFERENCE RECEIVED, INCLUDING INTERFERENCE THAT MAY CAUSE UNDESIRED OPERATION.  
CAN ICES(B)/NMB(B)

**Visit our website for more  
information about our products,  
downloads, resources and more.**

***vtechkids.com***  
***vtechkids.ca***

Read our complete warranty policy online at  
***vtechkids.com/warranty***  
***vtechkids.ca/warranty***

