

5+

MR BEAST LAB

EXPERIMENT TO CREATE YOUR BEAST!

HYPER FUSION SERIES

MUTATORS

INSTRUCTION MANUAL



SCAN FOR MORE
Parental consent required before going online and viewing online content.

moose

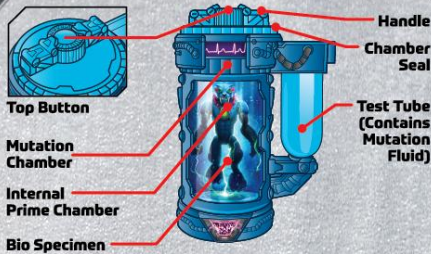

1. UNLOCK CHAMBER!

- Cut all 4 zip ties.

ATTENTION!

- Place Mutation Chamber on flat/level surface and/or a tray.
- Use paper towels or a cloth to catch any spills.

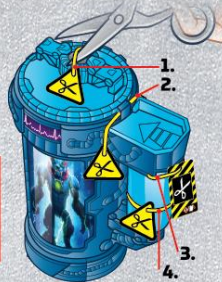

2. REMOVE TEST TUBE



3. REMOVE CAP AND PEEL OPEN TEST TUBE



4. POUR IN THE MUTATION FLUID



5. PUSH TOP BUTTON

- Push Top Button to unlock the Handle.

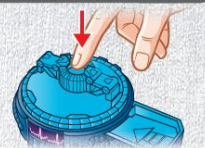

6. ROTATE HANDLE

- Rotate Handle 180 degrees to uncover the Finger Print Scanner Button.



7. PUSH FINGERPRINT SCANNER

- Push down HARD on the Fingerprint Scanner.



8. BEAST MUTATION!

- The Mutation Reaction Fluid transforms the Bio Specimen into your Beast!

*If fluid doesn't become clear, repeat step 7.



RELEASE YOUR BEAST!

9. REMOVE

- Unscrew Chamber Seal.



10. LIFT OFF LID

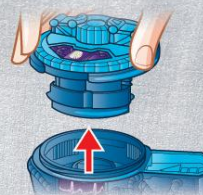

11. LIFT OUT BEAST

- Remove Internal Prime Chamber. Cut the ties.

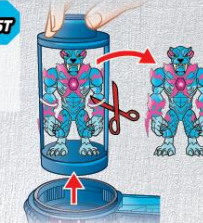

12. CLEAN UP

- Empty liquid down drain.
- Rinse Chamber with soapy water to remove any remaining liquid.
- Wash hands.



- Add Beast back into Mutation Chamber and screw on Lid for future battles.
- Ensure head and limbs are placed completely inside the Internal Prime Chamber.

To catch spills, support base with paper towel or cloth when carrying.

COLLECT THEM ALL!



TROUBLESHOOTING

I cannot remove the Test Tube from the Mutation Chamber. I do not see it inside.
The Top Button is not moving when I push it.
Chamber Seal is not rotating.

• Make sure that zip ties have been removed as shown in step #1.
When I pour the Mutation Fluid into the Mutation Chamber, I do not see it inside.

• Ensure there is nothing blocking the port on the side of the Mutation Chamber.
Nothing happens when I push the Fingerprint Scanner Button.

• Make sure you are pushing down on the Fingerprint Scanner Button hard enough to activate the mutation reaction.
• Try pushing the Fingerprint Scanner Button with 2 or 3 fingers to get more force.

Beast's joints are stiff or not moving easily.
• Your Beast will come with stiffer joints to ensure it lasts a long time and can hold its poses.
• Joints will loosen slightly over time as you play with it and become easier to move.

The Handle is not rotating.

- Make sure Top Button is pushed down to unlock Handle.
- Carefully grip it with one hand while holding the chamber with the other hand and rotate 180°.

How do I get the Beast out of the Mutation Chamber?

- After revealing your Beast, use one hand to hold the chamber in place while carefully rotating the top section counterclockwise with your other hand.
- Remove the top section to allow access to pull out the Internal Prime Chamber and Beast.

After placing the Beast and Internal Prime Chamber back into the Mutation Chamber, the Handle and Chamber Seal do not properly assemble or rotate.

- Make sure the Internal Prime Chamber was inserted correctly into the Mutation Chamber with triangular symbols aligned.

SCAN FOR HOW-TO



PARENTAL CONSENT REQUIRED BEFORE GOING ONLINE AND VIEWING ONLINE CONTENT.

WARNING: KEEP OUT OF REACH OF CHILDREN WHEN NOT IN USE. AVOID CONTACT WITH SKIN OR EYES. WASH HANDS AFTER HANDLING. IN CASE OF ACCIDENTAL EYE CONTACT, FLUSH EYES WITH WATER FOR 10 MINUTES. REMOVE CONTACT LENSES IF PRESENT AND EASY TO DO. IF EYE IRRITATION PERSISTS, GET MEDICAL ADVICE/ATTENTION. CAUTION: USE UNDER PARENTAL SUPERVISION. MUTATION FLUID CONTAINS BITTER TASTE, MAY CAUSE NAUSEA IF CONSUMED, WASH HANDS AFTER USE. IMPORTANT: RETAIN PACKAGING DETAILS FOR FUTURE REFERENCE. COLORS AND CONTENTS MAY VARY. AFTER COMPLETING WATER REVEAL RINSE PARTS WITH CLEAN WATER, WASH HANDS, DISPOSE OF WASTEWATER DOWN DRAIN, WASH CONTAINER WITH SOAPY WATER. RETAIN INSTRUCTIONS FOR FUTURE REFERENCE.

WARNING:

[123 mL (4.16 FL OZ)] MUTATION FLUID [1H1-BCXG-262]-530C-HPHP] CAUSES SERIOUS EYE IRRITATION. CONTAINS ETHOXYLATED C12-16 ALCOHOL, PHENOXYETHANOL, THYMOLPHTHALEIN. (+44 1637 882201)



Replace with FSC Logo Label Title Lumber Grade Do Not Scale



WARNING: CHOKING HAZARD - Small parts. Not for children under 3 years.



moose
www.moosetoys.com
©2024
The Moose Group