



Instruction Manual

4-in-1 Push & Play Vacuum™



INTRODUCTION

Be a cleaning machine with the **4-in-1 Push & Play Vacuum™**. Hear fun songs, learn colors, numbers and counting while you play.



INCLUDED IN THIS PACKAGE

- Vacuum



- Extension Wand



- Brush Roller



- Quick Start Guide

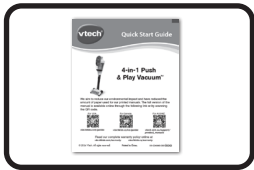

WARNING:

All packing materials such as tape, plastic sheets, packaging locks, removable tags, cable ties, cords and packaging screws are not part of this toy, and should be discarded for your child's safety.

NOTE:

Please save this Instruction Manual as it contains important information.

ATTENTION :

Pour la sécurité de votre enfant, débarrassez-vous de tous les produits d'emballage tels que rubans adhésifs, feuilles de plastique, attaches, étiquettes, cordons et vis d'emballage. Ils ne font pas partie du jouet.

NOTE :

Il est conseillé de sauvegarder ce manuel d'utilisation car il comporte des informations importantes.

UNLOCK THE PACKAGING LOCKS:

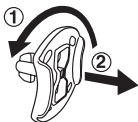

- ① Turn the packaging locks counterclockwise several times.
- ② Pull out and discard the packaging locks.

ACTIVATING NORMAL PLAY MODE

This product is in Try-Me mode in the packaging. To activate normal play mode, remove the packaging lock on the vacuum. You will hear 3 short “beeps”.



GETTING STARTED

Battery Removal and Installation

1. Make sure the unit is turned **OFF**.
2. Find the battery cover located on the back of the vacuum. Use a screwdriver to loosen the screw and then open the battery cover.
3. Remove old batteries by pulling up on one end of each battery.
4. Install 4 new 1.5V AA (LR6) batteries following the diagram inside the battery box. (For best performance, alkaline batteries or fully charged Ni-MH rechargeable batteries are recommended.)
5. Replace the battery cover and tighten the screw to secure.

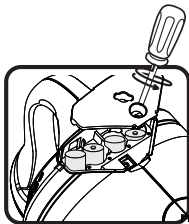



WARNING:

Adult assembly required for battery installation.
Keep batteries out of reach of children.



ATTENTION :

Les piles ou accumulateurs doivent être installés par un adulte.
Tenir les piles ou accumulateurs hors de portée des enfants.

IMPORTANT: BATTERY INFORMATION

- Insert batteries with the correct polarity (+ and -).
- Do not mix old and new batteries.
- Do not mix alkaline, standard (carbon-zinc) or rechargeable batteries.
- Only batteries of the same or equivalent type as recommended are to be used.
- Do not short-circuit the supply terminals.
- Remove batteries during long periods of non-use.
- Remove exhausted batteries from the toy.
- Dispose of batteries safely. Do not dispose of batteries in fire.

RECHARGEABLE BATTERIES:

- Rechargeable batteries are only to be charged under adult supervision.
- Do not charge non-rechargeable batteries.

IMPORTANT : INFORMATIONS CONCERNANT LES PILES

- Mettre en place les piles ou les accumulateurs en respectant les polarités + et -.
- Ne pas mélanger des piles ou des accumulateurs neufs avec des usagés.
- Ne pas mélanger différents types de piles : alcalines, zinc-carbone et rechargeables.

- Seules des piles du type recommandé doivent être utilisées.
- Ne pas mettre les bornes d'une pile ou d'un accumulateur en court-circuit (en reliant directement le + et le -).
- Retirer les piles ou les accumulateurs en cas de non-utilisation prolongée.
- Enlever les piles ou les accumulateurs usagés du jouet.
- Ne les jeter ni au feu ni dans la nature.

PILES RECHARGEABLES :

- Les accumulateurs ne doivent être chargés que sous la surveillance d'un adulte.
- Ne pas tenter de recharger des piles non rechargeables.

MODES

This product allows for 4 modes of play by simply adjusting the configuration of the 3 included pieces.

- Handheld



- Detachable Stick



- Mini Vacuum



- Stick Vacuum



ASSEMBLY INSTRUCTIONS

Note: Adult supervision is recommended for assembly.

1. Slide the **Mode Selector** to the **OFF** position prior to assembly.

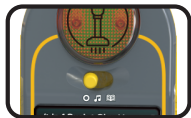

2. Insert the **Extension Wand** into the **Vacuum**. You will hear a “click” when the **Wand** is inserted properly.



3. Insert the other end of the **Extension Wand** into the **Brush Roller**. You will hear a “click” when the **Wand** is inserted properly.



DISASSEMBLY INSTRUCTIONS

1. Press the **Blue Lock** and pull the **Extension Wand** out of the **Vacuum**.

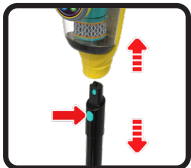

2. Press the **Blue Lock** and then pull the **Extension Wand** out of the **Brush Roller**.

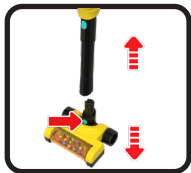

PRODUCT FEATURES

1. On/Off/Mode Selector

Slide the selector to **Vacuum Fun** 🎵 or **Clean & Learn Mode** 📖 to turn the unit **On**. Slide the switch to the left to turn the unit **Off**.



2. Orange Button

Press the **Orange Button** for cleaning role-play fun.

3. 5 Number Buttons

Press to hear colors, numbers, counting and fun vacuum sound effects.

4. Star Button

Press to hear fun songs in **Vacuum Fun Mode** 🎵, or to play games in **Learning Mode** 📖.

5. Light-Up Motor

Press buttons and play to see a vacuum light show.

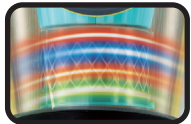

6. Volume Button

Press to raise or lower the volume.

ACTIVITIES

1. Vacuum Fun 🎵

Slide the **On/Off/Mode Selector** to the center for **Vacuum Fun Mode**. Press the **Orange Button** for fun phrases, the **Number Buttons** for cleaning sounds and the **Star Button** to hear songs.



2. Clean & Learn 📖

Slide the **On/Off/Mode Selector** to the right for **Clean & Learn Mode**. Press the **Orange Button** for fun phrases, the **Number Buttons** to learn colors, numbers and counting and the **Star Button** to play learning games.



3. Automatic Shut-Off

To preserve battery life, the **4-in-1 Push & Play Vacuum™** will automatically power-down after several minutes without input.

SONG LYRICS 🎵

Song 1

I'm a vacuum, hear me zoom,
cleaning up around the room.
Back and forth, I clean the floor,
shiny clean from door to door!

Song 2

One, two, count with me,
vacuuming so happily!
Three, four, we clean the floor,
five let's clean some more!

Song 3

Count the numbers, one by one.
Cleaning up is so much fun!
Two and three, come sing along.
Four and five, a tidy song!

Song 4

Red, blue, yellow too,
green and purple, peek-a-boo!
Colors shining, what a view,
I love each and every hue!

Song 5

Red and yellow, blue and green,
purple too, each color seen!
Bright and happy, one by one,
cleaning colors can be fun!

Song 6

Zoom zoom zoom, the dirt is gone.
Vacuum and sing a little song.
Crumbs are gone, the floor looks new.
Cleaning's fun to do with you!

Song 7

Crumbs and dust, we clean away.
Now it's time to clean and play.
Zoom and swoosh, the mess is gone.
Clean and bright, we carry on!

CARE & MAINTENANCE

1. Keep the unit clean by wiping it with a slightly damp cloth.
2. Keep the unit out of direct sunlight and away from any direct heat sources.
3. Remove the batteries if the unit will not be in use for an extended period of time.
4. Do not drop the unit on hard surfaces and do not expose the unit to moisture or water.

TROUBLESHOOTING

If for some reason the unit stops working or malfunctions, please follow these steps:

1. Turn the unit **Off**.
2. Interrupt the power supply by removing the batteries.
3. Let the unit stand for a few minutes, then replace the batteries.
4. Turn the unit **On**. The unit should now be ready to use again.
5. If the unit still does not work, install a new set of batteries.

IMPORTANT NOTE:

If the problem persists, please call our **Consumer Services Department** at **1-800-521-2010** in the U.S. or **1-877-352-8697** in Canada, or by going to our website at **vtechkids.com** and filling out our **Contact Us** form located under the **Customer Support** link. Creating and developing **VTech®** products is accompanied by a responsibility that we take very seriously. We make every effort to ensure the accuracy of the information, which forms the value of our products. However, errors sometimes can occur. It is important for you to know that we stand behind our products and encourage you to contact us with any problems and/or suggestions that you might have. A service representative will be happy to help you.

NOTE

This equipment has been tested and found to comply with the limits for a Class B digital device, pursuant to Part 15 of the FCC Rules. These limits are designed to provide reasonable protection against harmful interference in a residential installation. This equipment generates, uses and can radiate radio frequency energy and, if not installed and used in accordance with the instructions, may cause harmful interference to radio communications. However, there is no guarantee that interference will not occur in a particular installation. If this equipment does cause harmful interference to radio or television reception, which can be determined by turning the equipment off and on, the user is encouraged to try to correct the interference by one or more of the following measures:

- Reorient or relocate the receiving antenna.
- Increase the separation between the equipment and receiver.
- Connect the equipment into an outlet on a circuit different from that to which the receiver is connected.
- Consult the dealer or an experienced radio/TV technician for help.

CAUTION

Changes or modifications not expressly approved by the party responsible for compliance could void the user's authority to operate the equipment.

Supplier's Declaration of Conformity 47 CFR § 2.1077 Compliance Information

Trade Name: VTech®
Model: 5883
Product Name: 4-in-1 Push & Play Vacuum™
Responsible Party: VTech Electronics North America, L.L.C.
Address: 1156 W. Shure Drive, Suite 200
Arlington Heights, IL 60004
Website: vtechkids.com

THIS DEVICE COMPLIES WITH PART 15 OF THE FCC RULES. OPERATION IS SUBJECT TO THE FOLLOWING TWO CONDITIONS: (1) THIS DEVICE MAY NOT CAUSE HARMFUL INTERFERENCE, AND (2) THIS DEVICE MUST ACCEPT ANY INTERFERENCE RECEIVED, INCLUDING INTERFERENCE THAT MAY CAUSE UNDESIRE OPERATION.
CAN ICES(B)/NMB(B)

**Visit our website for more
information about our products,
downloads, resources and more.**

vtechkids.com
vtechkids.ca

Read our complete warranty policy online at
vtechkids.com/warranty
vtechkids.ca/warranty

