

4 Leg Bed Frame Assembly

USE WITH MODEL STFG4, STQG4, DTQG4, DTQRR4, DTQSG4

NEED HELP?

1-800-444-8444

warranty@risehome.com

INCLUDED PARTS

FOR ALL MODELS

Side Rail Assembly With Cross Arms
2 pcs

End Caps
2 pcs

FOR MODELS STFG4, STQG4, DTQG4

Plastic Glides
4 pcs

FOR MODEL DTQRR4

Plastic Sockets
4 pcs

Rollers
4 pcs

FOR MODEL DTQSG4

Plastic Sockets
4 pcs

Spin Glides
4 pcs

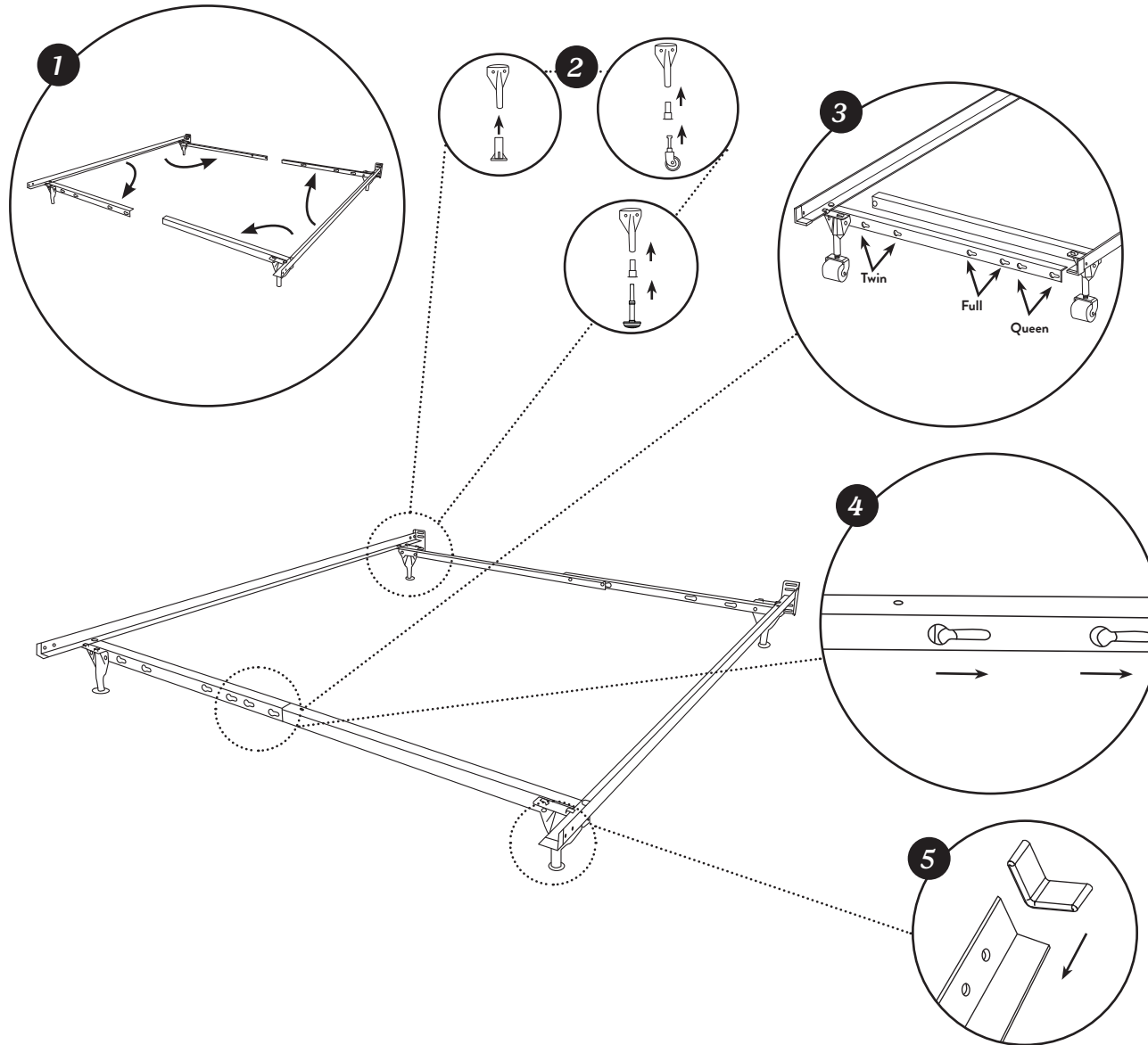

1. Set side rail assemblies out with headboard brackets at the same end. Swing out cross arms from the side rails to a 90° angle.
2. Depending on the model purchased, install glides **OR** rollers with plastic sockets **OR** spin glides with plastic sockets onto the legs. The locking rollers should be at the foot end.
3. Locate the keyholes on the cross arms needed for your appropriate size bedding. Overlap the cross arms and insert rivets on cross arms into the keyholes selected.
4. Slide the cross arms away from each other to lock the position. Repeat steps 3 & 4 at the other end of the bed.
5. Slip end caps over the foot ends of the side rails. Your frame is now ready to use.

SHOWN FOR REFERENCE: STQG4, QUEEN

REV: 01.05.24