



**We love that you are rocking JLab!**  
**We take pride in our products and fully stand behind them.**

JLAB®  
EPIC SPORT  
ANC 3 EARBUDS



#### YOUR WARRANTY

All warranty claims are subject to JLab authorization and at our sole discretion. Retain your proof of purchase to ensure warranty coverage.



#### CONTACT US

Reach out to us at [support@jlab.com](mailto:support@jlab.com) or visit [jlab.com/contact](https://jlab.com/contact)

### REGISTER TODAY

[jlab.com/register](https://jlab.com/register)

[Product updates](#) | [How-to tips](#)  
[FAQs & more](#)

## PAIR UP

- 1** Remove stickers from earbuds and place back in charging case.

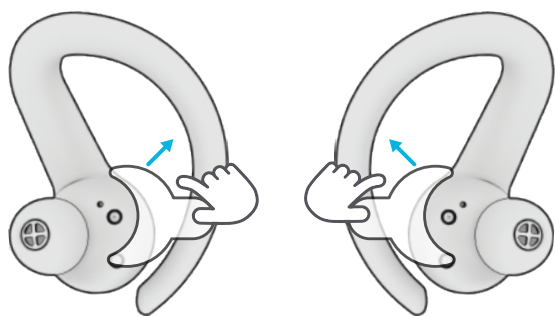

- 2** White light on case indicates charge. Remove earbuds.

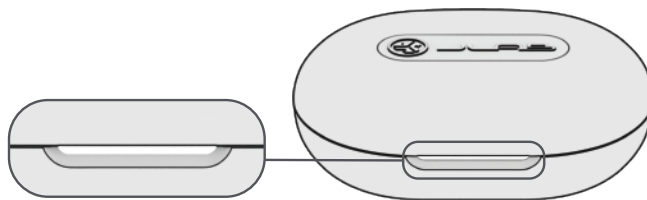

- 3** One earbud blinks blue/white = Ready to Pair  
Connect to JLab Epic Sport ANC 3 in your device settings.

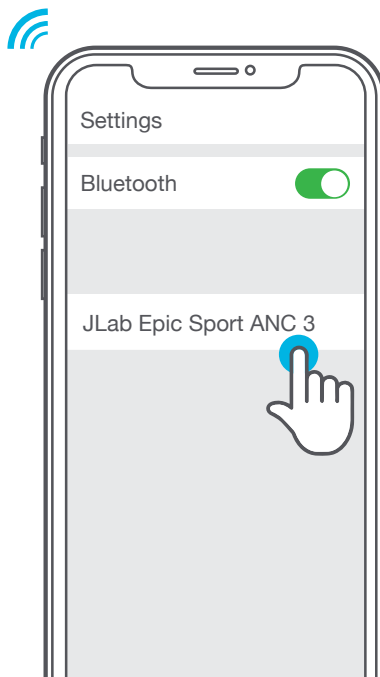

## GO AHEAD, PRESS THE BUTTON

1x ●    2x ●●    3x ●●●    Press Hold ■■■■

### LEFT/RIGHT SYMMETRICAL CONTROLS

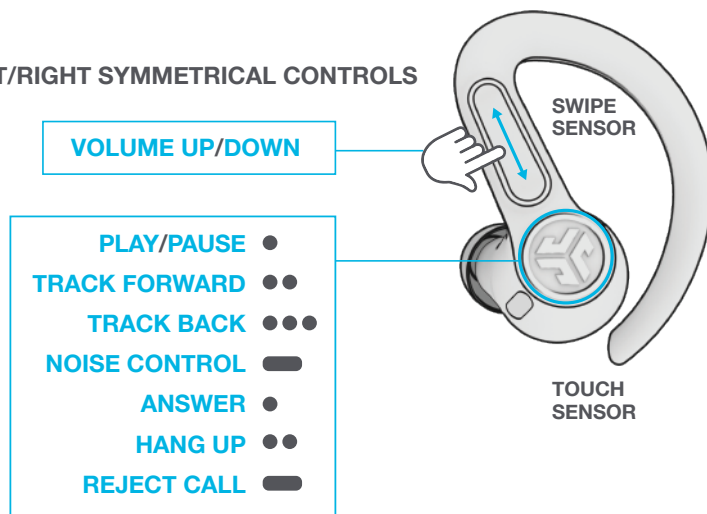

**EQ CHANGE** Simultaneous Press Hold Right and Left Touch Sensors

**SPATIAL AUDIO ON/OFF** 5x Press Touch Sensor

## THE RIGHT SOUND FOR EVERY MOMENT

### EQUALIZER MODES

- "JLab SIGNATURE"**  
JLab C3™ signature sound with amplified bass and vocals
- "KNOWLES PREFERRED"**  
Even sound with no additional enhancements
- "BASS BOOST"**  
Amplified bass and sub-bass
- "CUSTOM"**  
Personalize your EQ through the JLab App.

## GET CHARGED (EARBUDS)

Earbuds auto power off and start charging when placed in case. Earbuds will auto-connect when removed.

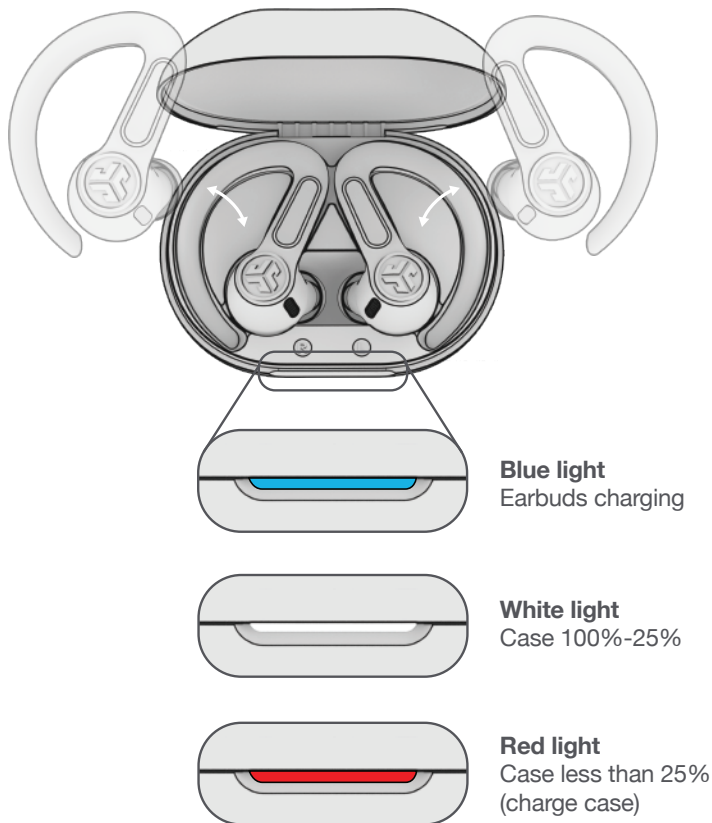

## GET CHARGED (CASE)

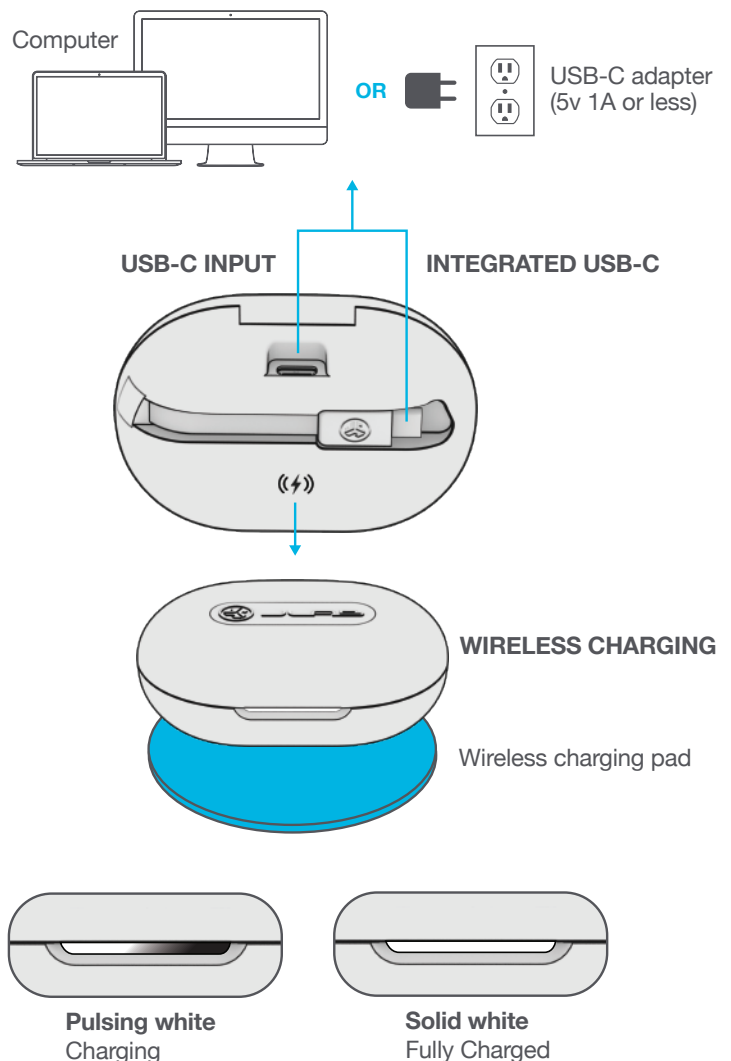

## FIND YOUR FIT

Try all ear tips for best fit and proper seal.

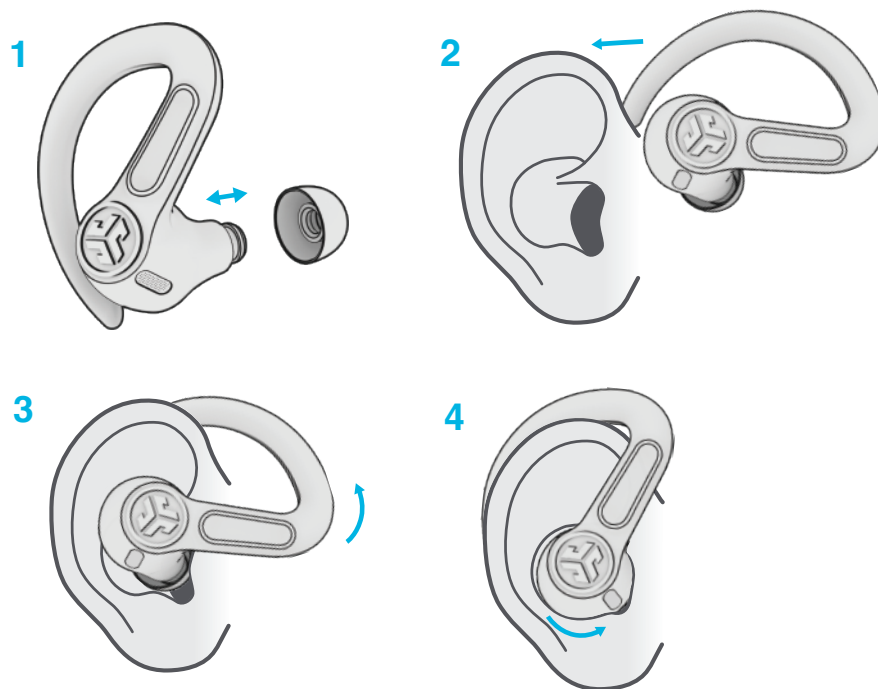

## MULTIPOINT

- 1** Once **FIRST** device is connected, turn off Bluetooth in device settings. Earbuds will auto enter Bluetooth Pairing.



- 2** Enter your **SECOND** device Bluetooth settings and connect.

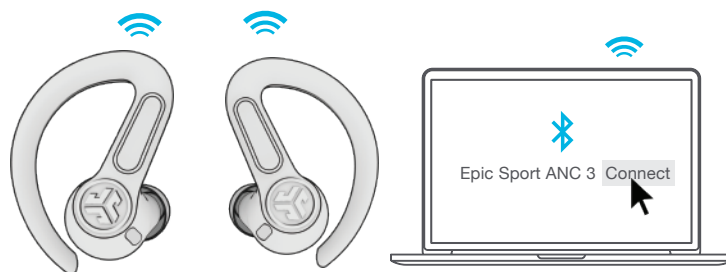

- 3** Enter your **FIRST** device Bluetooth settings. Turn on Bluetooth and connect to Epic Sport ANC 3.

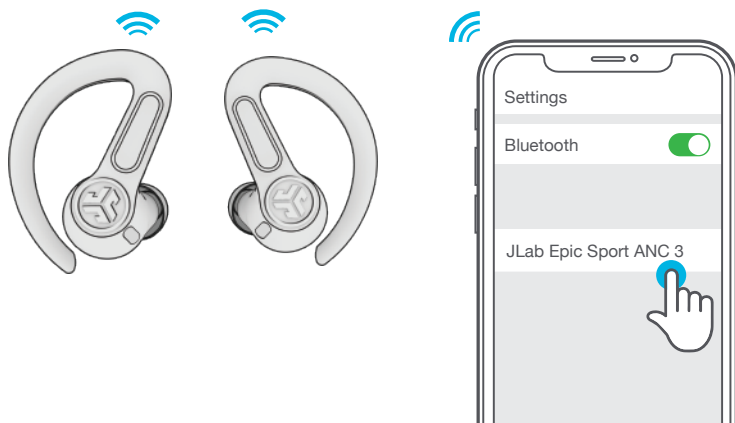

## DOWNLOAD THE APP

Customize Epic Sport ANC 3 with features like an interval timer and update to the latest software.

Download the **JLab App** in Apple/Google Play Store.



[Shop products](#) | [Product alerts](#) | [Burn-in your headphones](#)

JLab Store + Burn-in Tool

