



Scoop & Learn Ice Cream Parlor™



Instruction Manual

This manual contains important information. Please keep it for future reference.

INTRODUCTION

Thank you for purchasing the **Scoop & Learn Ice Cream Parlor™!** Colors, counting and sweet pretend play are always on the menu. Four flavors of ice cream, three toppings and four baked treats combine for 100s of tasty creations and hours of fun and learning.

2 Lollipops

2 Double-sided Menus

4 Baked Treats

2 Ice Cream Cones

Bell

8 Double-sided Signs

Magic Scooper

8 Ice Cream Scoops

3 Toppings

Ice Cream Cart
Assembly required

10 Paper Bills

10 Plastic Coins



Magic Scooper

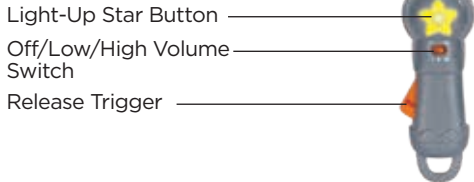

INCLUDED IN THE PACKAGE

- Scoop & Learn Ice Cream Parlor™
- Quick Start Guide



1 Magic Scooper



2 Brown Chocolate Ice Cream Scoops



2 Yellow Vanilla Ice Cream Scoops



2 Pink Strawberry Ice Cream Scoops



2 Green Mint Ice Cream Scoops



1 Red Cherry Sauce Topping



1 Orange Sprinkles Topping



1 White Whipped Cream Topping



2 Ice Cream Cones



2 Circle Cookies



1 Square Cake



1 Triangle Pie



2 Lollipops



2 Double-sided Menus



8 Double-sided Signs



10 Plastic Coins



10 Paper Bills

Ice Cream Cart Parts



1 Cart Front Panel



3 Cart Legs

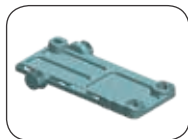

1 Cart Lower Shelf



2 Cart Feet



2 Cart Wheels



1 Ice Cream Tray



1 Cart Handle



1 Upper Shelf



1 Upper Shelf Back



2 Upper Shelf
Rear Legs



2 Upper Shelf
Front Legs



3 Umbrella Panels



1 Umbrella Cap



1 Umbrella Pole



Ice Cream Tray
Stickers

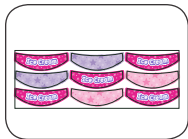

Umbrella Stickers

WARNING

All packing materials such as tape, plastic sheets, packaging locks, removable tags, cable ties, cords and packaging screws are not part of this toy and should be discarded for your child's safety.

NOTE

Please save this Instruction Manual as it contains important information.

ATTENTION

Pour la sécurité de votre enfant, débarrassez-vous de tous les produits d'emballage tels que rubans adhésifs, feuilles de plastique, attaches, étiquettes, cordons et vis d'emballage. Ils ne font pas partie du jouet.

NOTE

Il est conseillé de sauvegarder ce manuel d'instructions car il comporte des informations importantes.

NOTE

After removing from packaging, wipe all the included plastic pieces using a slightly damp cloth. Wash the plastic play accessories thoroughly before and after use. To avoid damaging the electronics, do not submerge the **Magic Scooper** in water or expose it to excessive moisture.

ADULT ASSEMBLY REQUIRED

No tools needed. Press pieces firmly together until they snap or click.

NOTE: Cart pieces fit together one way only. Do not force pieces together. Once assembled, pieces cannot be removed.

APPLY STICKERS

Before assembly, apply the **Tray Stickers** to the **Ice Cream Tray** and leave a blank slot for the **Toppings**. Apply the **Umbrella Stickers** to the **Umbrella Panels**.

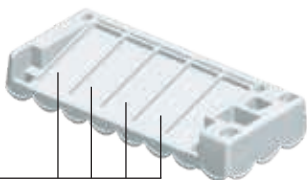

ASSEMBLE THE CART BASE

1. Place a green **Cart Wheel** on a firm stable surface with the flat side facing up. Line up the axle on the blue **Cart Lower Shelf** with the **Wheel** hub and press down to attach. Repeat for the second **Wheel**.

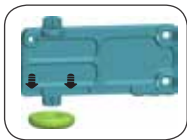

2. Insert the white **Cart Feet** into the underside of the **Cart Lower Shelf** and press firmly until they snap in place.

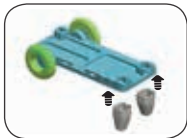

3. Attach the silver **Cart Legs** to the **Cart Lower Shelf**. Insert the round pegs into the holes on the **Cart Lower Shelf**.



4. Insert the tabs on the bottom of the blue **Cart Front Panel** into the slots on the **Cart Lower Shelf**.

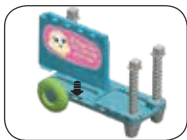

5. Locate the slots on the underside of the white **Ice Cream Tray**. Line up the slots with the tops of the **Cart Legs** and the tabs on the top of the **Cart Front Panel**. Press carefully to attach all pieces at the same time.



ASSEMBLE THE UPPER SHELF

1. Turn the silver **Upper Shelf** upside down and snap the silver **Upper Shelf Legs** in place. The curved **Legs** are in front, the straight **Legs** are in back. **Legs** will fit into the slots only one way.
2. Line up the bottom tabs of the **Upper Shelf Legs** with the slots in the **Ice Cream Tray** and press down firmly to snap together.
3. Attach the silver **Upper Shelf Back** to the **Upper Shelf**.

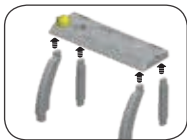

ASSEMBLE THE UMBRELLA

1. Fit the edges of the 3 pink **Umbrella Panels** together and snap in place.
2. Push the pink **Umbrella Cap** up through the opening in the **Umbrella** from underneath.

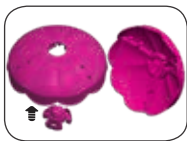
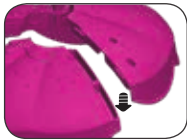

3. Slide top tab of the pink **Umbrella Pole** into the slot in the **Umbrella Cap**.

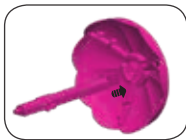

4. Align the bottom peg of the **Umbrella Pole** with the hole on the **Ice Cream Tray**, and align the tab on the side of the **Pole** with the slot on the end of the **Upper Shelf**. Press carefully to attach both at the same time.



5. Attach the green **Cart Handle** to the **Ice Cream Tray**.



Double check all attachments to make they are securely snapped in place.

GETTING STARTED

BATTERY REMOVAL AND INSTALLATION

1. Make sure the **Magic Scooper** is turned Off.
2. Find the battery cover located on the back of the **Magic Scooper**. Use a screwdriver to loosen the screw and then open the battery cover.
3. Remove old batteries by pulling up on one end of each battery.
4. Install 2 new 1.5V AAA (LR03) batteries following the diagram inside the battery box. (For best performance, alkaline batteries or fully charged Ni-MH rechargeable batteries are recommended.)
5. Replace the battery cover and tighten the screw to secure.

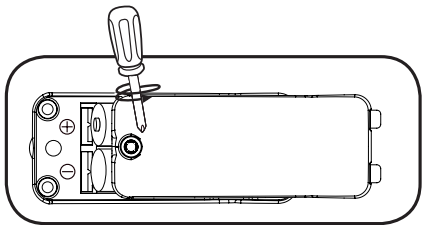

WARNING:

Adult assembly required for battery installation.
Keep batteries out of reach of children.



ATTENTION :

Les piles ou accumulateurs doivent être installés par un adulte. Tenir les piles ou accumulateurs hors de portée des enfants.

ACTIVATE STANDARD PLAY MODE

This product starts in Demo mode when it is turned On. To activate standard Play mode, please complete the following steps:

1. Remove the unit from the packaging.
2. Turn the **Magic Scooper On** by sliding the switch to either **Low Volume** 🗣️ or **High Volume** 🗣️) position. Pick up one of the **Ice Cream Scoops** with the **Magic Scooper** to activate standard Play mode.



IMPORTANT: BATTERY INFORMATION

- Insert batteries with the correct polarity (+ and -).
- Do not mix old and new batteries.
- Do not mix alkaline, standard (carbon-zinc) or rechargeable batteries.
- Only batteries of the same or equivalent type as recommended are to be used.
- Do not short-circuit the supply terminals.
- Remove batteries during long periods of non-use.
- Remove exhausted batteries from the toy.
- Dispose of batteries safely. Do not dispose of batteries in fire.

RECHARGEABLE BATTERIES

- Rechargeable batteries are only to be charged under adult supervision.
- Do not charge non-rechargeable batteries.

IMPORTANT : INFORMATIONS CONCERNANT LES PILES

Les piles fournies avec le produit permettent de tester le jouet en magasin mais ne sont pas des piles longue durée.



- Mettre en place les piles ou les accumulateurs en respectant les polarités + et -.
- Ne pas mélanger des piles ou des accumulateurs neufs avec des usagés.
- Ne pas mélanger différents types de piles : alcalines, zinccarbone et rechargeables.
- Seules des piles du type recommandé doivent être utilisées.
- Ne pas mettre les bornes d'une pile ou d'un accumulateur en court-circuit (en reliant directement le + et le -).
- Retirer les piles ou les accumulateurs en cas de nonutilisation prolongée.
- Enlever les piles ou les accumulateurs usagés du jouet.
- Ne les jeter ni au feu ni dans la nature.

PILES RECHARGEABLES :

- Les accumulateurs ne doivent être chargés que sous la surveillance d'un adulte.
- Ne pas tenter de recharger des piles non rechargeables.

PRODUCT FEATURES

1. Magic Scooper

To turn the unit **On**, slide the **Off/Low/High Volume Switch** to the **Low Volume**  or **High Volume**  position. To turn the unit **Off**, slide the **Off/Low/High Volume Switch** to the **Off**  position.



2. Release Trigger

Place the **Magic Scooper** on top of an **Ice Cream Scoop** or **Topping** to pick up and hear the color or flavor name. To release the **Ice Cream Scoop** or **Topping**, press the **Release Trigger** on the side of the **Magic Scooper**.

Quickly pressing the **Release Trigger** three times in a row during an activity will exit the activity.



3. Light-Up Star Button

Press the **Light-Up Star Button** to hear customer orders with step-by-step instructions and play games about counting and stacking.



4. 8 Ice Cream Scoops, 3 Toppings, 2 Cones, 4 Baked Treats

Mix, make and serve 100s of pretend frozen treats. Hear the color or flavor name of the **Ice Cream Scoop** or **Topping** as it's picked up and released by the **Magic Scooper**.



5. Paper Bills and Plastic Coins

Play **Bills** and **Coins** enhance pretend play and reinforce counting 1 to 10.



6. Double-sided Signs and Menus

Set up shop your way! **Eight Double-sided Signs** let kids advertise flavors and specials. **Two Double-sided Menus** reinforce colors and inspire rich pretend-play experiences.



7. Automatic Shut-Off

To preserve battery life, the **Scoop & Learn Ice Cream Parlor™** will automatically shut off after approximately 80 seconds without input. The **Magic Scooper** can be turned on again by pressing the **Light-Up Star button**, picking up an **Ice Cream Scoop** or **Topping** with the **Magic Scooper**, or pressing the **Release Trigger**.

SONG LYRICS

Open Shop

Flip the sign, the shop's awake
Scoops of ice cream and treats are great.
Colors and shapes, so nice and neat
Today's special tastes so sweet!

Open Shop Reprise

Flip the sign, the shop's awake
Scoops of ice cream and treats are great.

Sweet Shapes

Put it on a circle cookie, yum
On a square cake, here it comes
Triangle pie with a scoop on top
A la mode, don't let it drop

Order Up

Order up, a treat to go
Stack it fast, or stack it slow
Scoop by scoop it's a such blast
Eat it up quickly, yeah
It melts so fast.

CARE & MAINTENANCE

1. Keep the unit clean by wiping it with a slightly damp cloth.
2. Keep the unit out of direct sunlight and away from any direct heat sources.
3. Remove the batteries if the unit will not be in use for an extended period of time.
4. Do not drop the unit on hard surfaces and do not expose the unit to moisture or water.

TROUBLESHOOTING

If for some reason the unit stops working or malfunctions, please follow these steps:

1. Turn the unit **Off**.
2. Interrupt the power supply by removing the batteries.
3. Let the unit stand for a few minutes, then replace the batteries.
4. Turn the unit **On**. The unit should now be ready to use again.
5. If the unit still does not work, install a new set of batteries.

Environmental Phenomena

The unit may malfunction if subjected to radio-frequency interference. It should revert to normal operation when the interference stops. If not, it may become necessary to turn the power **off** and back **on**, or remove and reinstall the batteries. In the unlikely event of an electrostatic discharge, the unit may malfunction and lose memory, requiring the user to reset the device by removing and reinstalling the batteries.

Impact de l'environnement

Une défaillance de fonctionnement de l'appareil peut survenir s'il est sujet à des interférences avec les fréquences radioélectriques. Le fonctionnement normal de l'appareil devrait reprendre avec l'arrêt des interférences. Si ce n'est pas le cas, il peut s'avérer nécessaire d'éteindre et rallumer l'appareil ou de retirer et réinstaller les piles. Dans l'éventualité peu probable d'une décharge électrostatique, un mauvais fonctionnement et une perte de mémoire de l'appareil peuvent se produire. L'utilisateur doit alors retirer et réinstaller les piles pour réinitialiser l'appareil.

NOTE

This equipment has been tested and found to comply with the limits for a Class B digital device, pursuant to Part 15 of the FCC Rules. These limits are designed to provide reasonable protection against harmful interference in a residential installation. This equipment generates, uses and can radiate radio frequency energy and, if not installed and used in accordance with the instructions, may cause harmful interference to radio communications. However, there is no guarantee that interference will not occur in a particular installation. If this equipment does cause harmful interference to radio or television reception, which can be determined by turning the equipment off and on, the user is encouraged to try to correct the interference by one or more of the following measures:

- Reorient or relocate the receiving antenna.
- Increase the separation between the equipment and receiver.
- Connect the equipment into an outlet on a circuit different from that to which the receiver is connected.
- Consult the dealer or an experienced radio/TV technician for help.

CAUTION

Changes or modifications not expressly approved by the party responsible for compliance could void the user's authority to operate the equipment.

IMPORTANT NOTE:

If the problem persists, please call our **Consumer Services Department** at **1-800-701-5327** in the U.S. and Canada, or email **support@leapfrog.com**. Creating and developing LeapFrog products is accompanied by a responsibility that we take very seriously. We make every effort to ensure the accuracy of the information, which forms the value of our products. However, errors sometimes can occur. It is important for you to know that we stand behind our products and encourage you to contact us with any problems and/or suggestions you might have. A service representative will be happy to help you.

Supplier's Declaration of Conformity

47 CFR § 2.1077 Compliance Information

Trade Name: LeapFrog®
Model: 6216
Product Name: Scoop & Learn Ice Cream Parlor™
Responsible Party: LeapFrog Enterprises, Inc.
Address: 2200 Powell St., Suite 500
Emeryville, CA 94608
Website: leapfrog.com

THIS DEVICE COMPLIES WITH PART 15 OF THE FCC RULES. OPERATION IS SUBJECT TO THE FOLLOWING TWO CONDITIONS: (1) THIS DEVICE MAY NOT CAUSE HARMFUL INTERFERENCE, AND (2) THIS DEVICE MUST ACCEPT ANY INTERFERENCE RECEIVED, INCLUDING INTERFERENCE THAT MAY CAUSE UNDESIRED OPERATION.



***Visit our website for more
information about our products,
downloads, resources and more.***

***leapfrog.com
leapfrog.ca***

**Read our complete warranty and legal
policies online at leapfrog.com/legal**

LeapFrog Enterprises, Inc.,
A subsidiary of VTech Holdings Limited.

© 2026 LeapFrog Enterprises, Inc.

All rights reserved.

Printed in China

IM-621600-000

Version:0