



PRE-LIT HINGED TREE ASSEMBLY INSTRUCTIONS

Before you start to set up your tree, please read this instruction sheet carefully.

1. Remove all parts from the box: tree stand, tree top, tree body sections, instruction sheet and spare bulbs.
2. Set up tree stand in cross shape.
3. If a tree is divided into two sections, tree top(B) and tree bottom(A).
 - Insert the bottom section of tree (with tapered section of the trunk) into the tree stand, and fasten the 3 screws on the top of tree stand to make sure your tree is standing upright.
 - Insert tree top into the hole (pole cap) on the top of the trunk.If a tree is divided into three sections: tree top(C), tree body(B), tree bottom(A).
 - Insert the bottom section of tree (with tapered section of the trunk) into the tree stand, and fasten the 3 screws on the top of tree stand to make sure your tree is standing upright.
 - Insert the trunk end of the body section of tree into the tree's bottom section.
 - Insert tree top into the hole (pole cap) on the top of the trunk.If a tree is divided into four sections: tree top(D), tree body I (C), tree body II (B), tree bottom(A).
 - Insert the bottom section of tree (with tapered section of the trunk) into the tree stand, and fasten the 3 screws on the top of tree stand to make sure your tree is standing upright.
 - Insert the trunk end of the body section II of tree into the tree's bottom section.
 - Connect the body section I with body section II.
 - Insert tree top into the hole (pole cap) on the top of the trunk.
4. Remove the packaging (foam, bubble wrap, cord, etc.) to allow the hinged branches to unfold into place.
5. Find the outlets on the extension cord, which is placed on the body or bottom section of the tree, then connect all plugs on the light sets into the extension cord outlets. ***Do not connect more than 6 light set plugs together end-to-end. (pls note that trees with less than 500 lights have no extension cord.)***
6. Shape the tree by arranging its branches into the desired position. Finished look should be natural looking and full.
7. Plug the extension cord into the electric wall outlet. Your tree should be fully lit.
8. Your tree is ready to be decorated and enjoyed.
9. For indoor use.

WARNING -Risk of fire, personal injury and electrical shock.

1. Do not leave the tree unattended while it is power-on.
2. Replace any missing or broken bulbs before plugging in.
3. Do not place near gas or electric heaters, radiators, fireplaces, candles, outdoor heaters, barbecues or other similar sources of heat.
4. Place on a level, hard, flat surface: do not place where tree is likely to wobble due to uneven floors or thick carpeting.
5. After assembling the tree and adding decorations, make sure the tree is stable. If tree is not stable, shift the weight of the decorations, and use support wires to walls and/or window frames (make sure they are secure also).
6. Do not install near fountains, bathtubs, sinks, pools, hot tubs or other wet areas.
7. Do not use candles on this tree.

8. Do not overload power strips, or any other power receptacles. Make sure that the electrical rating of the tree and any other device connected to the same receptacle is below the maximum rating of the extension cord(If a tree is supplied with an extension cord), power strip or other power receptacle.
9. This is an electrical product – not a toy! To avoid risk of fire, burns, personal injury and electrical shock it should not be played with or placed where small children and pets can reach it.

STORAGE:

- (1) Unplug light cord from the wall outlet and remove all ornaments and decorations.
- (2) Unplug each section.
- (3) Gently lift off the tree top and remove the bottom section from the tree stand. Carefully place the tree in its box and tape it shut. DO NOT STORE TREE IN A DAMP AREA OR IN AN AREA WHERE THE TEMPERATURE EXCEEDS 100° F.

TROUBLE SHOOTING INSTRUCTIONS

If Lights Do Not Work:

1. Check whether the plug is properly plugged into the outlet.
2. Be sure there is power to the outlet.
3. Check whether all plugs within the tree are securely connected.
4. Check whether all bulbs are tightly inserted into lampholders and replace any missing or broken bulbs.
5. Check the light string fuse in the section plug that is out, but unplug tree first. If the fuse is blown (see if wire inside is intact or glass is blown). Replace the blown fuse following the diagram. There is a spare fuse included for easy replacement.

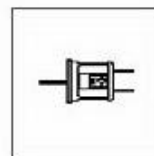
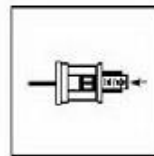
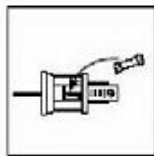
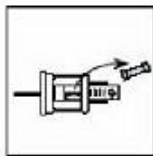

Spare fuse

If a bulb does not work:

- a. First remove the bulb and make sure the wires are on either side of the bulb adaptor so that they will contact with the brass inside the lampholders and reinsert.
- b. If bulb still does not light, it is blown, remove the bulb and replace only with the supplied replacement bulbs following the diagram below.

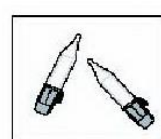
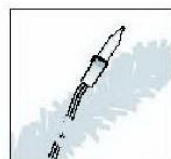
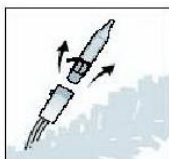
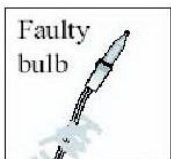

Spare bulbs



FLAME RETARDANT

MADE IN CHINA