

ASSEMBLY INSTRUCTIONS

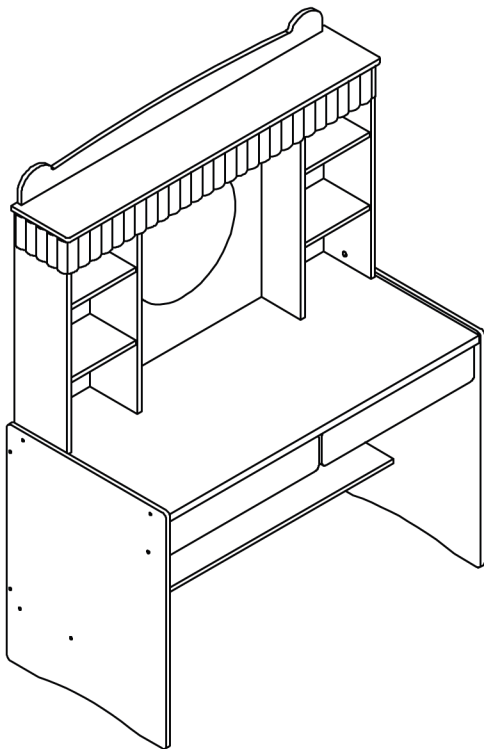

TOOLS REQUIRED



**Allen Wrench
(Included)**

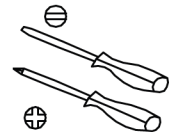

**Phillips Screwdriver
Flathead Screwdriver
(Not Included)**

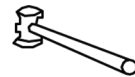

Hammer (Not Included)



**2 - Persons
Recommended**

ASSEMBLY RATING



EASY —————> DIFFICULT

The Assembly Rating is a 5-point system showing the level of effort needed to assemble a specific product.



CHECK BEFORE STARTING

☐

Are you missing anything?

Double-check all parts, hardware and accessories listed on Page 6 are accounted for.

☐

Should we send any replacements?

Are there any irregularities or flaws in the parts? We can send replacements!

☐

Check out our Quick Tips!

We recommend reviewing the pre-assembly handouts. Even experts need a refresher now and then!

☐

Prep Time!

Please review the assembly instructions and all diagrams prior to assembling. Arrange parts as recommended on Page 7 and group identical hardware together to make assembling easier.

PRE ASSEMBLY INTRODUCTION

We understand building ready-to-assemble furniture can be a challenging experience for some. To help avoid confusion, we have provided some helpful tips that may speed up the process.

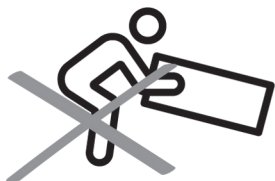

Teamwork

ALWAYS have at least two people to help with transporting and assembling the product to avoid potential injury and/or damage.



Suitable Location

Assembling near the area of the intended location is highly recommended.



Sufficient Space

Make sure you have enough space to move around during the assembly.



Avoid Scratches

Use cardboard, blankets or a carpeted area while assembling furniture to prevent scratches.

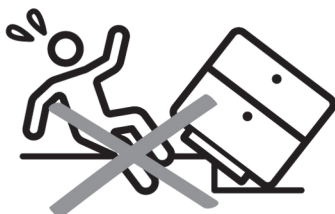

Flat Surface

Make sure the furniture rests on a flat and level surface with each leg evenly touching the floor.

ASSEMBLY AND CARE ADVICE



**FAILURE TO FOLLOW THE GUIDELINES BELOW MAY
RESULT IN INJURY AND/OR PROPERTY DAMAGE.**



Position each part correctly
and insert screws or bolts into
their respective holes.

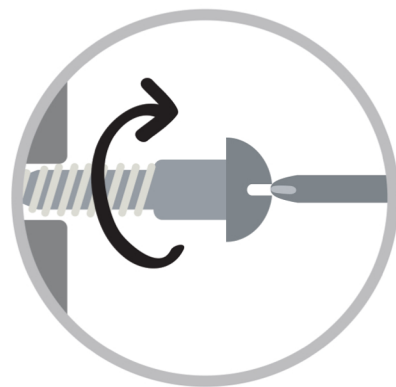

Turn clockwise to tighten and
only tighten when step is
completed or when instructed
to do so.



Use the appropriate hand tools
or power tools for assembly.
Select steps, such as tightening
screws and/or bolts, may require
hand tools to avoid causing
damage during assembly.



Save the instructions and store
any supplied tools for later
maintenance.

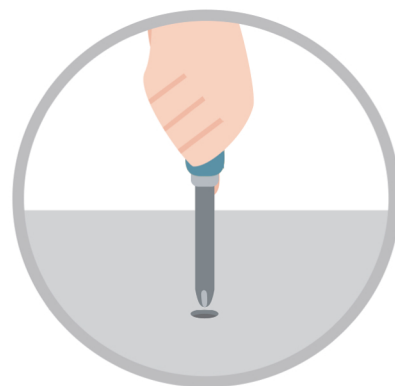

After two weeks, check and
tighten any loose hardware and
repeat again every six months
thereafter.

IT IS THE USER'S RESPONSIBILITY TO MAINTAIN THE FURNITURE. THE HARDWARE MAY LOOSEN OVER TIME AND MAY CAUSE THE FURNITURE TO BE WOBBLY AND UNABLE TO SUPPORT ITS INTENDED WEIGHT CAPACITY. THIS MAY LEAD TO COLLAPSE AND MAY CAUSE SERIOUS INJURY.

DESK



- Please keep instructions for future reference.
- Check the quantity and irregularity of parts and hardware before you start.

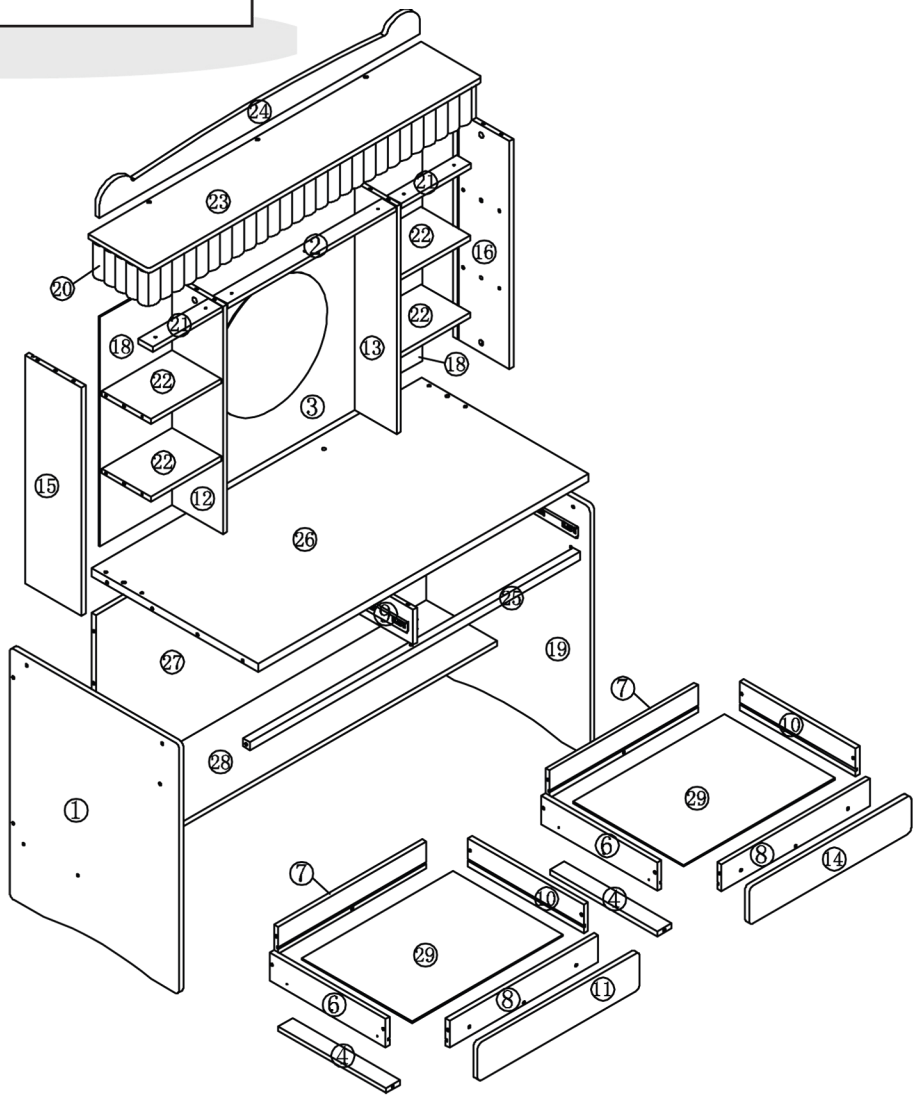

HARDWARE

A	A1	B	C	D	D1	E	F	H	I	J
d15 QTY:30	d15 QTY:30	d8*30 QTY:42	4#*15 QTY:24	M6*50 QTY:28	D22 QTY:2	8#*25 QTY:7	M6*20 QTY:4	400mm QTY:2		QTY:12

SCALE 1:1

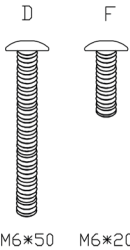

M6*50 M6*20



- Please keep instructions for future reference.
- Check the quantity and irregularity of parts and hardware before you start.

PARTS

DESCRIPTION OF COMPONENT						
ITEM NO	WORK PIECE DESCRIPTION	MEASUREMENT	QTY	COLOUR	SHAPE	PACK IN BOX
(1)	DESK SIDE PANEL (L)	770*600*15	1	PINK		1/2
(2)	BOOK SHELF UPPER FRONT BOARD-1	598*50*15	1	PINK		1/2
(3)	BOOK SHELF MIDDLE BACK PANEL	700*600*15	1	PINK		1/2
(4)	DRAWER SUPPORT	380*50*15	2	PINK		1/2
(5)	HARDWARE	375*89*28	1	-		1/2
(6)	DRAWER SIDE BOARD (L)	410*87*15	2	WHITE		1/2
(7)	DRAWER BACK BOARD	525*83*15	2	WHITE		1/2
(8)	DRAWER FRONT BOARD	525*83*15	2	WHITE		1/2
(9)	SEPARATE BOARD	544*108*15	1	WHITE		1/2
(10)	DRAWER SIDE BOARD (R)	410*87*15	2	WHITE		1/2
(11)	DRAWER BOARD (L)	574*116*15	1	PINK		1/2
(12)	BOOK SHELF MIDDLE SIDE BOARD (L)	700*200*15	1	PINK		1/2
(13)	BOOK SHELF MIDDLE SIDE BOARD (R)	700*200*15	1	PINK		1/2
(14)	DRAWER BOARD (R)	574*116*15	1	PINK		1/2
(15)	BOOK SHELF SIDE BOARD (L)	700*200*15	1	PINK		1/2
(16)	BOOK SHELF SIDE BOARD (R)	700*200*15	1	PINK		1/2
(18)	BOOK SHELF BACK BOARD	705*260*5	2	PINK		1/2
(19)	DESK SIDE PANEL (R)	770*600*15	1	PINK		1/2
(20)	CURTAIN	1665*105*1	1	PINK		1/2
(21)	BOOK SHELF UPPER FRONT BOARD-2	248*50*15	2	PINK		1/2
(22)	BOOK SHELF BOARD	250*173*15	4	PINK		1/2
(23)	BOOK SHELF TOP BOARD	1180*215*15	1	PINK		2/2
(24)	DECORATE PIECE	1134*91*15	1	PINK		2/2
(25)	SQUARE PIPE	1170*25*25	1	WHITE		2/2
(26)	DESK TOP PANEL	1170*590*25	1	PINK		2/2
(27)	DESK BACK PANEL	1170*554*15	1	WHITE		2/2
(28)	BOOK SHELF MIDDLE FILTLER	1170*250*15	1	PINK		2/2
(29)	DRAWER BOTTOM BOARD	535*390*5	2	WHITE		2/2

ASSEMBLY INSTRUCTIONS

1

Align the rails (#H) to the holes along the desk side panels (#19), then secure using screws (#C).

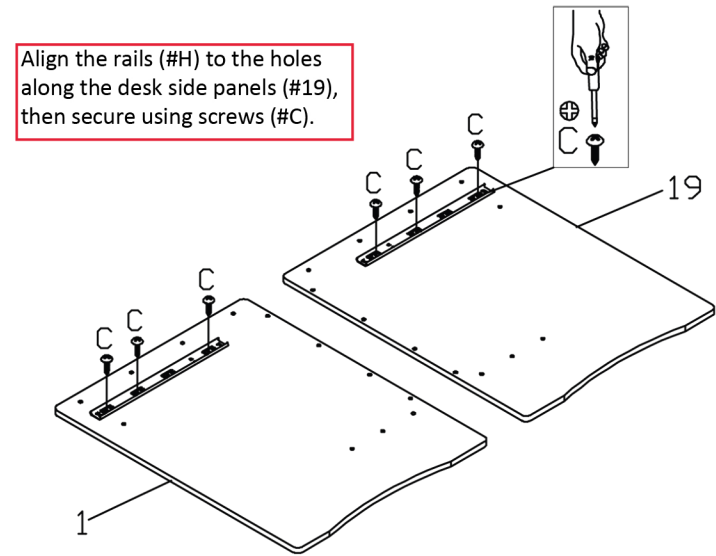

C



4 #*15
QTY:6

H



400mm
QTY:2

3

Secure cam bolts (#A) in to desk top panel (#26).

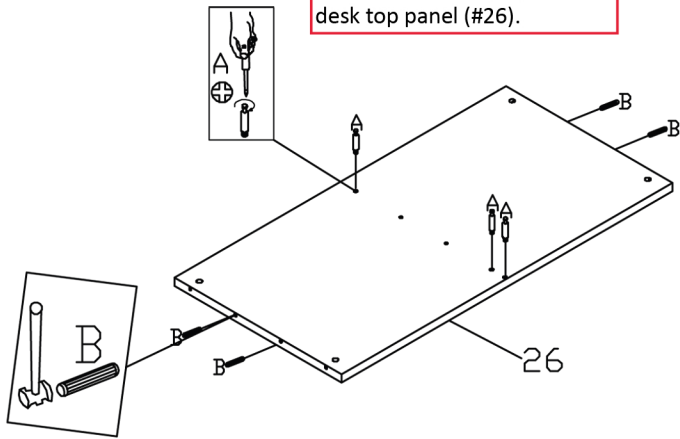

Softly hammer in dowels (#B).

B



d8*30
QTY:4

A



d15
QTY:3

2

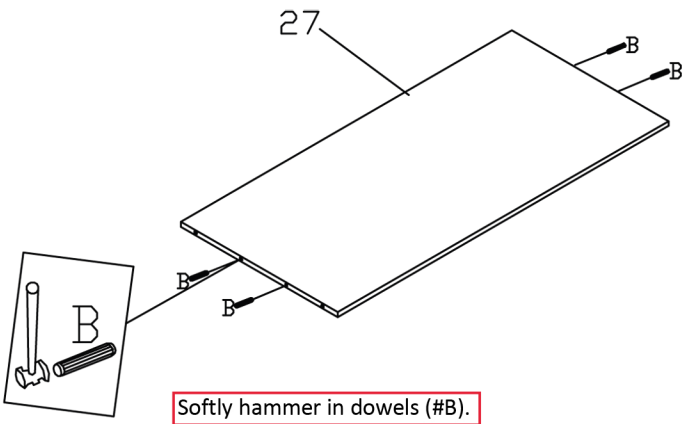

Softly hammer in dowels (#B).

B



d8*30
QTY:4

4

Softly hammer in dowels (#B).

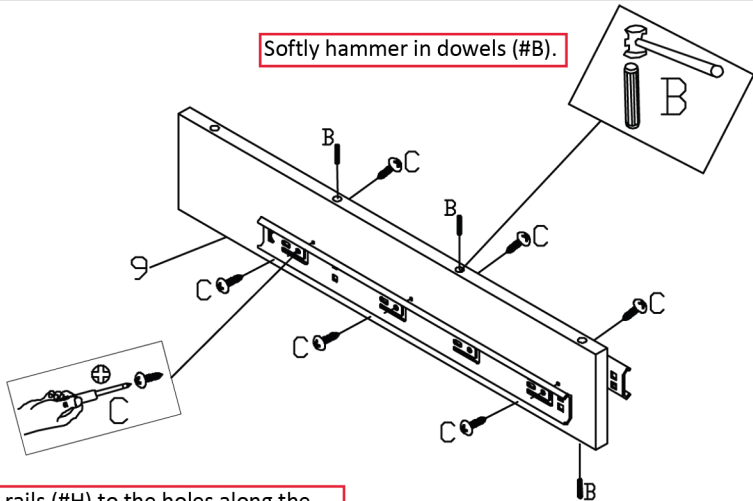

Align the rails (#H) to the holes along the board (#9), then secure using screws (#C).

C



4 #*15
QTY:6

B



d8*30
QTY:3

H



400mm
QTY:2

ASSEMBLY INSTRUCTIONS

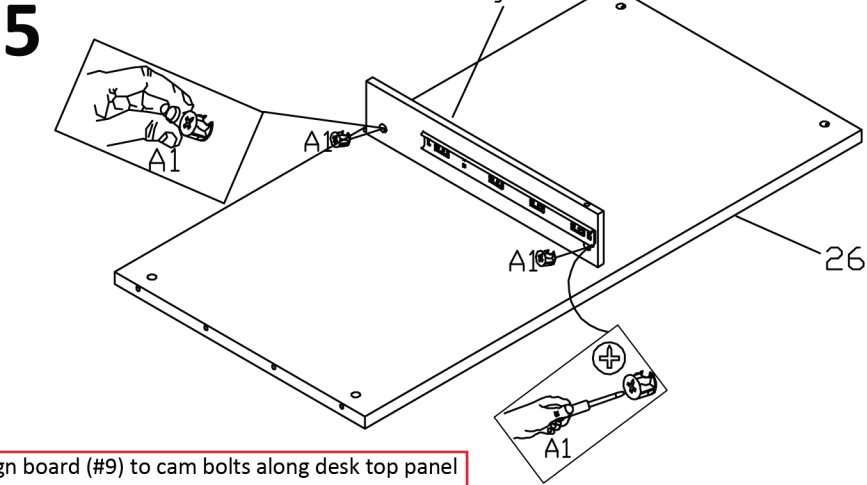

Align board (#9) to cam bolts along desk top panel (#26) and secure using the cam locks (#A1).

A1



d15
QTY:2

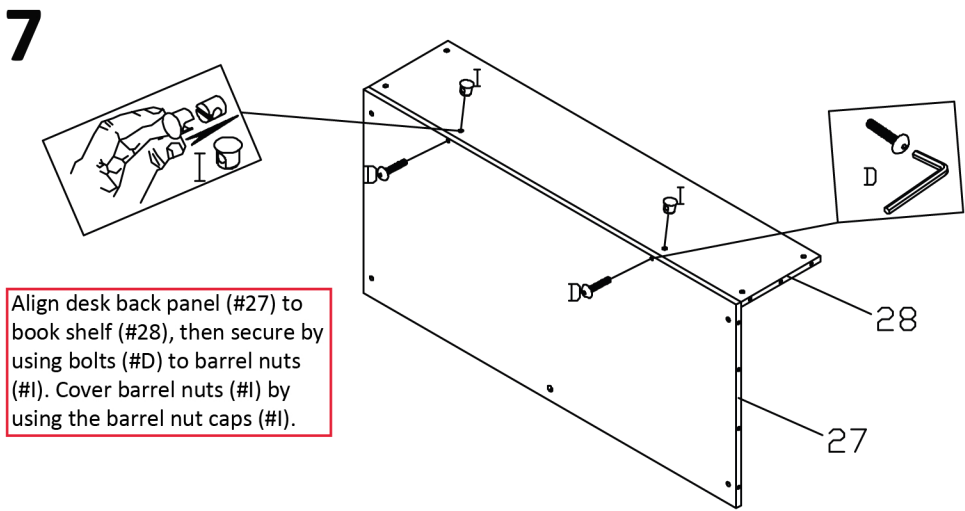

Align desk back panel (#27) to book shelf (#28), then secure by using bolts (#D) to barrel nuts (#I). Cover barrel nuts (#I) by using the barrel nut caps (#I).

D



M6*50
QTY:2

I



QTY:2

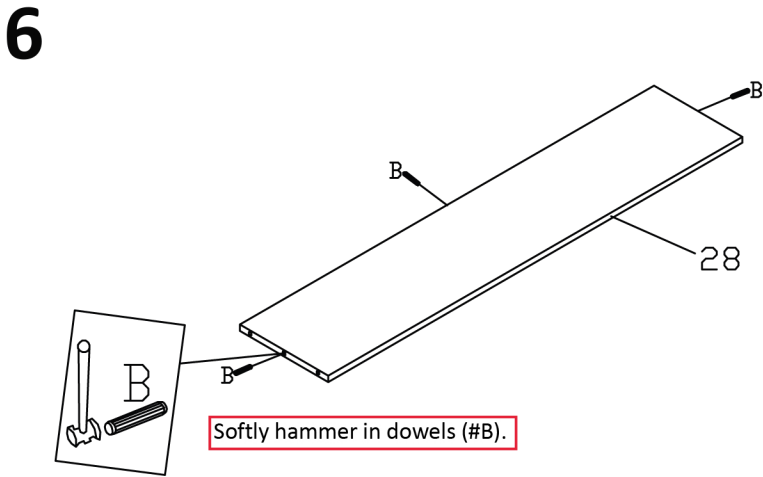

Softly hammer in dowels (#B).

B



d8*30
QTY:3

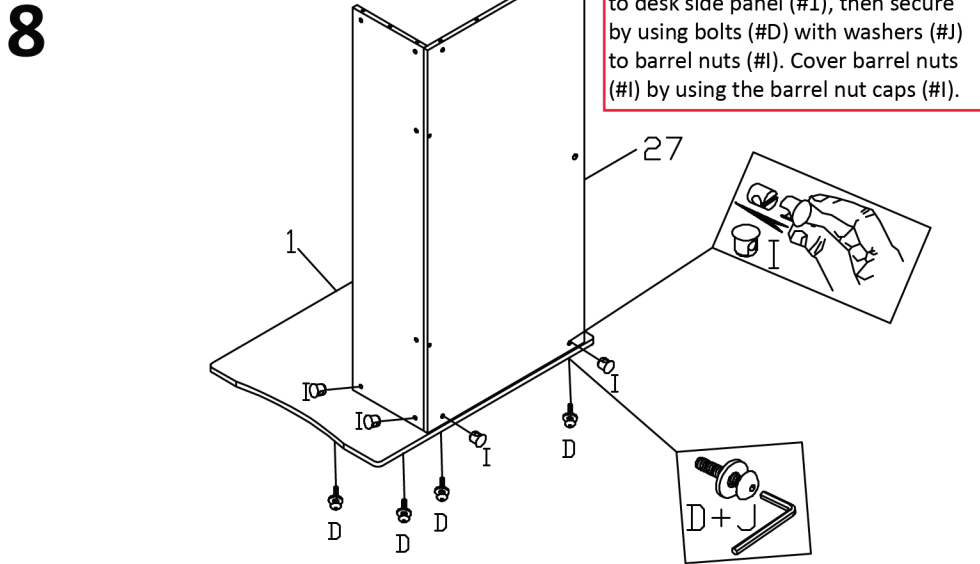

Align panel (#27) and book shelf (#28) to desk side panel (#1), then secure by using bolts (#D) with washers (#I) to barrel nuts (#I). Cover barrel nuts (#I) by using the barrel nut caps (#I).

D



M6*50
QTY:4

I



QTY:4

J



QTY:4

ASSEMBLY INSTRUCTIONS

9

26

Align desk top panel (#26) to desk back panel (#27) and desk side panel (#1), then secure by using bolts (#D) with washers (#J) to barrel nuts (#I). Cover barrel nuts (#I) by using the barrel nut caps (#I).

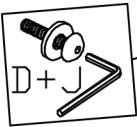

D

D M6*50
QTY:2

I



QTY:2

J



QTY:2

11

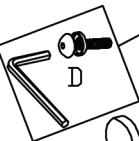

D1

A d15
QTY:4

D



M6*50
QTY:2

D1



QTY:2

10

19

1) Align desk side (#19) to the unit, then secure by using bolts (#D) with washers (#J) to barrel nuts (#I). Cover barrel nuts (#I) by using the barrel nut caps (#I).

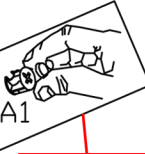

2) Secure by using cam lock (#A1).

D M6*50
QTY:6

I



QTY:6

J



QTY:6

A1



d15
QTY:1

12

Softly hammer in dowels (#B).

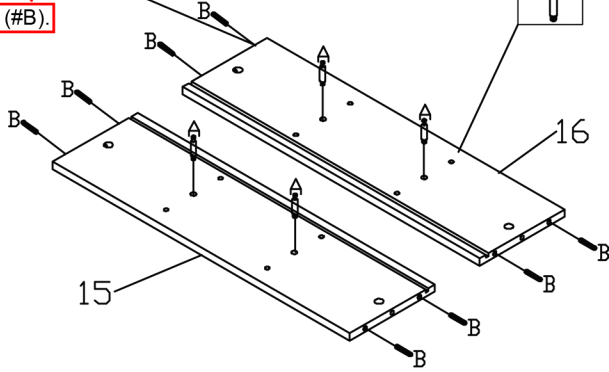
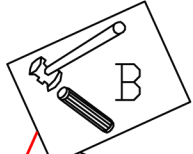

Secure cam bolts (#A) to shelf sides (#15,16).

B

d8*30
QTY:8

A

d15
QTY:4

ASSEMBLY INSTRUCTIONS

13

Softly hammer in dowels (#B).

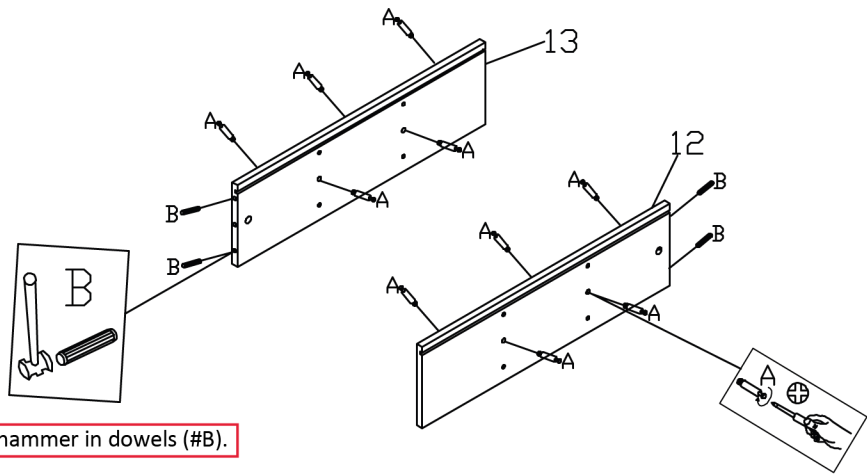

B



d8*30
QTY:4

A



d15
QTY:10

15

Align shelf boards (#22) to shelf side board (#15), then secure by using cam locks (#A1).

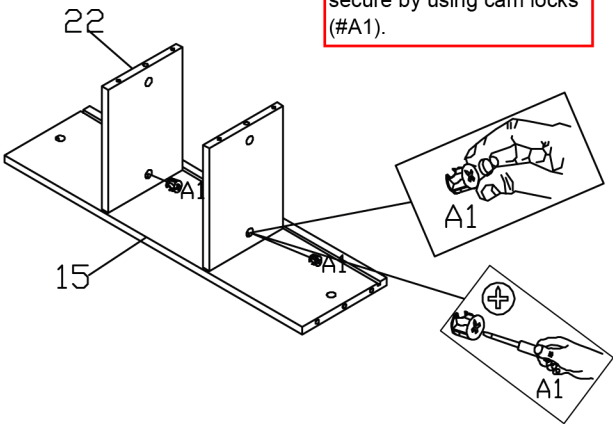

A1



d15
QTY:2

14

Softly hammer in dowels (#B).

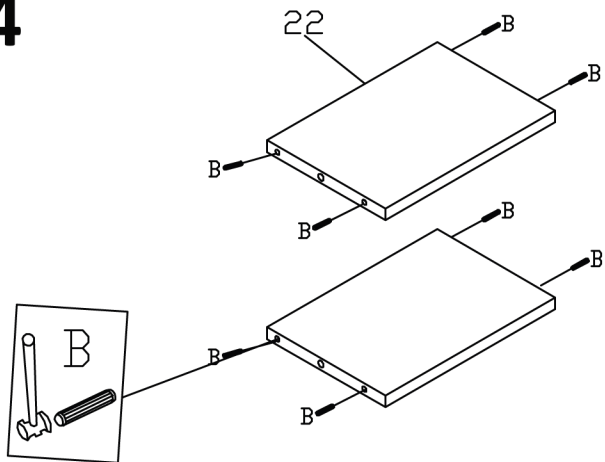

2X

B



d8*30
QTY:16

16

Align shelf mid side board (#12) to shelf boards (#22), then secure by using cam locks (#A1).

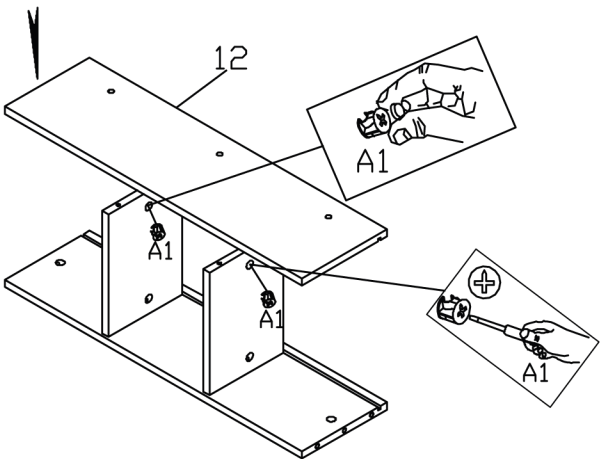

A1



d15
QTY:2

ASSEMBLY INSTRUCTIONS

17

Align shelf boards (#13) to shelf mid side board (#15), then secure by using cam locks (#A1).

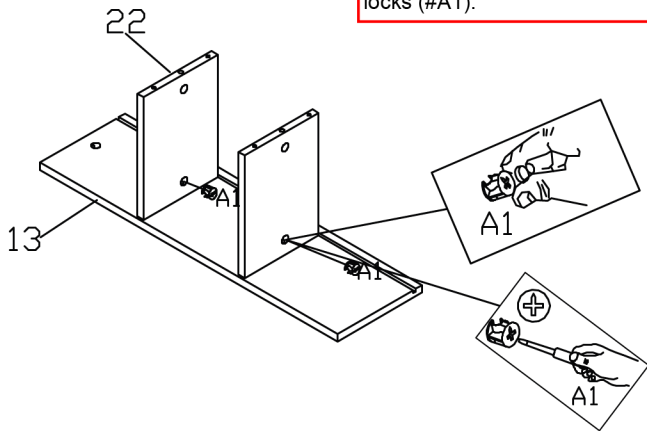

A1 d15
QTY:2

19

Align mid side boards (#12,13) to shelf mid back panel (#3), then secure by using cam locks (#A1).

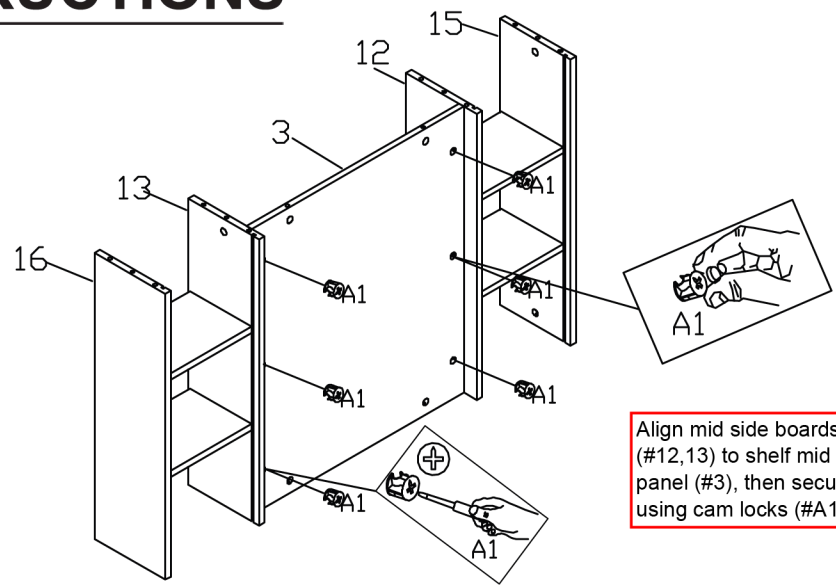

A1 d15
QTY:6

18

Align shelf side board (#16) to shelf boards (#22), then secure by using cam locks (#A1).

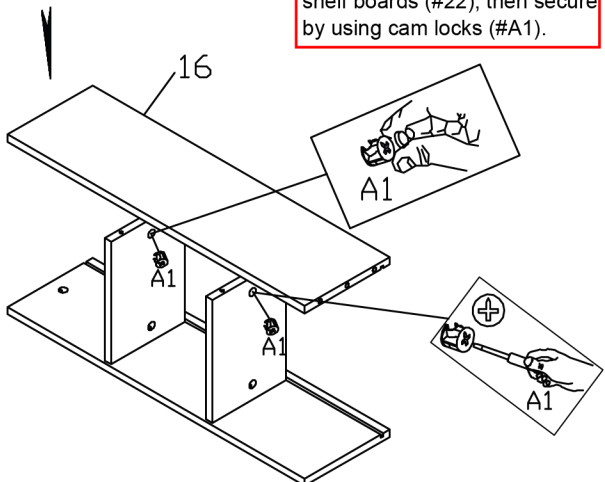

A1 d15
QTY:2

20

Secure cam bolts (#A) to shelf top (#23).

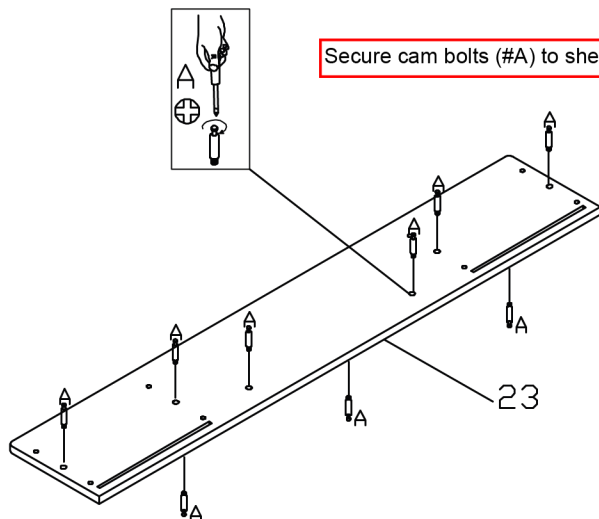

A d15
QTY:9

ASSEMBLY INSTRUCTIONS

21

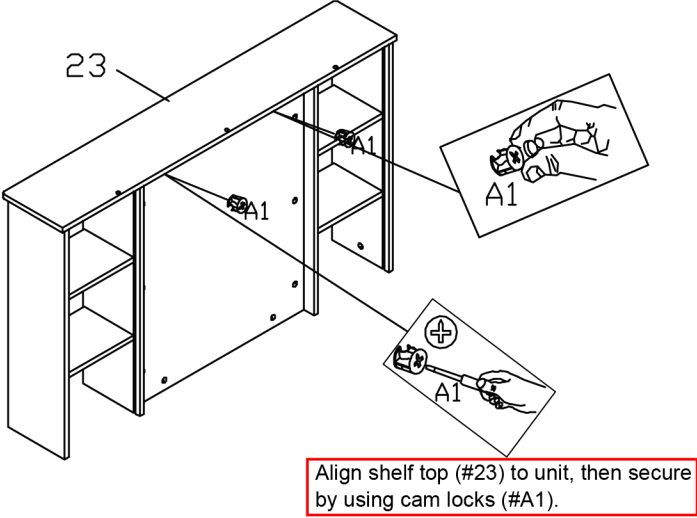

A1



d15
QTY:6

23

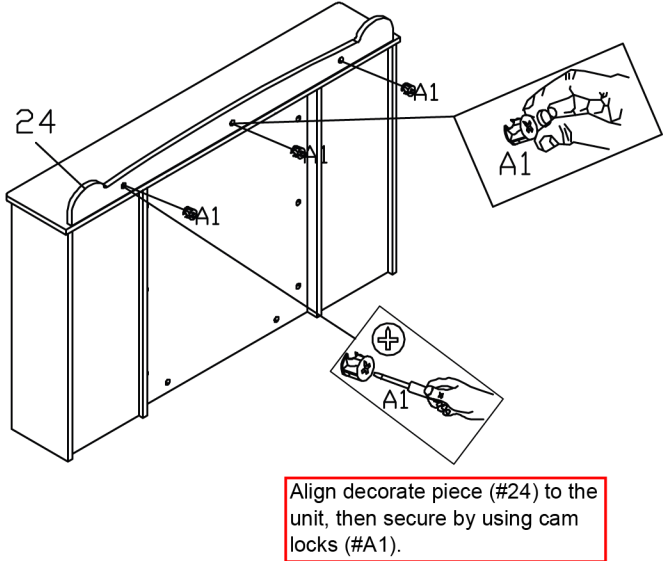

A1



d15
QTY:3

22

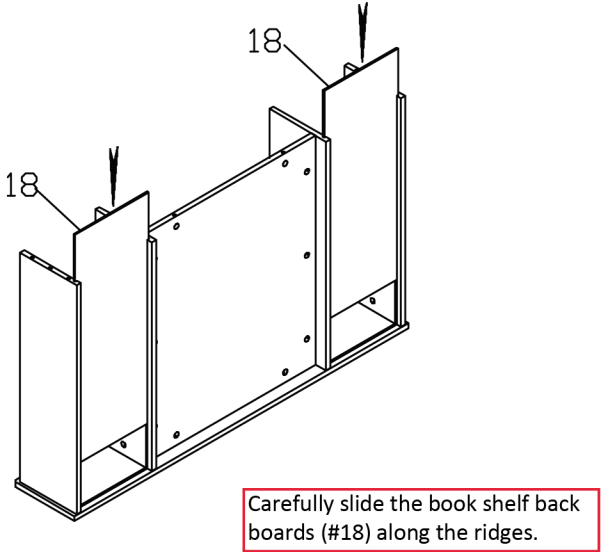

24

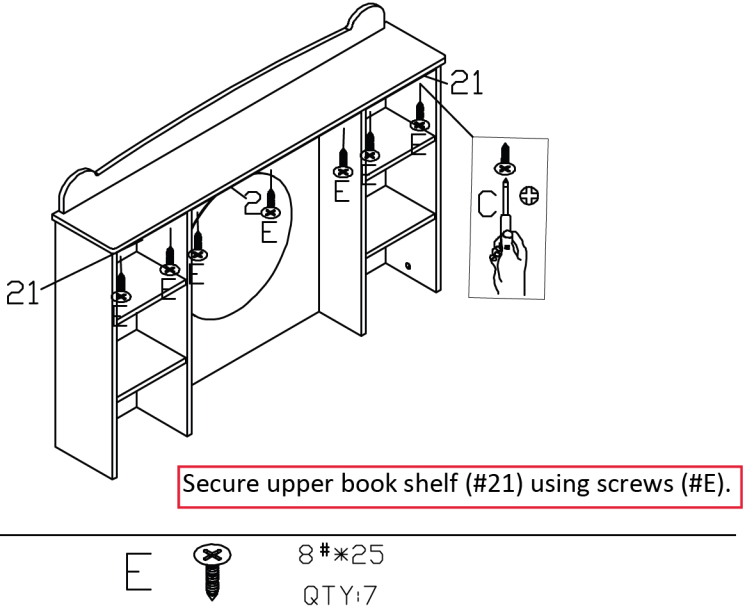

E



8*25
QTY:7

ASSEMBLY INSTRUCTIONS

25

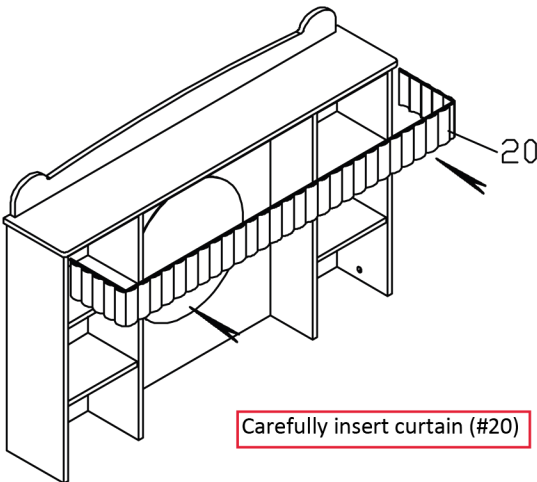

Carefully insert curtain (#20)

27

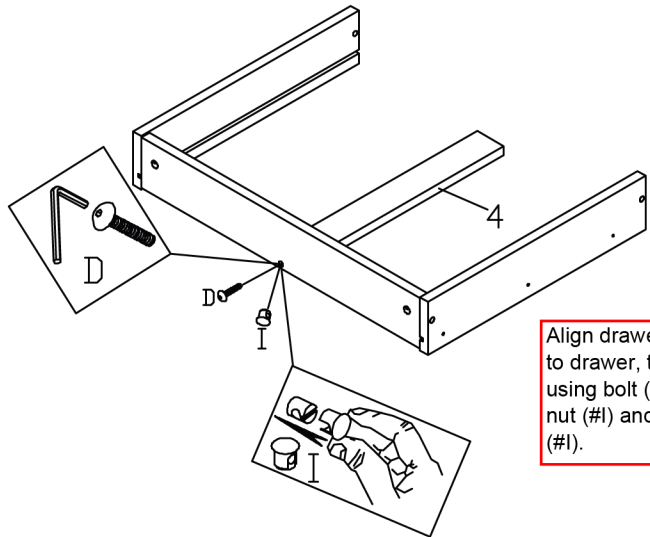

Align drawer support (#4) to drawer, then secure by using bolt (#D) to barrel nut (#I) and barrel nut cap (#I).

2X

D		M6*50 QTY:2	I			QTY:2
---	--	----------------	---	--	--	-------

26

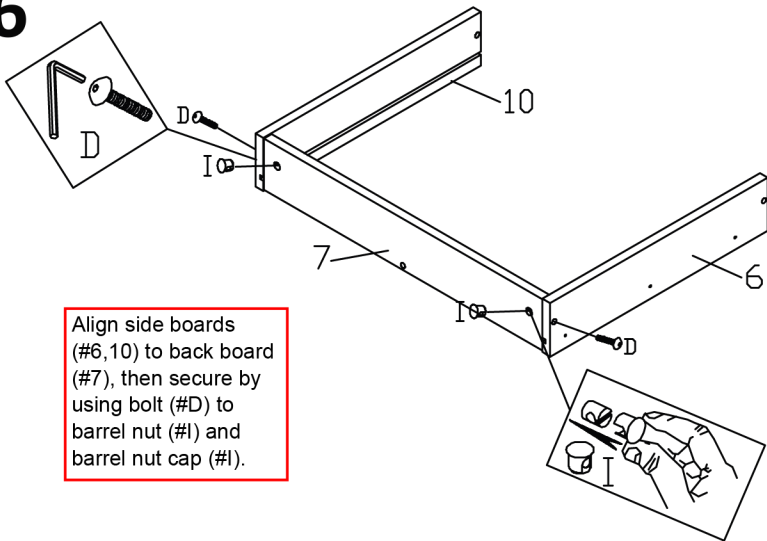

Align side boards (#6, 10) to back board (#7), then secure by using bolt (#D) to barrel nut (#I) and barrel nut cap (#I).

2X

28

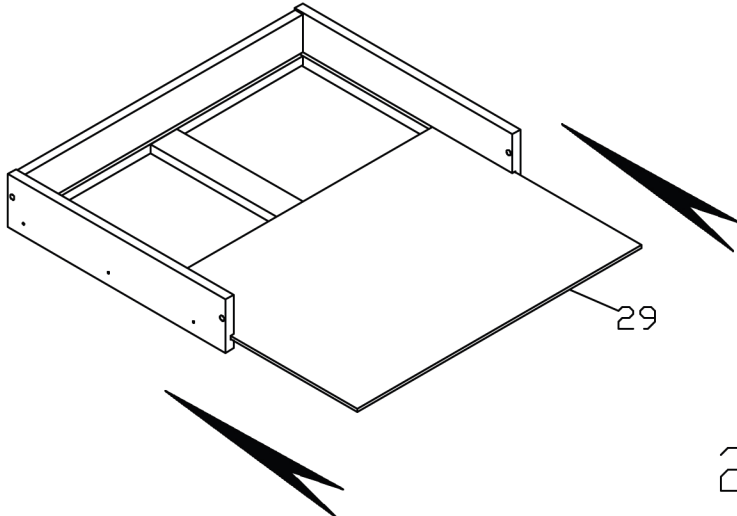

2X

Carefully slide the drawer bottom boards (#29) along the drawer ridges.

D		M6*50 QTY:4	I			QTY:4
---	--	----------------	---	--	--	-------

ASSEMBLY INSTRUCTIONS

29

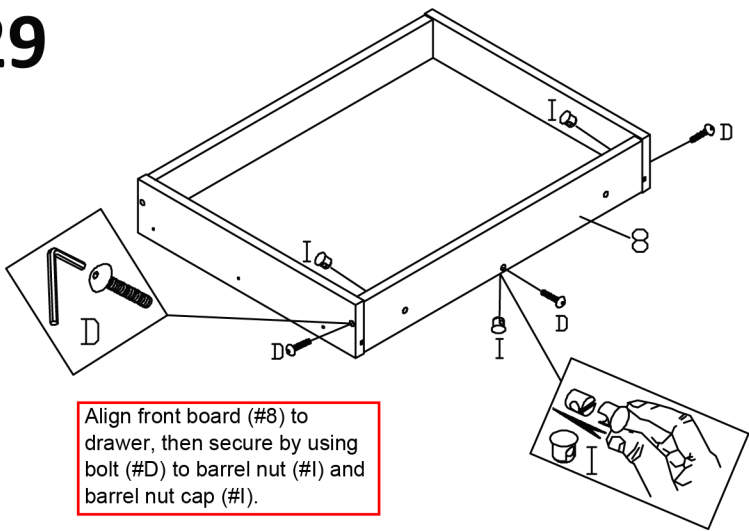

2X

D



M6*50
QTY:6

I



QTY:6

31

Align drawer rails (#H) with lever to the drawer, then secure by using screws (#C).

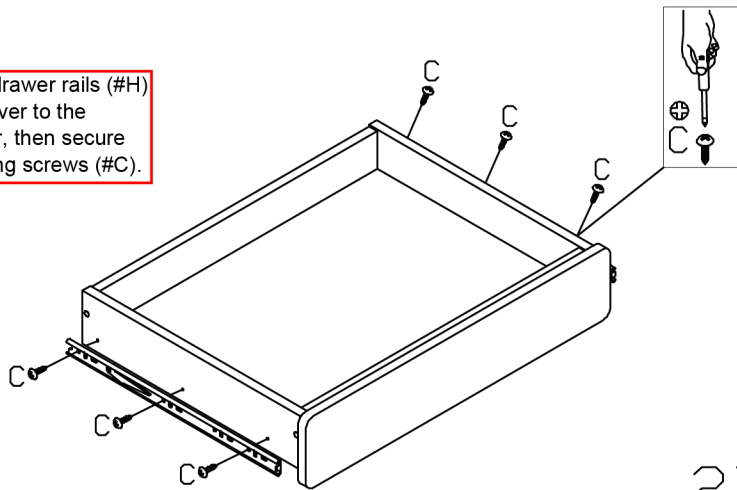

2X

C



4#*15
QTY:12

30

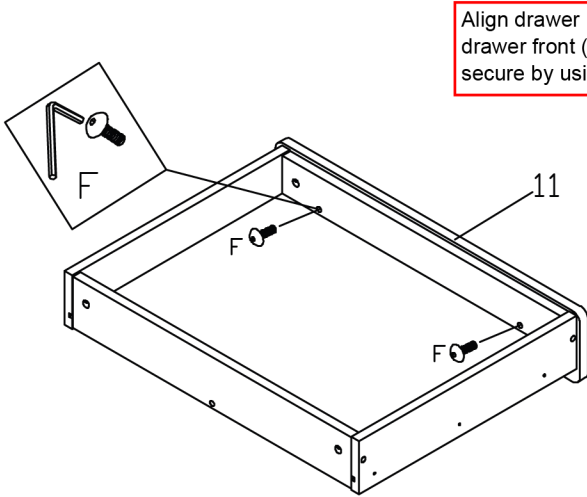

2X

F



M6*20
QTY:4

32

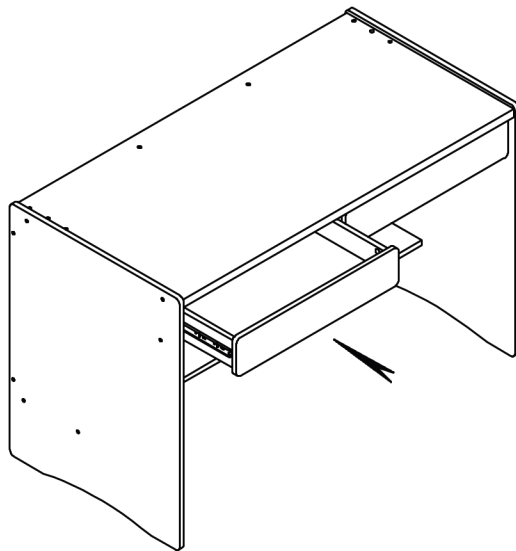

ASSEMBLY INSTRUCTIONS

33

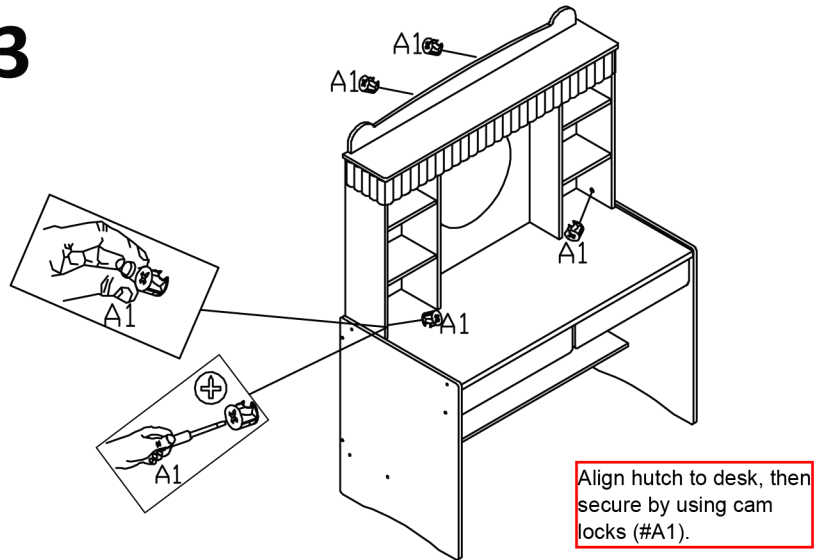

A1



ø15
QTY:4

34

ASSEMBLY COMPLETED



Please ensure the furniture rests on an even and flat surface. If the product wobbles or feels loose, double-check all bolts and/or screws are properly tightened and secured.



Keep this handy!

Please retain this instruction manual and any order-related information for future reference.

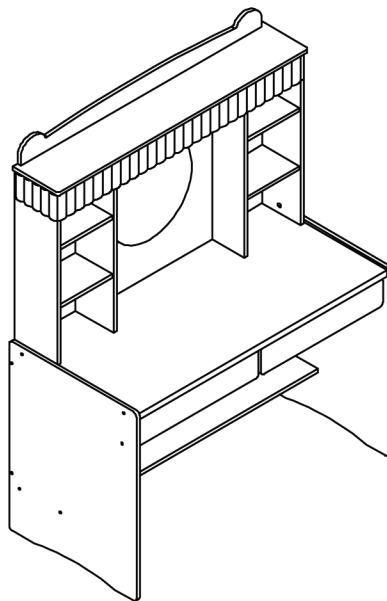

Additional Information

- User Age: 72 Months Or Above.
- Standard Of Paint: EN1725:1998
EN1022:2005
EN71-1:2014
EN71-3:2013+A1:2014

IMPORTANT, RETAIN FOR FUTURE REFERENCE: READ CAREFULLY

- Information regarding maintenance
Use dry, clean & soft cloth rub on the surface regularly; must not use any wet cloth, hardware or any hard material (such as keys, knife, sand-paper) rub on the surface. Keep away from water and any chemical substances.
- Conditions for use of the product domestic
- Installation only to be carried out by a competent person
- Article consists swallowable small parts, children ≤ 3 years should not be without parental guidance (surveillance or monitoring)
- Screw lock must be inserted before joining
- For the safety reason all of the hardware must be screwed tidely.
- This Product must be assembled by adult
- To avoid surface damage, tight all serew must not use over 5Nm power.