



Pro Low-Profile Wall Ventilation Hoods

With standard features like heat sentry and dual setting halogen lighting, Wolf pro wall hoods provide the ultimate in ventilation. Pro low-profile wall ventilation hoods are available in four widths.



Model PW362210 shown.

FEATURES

- Stainless steel finish.
- Heavy-duty, 16-gauge brushed stainless steel with continually welded seams, hemmed edges and sides.
- Stainless steel enclosed liner.
- Recessed easy-access controls.
- Infinite-speed blower control.
- Heat sentry feature automatically turns unit on when heat is sensed and automatically adjusts blower speed.
- Halogen lighting with two settings.
- Removable, dishwasher-safe, restaurant-grade stainless steel baffle filters.

MODEL OPTIONS

Model	PW302210	PW362210	PW422210	PW482210
Overall Width	30"	36"	42"	48"

BLOWER OPTIONS

		INTERNAL				IN-LINE		REMOTE			
CFM		500	600	900	1200	600	1100	600	900	1200	1500
PW302210	PW362210	•				•		•	•		
PW422210	PW482210					•		•	•		

ACCESSORIES

- Internal, in-line and remote blowers (refer to chart above).
- 38" high stainless steel backsplash with or without warming racks.
- 6", 12", 18", 24" and 30" stainless steel duct covers.
- Transitions for 8" and 10" round duct.
- Recirculating kit (30" and 36" wide hoods).

Accessories are available through your authorized Wolf dealer. For local dealer information, visit the find a showroom section of our website, wolfappliance.com.



Model PW362210 Pro Wall Hood



Recessed controls.



Baffle filters.



Pro Low-Profile Wall Ventilation Hoods

OVERALL DIMENSIONS

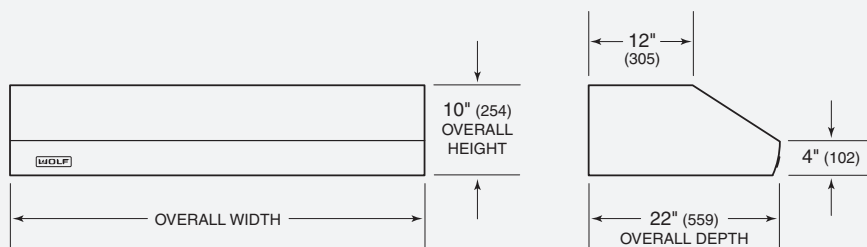

Unit dimensions may vary by $\pm 1/8$ ".

SPECIFICATIONS

Exterior Finish	Stainless Steel
Overall Widths	30", 36", 42" and 48"
Overall Height	10"
Overall Depth	22"
Bottom of Hood to Countertop	30" to 36"
Discharge	Vertical or Horizontal
Duct Size (recommended)	10" Round*
Electrical Requirements	110/120 V AC 60 Hz, 15 amp dedicated circuit
Shipping Weight	39–55 lbs

*Duct size may vary based on blower and transition used.

INSTALLATION NOTES

Low-profile wall hoods are sold as a shell only. An internal, in-line or remote blower is required. For blower recommendations, visit our website, wolfappliance.com.

Pro low-profile wall ventilation hoods are recommended for use with all Wolf cooking appliances.

IMPORTANT NOTE: For optimal performance, a pro 27" deep wall hood is recommended for use with ranges and rangetops that contain a charbroiler or griddle.

Complete installation specifications can be found on our website, wolfappliance.com.

INSTALLATION SPECIFICATIONS

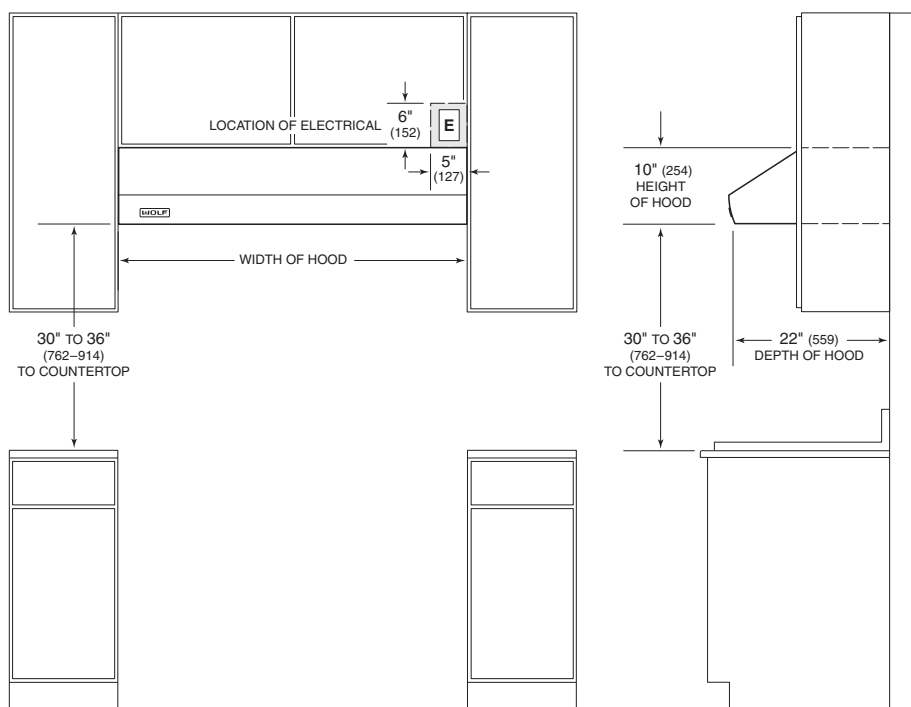

NOTE: Pro low-profile wall hoods have an adjustable discharge.

Dimensions in parentheses are in millimeters unless otherwise specified.