

AFRA UPHOLSTERED BED QUEEN ASSEMBLY INSTRUCTIONS



BOX#1

A. HEADBOARD PANEL
E. LEG

1 PC
2 PCS

A

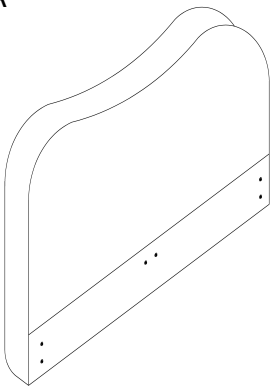

E

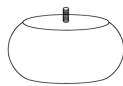

HARDWARE KIT PACKED IN BOX#1

1	FLAT WASHER (8mm)		2 PCS
2	LOCK WASHER(8mm)		2 PCS
3	HEX NUT (8mm)		2 PCS
4	WRENCH (8mm)		1 PC

HARDWARE KIT PACKED IN BOX#2

5	ALLEN BOLT (6 × 40mm)		3 PCS
6	PHILLIPS SCREW (7 × 35mm)		4 PCS
7	FLAT WASHER (8mm)		2 PCS
8	FLAT WASHER (6mm)		3 PCS
9	LOCK WASHER(6mm)		2 PCS
10	HEX NUT (8mm)		2 PCS
11	WRENCH (8mm)		1 PC
12	ALLEN KEY (8mm)		1 PC

BOX#2

B. LEFT SIDE RAIL
C. RIGHT SIDE RAIL
D. FOOTBOARD
E. LEG
F. SUPPORT LEG
G. CENTER SLAT SUPPORT
H. SLAT ROLL

1 PC
1 PC
1 PC
2 PCS
3 PCS
1 PC
1 SET

B

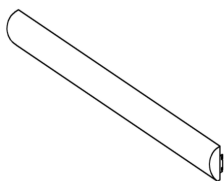

C

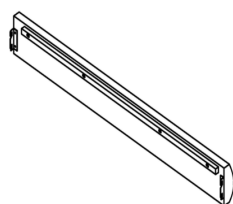

D

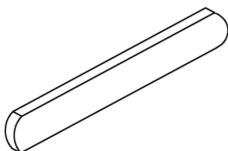

E

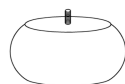

F



G

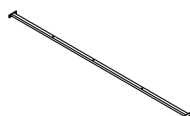

H

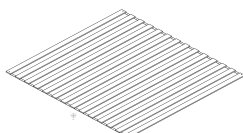

FULLY ASSEMBLED

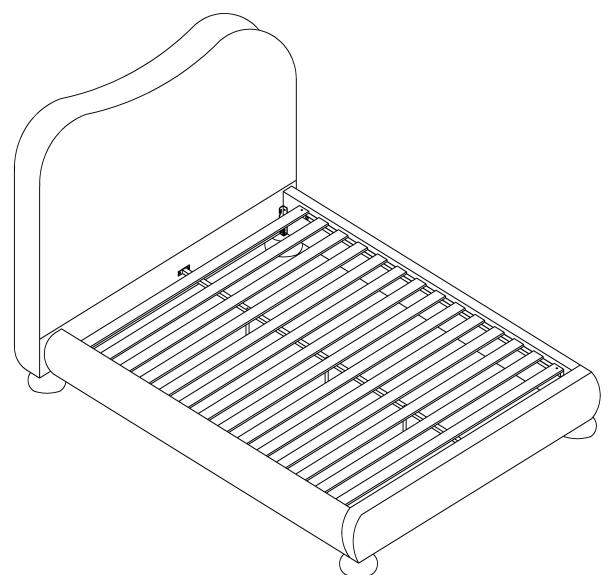

AFRA UPHOLSTERED BED QUEEN ASSEMBLY INSTRUCTIONS



STEP 1

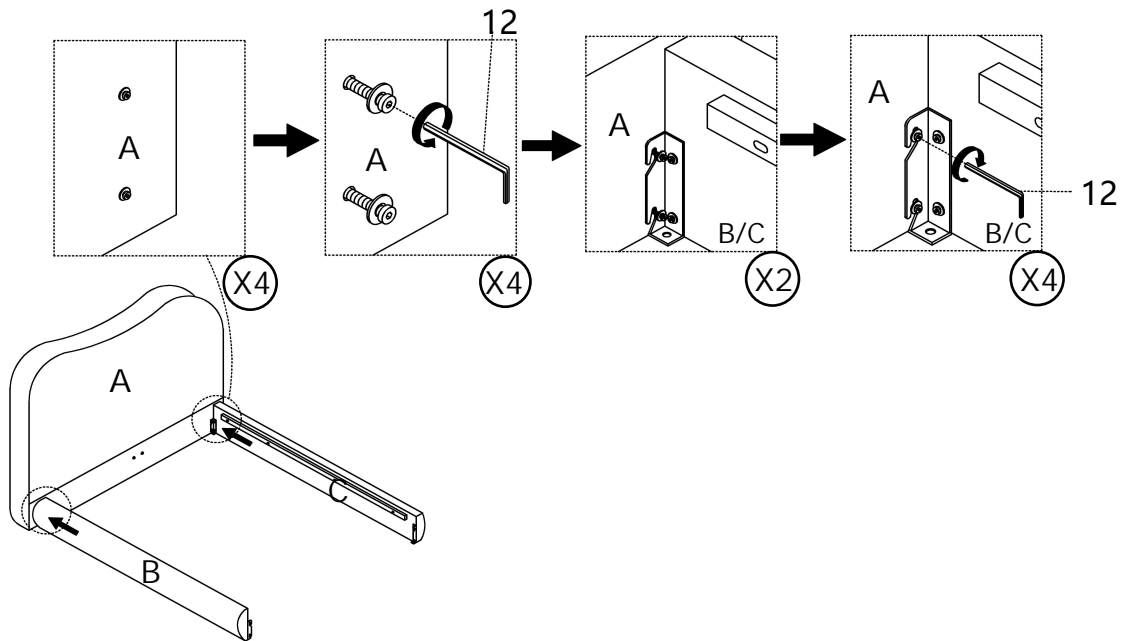

STEP 2

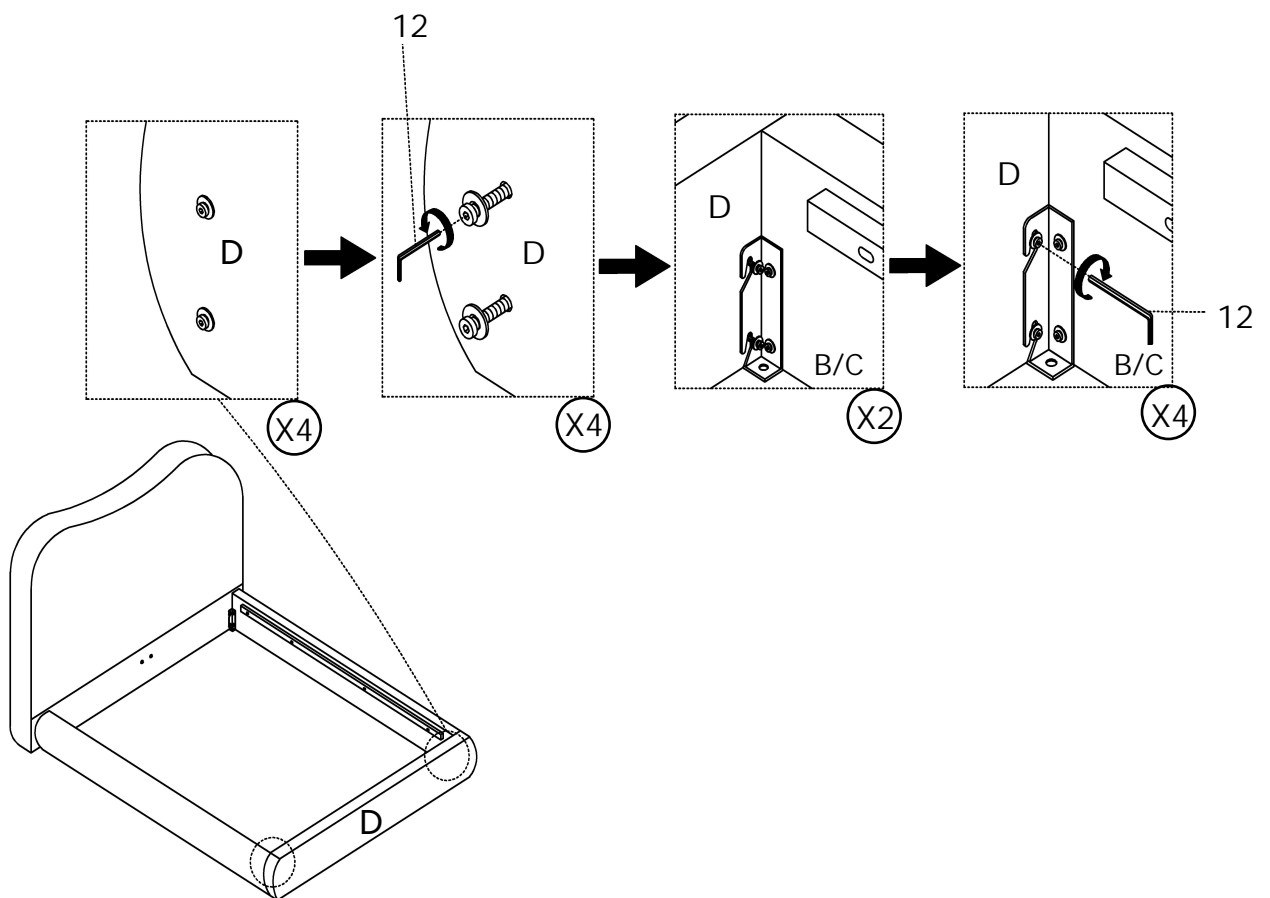

AFRA UPHOLSTERED BED QUEEN ASSEMBLY INSTRUCTIONS



STEP 3

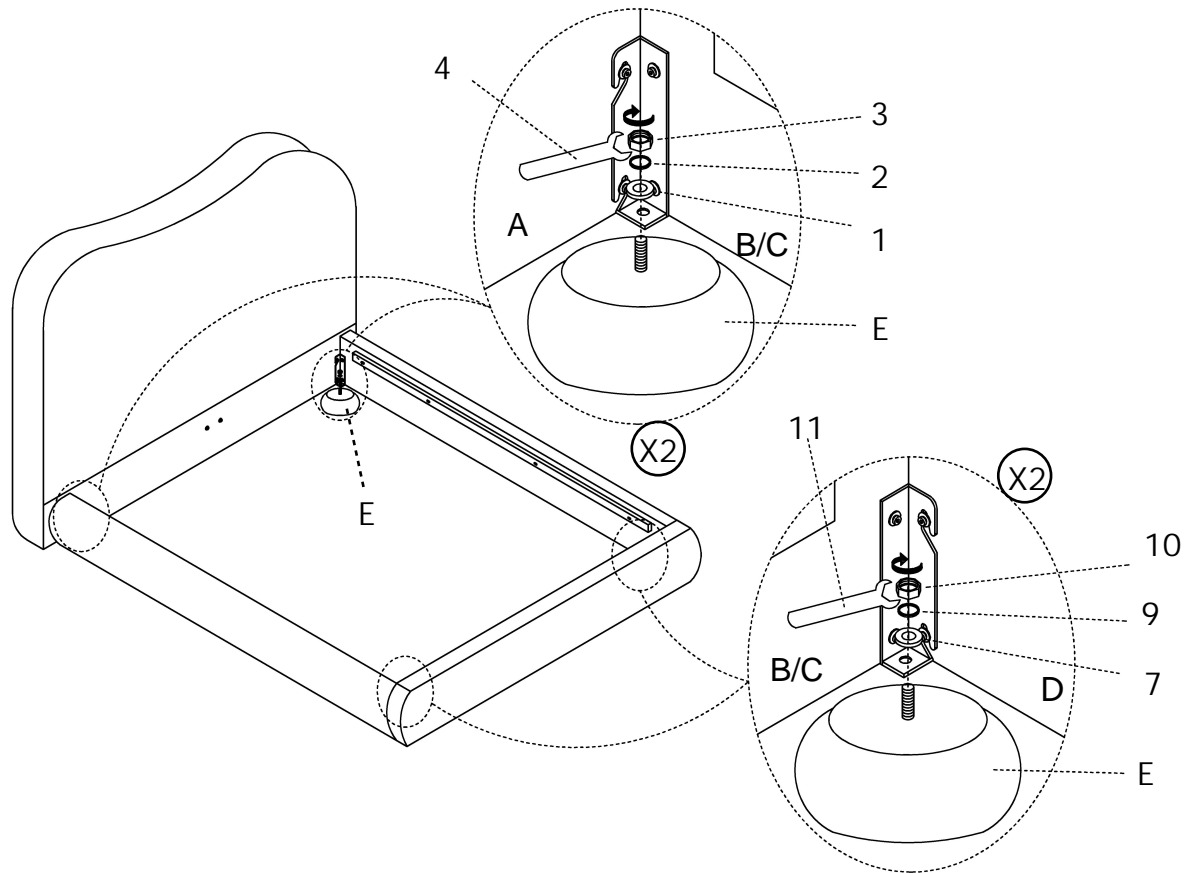

STOP IF USING BED WITH AN ADJUSTABLE MATTRESS BASE, SKIP STEPS 4, 5&6 AND REFERENCE APPENDIX A: ADJUSTABLE MATTRESS BASE ASSEMBLY SUPPLEMENT.
IF USING BED FRAME WITH STANDARD BOX SPRING OR FOUNDATION, CONTINUE TO STEP 4.

STEP 4

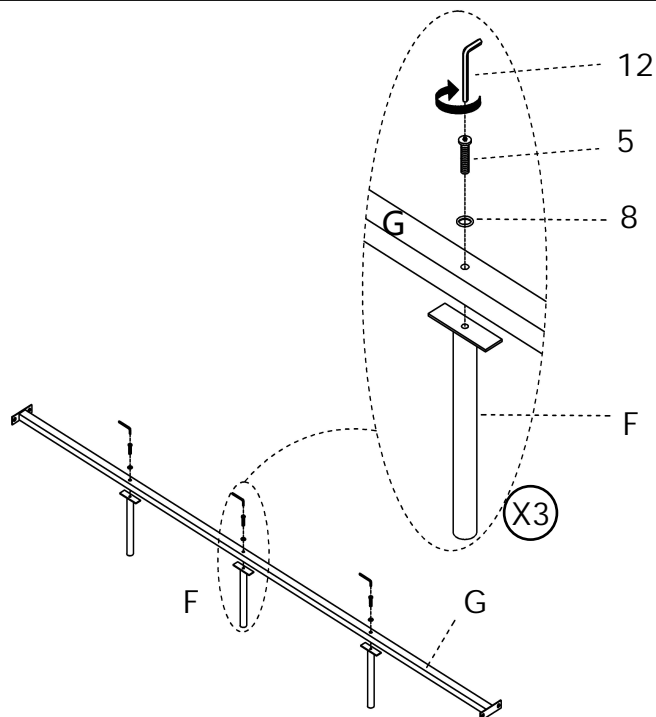

AFRA UPHOLSTERED BED QUEEN ASSEMBLY INSTRUCTIONS



STEP 5

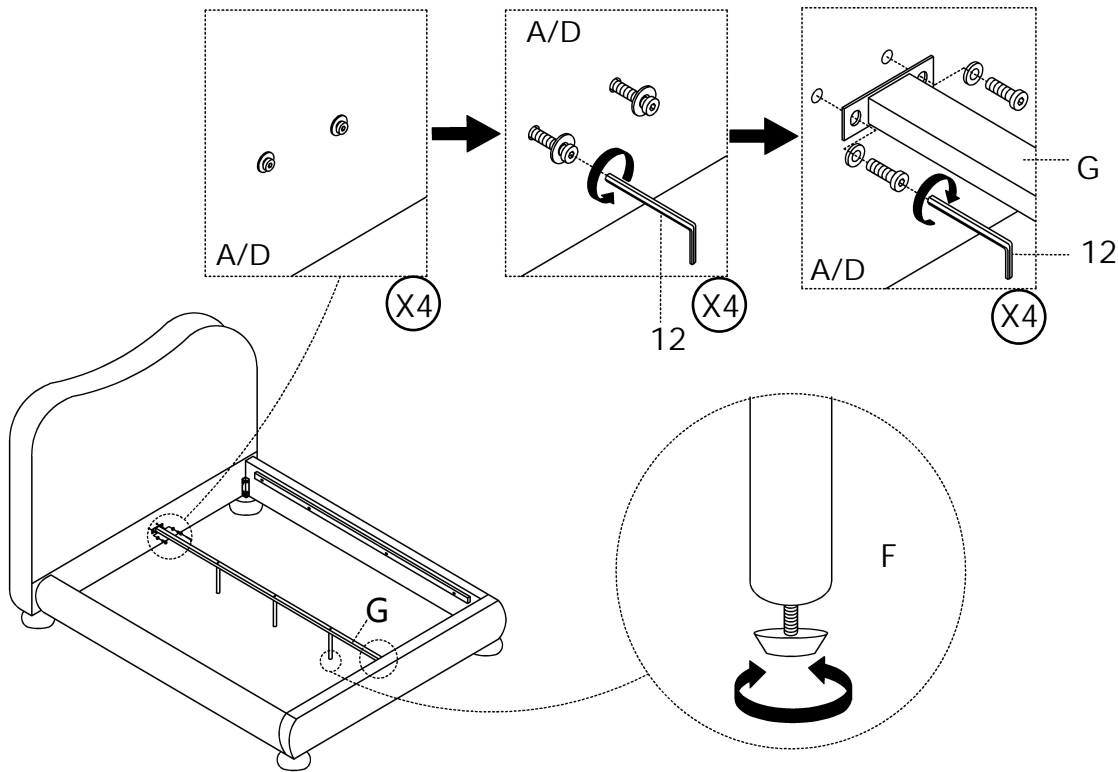

STEP 6

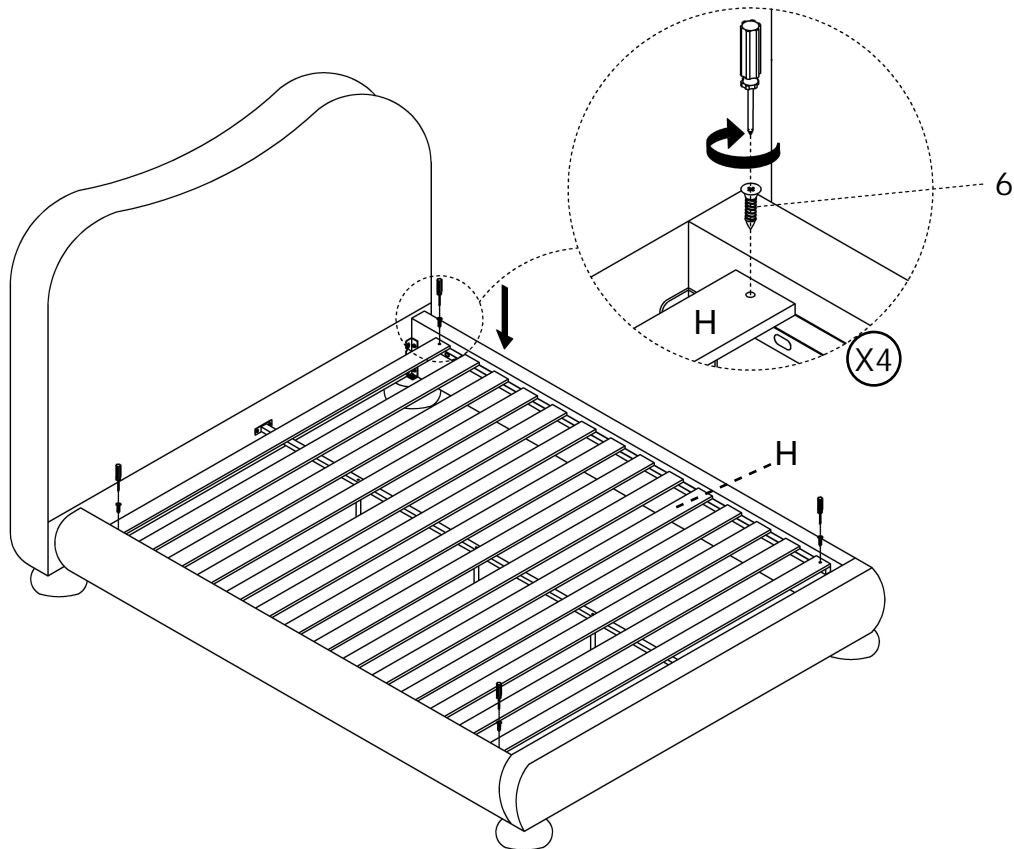

AFRA UPHOLSTERED BED QUEEN ASSEMBLY INSTRUCTIONS

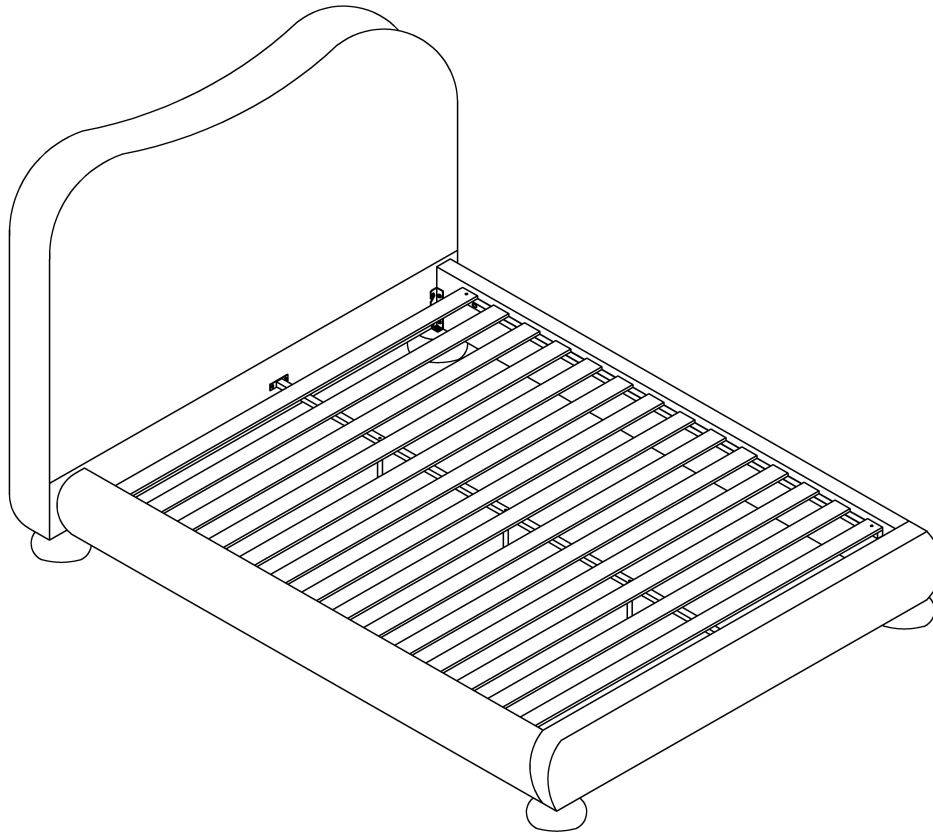

ASSEMBLY COMPLETE.

INSTRUCTIONS FOR ADJUSTING LEVELERS:

POSITION THE BED IN YOUR ROOM.
LOCATE LEVELERS UNDER EACH
SUPPORT LEG (F).

TURN COUNTER-CLOCKWISE TO
EXTEND, CLOCKWISE TO RETRACT.

ADJUST LEVELERS UNTIL EACH LEG
SUPPORT IS APPLYING EQUAL UPWARD
PRESSURE ON THE CENTER SLAT.

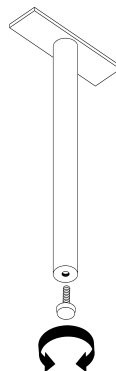

MAINTENANCE INSTRUCTIONS:

- PERIODICALLY CHECK ALL FITTINGS AND TIGHTEN IF NECESSARY, AS THEY CAN LOOSEN OVER TIME.
- ALWAYS REMOVE BOX SPRING AND MATTRESS BEFORE MOVING THE BED.
- LIFT THE BED WHEN MOVING IT. DRAGGING THE BED CAN DAMAGE THE CENTER SUPPORT.
- READJUST LEVELERS AFTER MOVING THE BED.

AFRA UPHOLSTERED BED QUEEN ASSEMBLY INSTRUCTIONS



APPENDIX A:ADJUSTABLE MATTRESS BASE ASSEMBLY SUPPLEMENT

AN ADJUSTABLE MATTRESS BASE IS A FREESTANDING MATTRESS SUPPORT THAT SITS WITHIN THE PERIMETER OF THE BED FRAME.

IF USING THIS BED FRAME WITH A STANDARD BOX SPRING OR FOUNDATION THESE INSTRUCTIONS DO NOT APPLY.

PRE-ASSEMBLED SIDE RAIL CLEATS OBSTRUCT ADJUSTABLE BASE INSTALLATION AND OPERATION. FOLLOW THESE INSTRUCTIONS TO REMOVE THEM.

THE FOLLOWING PARTS ARE NOT REQUIRED FOR ADJUSTABLE MATTRESS BASE INSTALLATION:

F. SUPPORT LEG	3 PCS
G. CENTER SLAT SUPPORT	1 PC
H. SLAT ROLL	1 SET

STEP 1 :

USE ALLEN KEY (12) TO UNSCREW ALLEN BOLTS
AND REMOVE PRE-ASSEMBLED SIDE RAIL
CLEATS.

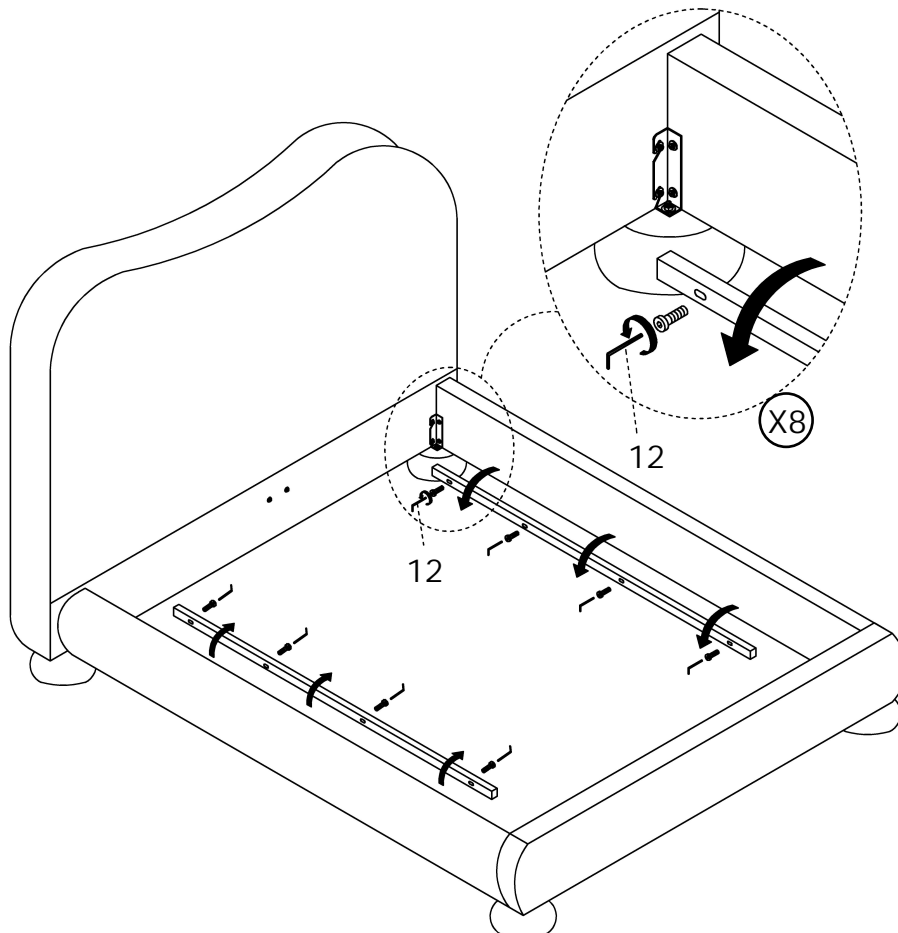

NOTE: YOU MAY WISH TO RETAIN UNUSED PARTS
IF IN THE FUTURE YOU INTEND TO USE THE BED FRAME
WITH A STANDARD BOX SPRING OR FOUNDATION.