

Disney · PIXAR

**TOY  
STORY**

# SPACE RANGER LASER GAUNTLET

## INSTRUCTIONS

Keep these instructions for future reference as they contain important information.

### 1 CONTENTS

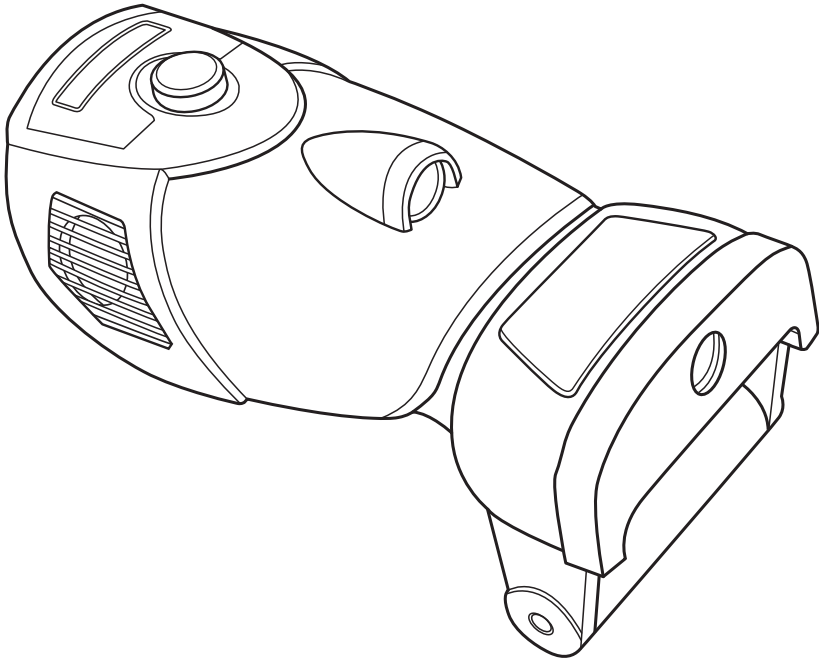

©2026 Mattel. ® and ™ designate U.S. trademarks of Mattel, except as noted.

©Disney/Pixar

[www.Disney.com](http://www.Disney.com)



RECYCLED  
Packaging made from  
recycled material  
FSC® C162170

? [service.mattel.com](http://service.mattel.com)

JKV42-0971  
1103510208-DOM

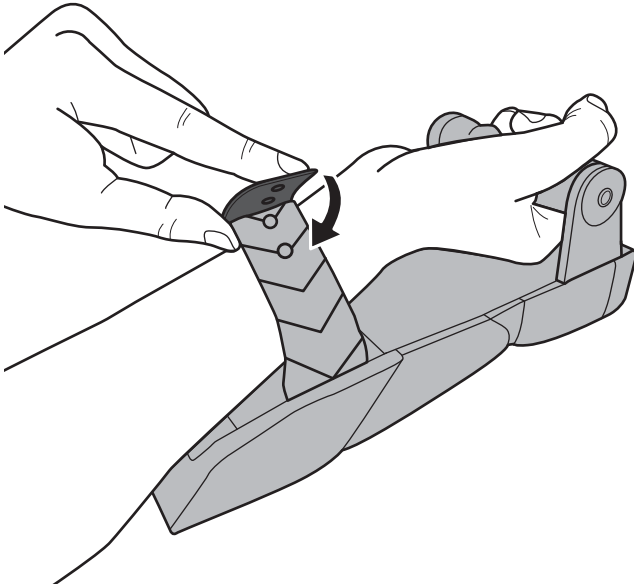
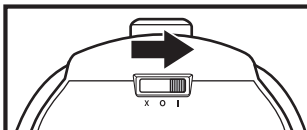

**A. Attach gauntlet to wrist and adjust the fit.****B. Slide power switch to I (ON).**

I = ON  
O = OFF  
X = TRY ME

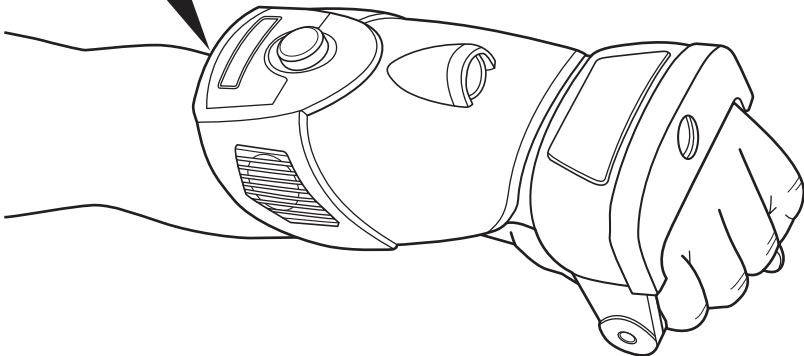

**C. Press button to activate the gauntlet's lights, sounds and vibrations.**

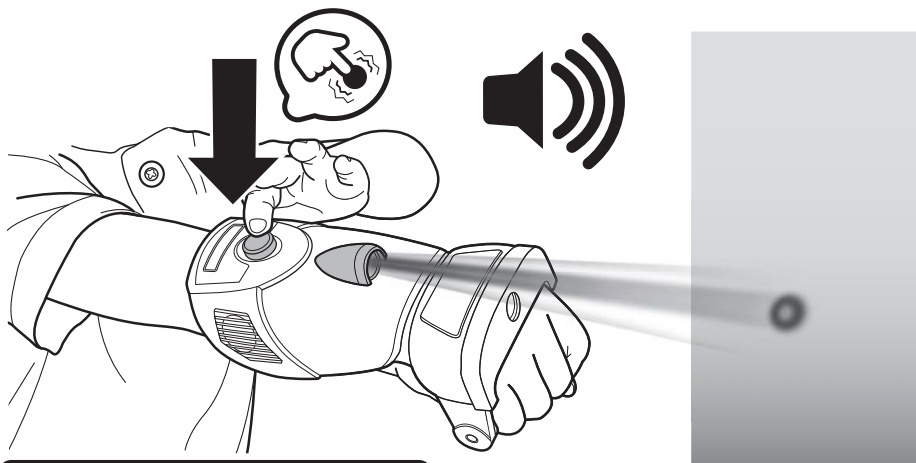

**TIP:**

Light effects work better in low-light environments.

## WAYS TO BLAST

**1**



**Press the button again for a short blast sound and effects.**

**2**

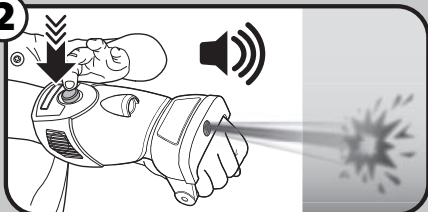

**Press the button repeatedly for quicker blast sounds and effects.**

**3**



**Press and hold the button for missile launch sounds and effects.**

# 3

## BATTERY REPLACEMENT

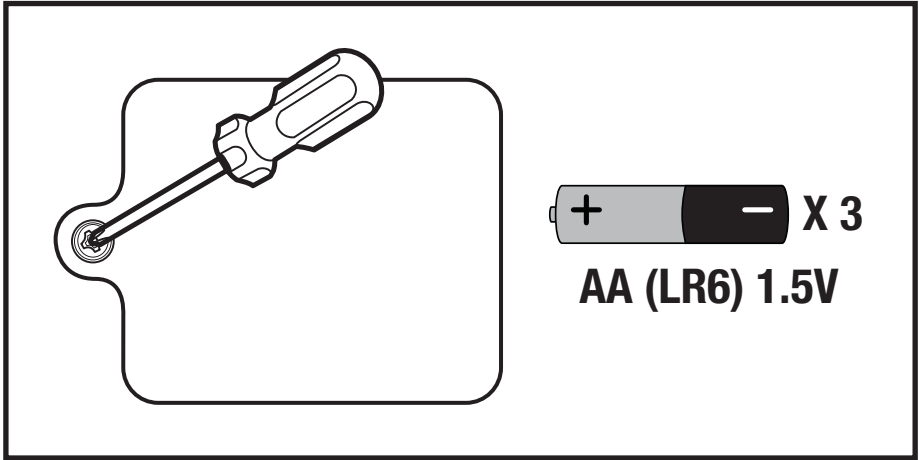

- Batteries included are for demonstration purposes only.
- Replace the batteries if lights dim or sounds distort or if vibrations weaken.
- Unscrew the battery cover with a Phillips head screwdriver (not included).
- Remove batteries and dispose of them safely.
- Install 3 new AA (LR6) 1.5V alkaline batteries in the battery box.
- Replace battery cover and tighten screw.
- For best performance, use only alkaline batteries.
- When exposed to an electrostatic source, the product may malfunction.  
To resume normal operation, slide the power switch off for a few seconds and then on again, or remove and reinstall the batteries.

**NOTE:** This product is equipped with an automatic shut-off feature that helps preserve battery life.