



By The Makers Of **AtomicBeam**®



QUICK START GUIDE

SEE INSTRUCTION MANUAL FOR FULL INSTRUCTIONS
AND IMPORTANT SAFETY INFORMATION.

PRODUCT COMPONENTS

A. Power/Record Button

B. Indicator Light

C. Camera Lens

D. Night Mode Bulbs

E. Memory Card Port

F. Charging Port

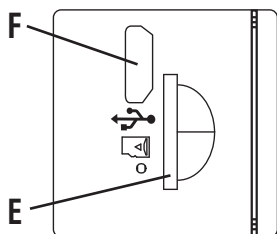
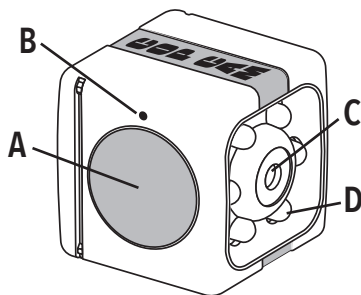

POWER ON/OFF

To Power On:

To turn on press and hold
POWER/RECORD button for
4 seconds.

To Power Off:

To turn off press and hold
POWER/RECORD button for
4 seconds.

GETTING STARTED

STEP 1: To turn on press and hold **POWER/RECORD** button for 4 seconds. (Figure A) LED light will illuminate solid red. Cop Cam™ will start recording video when motion is detected. Ensure Cop Cam™ is oriented as shown so video is upright. (Figure B)

STEP 2: To switch to photo mode press and hold the **POWER/RECORD** button for 2 seconds. LED light will illuminate solid green. To take a photo quickly press the **POWER/RECORD** button once.

STEP 3: To retrieve footage, remove memory card by pressing inward to release, then pull out of slot. (Figure C) Use included USB cable to connect Cop Cam™ to your Computer/Laptop. Access footage following prompts. (Figure D)

STEP 4: To charge Cop Cam™, plug into computer/laptop. LED light will alternately flash red and green. (Figure D)

FIGURE A

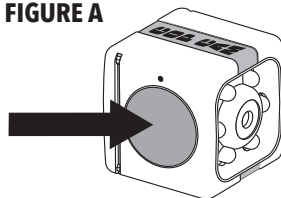

FIGURE B

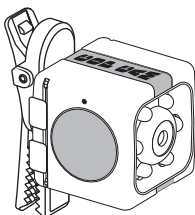

FIGURE C

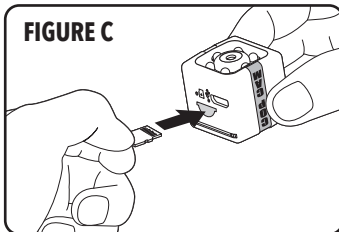
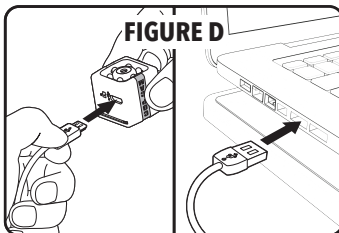

FIGURE D



See instruction manual for additional camera use information
& how to use wall mount/table stand & swivel clip.