

# 6 Leg Bed Frame Assembly

USE WITH MODELS: SQKG6, DQKG6, DQKSG6, DQKRR6

**NEED HELP?**

1-800-444-8444

warranty@risehome.com

## INCLUDED PARTS

### ALL MODELS

Side Rail Assembly with Cross Arms  
2 pcs

Extender Rails  
2 pcs

End Caps  
2 pcs

Center Rail  
1 pcs

Screws

Nuts

FOR MODEL SQKG6,  
DQKG6

Glides  
6 pcs

FOR MODEL DQKSG6

Plastic Sockets  
4 pcs

Spin Glides  
4 pcs

Glides  
2 pcs

FOR MODEL DQKRR6

Plastic Sockets  
4 pcs

Rollers  
4 pcs

Glides  
2 pcs

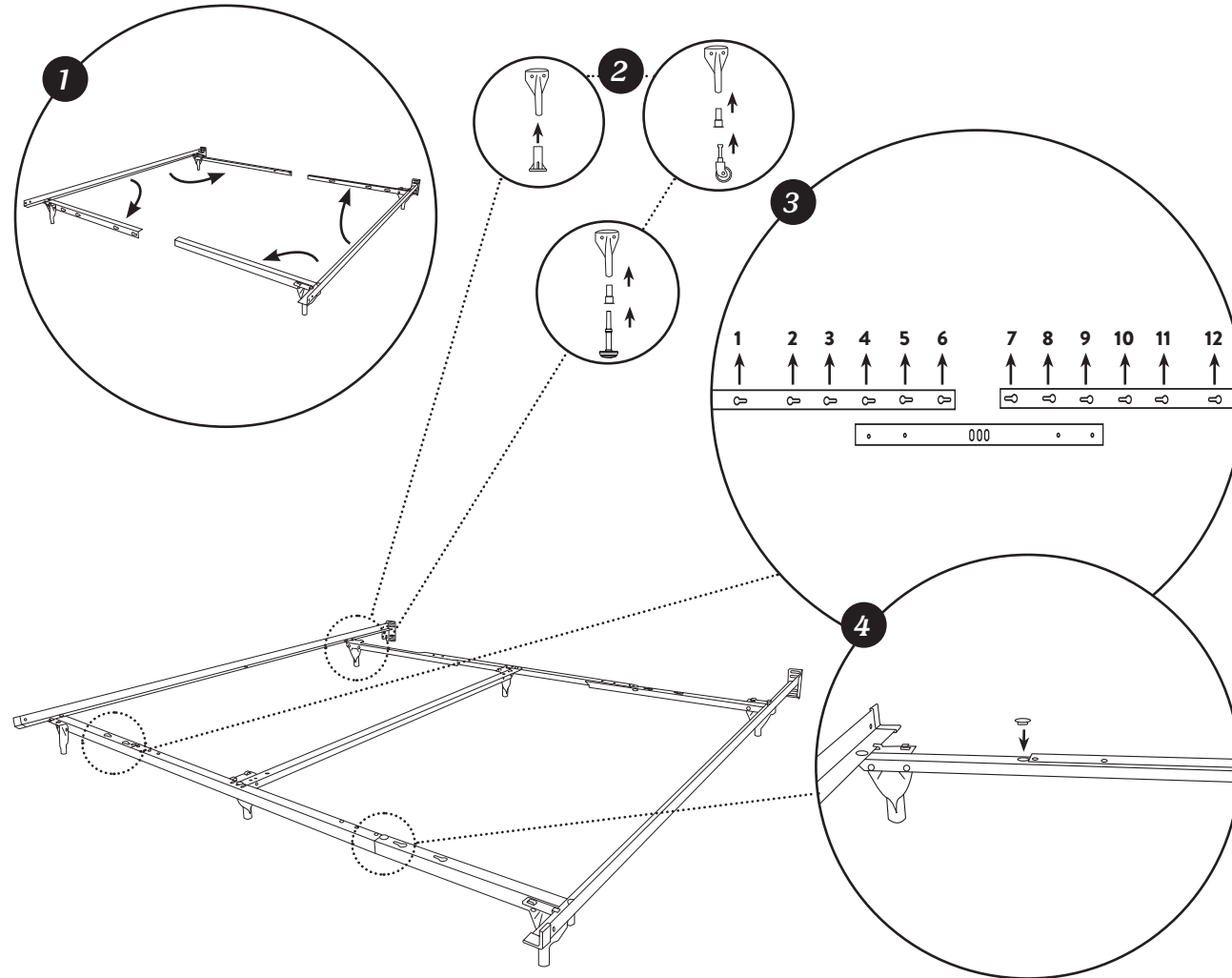

1. Set side rail assemblies out with the headboard brackets on the same end. Swing out cross rails from the side rails to a 90° angle.
2. Depending on the model purchased, install glides **OR** rollers with plastic sockets **OR** spin glides with plastic sockets onto the legs.
3. Locate the keyholes on the cross arms needed for your appropriate size bedding.  
  
**QUEEN:** Keyhole 1, 2, 11, 12  
  
**CAL-KING:** Keyhole 3, 5, 8, 10  
  
**KING:** Keyhole 4, 6, 7, 9
4. Insert rivets on extender rail into selected keyholes. Slide arms away from each other to lock the position. Then insert plug lock into keyhole at the end of the overlap. Repeat on the other end of the frame.

**CONTINUE TO NEXT PAGE →**

SHOWN FOR REFERENCE: KING SIZE

REV: 01.05.24



# 6 Leg Bed Frame Assembly

USE WITH MODELS: SQKG6, DQKG6, DQKSG6, DQKRR6

**NEED HELP?**

1-800-444-8444

warranty@rizehome.com

## INCLUDED PARTS

### ALL MODELS

Side Rail Assembly with Cross Arms  
2 pcs

Extender Rails  
2 pcs

End Caps  
2 pcs

Center Rail  
1 pcs

Screws

Nuts

FOR MODEL SQKG6,  
DQKG6

Glides  
6 pcs

FOR MODEL DQKSG6

Plastic Sockets  
4 pcs

Spin Glides  
4 pcs

Glides  
2 pcs

FOR MODEL DQKRR6

Plastic Sockets  
4 pcs

Rollers  
4 pcs

Glides  
2 pcs

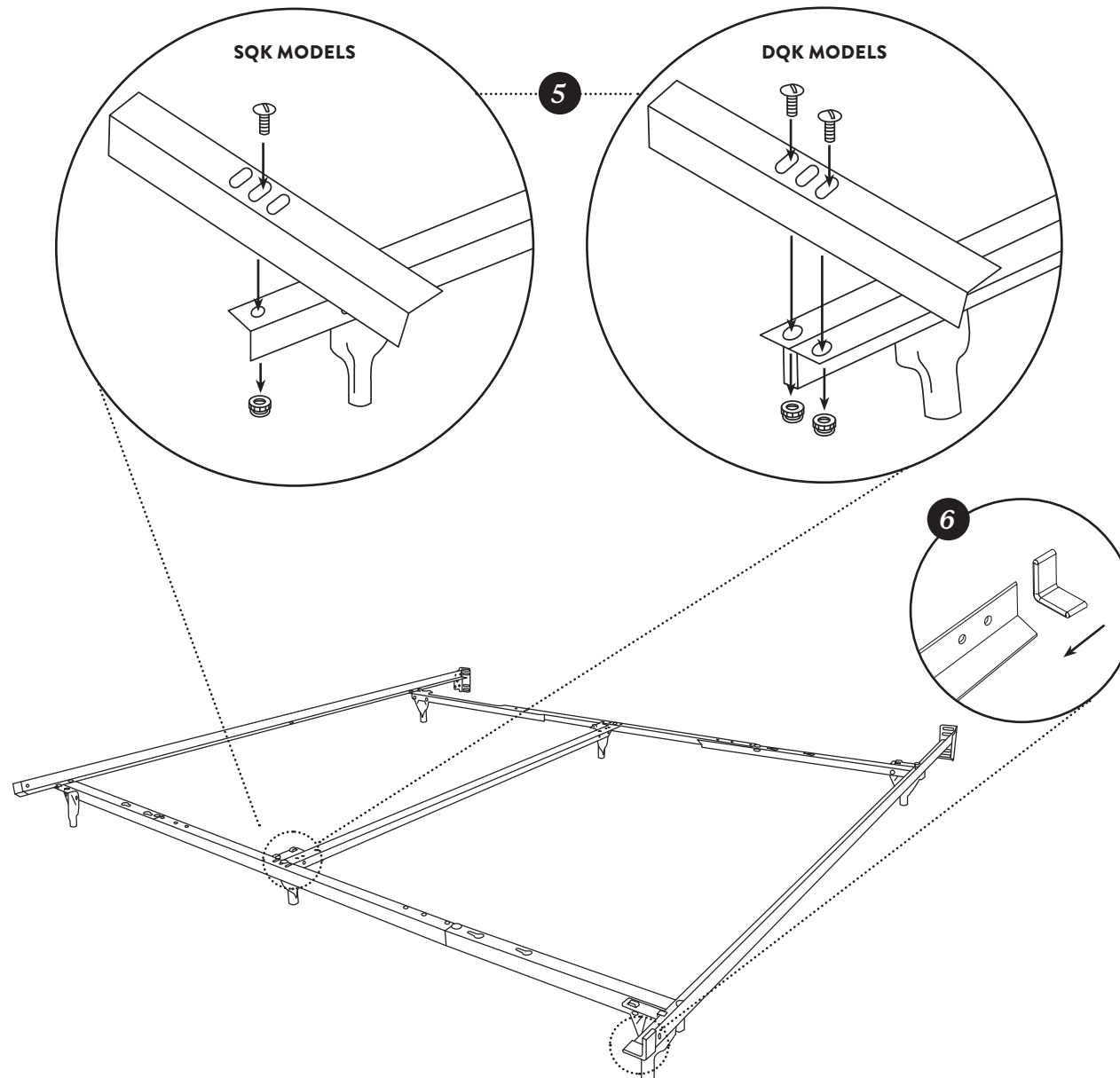

5. Attach each end of center rail to the extender rails using screws and nuts. First, select the correct holes on the extender rails, which will be determined by your frame model.

### CENTER RAIL INSTALL:

Insert a screw through the holes at the end of the center rail and the end holes in the extender rail. Center rail should run head to foot. Secure with nut. See figure 5 for model references. Repeat on the other end.

6. Slip the end caps over the foot ends of the side rails. Your bed frame is now ready to use.

SHOWN FOR REFERENCE: KING SIZE

REV: 01.05.24