

# Stereo Turntable System

## Operating Instructions

In this Operating Instructions, PS-LX5BT is used for illustration purposes unless when otherwise indicated. PS-LX5BT and PS-LX3BT have different headshell shapes, but the operating procedure is the same.

© 2025 Sony Corporation  
Printed in China / Imprimé en Chine



PS-LX5BT/ PS-LX3BT

Model: YY2098C/ YY2097C

### Owner's Record

Record the model and serial numbers in the spaces provided below and store them safely. Refer to them whenever you call your Sony dealer regarding this product.

Model No. \_\_\_\_\_

Serial No. \_\_\_\_\_

The model and serial numbers to be recorded are located in the following places.

- the bottom of the unit

To reduce the risk of fire or electric shock, do not expose this product to dripping or splashing, and do not place objects filled with liquids, such as vases, on the product.

The AC adaptor is not disconnected from the AC power source (mains) as long as it is connected to the wall outlet, even if the unit itself has been turned off.

As the main plug of the AC adaptor is used to disconnect the AC adaptor from the mains, connect it to an easily accessible AC outlet. Should you notice an abnormality in it, disconnect it from the AC outlet immediately.

The nameplate and important information concerning safety are attached in the following locations:

- the bottom of the unit

### For customers who purchased PS-LX5BT

This unit has been tested and found to comply with the limits set out in the EMC regulation using a connection cable shorter than 3 m.

Use only the supplied AC adaptor. To avoid damaging the unit, do not use any other AC adaptor.

### For customers in the U.S.A. and Canada Pour les clients aux États-Unis et au Canada Para clientes en EE. UU. y Canadá

You are cautioned that any changes or modifications not expressly approved in this manual could void your authority to operate this unit.

This unit must not be co-located or operated in conjunction with any other antenna or transmitter.

### NOTE:

This unit has been tested and found to comply with the limits for a Class B digital device, pursuant to Part 15 of the FCC Rules. These limits are designed to provide reasonable protection against harmful interference in a residential installation. This unit generates, uses, and can radiate radio frequency energy and, if not installed and used in accordance with the instructions, may cause harmful interference to radio communications.

However, there is no guarantee that interference will not occur in a particular installation. If this unit does

cause harmful interference to radio or television reception, which can be determined by turning the unit off and on, the user is encouraged to try to correct the interference by one or more of the following measures:

- Reorient or relocate the receiving antenna.
- Increase the separation between the unit and receiver.
- Connect the unit into an outlet on a circuit different from that to which the receiver is connected.
- Consult the dealer or an experienced radio/TV technician for help.

For customers of YY2098C.

The shielded interface cable recommended in this manual must be used with the unit in order to comply with the limits for a digital device pursuant to Subpart B of Part 15 of FCC Rules.

If you have any questions about this product: Visit: <https://www.sony.com/electronics/support> Contact: Sony Customer Information Service Center at 1-800-222-7669

Supplier's Declaration of Conformity

Trade Name: SONY

Model: YY2097C/ YY2098C

Responsible Party: Sony Electronics Inc.

Address: 16535 Via Esprillo, San Diego, CA 92127 U.S.A.

Telephone Number: 858-942-2230

This equipment complies with FCC/ISED radiation exposure limits set forth for an uncontrolled environment and meets the FCC radio frequency (RF) Exposure Guidelines and RSS-102 of the ISED radio frequency (RF) Exposure rules as this equipment has very low levels of RF energy.

### For customers in Canada

This unit contains licence-exempt transmitter(s)/ receiver(s) that comply with Innovation, Science and Economic Development Canada's licence-exempt RS(S)s. Operation is subject to the following two conditions:

- (1) This unit may not cause interference; and
- (2) This unit must accept any interference, including interference that may cause undesired operation of the unit.

### To check the firmware version of your turntable

You can check the firmware version of your turntable on the computer. When a firmware update is available, it will be provided on the Sony Support Page. Download it to perform the update.

This equipment complies with FCC/ISED radiation exposure limits set forth for an uncontrolled environment and meets the FCC radio frequency (RF) Exposure Guidelines and RSS-102 of the ISED radio frequency (RF) Exposure rules as this equipment has very low levels of RF energy.

For information on product self repair, please visit: [www.sony.com/repair-country](http://www.sony.com/repair-country)

## Names of Parts

### Top/Side

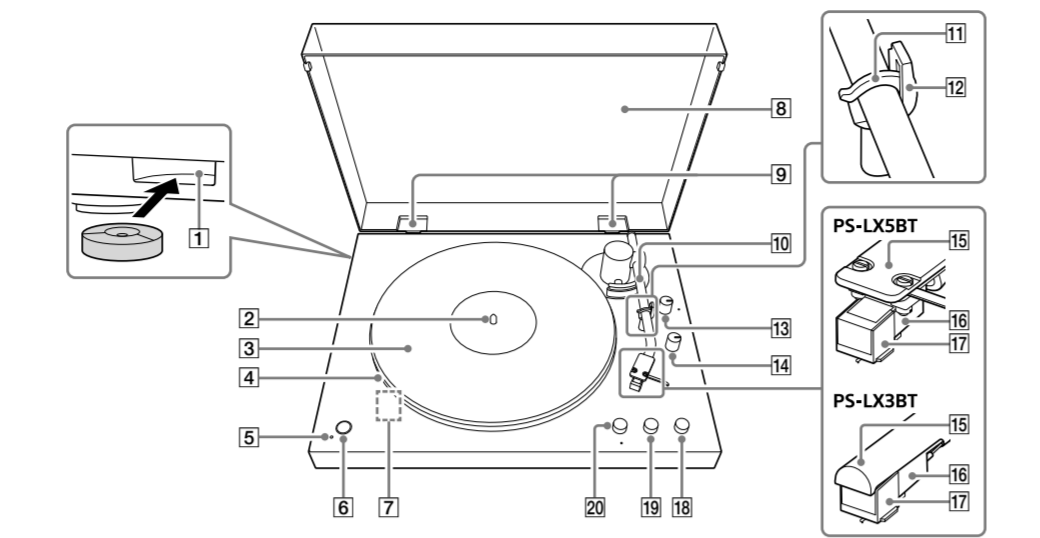

- |   |                             |
|---|-----------------------------|
| 1 Storage hole for the 45 rpm adaptor   | 8 Dust cover                |
| 2 Spindle   | 9 Dust cover hinges         |
| 3 Mat for the platter   | 10 Tone arm                 |
| 4 Platter   | 11 Tone arm lock            |
| 5 BLUETOOTH indicator   | 12 Tone arm rest            |
| Flashes rapidly in blue: Your turntable is in pairing mode.   | 13 SIZE rotary switch knob* |
| Lights up in blue: Your turntable is connected to a BLUETOOTH device.   | 14 SPEED rotary switch knob |
| Lights up in orange: Your turntable is waiting to connect to a paired device.   | 15 Headshell                |
| 6 BLUETOOTH button/PAIRING button   | 16 Cartridge body           |
| 7 Micro USB port  | 17 Stylus                   |
| The port is located inside your turntable when the platter is removed. When a firmware update is available, use a micro USB cable (not supplied) to connect a computer to the port and update the firmware. | 18 UP/DOWN button           |
| For the firmware update, also refer to "To check the firmware version of your turntable."   | 19 STOP button              |
|   | 20 START button*            |
- \* A tactile dot is provided for each of the number "12" of the SIZE rotary switch knob and the START button to assist with identification during operation.

### Back (PS-LX5BT)

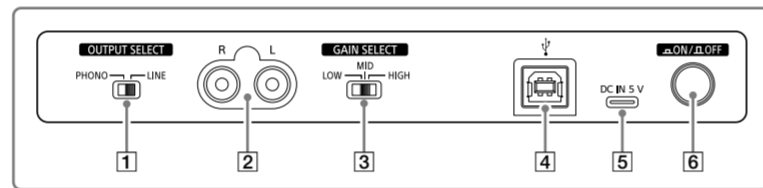

### Back (PS-LX3BT)

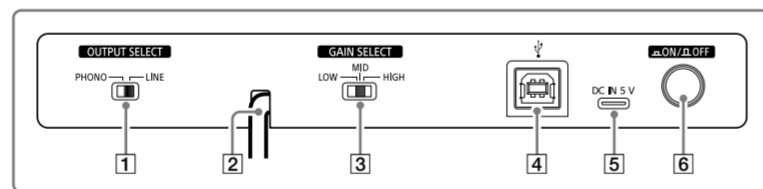

- |   |                       |
|---|-----------------------|
| 1 OUTPUT SELECT switch                                    | 4 Ψ USB port (Type B) |
| 2 Audio output jacks (PS-LX5BT)<br>Audio cable (PS-LX3BT) | 5 DC IN 5 V jack      |
| 3 GAIN SELECT switch                                      | 6 Power ON/OFF button |

**Note on carrying your turntable**  
When carrying the turntable, make sure that you hold it firmly at the bottom and sides as illustrated below. Inappropriate handling may cause the turntable to fall, resulting in malfunctions or injury.

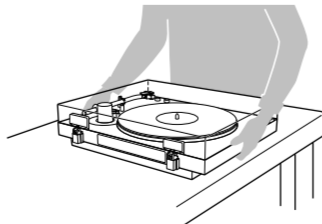

## Getting Started

### Checking the included items

- Stereo Turntable System (1)
- Platter (with drive belt) (1)

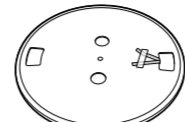

- Mat for the platter (1)

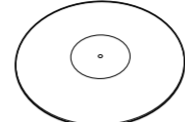

- Dust cover (1)

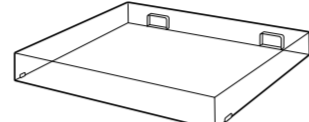

- Dust cover hinge (2)



- 45 rpm adaptor (1)  
Place the 45 rpm adaptor on the spindle to play a 7-inch (17 cm) vinyl record (EP record).

- AC adaptor (1)

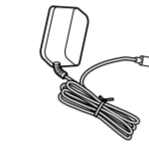

- Audio cable (1)  
Included only with PS-LX5BT



- Documents (1 set)

**Note**  
Keep the packaging materials in case you need to transport your turntable for repair.

### Assembling the Turntable

**Note**  
Place your turntable on a stable, level surface.

#### 1 Place the platter on the spindle.

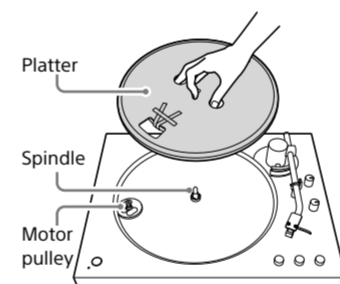

#### 2 Turn the platter to the position where you can see the motor pulley through the rectangular hole with the red ribbon ends taped on the platter.

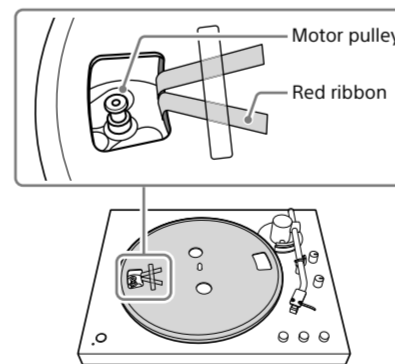

#### 3 Peel off the adhesive tape, pull and hold the red ribbon, and then hook the drive belt around the motor pulley.

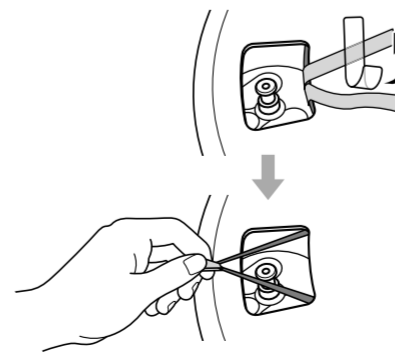

### Note

- Be careful not to twist the drive belt.
- If the drive belt comes off the inner ring of the platter during installation, remove the platter, turn it upside down, and rewrap the drive belt around the out circumference of the inner ring. Then, restart the procedure from the beginning.
- Be sure to remove the red ribbon after you place the drive belt around the motor pulley.

#### 4 Place the mat for the platter onto the platter.

If the mat has a recessed area in the center, place it with that side facing up.

#### 5 Unlock the tone arm by releasing the tone arm lock.

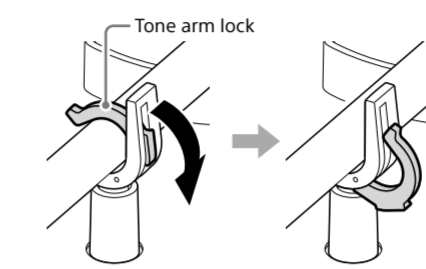

#### 6 Press the UP/DOWN button to lift the tone arm and rotate the platter 10 times to initialize the operating mechanism.

### Note

Be careful not to bump your hand against the tone arm while rotating.

After rotating the platter, press the UP/DOWN button to lower the tone arm.

#### 7 Insert the dust cover hinges to the hinge pockets on the dust cover.

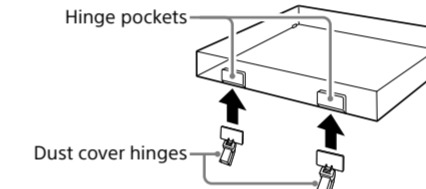

#### 8 Attach the dust cover to your turntable.

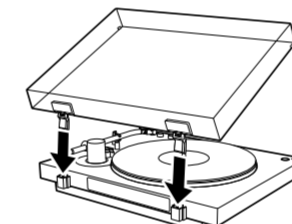

### Note

Before moving your turntable after assembly, ensure the following:

- Attach the stylus protective cover.
- Remove the platter.
- Secure the tone arm with the tone arm lock.

### Connecting Your Turntable to a Stereo System

### Note

Be sure to turn off the stereo system (amplifier) before making any connections.

### PS-LX5BT

- Ⓐ: When connecting to the PHONO input jack
- Ⓑ: When connecting to the LINE/AUX input jack or similar input

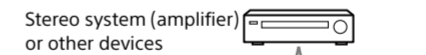

Stereo system (amplifier) or other devices

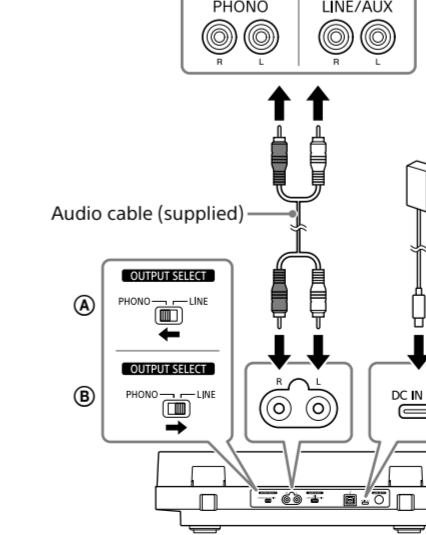

### PS-LX3BT

- Ⓐ: When connecting to the PHONO input jack
- Ⓑ: When connecting to the LINE/AUX input jack or similar input

Stereo system (amplifier) or other devices

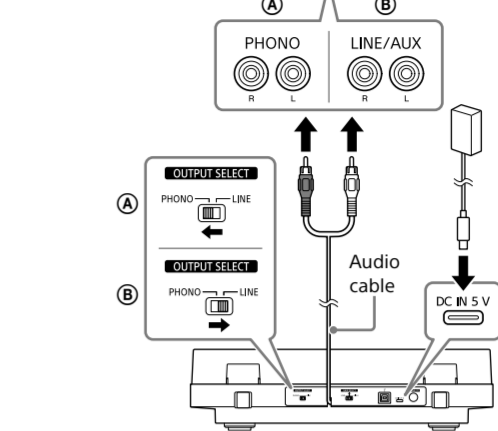

#### 1 Use the audio cable to connect your turntable and the PHONO input jack or LINE/AUX input jack on the stereo system (amplifier).

- PS-LX5BT comes with the audio cable. Use it to connect to the audio output jacks on the back. For PS-LX3BT, the audio cable comes out from the back.
- Connect the white plug of the audio cable to the white (L) jack, and the red plug to the red (R) jack.

#### 2 Move the OUTPUT SELECT switch on the back of your turntable to match the input jacks on the stereo system (amplifier).

- Ⓐ: When connecting the audio cable to the PHONO input jacks  
Move the switch to the PHONO position. The audio signal from the MM cartridge is output through the audio cable, bypassing the built-in phono equalizer amplifier. The phono equalizer amplifier of the stereo system (amplifier) is used instead.
- Ⓑ: When connecting the audio cable to the LINE/AUX input jacks or similar input  
Move the switch to the LINE position. The audio signal is output through the audio cable, processed through the built-in phono equalizer amplifier.

### Note

- If using your turntable with the BLUETOOTH connection only, ensure that the metal parts at the ends of the audio cable do not come into contact with each other or with metal parts of the rack or other devices. Move the OUTPUT SELECT switch to the LINE position before use.
- When connecting to the PHONO input jacks of the stereo system (amplifier), be sure to move the OUTPUT SELECT switch to the PHONO position. Moving the switch to the LINE position may cause damage to the amplifier or speakers.

### Playing a Vinyl Record

### Note

Turn down the volume of the stereo system (amplifier) before playing a vinyl record. When the tone arm drops and the stylus touches the record, a loud noise (such as a thump) may occur, which could cause damage to the stereo system (amplifier) or speakers. Adjust the volume only after the stylus has lowered onto the record.

#### 1 Place a vinyl record onto the platter.

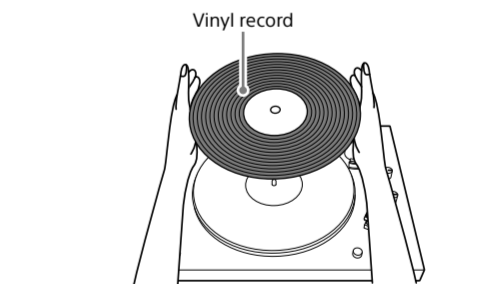

#### To play 7-inch (17 cm) vinyl records (EP records)

Place the supplied 45 rpm adaptor on the spindle to play 7-inch (17 cm) vinyl records (EP records). When you have finished using the 45 rpm adaptor, keep it in its storage hole.

#### 2 Use the SPEED rotary switch knob to select the rotation speed appropriate for the vinyl record.

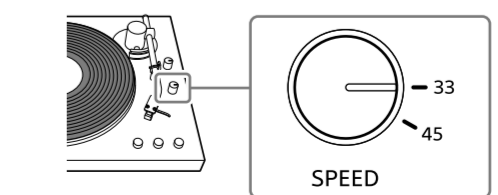

#### 3 Use the SIZE rotary switch knob to select the size of the vinyl record.

Set it to "12" for LP records, or "7" for EP records.

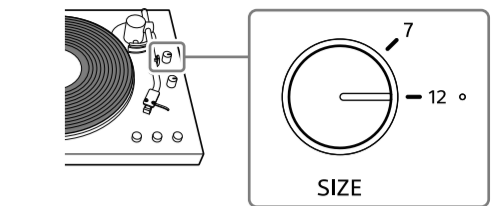

#### 4 Remove the stylus protective cover.

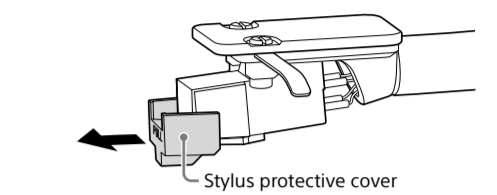

### Note

Remove the stylus protective cover with care so as not to damage the stylus.

#### 5 Unlock the tone arm by releasing the tone arm lock.

#### 6 Connect the AC adaptor to a power outlet and press the power ON/OFF button on the back of your turntable to turn on the turntable.

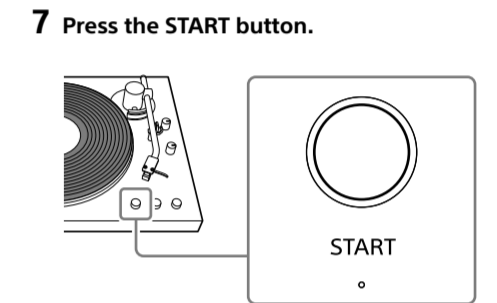

### Note

- Close the dust cover slowly to prevent vibrations that could cause the stylus to skip.
- During playback, keep your hands away from the tone arm and the spinning vinyl record.
- During playback, do not move the switches on the back of your turntable.

#### 8 Adjust the volume using the stereo system (amplifier).

### To stop playback

Press the STOP button. The tone arm returns to the tone arm rest. The platter stops rotating.

### To pause playback

Press the UP/DOWN button. The tone arm rises above the vinyl record. The platter keeps rotating.

### When playback is finished

The tone arm returns to the tone arm rest automatically, then the platter stops rotating.

### To play a different part of the vinyl record

#### 1 After performing step 6, press the UP/DOWN button to lift the tone arm.

Manually move the tone arm to the desired starting position.

#### 2 Press the UP/DOWN button to lower the tone arm.

## Using the BLUETOOTH® function

### Pairing with a BLUETOOTH device

When connecting your turntable to a BLUETOOTH device for the first time, you must pair them in advance.

**1 Place the BLUETOOTH device you want to connect as close to your turntable as possible.**

**2 Press and hold the BLUETOOTH button/ PAIRING button on your turntable for about 2 seconds, and then release it.**  
The BLUETOOTH indicator flashes rapidly in blue.

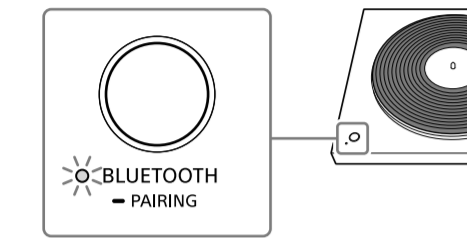

**3 Put the BLUETOOTH device into pairing mode.**

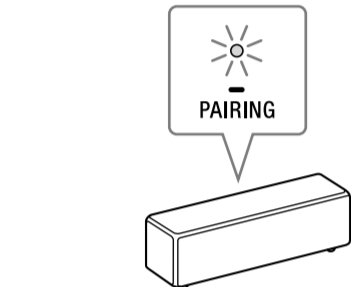

The BLUETOOTH indicator on your turntable stops flashing blue and remains lit when pairing is complete.

#### Note

If using your turntable with the BLUETOOTH connection only, move the OUTPUT SELECT switch to the LINE position on the back of the turntable before playback.

#### Tip

- Press the BLUETOOTH button/ PAIRING button to disconnect the BLUETOOTH connection. The BLUETOOTH indicator turns off.
- Your turntable can store pairing information for up to 8 BLUETOOTH devices. To delete all stored device information, press and hold the BLUETOOTH button/ PAIRING button for about 10 seconds, and then release it.

### Listening to a Vinyl Record through a BLUETOOTH device

**1 First, turn on the BLUETOOTH device and ensure it is ready to receive data via BLUETOOTH connection. Then, press the BLUETOOTH button/ PAIRING button on your turntable to enable the BLUETOOTH function.**

When the BLUETOOTH function is successful, the BLUETOOTH indicator on your turntable lights up in blue.

**2 Do steps 1 through 7 of "Playing a Vinyl Record" to play a vinyl record.**

## Recording a Vinyl Record to a Computer

You can connect your turntable to a computer using a USB cable (not supplied) and record audio tracks from a vinyl record.

#### Note

- You need to install recording software on the computer to record audio tracks. If no recording software is installed, you cannot record audio tracks, even if you connect your turntable to the computer. Prepare music recording software separately. You can also use freeware, such as Audacity®. Download Audacity from the following URL: <https://www.audacityteam.org/> Sony does not offer support for this software.
- The USB output signals are only for recording, not for playback.

### System requirements

#### Windows®

Operating systems:  
Windows 11 (64 bit)

#### Mac

Operating systems:  
macOS Ventura (13)  
macOS Sonoma (14)  
macOS Sequoia (15)

### Connecting to a computer

**1 Connect your turntable to a computer.**

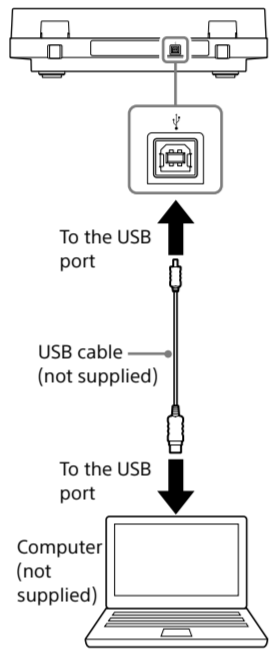

**2 Press the power ON/OFF button on the back of your turntable to turn on the turntable.**

#### Note

- Do not use a USB hub or a USB extension cable for connection.
- The audio output from your turntable is processed by the built-in phono equalizer amplifier and sent to the computer's USB port, regardless of the position of the OUTPUT SELECT switch on the back of the turntable.

### Setting up your computer

#### For Windows users

The following procedure is an example when using Windows 11 as the operating system.

**1 Click [Start], and then select [Settings] from the list of applications displayed.**

**2 Select [Sound].**

**3 Select the output of your computer from the [Output] list.**

#### Note

Selecting [USB AUDIO CODEC] sets your turntable as a device for sound output. Note that no sound will be output if you select this option.

**4 Select [USB AUDIO CODEC] from the [Input] list.**

[USB AUDIO CODEC] does not appear unless your turntable, which is connected to the computer, is turned on.

#### For Mac users

The following procedure is an example when using macOS 15 as the operating system.

**1 Select the Apple menu in the menu bar and [System Settings].**

**2 Select [Sound].**

**3 Select the [Output] tab and the output of your computer from the list of output devices.**

#### Note

Selecting [USB AUDIO CODEC] sets your turntable as a device for sound output. Note that no sound will be output if you select this option.

**4 Select the [Input] tab and [USB AUDIO CODEC] from the list of input devices.**

#### Note

- In addition to adjusting the above settings on Windows or macOS, you may also need to change the audio settings in your music recording software. In such a case, set the output device to your computer and the input source to [USB AUDIO CODEC] in the software.
- If your music recording software allows you to select the recording channel, set it to stereo.

## Maintenance

### Cleaning the Stylus

The stylus is a high-precision component. Handle it with care to avoid damage. Use a commercial cleaning product for cleaning the stylus.

### Replacing the Stylus

The stylus may become worn out, damaged, or dirty beyond cleaning depending on your use case. In such a case, replace the stylus. For a replacement stylus, consult Sony support contact or your nearest Sony dealer.

#### Note

- Do not use a replacement stylus made by another company.
- Be sure to attach the stylus protective cover before you replace the stylus so as not to harm your fingertips or damage the stylus.

#### To remove the stylus

**1 Turn off your turntable and the connected stereo system (amplifier) and unplug their AC adaptors from the power outlet.**

**2 Align the stylus protective cover with the projection (1) on the lower part of the stylus and slide it toward the back of the cartridge body (2) until it is securely in place.**

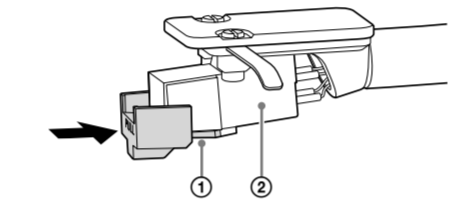

**3 Remove the stylus with the stylus protective cover attached.**

#### PS-LX5BT

- Hold the sides of the cartridge body (1) using your fingers to keep it in place.
- Place your finger of your other hand on the top of the stylus (2), then pull it down diagonally toward you and continue pulling it downward.

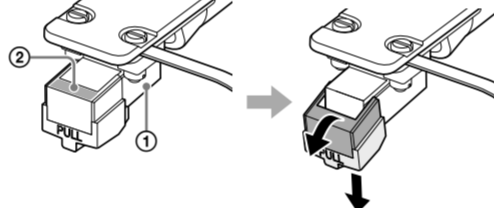

#### PS-LX3BT

- Hold the sides of the cartridge body (1) using your fingers to keep it in place.
- Hold the stylus together with the stylus protective cover from both sides using your fingers of your other hand, then pull it down diagonally toward you and continue pulling it downward.

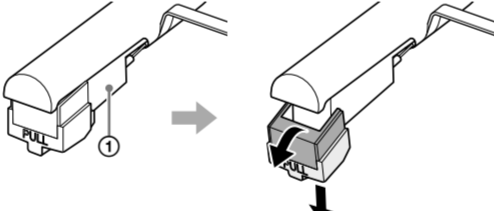

#### To attach the replacement stylus

**1 Attach the stylus protective cover to the replacement stylus.**

**2 Hold the sides of the cartridge body (1) using your fingers to keep it in place and insert the tab on the stylus into the slot on the bottom of the cartridge body from a diagonal downward angle.**

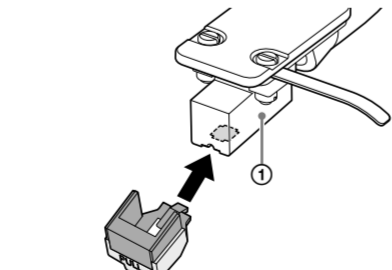

**3 Push the stylus straight up until it clicks into place.**

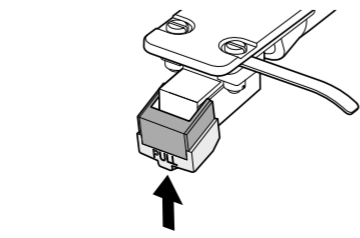

### Replacing the Drive Belt

The drive belt may deteriorate or break depending on your use case. In such a case, replace the drive belt.

For a replacement drive belt, consult Sony support contact or your nearest Sony dealer.

**1 Turn off your turntable and the connected stereo system (amplifier) and unplug their AC adaptors from the power outlet.**

**2 Remove the mat for the platter.**

**3 Unhook the drive belt from the motor pulley.**

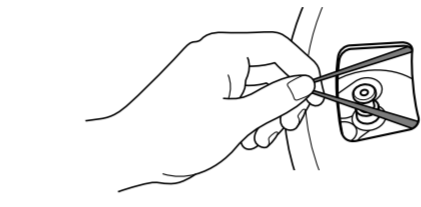

**4 Place your finger and thumb into the platter's round holes and remove it.**

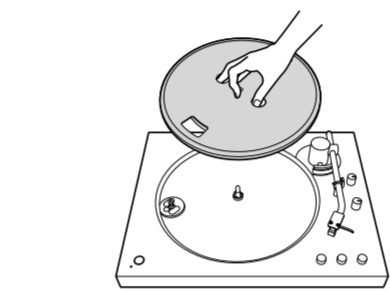

**5 Turn the platter upside down and remove the drive belt.**

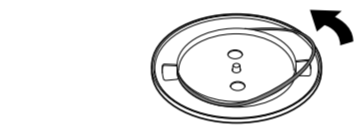

**6 Install the replacement drive belt onto the platter without twisting it.**

Follow the steps in "Assembling the Turntable" to finish assembly.

### Cleaning the Dust Cover and your Turntable Body

Use a dry, soft cloth to clean the dust cover and your turntable body.

When the dirt is difficult to remove, use a cloth dampened with a mild detergent solution. Do not use chemical agents such as alcohol, benzene, or paint thinner, as they may damage the finish.

## Specifications

### Stereo Turntable System (PS-LX5BT/ PS-LX3BT)

#### Motor/platter section

Drive system  
Belt-drive  
Motor  
DC motor  
Platter  
296 mm (11 3/4 in) dia. (aluminum die-cast)  
Speeds  
2 speeds (33 1/3 and 45 rpm)  
Wow and flutter  
0.1% (WRMS)  
S/N ratio  
When using the supplied cartridge.  
More than 50 dB (DIN-B)

#### Tone Arm

Type  
Dynamic balanced J shaped arm  
Effective arm length  
197 mm (7 7/8 in)

#### Cartridge

Type  
PS-LX5BT: MM  
PS-LX3BT: MM  
Stylus pressure  
PS-LX5BT: 2.0±0.5 g (1/14±1/64 oz)  
PS-LX3BT: 3.5±0.5 g (1/8±1/64 oz)  
Output level  
PS-LX5BT: 2.5 mV  
PS-LX3BT: 2.5 mV

#### BLUETOOTH section

Output  
BLUETOOTH Specification Power Class 2  
Maximum communication range  
Line of sight approx. 10 m (32.8 ft)  
The actual range will vary depending on factors such as obstacles between devices, magnetic fields around a microwave oven, static electricity, cordless phone use, reception sensitivity, the operating system, software applications, etc.

Frequency band  
2.4 GHz band (2.400 0 GHz - 2.483 5 GHz)

Modulation method  
FHS

Compatible BLUETOOTH profile  
A BLUETOOTH profile standardizes functions according to the characteristics of BLUETOOTH devices.

A2DP (Advanced Audio Distribution Profile)

Supported codec  
Codec is an audio signal compression and conversion format.

SBC (Subband Codec)

Qualcomm® aptX™ audio

Qualcomm® aptX™ Adaptive audio

Transmission range (A2DP)

20 Hz - 20 000 Hz (Sampling frequency 44.1 kHz)

20 Hz - 40 000 Hz (Sampling frequency aptX Adaptive 96 kHz)

USB section

Output port

Type B (USB 2.0 Plug-in power)

Power

Powered by computer (DC 5 V 100 mA)

General

Output

AUDIO OUT

Power

DC 5.0 V 2.0 A (using the supplied AC adaptor connected to AC 100 V - 240 V, 50 Hz/60 Hz power supply)

Use the supplied AC adaptor for your turntable, as other adaptors may cause a malfunction.

Power consumption

When using the supplied AC adaptor.

On (Power button is set to ON and the platter keeps rotating): 1.8 W

Low power mode (Power button is set to ON and the platter stops rotating): 0.5 W or less

This product enters low power mode immediately after rotation of the platter is stopped.

Turned off (Power button is set to OFF): 0.3 W or less

Dimensions (W × H × D)

Including projecting parts and controls (When the dust cover is attached)

Approx. 430 mm × 117 mm × 366 mm (17 in × 4 5/8 in × 14 1/2 in)

Mass

When the dust cover is attached.

PS-LX5BT: Approx. 3.6 kg (7 lb 15 oz)

PS-LX3BT: Approx. 3.5 kg (7 lb 12 oz)

Design and specifications are subject to change without notice.

## Trademarks

- Microsoft and Windows are registered trademarks or trademarks of Microsoft Corporation in the United States and/or other countries.
- Apple, Mac and macOS are trademarks of Apple Inc., registered in the U.S. and other countries and regions.
- Qualcomm aptX is a product of Qualcomm Technologies, Inc. and/or its subsidiaries.
- Qualcomm is a trademark of Qualcomm Incorporated, registered in the United States and other countries/regions. aptX is a trademark of Qualcomm Technologies International, Ltd., registered in the United States and other countries/regions.
- The BLUETOOTH® word mark and logos are registered trademarks owned by Bluetooth SIG, Inc. and any use of such marks by Sony Group Corporation and its subsidiaries is under license.
- USB Type-C® and USB-C® are registered trademarks of USB Implementers Forum.

All other trademarks and registered trademarks are trademarks or registered trademarks of their respective holders. In this manual, ™ and ® marks are not specified.

## Precautions

#### On safety

- Before operating the unit, check that the operating voltage of your unit is identical with that of your local power supply.
- Should any solid object or liquid fall into the cabinet, unplug the unit and have it checked by qualified personnel before operating it any further.
- Unplug the unit from the wall outlet if it is not to be used for an extended period of time. To disconnect the cord, pull it out by the plug. Never pull the cord itself.

#### On repacking

Keep the carton and packing materials. They provide an ideal container to transport the unit.

#### Note on recording

The recorded music is limited to private use only. Use of the music beyond this limit requires permission of the copyright holders.

#### Other notes

If you have any questions or problems concerning this unit that are not covered in this manual, please consult your nearest Sony dealer.

## Troubleshooting

When you find that your turntable is not working properly, first review the following suggestions before requesting a repair. If they do not help resolve your problem, consult Sony support contact or your nearest Sony dealer.

#### Vinyl record playback

**You do not hear any sound from the computer or stereo system (amplifier) connected via the USB port.**

- Connect your turntable to the stereo system (amplifier) with the audio cable to hear the sound.
- The USB port is used for recording to the computer with recording software. It cannot be used for audio output to the stereo system (amplifier).

**The tone arm skips or skates.**

- Your turntable may not be level. Place it on a flat, stable surface.
- The vinyl record may be dirty or scratched. Clean the surface with a commercial record cleaning product or replace the vinyl record.

**You experience sound problems.**

- If the dirty stylus is causing frequent noises, clean the stylus with a commercial stylus cleaning product. If the stylus is worn out, replace the stylus.
- If the sound pitch fluctuates, the drive belt may be worn out. Replace the drive belt.
- If the dusty vinyl record is causing frequent noises, clean the surface with a commercial record cleaning product.
- The stylus may be worn out. Replace it with a new one.

**You hear rumbling or low-frequency howling noises\*.**

Your turntable is placed too close to speakers. Move the turntable away from the speakers.

\* This phenomenon, called "acoustic feedback," occurs when vibrations that travel through the air or solid objects (such as shelves, cabinets, or the floor) from speakers are picked up by the stylus, amplified and played back through the speakers.

**You hear noises.**

- Make sure that the OUTPUT SELECT switch on the back of your turntable is in the LINE position. If the switch is in the PHONO position and the turntable is connected to any input jacks other than the PHONO input jacks on the stereo system (amplifier), noise may occur. When the OUTPUT SELECT switch is in the LINE position, do not connect the turntable to the PHONO input jacks on the stereo system (amplifier).
- Make sure that your turntable is NOT connected to a computer with a USB cable (not supplied). Keeping the USB cable connected while the turntable is also connected to a stereo system (amplifier) may cause noise.
- Noise may occur during vinyl record playback if a stereo system (amplifier) and computer are connected with a USB cable (not supplied) or audio cable (not supplied). If this happens, disconnect the computer and stereo system (amplifier).

**The sound pitch is too high or low.**

- The rotation speed may be incorrect. Set it to match the speed indicated on the vinyl record. Rotate the SPEED rotary switch knob to select "33" for 33 1/3 rpm records or "45" for 45 rpm records.
- The drive belt may be twisted. Untwist the drive belt.
- The drive belt may be worn out. Replace the drive belt.

**The sound pitch fluctuates.**

The stylus is worn out. Replace it with a new one.

**The drive belt is worn out or broken.**

Replace the drive belt. For a replacement drive belt, consult Sony support contact or your nearest Sony dealer.

**The platter does not rotate.**

- Make sure that the AC adaptor is firmly connected to a power outlet and the DC IN 5 V jack on your turntable.
- Make sure that the drive belt is completely hooked around the motor pulley.

**Playback sound is too low in volume or distorted.**

Make sure that the OUTPUT SELECT switch on your turntable is in the correct position for the type of input jacks on the connected stereo system (amplifier).

#### BLUETOOTH connections

**You cannot pair your turntable with a BLUETOOTH device.**

- If there are other devices nearby with the BLUETOOTH function enabled that you do not want to pair with, disable their BLUETOOTH function before pairing.
- During the pairing operation on your turntable, the device you do not intend to pair with may automatically turn on and pair. In this case, change the settings on the device to prevent it from turning on via BLUETOOTH connection, turn it off, and then pair with the desired device again.
- The procedure for putting the device into pairing mode differs depending on the device. For details, refer to the user's instructions supplied with the device.

**You cannot connect your turntable to the BLUETOOTH device you want to connect to.**

If there are other devices nearby with the BLUETOOTH function enabled that you do not want to connect to, disable their BLUETOOTH function before connecting.

**You cannot connect your turntable to a smartphone, TV, or computer.**

Your turntable can send data to BLUETOOTH devices using the BLUETOOTH function; however, it cannot receive data from smartphones, TVs, or computers, so it cannot be connected to them.

**The BLUETOOTH connection range is short.**

- Try the following.
- If there are other electronic devices connected to your turntable and the BLUETOOTH device, disconnect them.
- Connect your turntable to a power outlet that is not shared with a microwave oven.
- Place your turntable on a table that is not made of metal.

## Repair Services

When you find that your turntable is not working properly, first review the suggestions listed in "Troubleshooting" to determine whether your problem requires repair.

If they do not help resolve the problem, consult Sony support contact or your nearest Sony dealer.

Before you consult Sony support contact or your nearest Sony dealer, you are advised to have the following information at hand:

- Model number: PS-LX5BT or PS-LX3BT (model number of the purchased product)
- Serial number at the bottom of your turntable:
- Description of the defect(s). Please describe as much as you can.
- Date of your purchase:
- Your dealer name:

If the stylus or the drive belt is damaged or worn out due to improper use, repair services will be provided at your expense.

## Customer Support Websites

For information on purchasing replacement components, accessories, and other support services, visit the customer support website designated to your area of residence.

**For customers in Europe:**

<https://www.sony.eu/support>

**For customers in the U.S.A.:**

<https://esupport.sony.com/US>

**For customers in Canada:**

<https://esupport.sony.com/CA/>

**For customers in other countries/regions:**

<https://www.sony-asia.com/support>