

GTE19DTN

GE® ENERGY STAR® 19.1 Cu. Ft. Top-Freezer Refrigerator

DIMENSIONS AND INSTALLATION INFORMATION (IN INCHES)

OVERALL DIMENSIONS	Height to top of hinge (in.) A	66-3/8
	Height to top of case (in.) B	65-7/8
	Case depth without door (in.) C	28-3/8
	Case depth less door handle (in.) D	32-1/8
	Case depth with door handle (in.) E	34-1/2
	Depth with fresh food door open 90° (in.) F	60-1/2
	Width (in.) G	29-3/4
	Width with door open 90° with door handle (in.) H	32-3/8
AIR CLEARANCES	Each side (in.)	1/8
	Top (in.)	1
	Back (in.)	2

FRONT VIEW

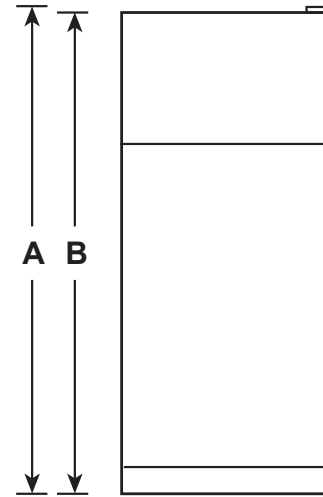

TOP VIEW

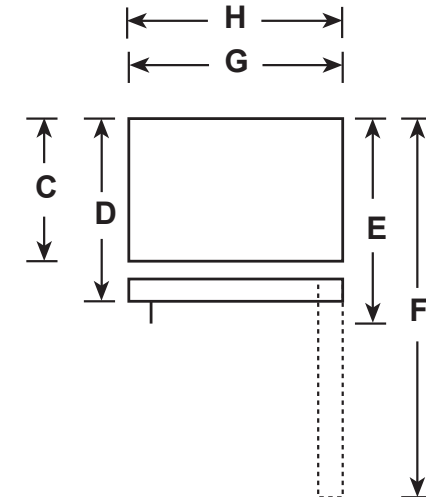

For answers to your Monogram, GE Café™ Series, GE Profile™ Series or GE Appliances product questions, visit our website at geappliances.com or call GE Answer Center® Service, 800.626.2000.



Listed by
Underwriters
Laboratories



As an ENERGY STAR® partner, GE has determined that this product meets the ENERGY STAR guidelines for energy efficiency.

GTE19DTN

GE® ENERGY STAR® 19.1 Cu. Ft. Top-Freezer Refrigerator

FEATURES AND BENEFITS

LED lighting – Find all your favorite foods under natural-looking light

Adjustable wire shelves – Moveable racks can handle a variety of foods

Upfront temperature controls – Easy-to-use controls regulate both fresh food and freezer sections

Model GTE19DTNBB – Black

Model GTE19DTNWW – White

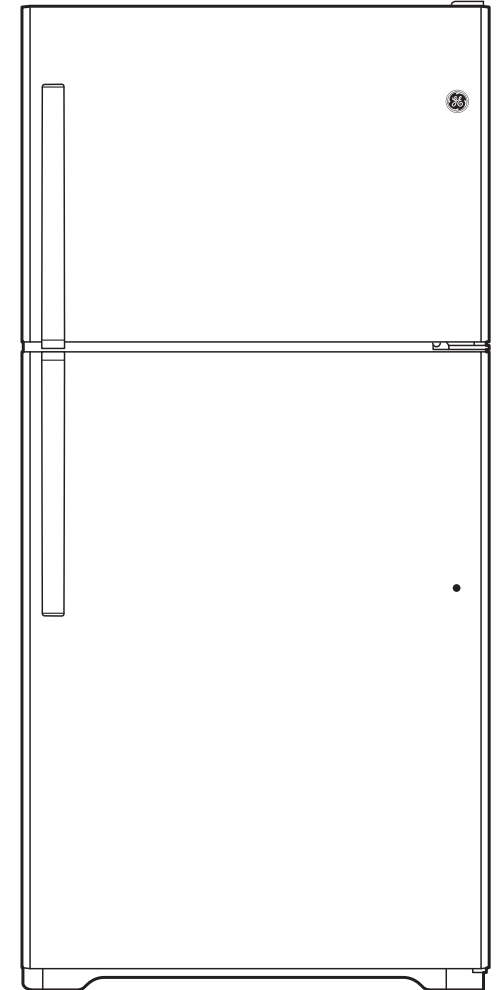

As an ENERGY STAR® partner, GE has determined that this product meets the ENERGY STAR guidelines for energy efficiency.