

# LIEBHERR

**Design Guide**  
**Fully Integrated 30" and 36"**  
Release 08 2015

---

### **Liebherr's engineering excellence in Germany provides the largest selection of freezers, refrigerators and wine refrigerators worldwide.**

Liebherr is one of the World's leading Manufacturers of Premium Refrigeration. For more than 60 years, Liebherr has specialized in developing and manufacturing first class refrigerators and freezers as well as wine cabinets. We focus on performance and efficiency as well as keeping food fresher longer. Produced in Austria and Germany, Liebherr has a full line of premium models tailored specifically for the North American marketplace to fit any design vision you have for your kitchen.

Our freestanding stainless models are sleek centerpieces that make a definite statement. Our built-in models are perfect for designs that call for units that slide into cabinet surrounds. And our fully-integrated models become one with your kitchen design, hidden seamlessly behind your custom cabinetry.

High quality materials, perfectly detailed finishes, precise electronic control systems, elite cooling components, variable speed compressors and the latest production processes ensure energy efficiency and performance for years to come. Our superior products offer premium quality, cutting edge design and innovative features that fit with your busy lifestyle.

### **Liebherr's Commitment to the Environment**

The components of Liebherr products can be recycled when the necessary resources are available. A concern for the environment and a desire to protect resources has led to increased levels of recycling year after year. When Liebherr manufactures products, it is essential that the recyclable recovery rate of the materials we use constantly increases.

Recycling is a common goal among all manufacturers, municipalities and recycling companies to protect our environment. Protecting the environment and producing products which have a low impact on the environment, is one of Liebherr's core values. When the time comes, please attempt to dispose of your old appliances in an environmentally safe and friendly manner.

### **LIEBHERR WARRANTY PLAN**

#### **FULL TWO YEAR WARRANTY**

For two years from the date of original purchase, your Liebherr warranty covers all parts and labor to repair or replace any part of the product which proves to be defective in materials or workmanship.

#### **FULL FIVE YEAR WARRANTY**

For five years from the date of original purchase, your Liebherr warranty covers all parts and labor to repair or replace any components that prove to be defective in materials or workmanship in the sealed system. The "Sealed System" means only the compressor, condenser, evaporator, drier and all connecting tubing.

#### **LIMITED 6TH THROUGH 12TH YEAR WARRANTY**

From the 6th through 12th year from the date of original purchase, your Liebherr warranty covers all parts that prove to be defective in materials or workmanship in the Sealed System (parts only).

### **For Service in the U.S.**

#### **Liebherr Service Center**

Toll Free: **1-866-LIEBHER**  
**1-866-543-2437**

Email: [Service-appliances.us@liebherr.com](mailto:Service-appliances.us@liebherr.com)

#### **PlusOne Solutions, Inc.**

3501 Quadrangle Blvd, Suite 120  
Orlando, FL 32817

### **For Installation Questions**

[Install.Americas@liebherr.com](mailto:Install.Americas@liebherr.com)

### **For Service in Canada**

#### **Liebherr Service Center**

Toll Free: **1-888-LIEBHER**  
**1-888-543-2437**

[www.euro-parts.ca](http://www.euro-parts.ca)

#### **EURO-PARTS CANADA**

39822 Belgrave Road  
Belgrave, Ontario, N0G 1E0  
Phone: (519) 357-3320  
Fax: (519) 357-1326

# Contents

---

<b>Safety Warnings</b> .....	7
<b>Electrical Requirements &amp; Safety</b> .....	8
<b>IceMaker (if equipped)</b> .....	8
<b>Area Requirements</b> .....	9
<b>Safety Regulations</b> .....	9
 <b>Specifications 30" Models</b>	
HC 1540 (right hinged) HC 1541 (left hinged) .....	10
HC 1550 (right hinged) HC 1551 (left hinged) .....	10
HCB 1560 (right hinged) HCB 1561 (left hinged) .....	11
 <b>Specifications 36" Models</b>	
HC 2060 (right hinged) HC 2061 (left hinged) .....	12
HCB 2060 (right hinged) HCB 2061 (left hinged) .....	12
HC 2062 .....	13
HCB 2062 .....	13
 <b>Unit Dimensions</b>	
Unit Dimensions HC 1540, HC 1541, HC 1550, HC 1551, HCB 1560, HCB 1561 .....	14
Unit Dimensions HC 2060, HC 2061, HCB 2060, HCB 2061 .....	15
Unit Dimensions HC 2062, HCB 2062 .....	16
 <b>Ventilation Requirements</b> .....	17
 <b>Cabinet Opening Dimensions</b>	
Cabinet Opening Dimensions HC 1540, HC 1541, HCB 1560, HCB 1561 .....	18
Cabinet Configuration HC 1540, HC 1541, HCB 1560, HCB 1561 .....	19
Cabinet Opening Dimensions HC/HCB 2060, HC/HCB 2061, HC 2062, HCB 2062 .....	20
Cabinet Configuration HC/HCB 2060, HC/HCB 2061, HC 2062, HCB 2062 .....	21
 <b>Installation Styles</b> .....	22
 <b>Panel Dimensions</b>	
Panel Dimensions Inset Installation Style HC 1540, HC 1541, HCB 1560, HCB 1561 .....	23
Panel Dimensions Frameless Installation Style HC 1540, HC 1541, HCB 1560, HCB 1561 .....	23
Panel Dimensions Inset Installation Style HC 2060, HC 2061, HCB 2060, HCB 2061 .....	24
Panel Dimensions Frameless Installation Style HC 2060, HC 2061, HCB 2060, HCB 2061 .....	24
Panel Dimensions Inset Installation Style HC 2062, HCB 2062 .....	25
Panel Dimensions Frameless Installation Style HC 2062, HCB 2062 .....	25
 <b>Door swing clearance</b>	
Door Swing Clearance - <u>Inset</u> installation style HC 1540, HC1541, HCB 1560, HCB 1561 .....	26
Door Swing Clearance - <u>Inset</u> installation style HC 2060, HC 2061, HCB 2060, HCB 2061 .....	26
Door Swing Clearance - <u>Frameless</u> installation style HC 1540, HC1541, HCB 1560, HCB 1561 .....	27
Door Swing Clearance - <u>Frameless</u> installation style HC 2060, HC 2061, HCB 2060, HCB 2061 .....	27
Door Swing Clearance - <u>Inset</u> installation style - HC 2062 / HCB 2062 Front panel 5/8" .....	28
Door Swing Clearance - <u>Inset</u> installation style - HC 2062 / HCB 2062 Front panel 3/4" .....	29
Door Swing Clearance - <u>Frameless</u> installation style - HC 2062 / HCB 2062 Front panel 5/8" .....	30
Door Swing Clearance - <u>Frameless</u> installation style - HC 2062 / HCB 2062 Front panel 3/4" .....	31
 <b>Accessories</b> .....	32

---

# General Remarks

---

## Safety Warnings

### PLEASE READ AND FOLLOW THESE INSTRUCTIONS

This design guide contains Warning and Important statements. This information is important for planning a safe and efficient installation. Please refer to the Installation Manual specific to your model for complete installation instructions.

This design guide is intended for planning purposes and is not a replacement for your appliance's Use and Care Manual which contains important information on how to use Liebherr appliances.

Always read and follow all Warning and Important statements!



**Warning indicates a potentially hazardous situation which, if not avoided, could result in death or serious injury.**

### **IMPORTANT**

*This highlights information that is especially relevant to a problem-free installation and operation.*

Make sure incoming voltage is the same as the unit rating.

To reduce the risk of fire, electric shock, or personal injury, the installation work and electrical wiring must be done by a qualified electrician in accordance with all applicable codes and standards, including fire rated construction.

### **To the Installer**

It is very important that the guidelines and instructions are followed in this design guide to ensure proper installation and operation of the unit. The Installation Guidelines section contains important information for making sure the installation is correct. Read and understand all the information and installation guidelines in this manual before the unit is installed.

It is also very important to **know** the Safety Information.

## General Remarks

### Electrical Requirements & Safety

A 15 amp or 20 amp, 110-120 VAC, circuit which is grounded and protected by a circuit breaker or fuse is required.

We recommend using a dedicated circuit for each appliance to prevent circuit overload and the chance of interruption to the appliance.

The appliances are equipped with a three-prong (grounding) polarized plug for protection against possible shock hazards.

Comply with the National Electrical Code as well as local codes and ordinances when installing the receptacle.



#### **WARNING!**

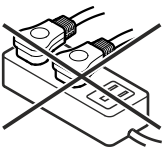
**Electrocution hazard.**

**Electrical grounding required.**

- **Do not remove the round grounding prong from the plug.** →
- **Do not use extension cords or ungrounded (two-prong) adapters.**
- **Do not use a power cord that is frayed or damaged.**



- **Do not use a power strip.** →



**Failure to follow these instructions may result in fire, electrical shock or death.**

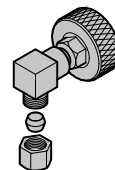
### IceMaker (if equipped)

The icemaker is located in the freezer compartment. It must be connected to the water supply. The appliance must be level for the icemaker to function properly.

The water supply pressure requirements are different based on whether or not the supplied Liebherr water filter is installed. With the filter installed, the pressure must be in the range of 40-90 psi (2.8-6.2 bar). Without the filter installed the acceptable pressure range is 22-87 psi (1.5-6 bar).

Use a braided style ice maker hose with 1/4" compression end or a 1/4" OD copper line to connect the water supply with the solenoid valve of the appliance. This is not supplied with the appliance.

**The supplied brass fitting must be used to connect to the solenoid as the plastic threads on the solenoid are metric.**



If you have hard water, we recommend you install a water softener. Also, a filter must be installed if the water contains solids such as sand.

All equipment and devices used to supply the water to the appliance must comply with the current regulations for your geographical area.

### Safety Instructions and Warnings

- Do not attach the water source while the appliance is connected to an electrical outlet.
- A shut-off valve, must be installed between the hose line and the main water supply so that the water supply can be stopped if necessary. Do not install the shut-off valve behind the refrigeration unit.
- The connection to the water supply may only be made by a trained and licensed plumber.
- The water quality must comply with the drinking water regulations for the geographical area where the appliance is located.
- The icemaker is designed exclusively to make ice cubes in quantities needed by a household and may only be operated with water appropriate for this purpose.
- All repairs and work on the icemaker may only be done by customer service personnel or other trained personnel.
- The manufacturer cannot accept liability for damage caused by equipment or water lines between the solenoid valve and the water supply.



## General Remarks

---

### Area Requirements

Verify the following:

- Floors can support refrigerator's weight plus approximately 1200 pounds (544 kg) of food weight. Not all Liebherr products are designed for 1200 pounds (544 kg) of food. Some units are smaller and total weights may vary.
- Finished kitchen floor height is level. Refrigerator must be shimmed to the floor level, or levelled, to make sure, air vents are not obstructed.
- Remove anything attached to the rear or side walls that can obstruct refrigerator opening.
- Cutout dimensions are accurate.
- Electrical outlet is in correct location.

Do not install this unit next to any other refrigerator or freezer except another Liebherr model. Liebherr models are designed to allow side by side installation. They are equipped with a heating system to eliminate condensation when units are installed side by side. Installing this unit next to any other refrigerator or freezer can cause condensation or cause damage to the Liebherr unit.

#### **IMPORTANT**

*To protect the refrigerator from possible damage, allow the appliance to stand 1 hour in place before turning the electricity on. This allows the refrigerant and system lubrication to reach equilibrium.*

### Blocking For Safety

The anti-tip bracket must be installed to prevent the unit from tipping after it is installed. Refer to chapter "Blocking For Safety" in the installation instructions.

### Safety Regulations

The appliances are designed to cool, freeze, store food as well and make ice (if equipped).

The appliances are manufactured to operate within specific ambient temperature limits according to its climate rating.

The climate rating indicates the ambient temperature at which the appliance may be operated in order to deliver optimal refrigeration performance.

The climate rating for each model is visible in chapter "Specifications".

Climate Rating	Ambient Temperature
SN	50°F to 90°F (10°C to 32°C)
N	61°F to 90°F (16°C to 32°C)
ST	61°F to 100°F (16°C to 38°C)
T	61°F to 109°F (16°C to 43°C)
SN-ST	50°F to 100°F (10°C to 38°C)
SN-T	50°F to 109°F (10°C to 43°C)

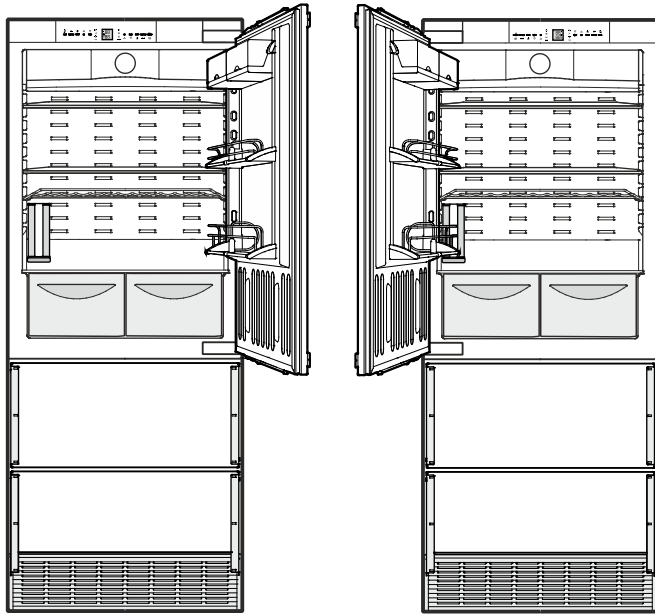
#### **IMPORTANT**

*Do not operate the appliance outside the specified ambient temperature range.*

- Refrigerant circuits are tested for leaks.
- The appliances comply with current safety regulations

CAN/CSA C22.2 No.60335-1-11  
UL 60335-1 Fifth Edition  
CAN/CSA C22.2 No. 60335-2-24-06  
UL 60335-2-24 First Edition

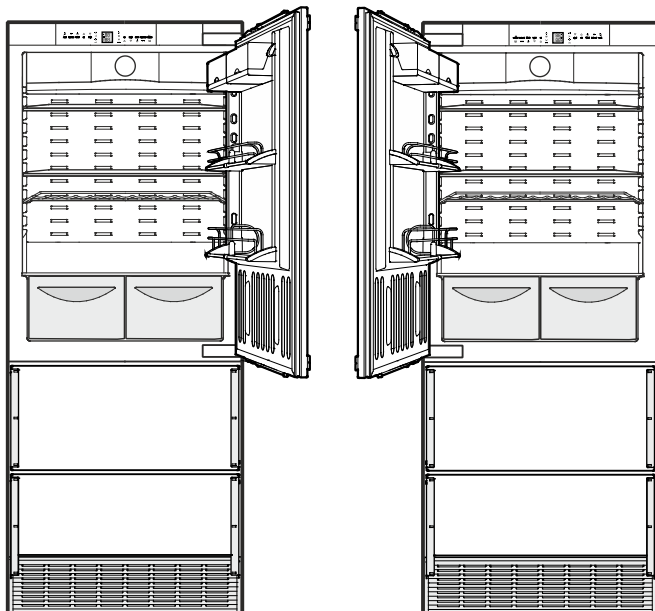
## Specifications 30" Models



### **HC 1540** (right hinged) **HC 1541** (left hinged)

Energy Star:	certified
Energy consumption p. a.:	507 kWh
Energy Supply:	115V / 60Hz / 2.5A
Total capacity:	14.1 cu ft (400 L)
Refrigerator:	9.8 cu ft (278 L)
Freezer:	4.3 cu ft (122 L)
Ice cube output:	2.2 lbs/24h
Ice cube stock:	6 lbs
IceMaker water tank capacity:	73.2 cu in (1.2 L)
Climate Rating:	SN-T

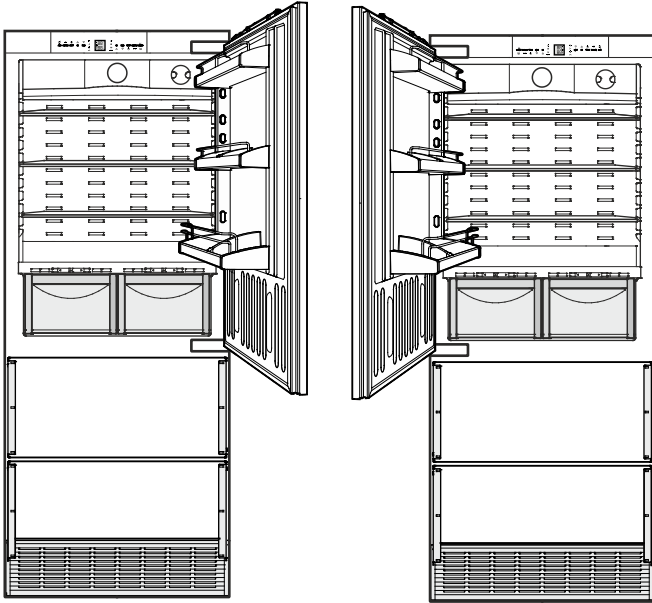
- Automatic refrigerator defrosting
- Automatic freezer compartment defrosting
- Automatic IceMaker can be switched off
- Maximum door opening angle is 115°
- LED ceiling and freezer lighting



### **HC 1550** (right hinged) **HC 1551** (left hinged)

Energy Star:	certified
Energy consumption p. a.:	507 kWh
Energy Supply:	115V / 60Hz / 2.5A
Total capacity:	14.1 cu ft (400 L)
Refrigerator:	9.8 cu ft (278 L)
Freezer:	4.3 cu ft (122 L)
Ice cube output:	2.2 lbs/24h
Ice cube stock:	6 lbs
Climate Rating:	SN-T

- Automatic refrigerator defrosting
- Automatic freezer compartment defrosting
- Automatic IceMaker can be switched off
- Maximum door opening angle is 115°
- LED ceiling and freezer lighting

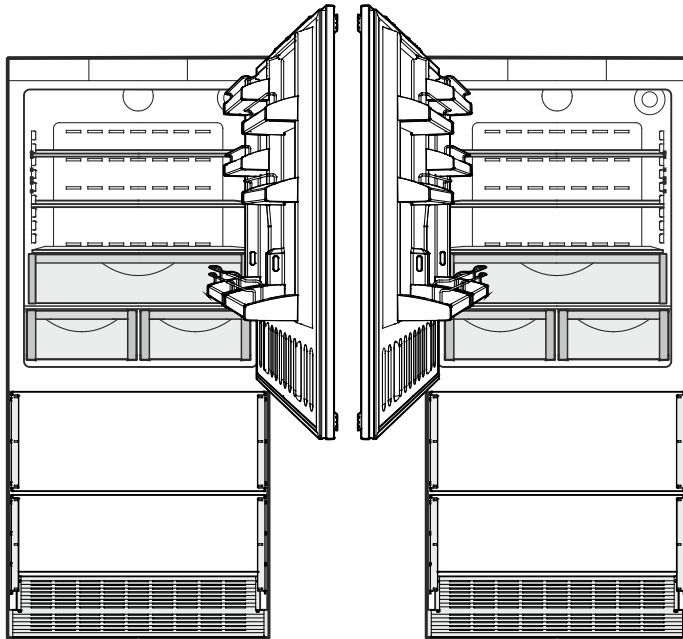


### **HCB 1560** (right hinged) **HCB 1561** (left hinged)

Energy Star:	certified
Energy consumption p. a.:	507 kWh
Energy Supply:	115V / 60Hz / 2.5A
Total capacity:	14.1 cu ft (400 L)
Refrigerator:	9.8 cu ft (278 L)
Freezer:	4.3 cu ft (122 L)
Ice cube output:	2.2 lbs/24h
Ice cube stock:	6 lbs
Climate Rating:	SN-T

- Automatic refrigerator defrosting
- Automatic freezer compartment defrosting
- Automatic IceMaker can be switched off
- Maximum door opening angle is 115°
- LED light column and LED freezer lighting
- BioFresh drawers with adjustable humidity

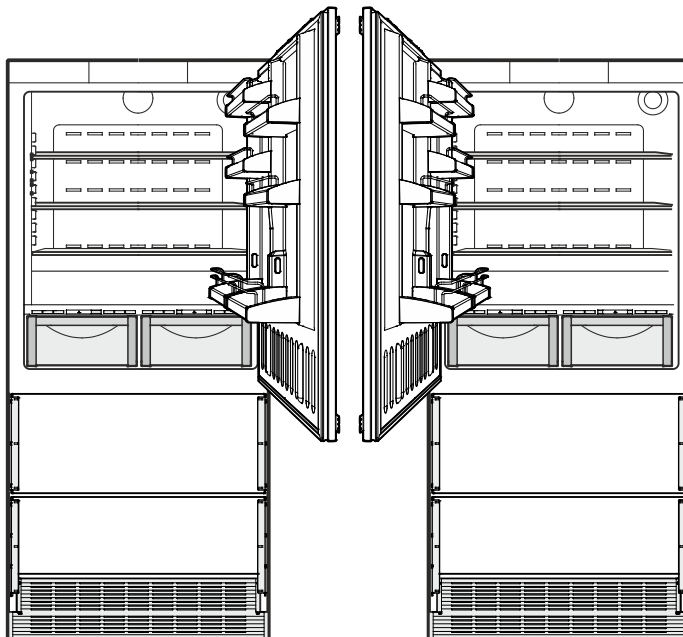
## Specifications 36" Models



### **HC 2060** (right hinged) **HC 2061** (left hinged)

Energy Star:	certified
Energy consumption p. a.:	561 kWh
Energy Supply:	115V / 60Hz / 2.5A
Total capacity:	19.5 cu ft (552 L)
Refrigerator:	13.5 cu ft (382 L)
Freezer:	6 cu ft (170 L)
Ice cube output:	3 lbs/24h
Ice cube stock:	6 lbs
Climate Rating:	SN-T

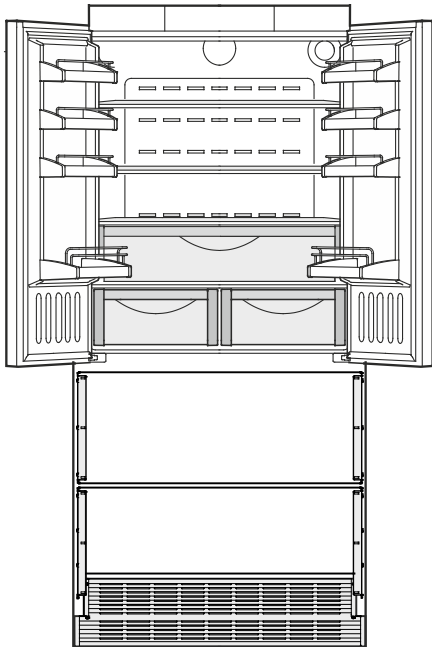
- Automatic refrigerator defrosting
- Automatic freezer compartment defrosting
- Automatic IceMaker can be switched off
- Maximum door opening angle is 115°
- LED light column and LED freezer lighting



### **HCB 2060** (right hinged) **HCB 2061** (left hinged)

Energy Star:	certified
Energy consumption p. a.:	556 kWh
Energy Supply:	115V / 60Hz / 2.5A
Total capacity:	18.9 cu ft (535 L)
Refrigerator:	12.9 cu ft (365 L)
Freezer:	6 cu ft (170 L)
Ice cube output:	3 lbs/24h
Ice cube stock:	6 lbs
Climate Rating:	SN-T

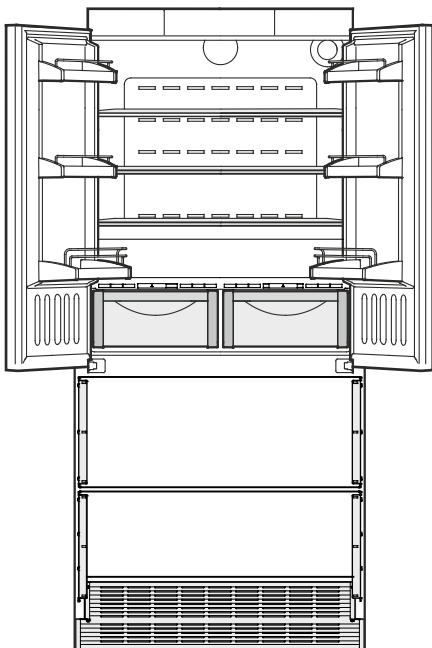
- Automatic refrigerator defrosting
- Automatic freezer compartment defrosting
- Automatic IceMaker can be switched off
- Maximum door opening angle is 115°
- LED light column and LED freezer lighting
- BioFresh drawers with adjustable humidity



### HC 2062

Energy Star:	certified
Energy consumption p. a.:	561 kWh
Energy Supply:	115V / 60Hz / 2.5A
Total capacity:	19.5 cu ft (552 L)
Refrigerator:	13.5 cu ft (382 L)
Freezer:	6 cu ft (170 L)
Ice cube capacity:	3 lbs/24h
Ice cube stock:	6 lbs
Climate Rating:	SN-T

- Automatic refrigerator defrosting
- Automatic freezer compartment defrosting
- Automatic IceMaker can be switched off
- Maximum door opening angle is 105°
- LED light column and LED freezer lighting



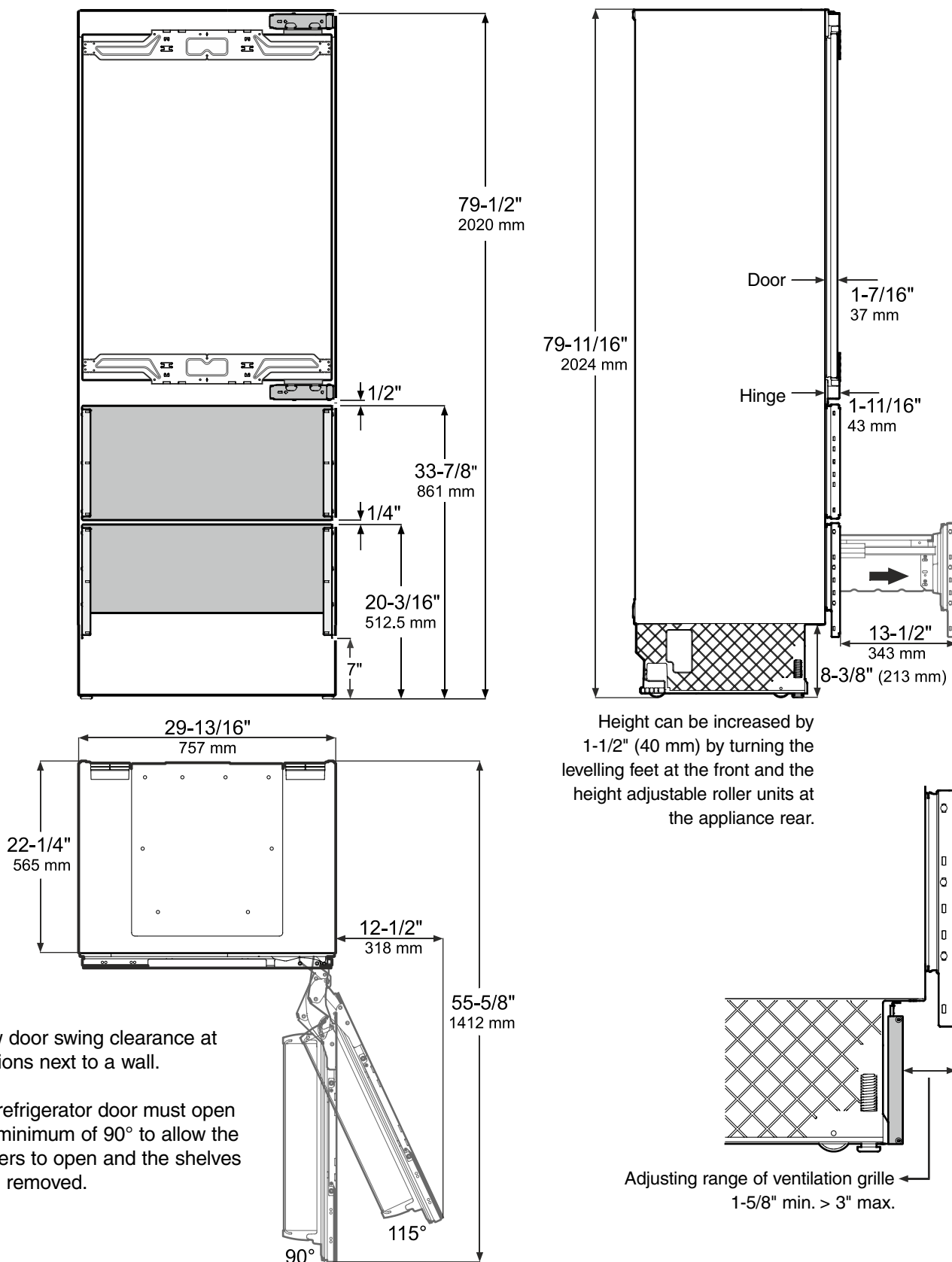
### HCB 2062

Energy Star:	certified
Energy consumption p. a.:	556 kWh
Energy Supply:	115V / 60Hz / 2.5A
Total capacity:	18.9 cu ft (535 L)
Refrigerator:	12.9 cu ft (365 L)
Freezer:	6 cu ft (170 L)
Ice cube output:	3 lbs/24h
Ice cube stock:	6 lbs
Climate Rating:	SN-T

- Automatic refrigerator defrosting
- Automatic freezer compartment defrosting
- Automatic IceMaker can be switched off
- Maximum door opening angle is 105°
- LED light column and LED freezer lighting
- BioFresh drawers with adjustable humidity

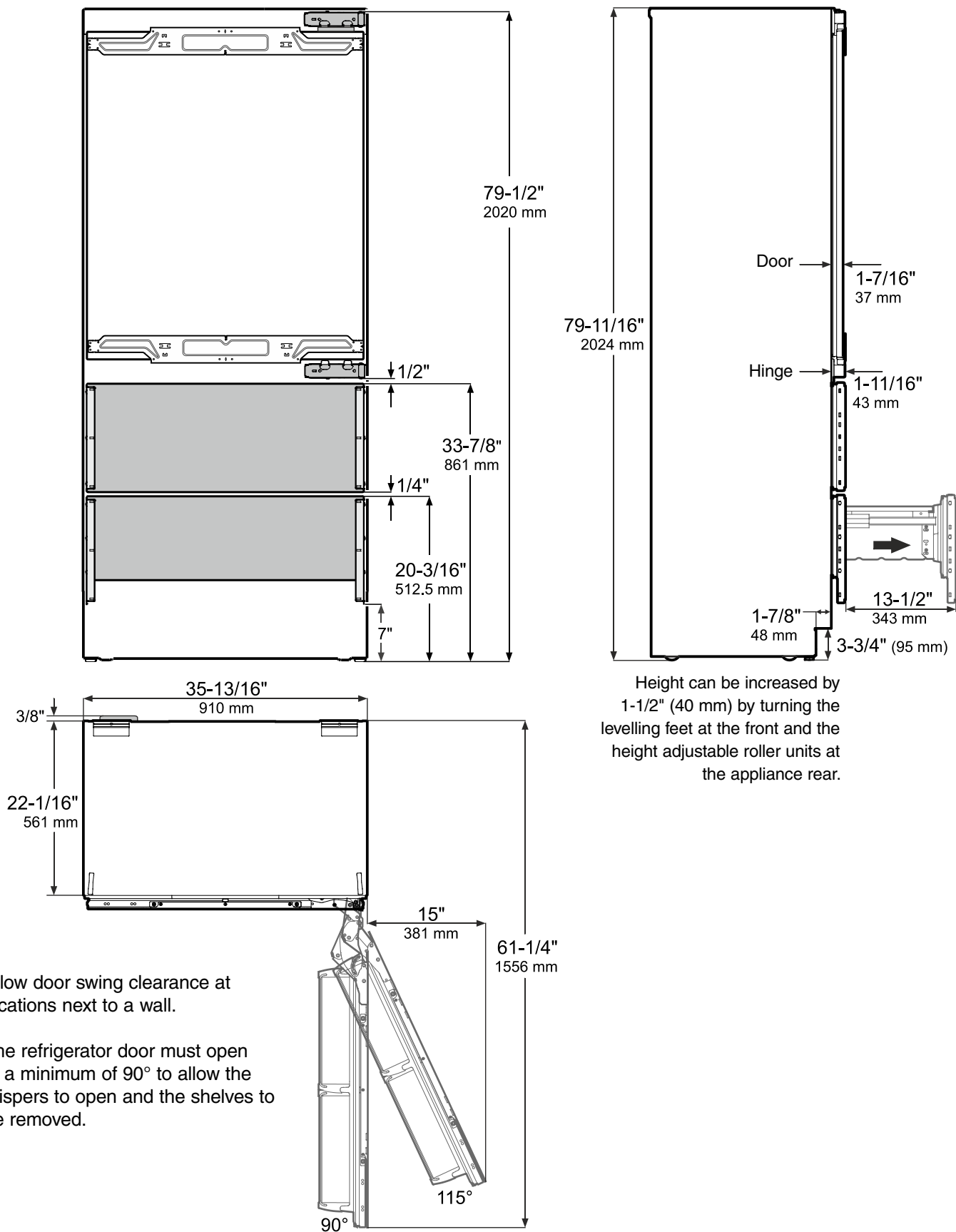
# Fully Integrated

## Unit Dimensions HC 1540, HC 1541, HC 1550, HC 1551, HCB 1560, HCB 1561



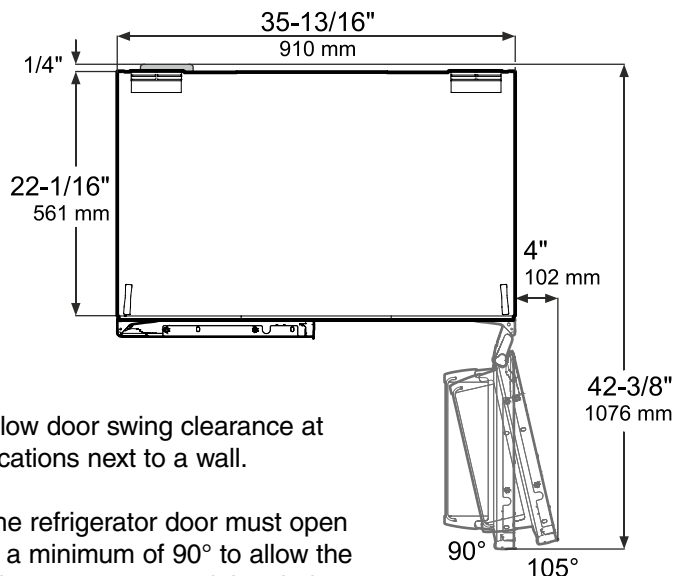
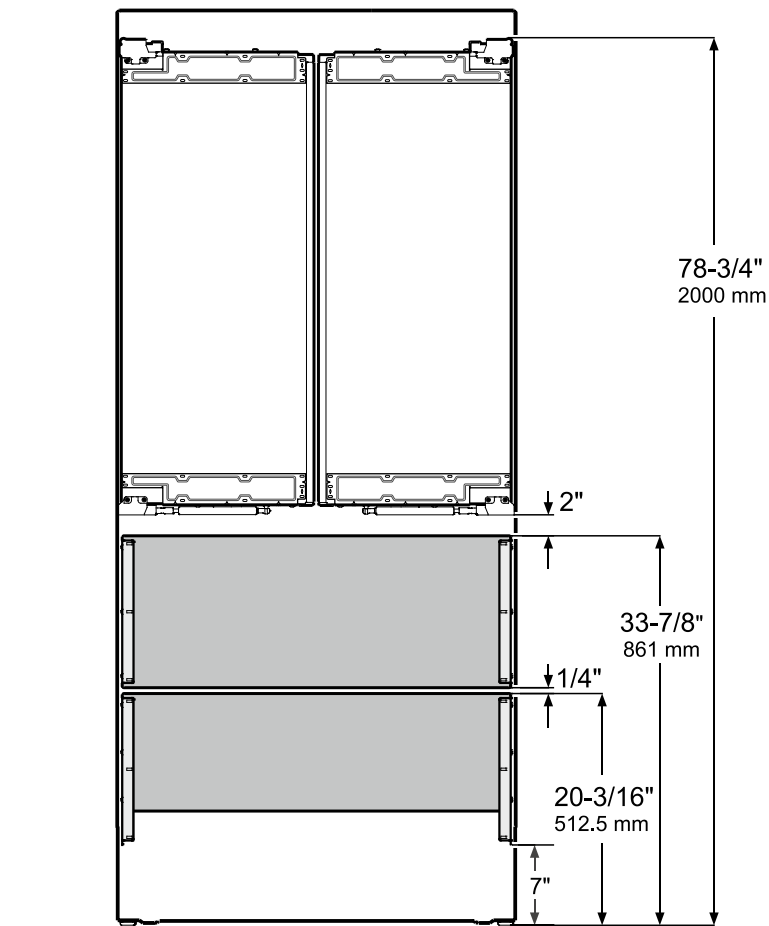
# Fully Integrated

## Unit Dimensions HC 2060, HC 2061, HCB 2060, HCB 2061



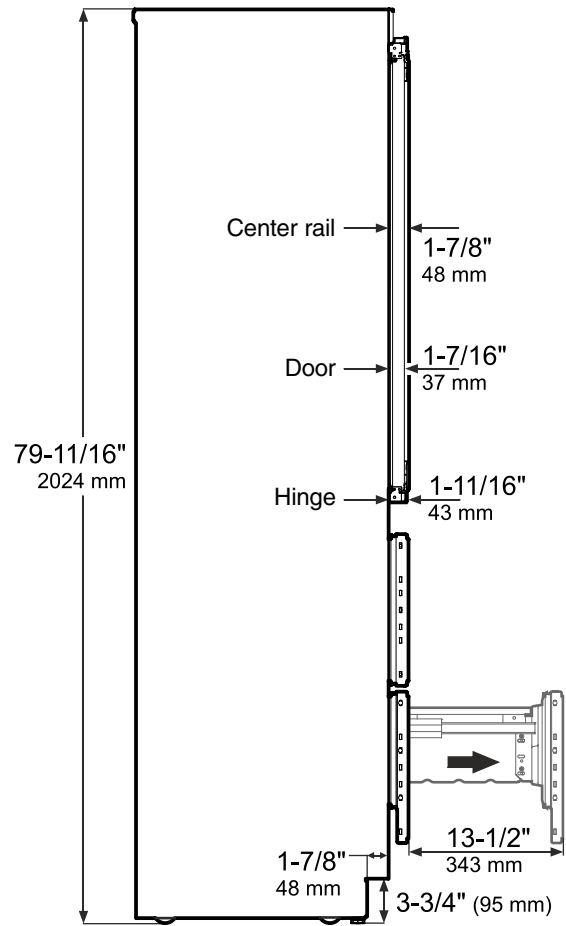
# Fully Integrated

## Unit Dimensions HC 2062, HCB 2062



Allow door swing clearance at locations next to a wall.

The refrigerator door must open to a minimum of 90° to allow the crispers to open and the shelves to be removed.



Height can be increased by 1-1/2" (40 mm) by turning the levelling feet at the front and the height adjustable roller units at the appliance rear.



# Fully Integrated

---

## Ventilation Requirements

HC and HCB appliances do not require ventilation considerations in the cabinetry.  
The required airflow is directed through the toe kick base.



It is important to use the provided cover grille for the ventilation opening. This opening must not be covered.

## R600a Refrigerant

### **WARNING!**

The refrigerant R600a contained within the appliances is environmentally friendly, but flammable. Leaking refrigerant can ignite.

To prevent possible ignition, designed ventilation is required.

Fully Integrated

Cabinet Opening Dimensions HC 1540, HC 1541, HCB 1560, HCB 1561

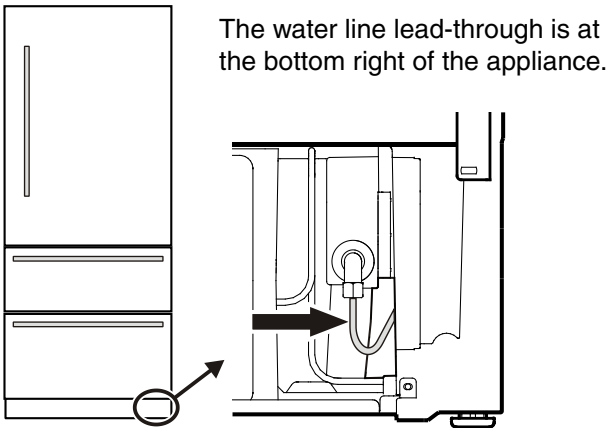
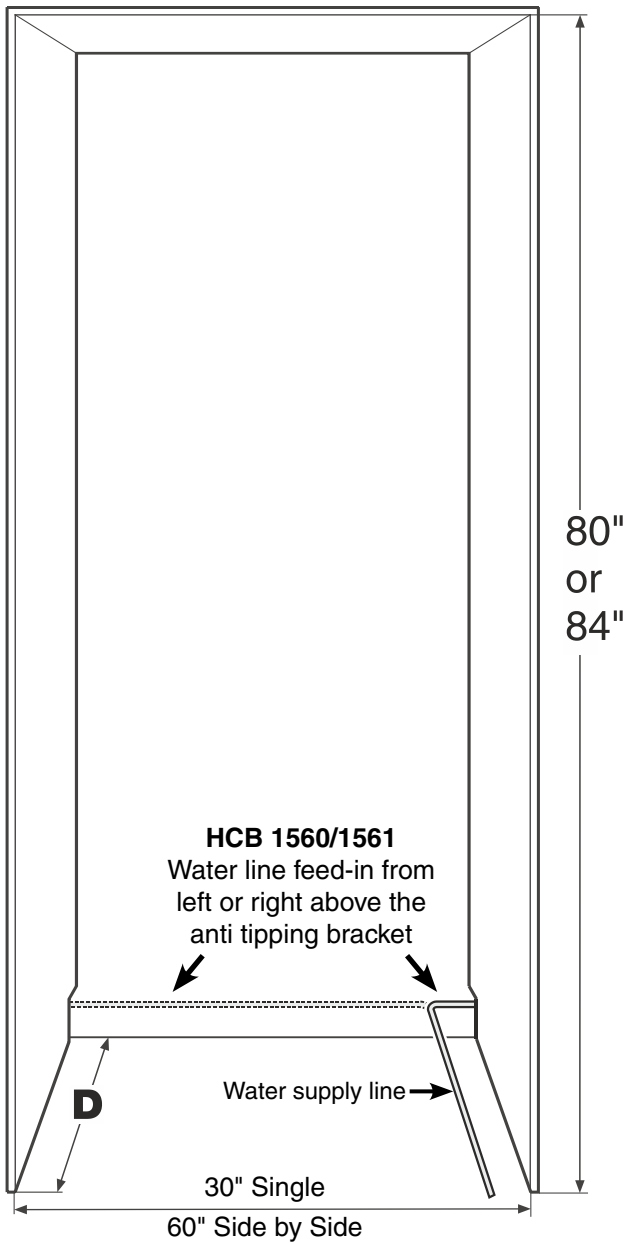
Inset cabinet Depth D	Frameless cabinet Depth D
24" + panel thickness	24"

IMPORTANT

Factory available stainless steel panels are designed for an inset installation only and require a cabinet / gable depth of 24 - 3/4".

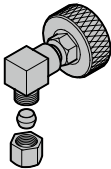
Concerning the refrigerator compartment there is the option to choose between stainless steel panels for a 80" or a 84" installation situation.

When using your own custom overlay panels, only the 80" opening minimum would apply. Opening height can be taller than the 80" minimum by any amount but be sure to adjust panel height accordingly.



Use a braided style ice maker hose with 1/4" compression end or a 1/4" OD copper line to connect the water supply with the solenoid valve of the appliance. This is not supplied with the appliance.

The supplied brass fitting must be used to connect to the solenoid as the plastic threads on the solenoid are metric.



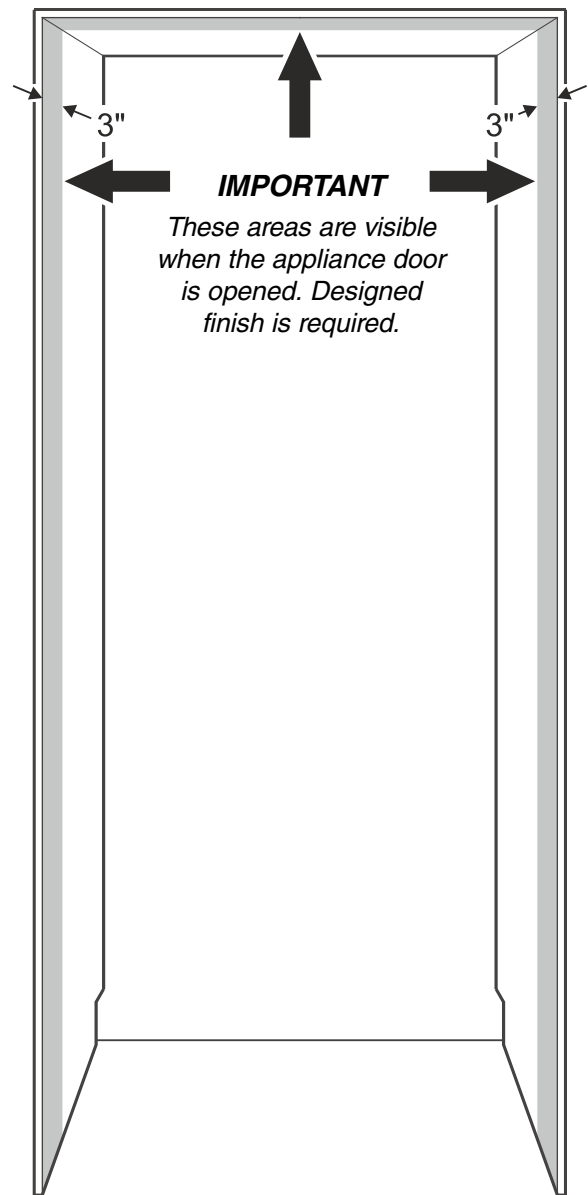
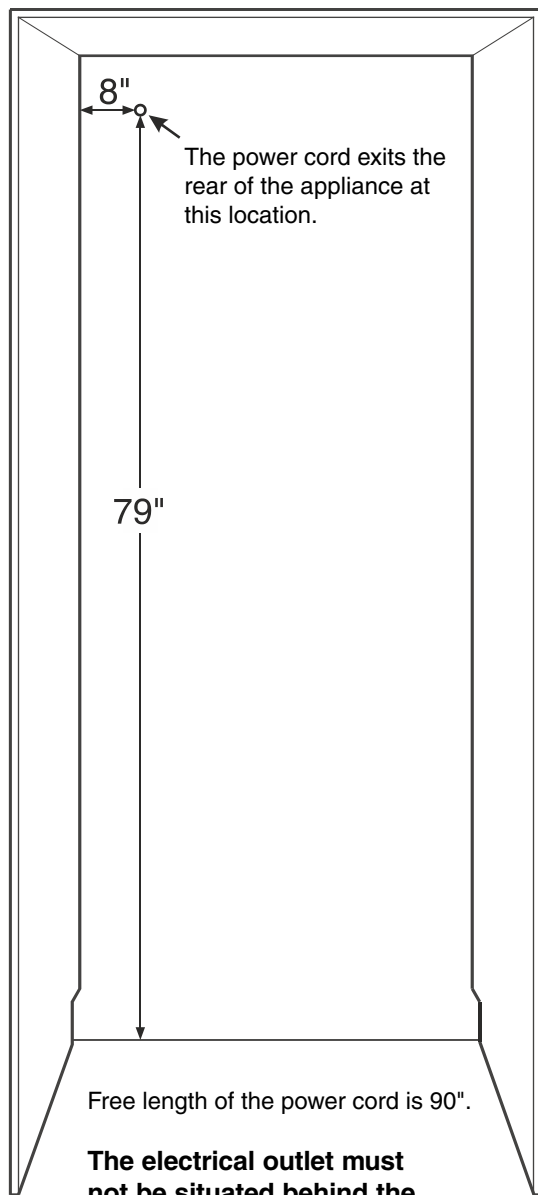
IMPORTANT

Do not install the shut-off valve for the water line behind the appliance.

## Fully Integrated

---

### Cabinet Configuration HC 1540, HC 1541, HCB 1560, HCB 1561



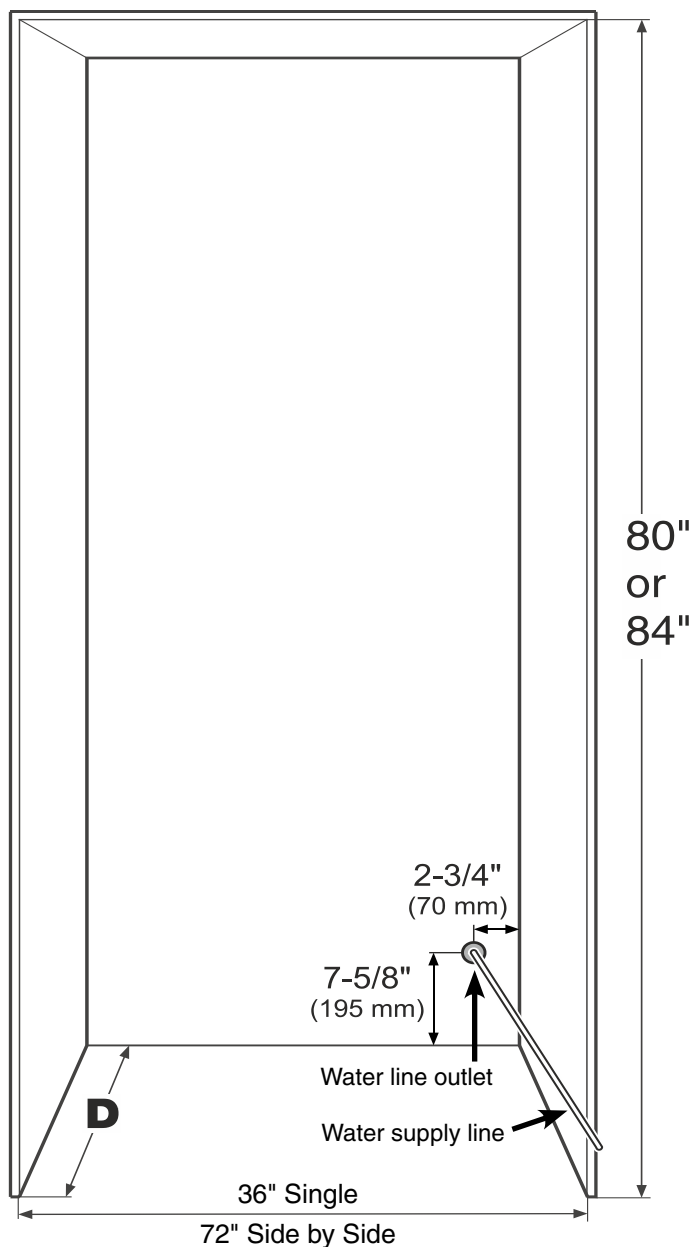
# Fully Integrated

## Cabinet Opening Dimensions HC/HCB 2060, HC/HCB 2061, HC 2062, HCB 2062

Inset cabinet Depth <b>D</b>	Frameless cabinet Depth <b>D</b>
24" + panel thickness	24"

### IMPORTANT

Factory available stainless steel panels are designed for an inset installation only and require a cabinet / gable depth of 24 - 3/4".



Concerning the refrigerator compartment there is the option to choose between stainless steel panels for a 80" or a 84" installation situation.

When using your own custom overlay panels, only the 80" opening minimum would apply. Opening height can be taller than the 80" minimum by any amount but be sure to adjust panel height accordingly.

### IMPORTANT

With 24" cabinets, the water line outlet must be in the location as shown.

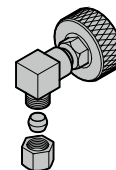
With cabinets deeper than 24" there is room to fit the pipe behind the appliance and the wall so there are no requirements for the water line lead out position.

The free length of the water supply line must be at least 31 - 1/2" (800 mm) when the tube comes out of the prescribed opening.

**Do not install the shut-off valve for the water line behind the appliance.**

Use a braided style ice maker hose with 1/4" compression end or a 1/4" OD copper line to connect the water supply with the solenoid valve of the appliance. This is not supplied with the appliance.

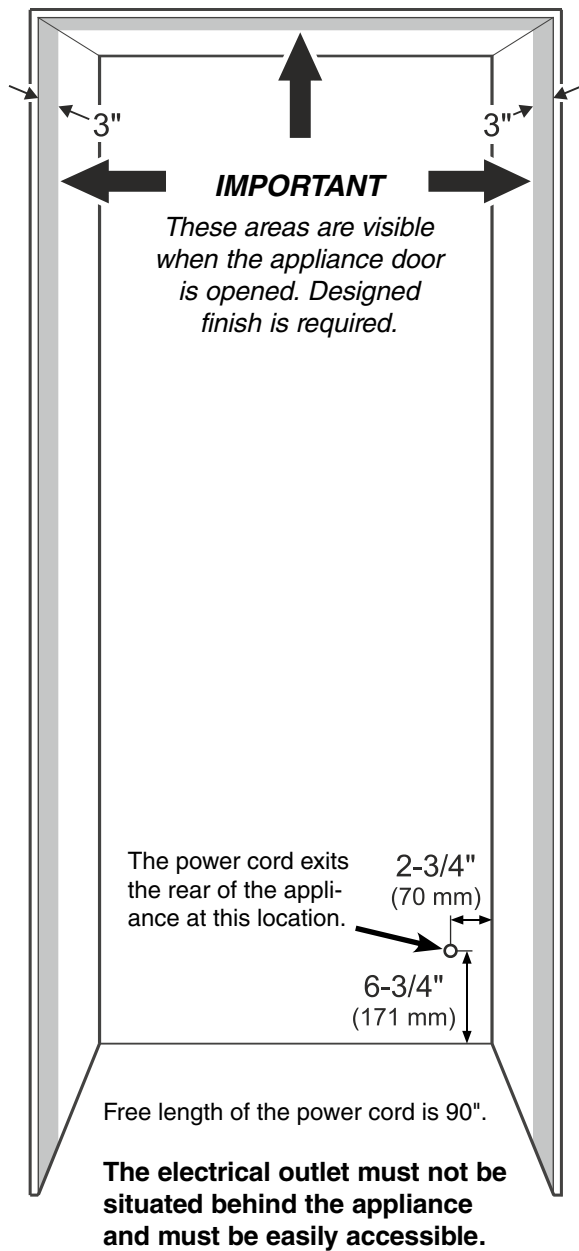
**The supplied brass fitting must be used to connect to the solenoid as the plastic threads on the solenoid are metric.**



## Fully Integrated

---

### Cabinet Configuration HC/HCB 2060, HC/HCB 2061, HC 2062, HCB 2062



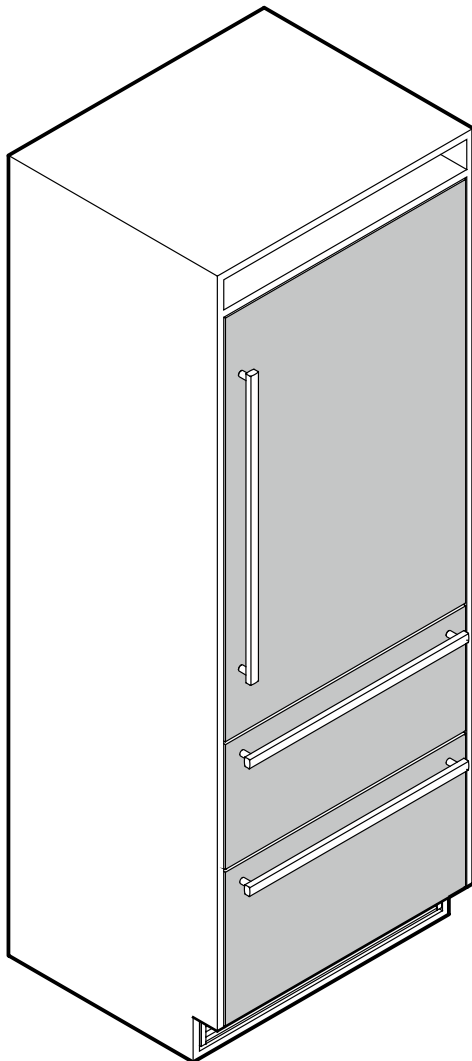
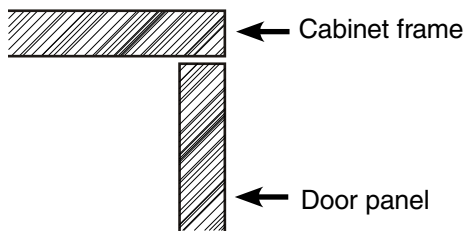
# Fully Integrated

## Installation Styles

### *Inset Installation Style*

Appliance and panels sit fully within the opening and are flush with what could be its own box, between two pantry cabinets or decorative columns, etc. This is the most common installation scenario.

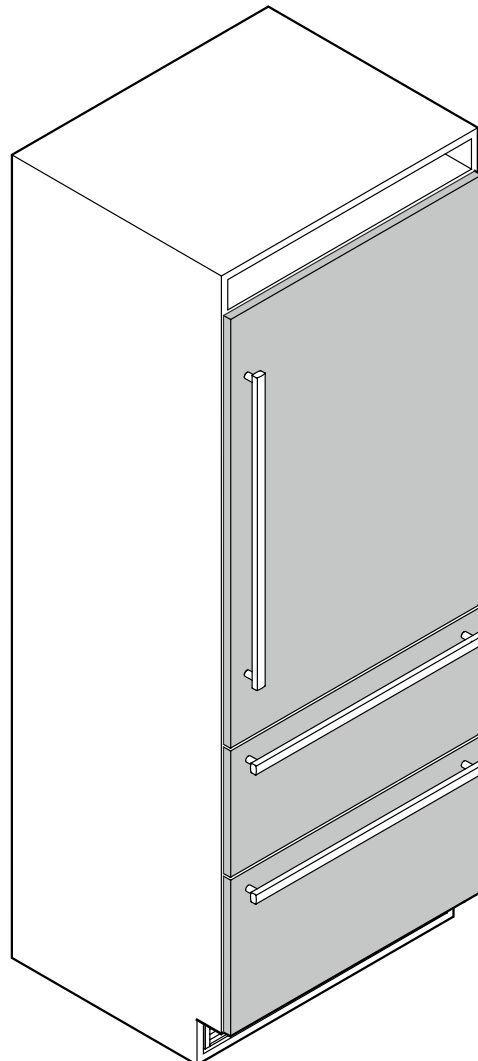
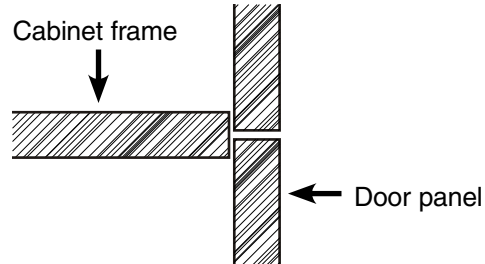
Side view of cabinet (sectional view)



### *Frameless Installation Style*

With this installation style, these wider appliance panels partially overlay the shared side gables of adjacent cabinetry so as to mimic the look of a frameless style cabinet.

Side view of cabinet (sectional view)

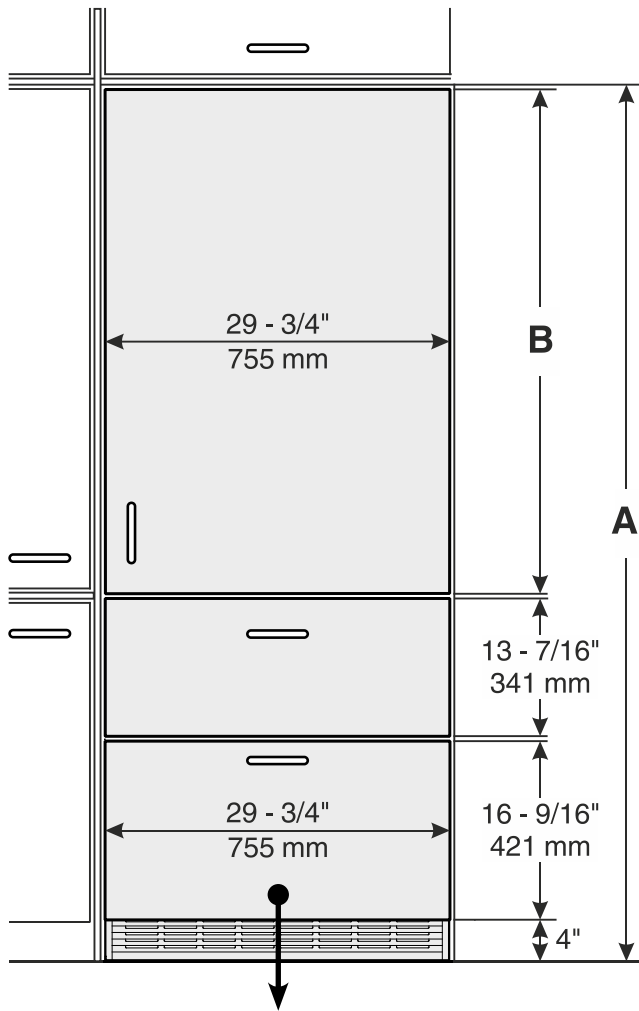


Fully Integrated

Panel Dimensions  
Inset Installation Style  
HC 1540, HC 1541  
HCB 1560, HCB 1561

Minimum panel thickness is **5/8"** (16 mm).  
Maximum panel thickness is **1-1/2"** (38 mm).  
Maximum weight of the refrigerator panel is **60 lbs** (27 kg).  
Maximum weight of each freezer panel is **26.5 lbs** (12 kg).

Cabinet opening <b>A</b>	Refrigerator door panel <b>B</b>
80"	45-1/4" (1150 mm)
84"	49-1/4" (1251 mm)

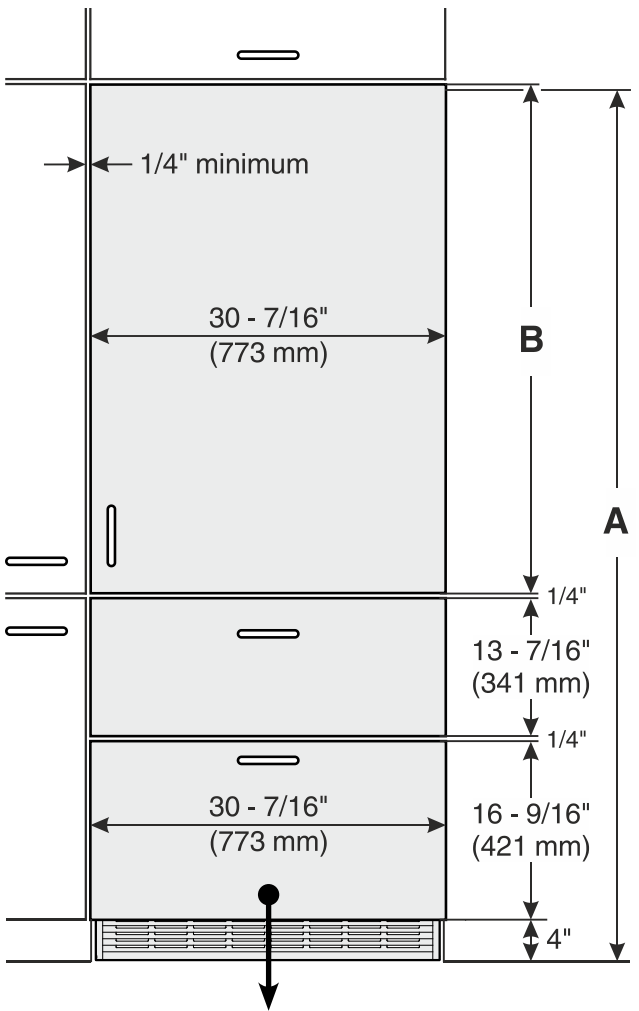


The height of this panel can be reduced by up to 2" to accommodate higher toe kicks

Panel Dimensions  
Frameless Installation Style  
HC 1540, HC 1541  
HCB 1560, HCB 1561

Minimum panel thickness is **5/8"** (16 mm).  
Maximum panel thickness is **1-1/2"** (38 mm).  
Maximum weight of the refrigerator panel is **60 lbs** (27 kg).  
Maximum weight of each freezer panel is **26.5 lbs** (12 kg).

Cabinet opening <b>C</b>	Refrigerator door panel <b>D</b>
80"	45-3/4" (1162 mm)
84"	49-3/4" (1264 mm)

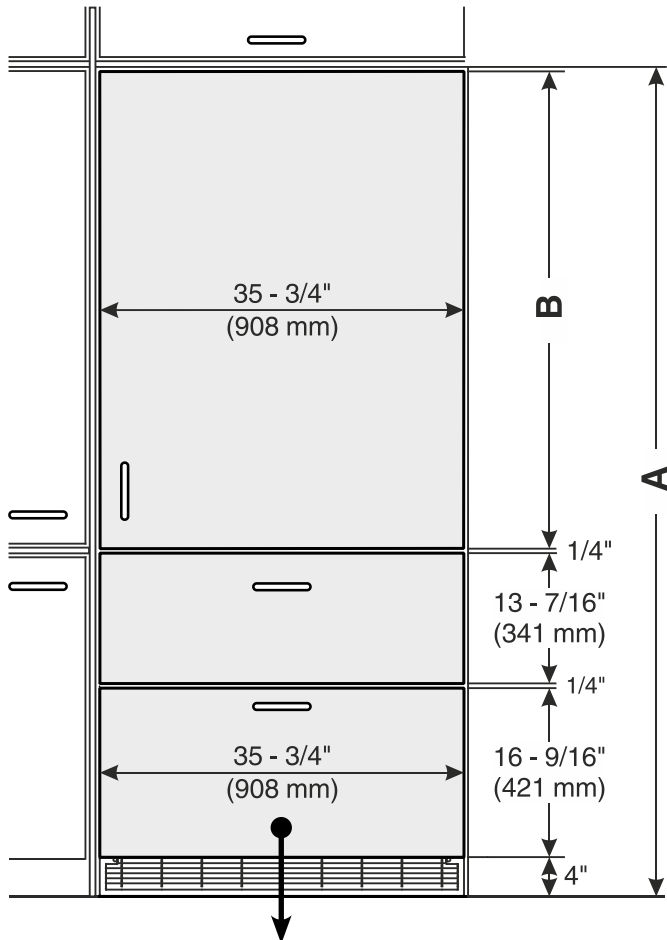


Fully Integrated

Panel Dimensions  
Inset Installation Style  
HC 2060, HC 2061  
HCB 2060, HCB 2061

Minimum panel thickness **5/8"** (16 mm).  
Maximum panel thickness is **1-1/2"** (38 mm).  
Maximum weight of the refrigerator panel is **60 lbs** (27 kg).  
Maximum weight of each freezer panel is **26.5 lbs** (12 kg).

Cabinet opening <b>A</b>	Refrigerator door panel <b>B</b>
80"	45-1/4" (1150 mm)
84"	49-1/4" (1251 mm)

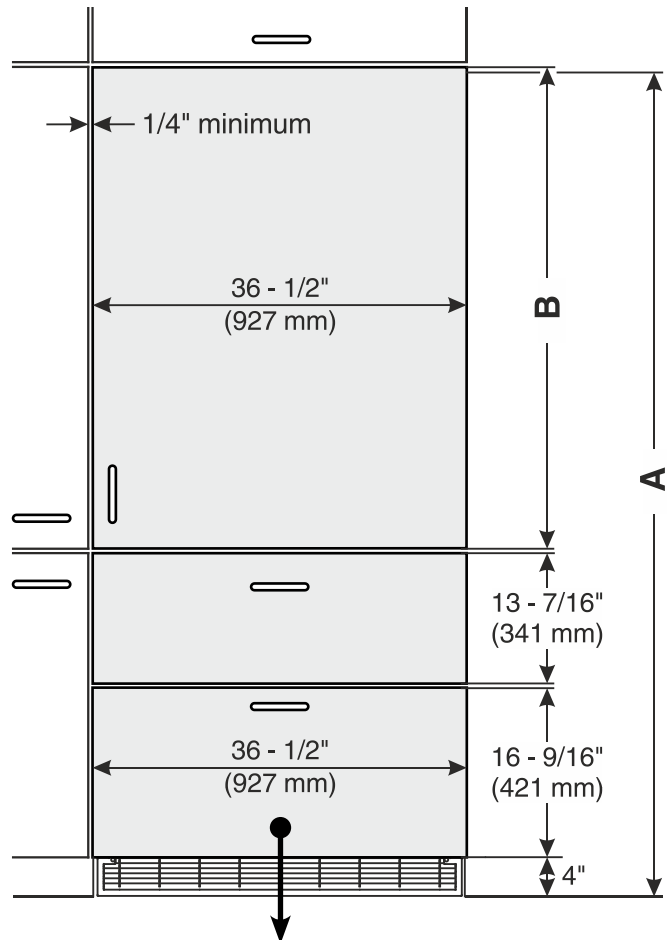


The height of this panel cannot be reduced for taller toe kicks as it will reveal structural elements of the appliance. Instead, install appliance on a platform and adjust the opening height to accommodate.

Panel Dimensions  
Frameless Installation Style  
HC 2060, HC 2061  
HCB 2060, HCB 2061

Minimum panel thickness **5/8"** (16 mm).  
Maximum panel thickness is **1-1/2"** (38 mm).  
Maximum weight of the refrigerator panel is **60 lbs** (27 kg).  
Maximum weight of each freezer panel is **26.5 lbs** (12 kg).

Cabinet opening <b>A</b>	Refrigerator door panel <b>B</b>
80"	45-3/4" (1162 mm)
84"	49-3/4" (1264 mm)



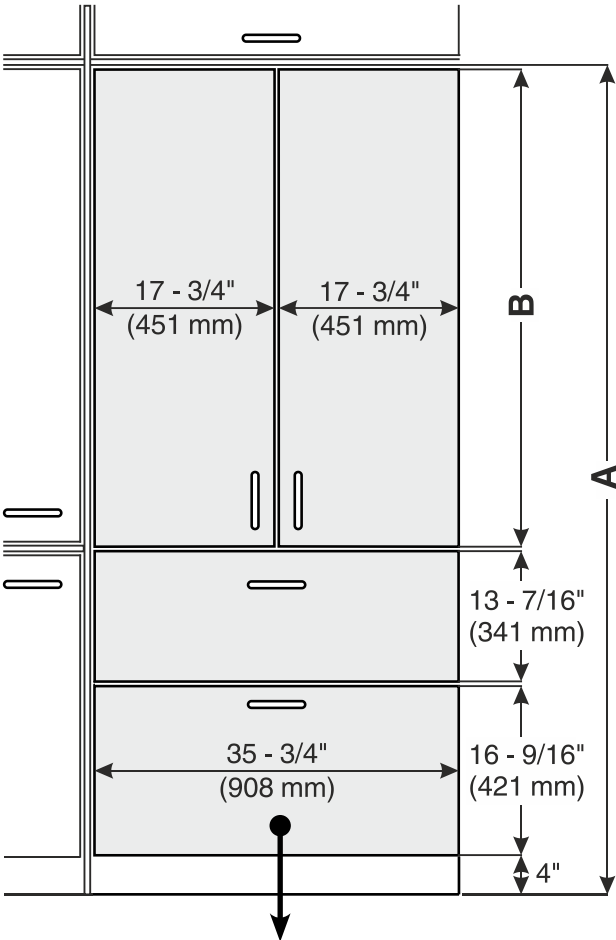


Fully Integrated

Panel Dimensions  
Inset Installation Style  
HC 2062, HCB 2062

Minimum panel thickness is **5/8"** (16 mm).  
Maximum panel thickness is **3/4"** (19 mm).  
Maximum weight for each panel is **26.5 lbs** (12 kg).

Cabinet Opening A	Refrigerator door panel B
80"	45 - 1/4" (1150 mm)
84"	49 - 1/4" (1251 mm)

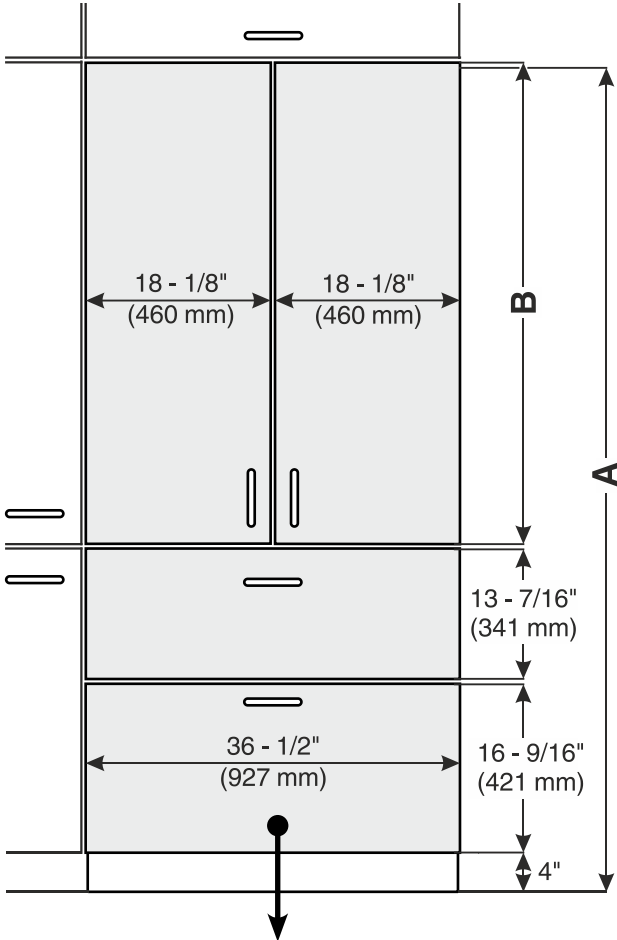


The height of this panel cannot be reduced for taller toe kicks as it will reveal structural elements of the appliance. Instead, install appliance on a platform and adjust the opening height to accommodate.

Panel Dimensions  
Frameless Installation Style  
HC 2062, HCB 2062

Minimum panel thickness is **5/8"** (16 mm).  
Maximum panel thickness is **3/4"** (19 mm).  
Maximum weight for each panel is **26.5 lbs** (12 kg).

Cabinet Opening A	Refrigerator door panel B
80"	45 - 3/4" (1162 mm)
84"	49 - 3/4" (1264 mm)



IMPORTANT

Risk of interference with the adjacent panels!  
Do not use wider panels as given in the illustration below!

## Fully Integrated

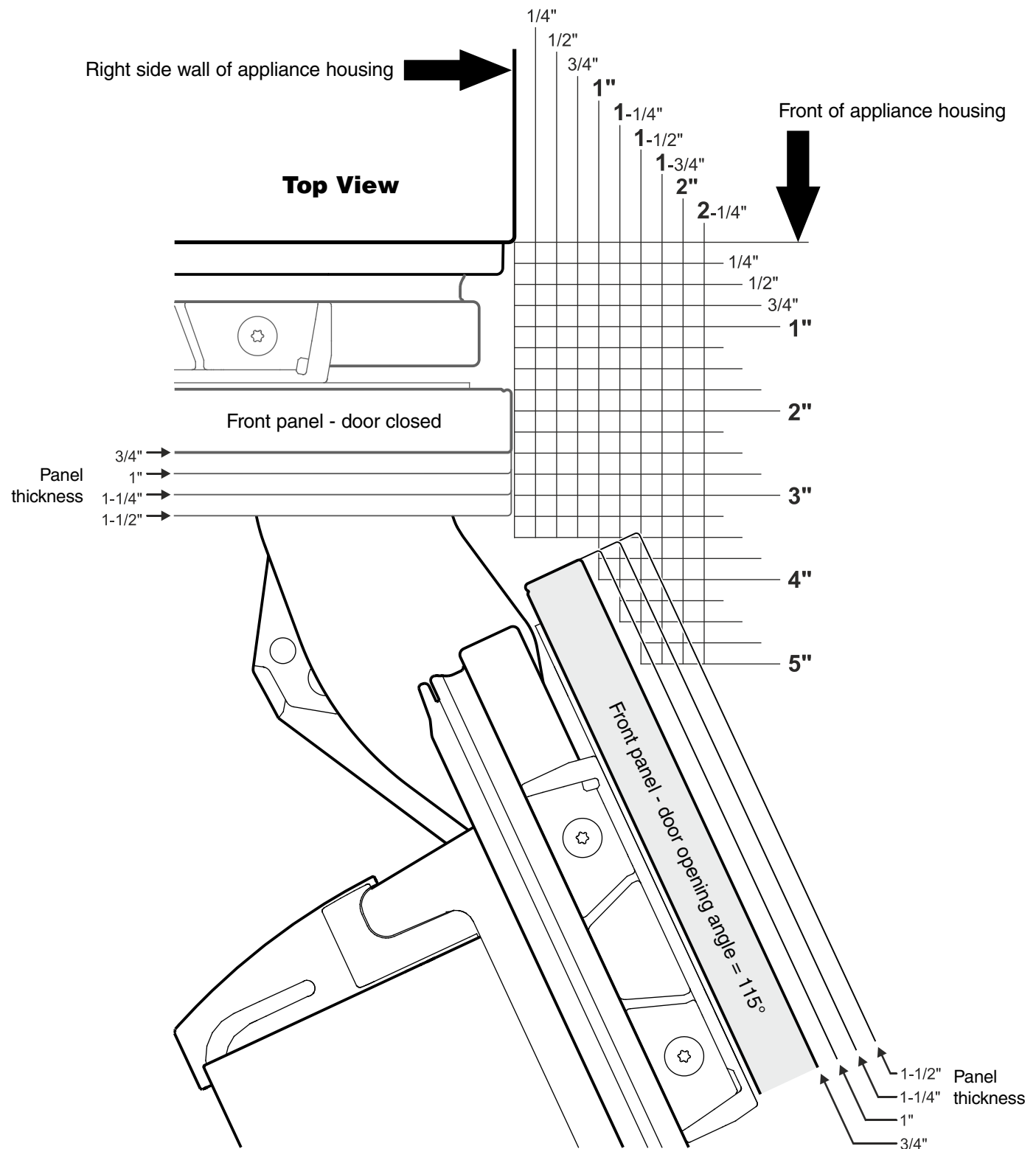
### Door Swing Clearance - Inset installation style

HC 1540, HC1541

HCB 1560, HCB 1561

HC 2060, HC 2061

HCB 2060, HCB 2061



## Fully Integrated

### Door Swing Clearance - Frameless installation style

HC 1540, HC1541

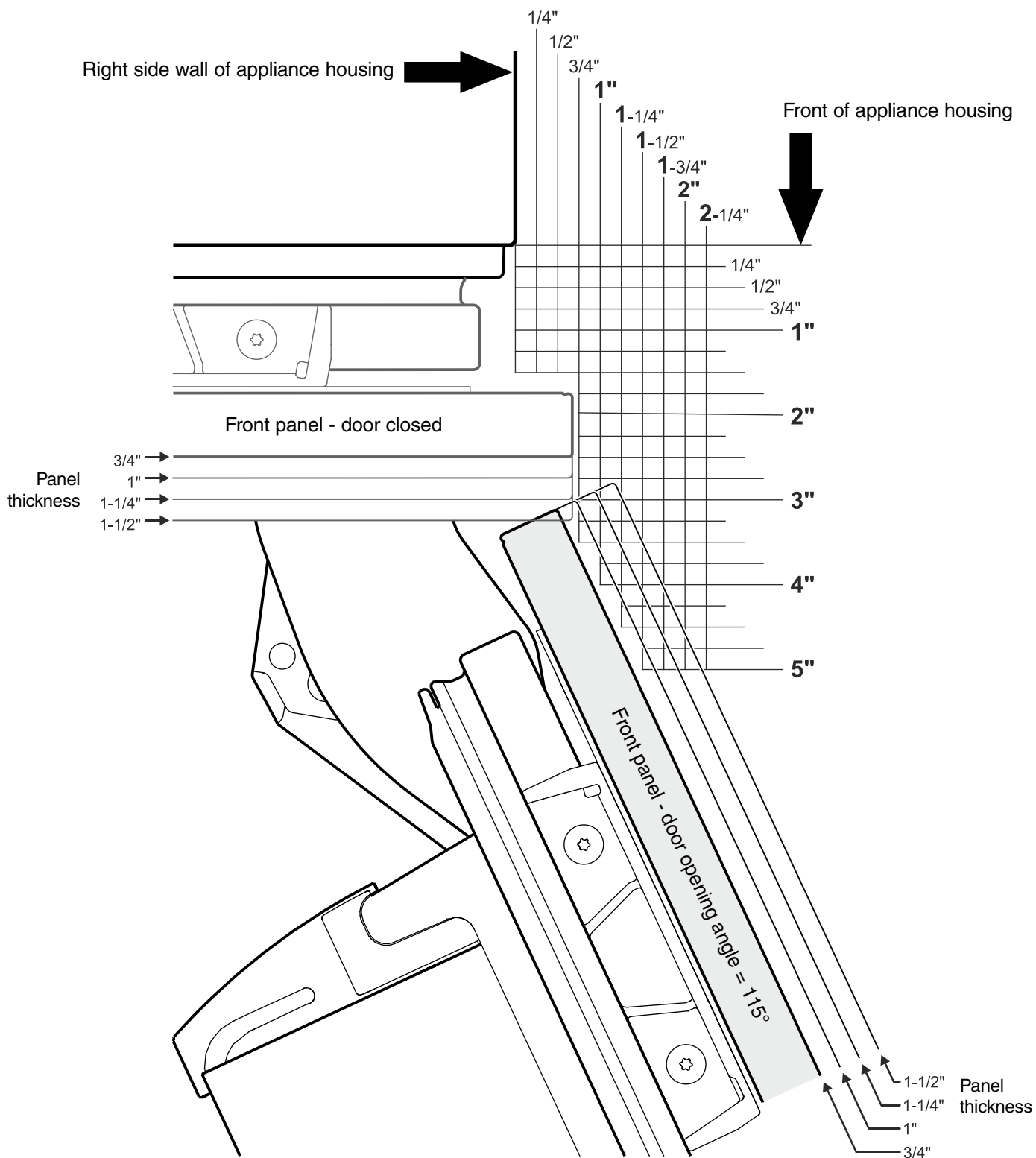
HCB 1560, HCB 1561

HC 2060, HC 2061

HCB 2060, HCB 2061

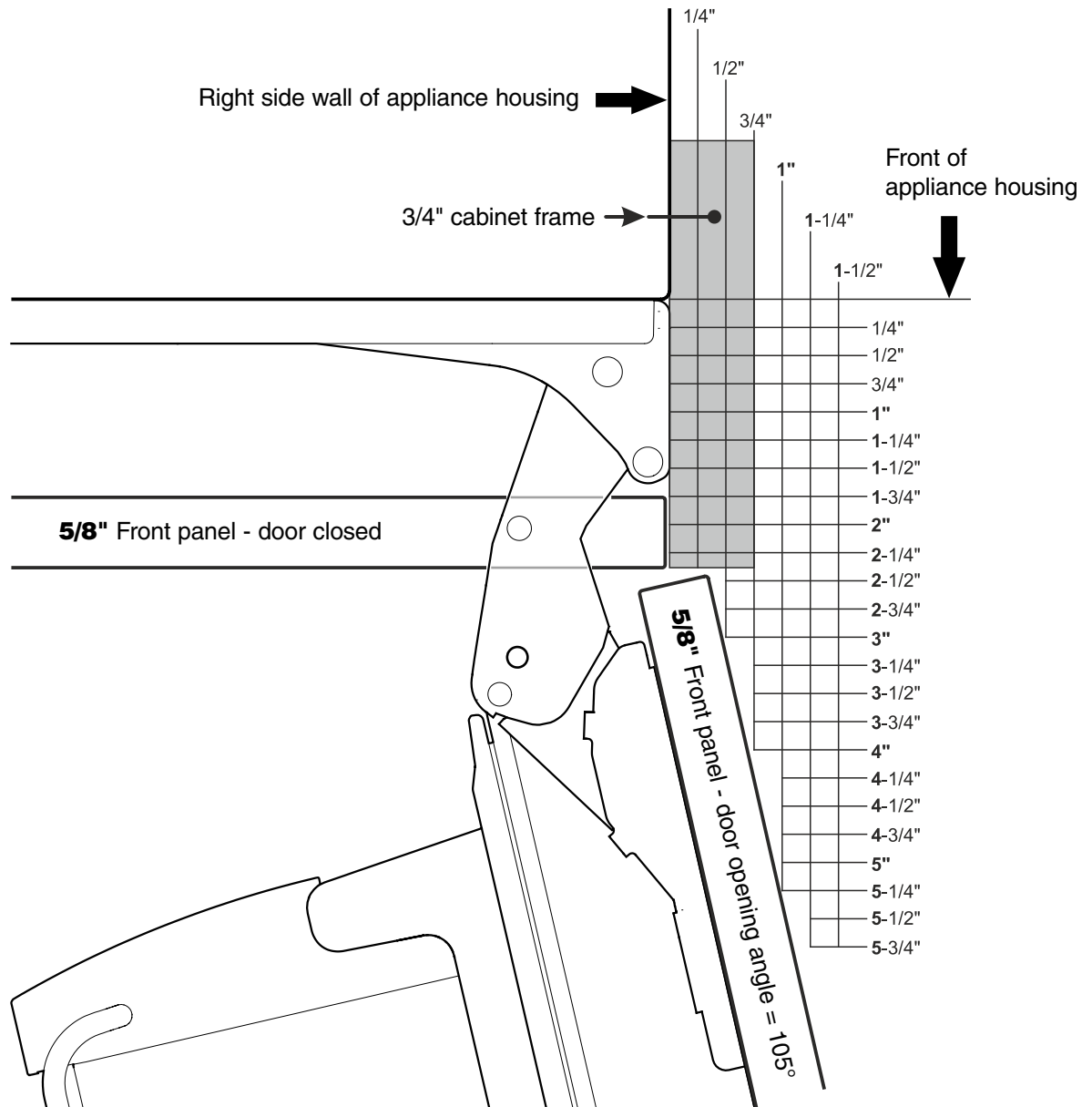
#### **IMPORTANT**

The gap between panels at **frameless** installation style must be at least  $\frac{1}{4}$ " (6 mm).



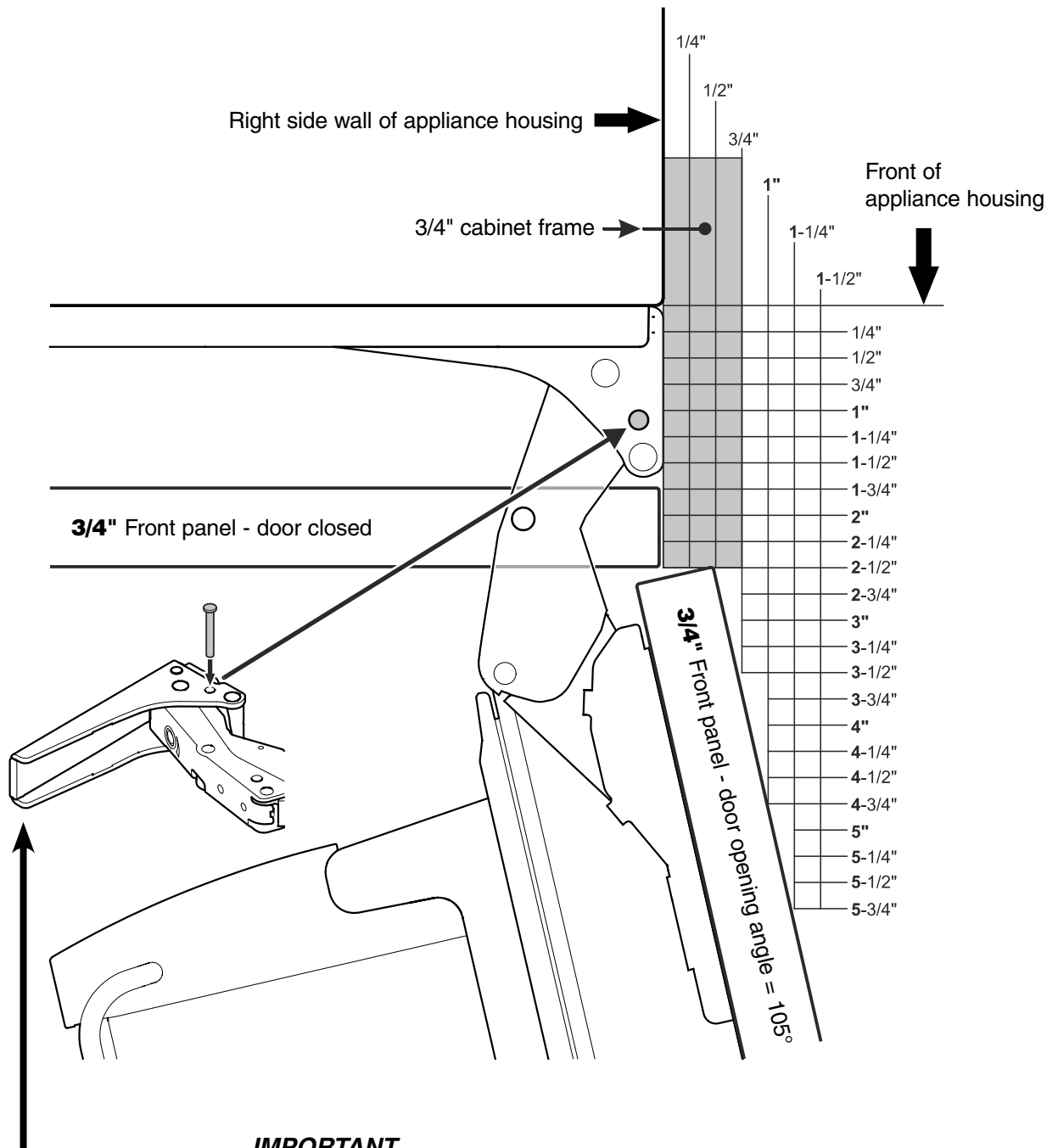
## Door Swing Clearance - Inset installation style - HC 2062 / HCB 2062

### Front panel 5/8"



### Door Swing Clearance - Inset installation style - HC 2062 / HCB 2062

#### Front panel 3/4"



#### **IMPORTANT**

The use of **3/4"** panels at inset installation style requires **95° hinge limitation**.

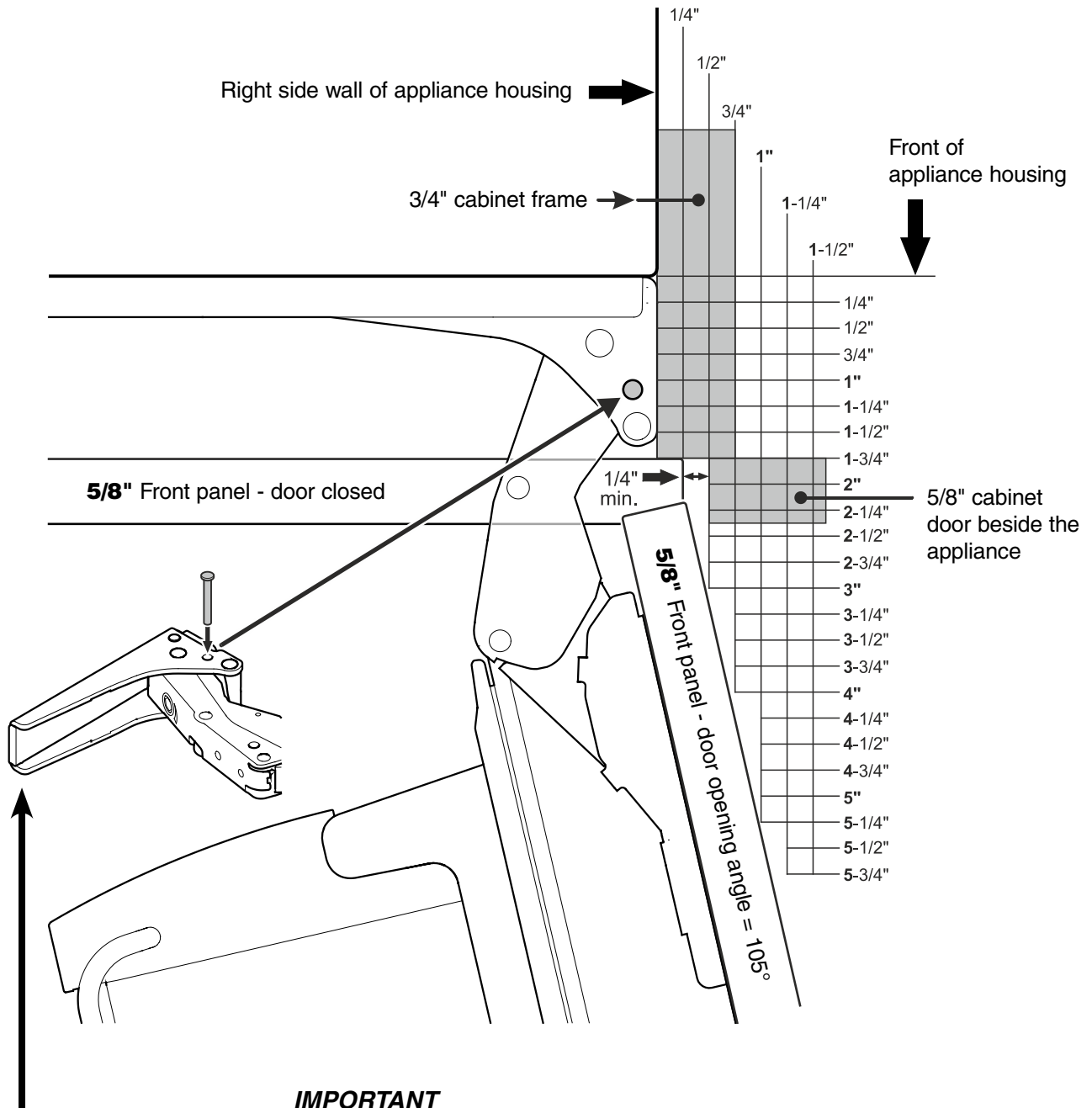
Door stop pins are included with the appliance.

3/4" panels will interfere with the adjacent gable at 105° opening angle.

## Fully Integrated

Door Swing Clearance - Frameless installation style - HC 2062 / HCB 2062

### Front panel 5/8"



#### IMPORTANT

The use of 5/8" panels, **with a reveal of less than 1/4" to the adjacent cabinet panel** requires 95° hinge limitation.

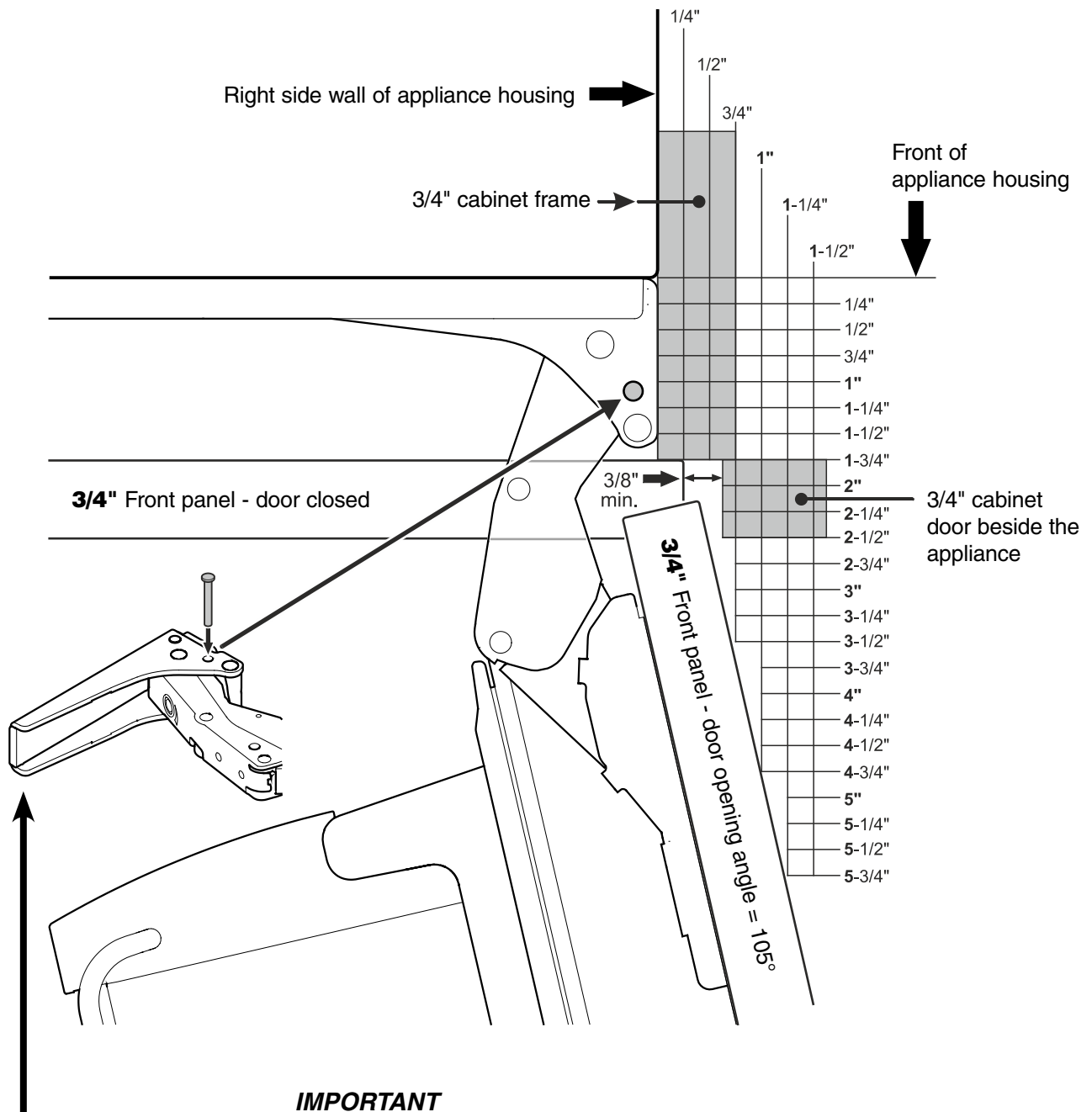
Door stop pins are included with the appliance.

If the reveal is less than 1/4" **the panel will interfere with the adjacent cabinet panel** at 105° opening angle.

**When the hinge is limited to 95° the minimum reveal is 1/8".**

### Door Swing Clearance - Frameless installation style - HC 2062 / HCB 2062

#### Front panel 3/4"



#### IMPORTANT

The use of 3/4" panels, **with a reveal of less than 3/8" to the adjacent cabinet panel** requires 95° hinge limitation.

Door stop pins are included with the appliance.

If the reveal is less than 3/8" **the panel will interfere with the adjacent cabinet panel** at 105° opening angle.

**When the hinge is limited to 95° the minimum reveal is 1/8".**

## Accessories


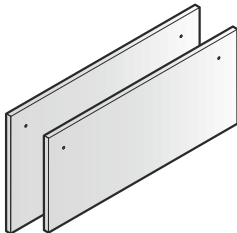
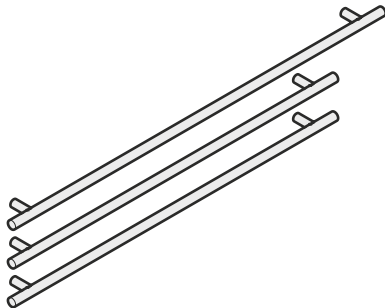
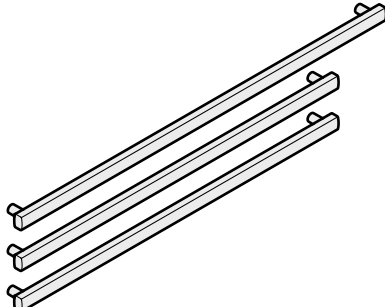

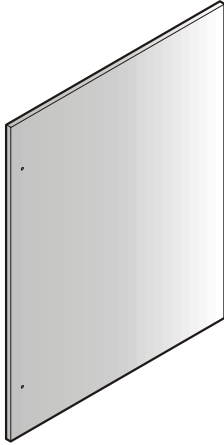
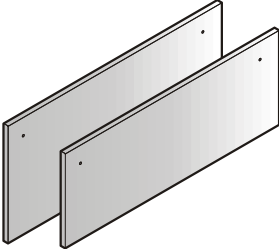
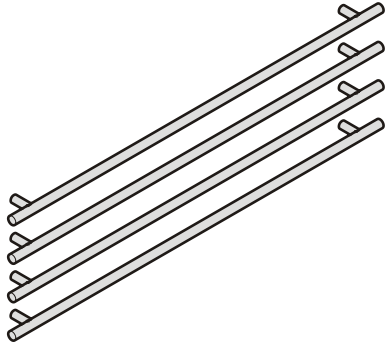
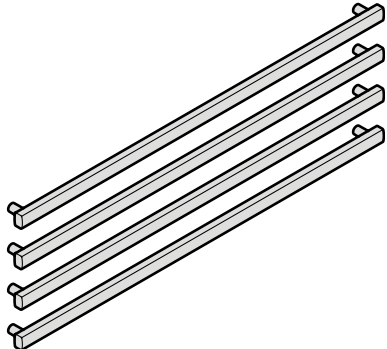
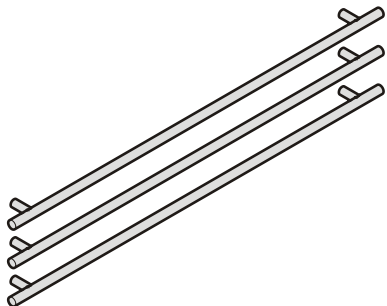
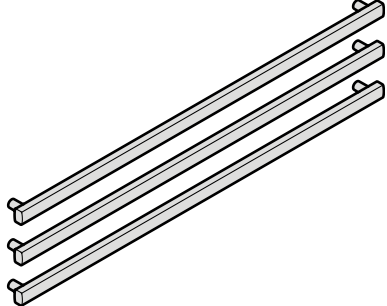
Image	Article number	Name of the item	For use with model
	9900 287-00	Stainless steel panel refrigerator door <b>80"</b> recess height. (Inset installation style) Height: 45 - 1/4" Width: 29 - 3/4" Thickness: 3/4"	HC 1540 HC 1541  HCB 1560 HCB 1561
	9900 285-00	Stainless steel panel refrigerator door <b>84"</b> recess height. (Inset installation style) Height: 49 - 1/4" Width: 29 - 3/4" Thickness: 3/4"	HC 1540 HC 1541  HCB 1560 HCB 1561
	9900 283-00	Stainless steel panels freezer drawers (Inset installation style)  <b>Top panel</b> Height: 13 - 7/16" Width: 29 - 3/4" Thickness: 3/4"  <b>Bottom panel</b> Height: 16 - 9/16" Width: 29 - 3/4" Thickness: 3/4"	HC 1540 HC 1541  HCB 1560 HCB 1561
	9900 279-00	Handle set stainless steel	HC 1540 HC 1541  HCB 1560 HCB 1561
	9900 281-00	Handle set aluminium	HC 1540 HC 1541  HCB 1560 HCB 1561

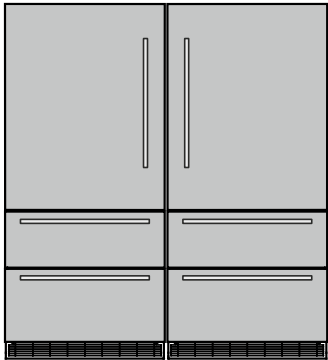
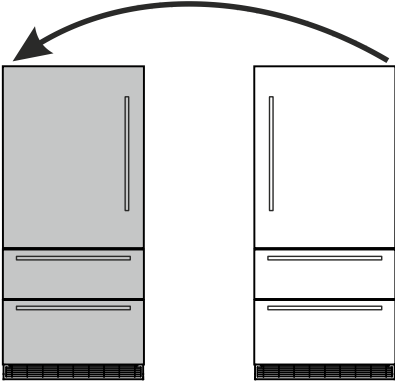
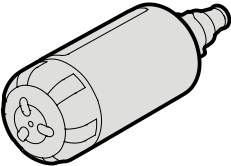
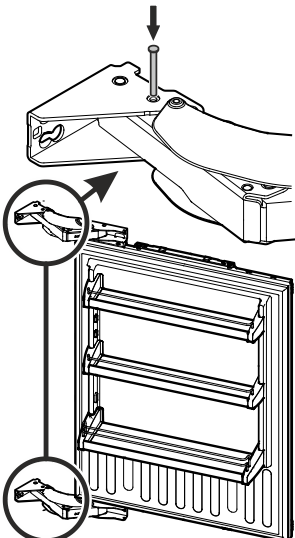


Image	Article number	Name of the item	For use with model
	9900 337-00	Stainless steel panels refrigerator doors <b>80"</b> recess height. (Inset installation style) Height: 45 - 1/4" Width: 17 - 3/4" Thickness: 3/4"	HC 2062 HCB 2062
	9900 335-00	Stainless steel panels refrigerator doors <b>84"</b> recess height. (Inset installation style) Height: 49 - 1/4" Width: 17 - 3/4" Thickness: 3/4"	HC 2062 HCB 2062
	9900 333-00	Stainless steel panel refrigerator door <b>80"</b> recess height. (Inset installation style) Height: 45 - 1/4" Width: 35 - 3/4" Thickness: 3/4"	HC 2060 HC 2061  HCB 2060 HCB 2061
	9900 331-00	Stainless steel panel refrigerator door <b>84"</b> recess height. (Inset installation style) Height: 49 - 1/4" Width: 35 - 3/4" Thickness: 3/4"	HC 2060 HC 2061  HCB 2060 HCB 2061
	9900 323-00	Stainless steel panels freezer drawers (Inset installation style)  <b>Top panel</b> Height: 13 - 7/16" Width: 35 - 3/4" Thickness: 3/4"  <b>Bottom panel</b> Height: 16 - 9/16" Width: 35 - 3/4" Thickness: 3/4"	HC 2062 HCB 2062  HC 2060 HC 2061  HCB 2060 HCB 2061

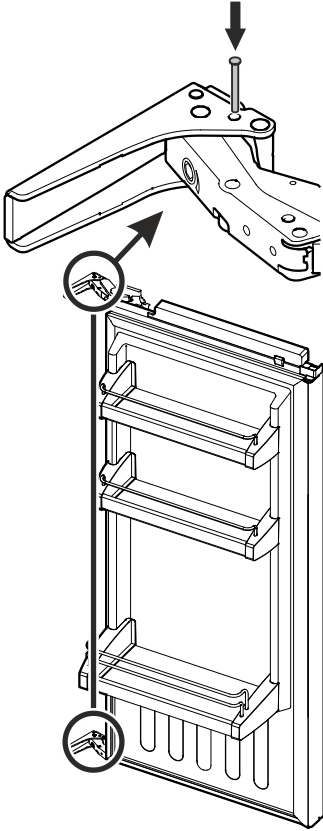
## Fully Integrated

Image	Article number	Name of the item	For use with model
	9900 339-00	Handles stainless steel (4 pcs)	HC 2062 HCB 2062
	9900 513-00	Handles aluminium (4 pcs)	HC 2062 HCB 2062
	9900 327-00	Handles stainless steel (3 pcs)	HC 2060 HC 2061  HCB 2060 HCB 2061
	9900 329-00	Handles aluminium (3 pcs)	HC 2060 HC 2061  HCB 2060 HCB 2061

## Fully Integrated

Image	Article number	Name of the item	For use with model
	9900 219-00	Side by Side Kit Includes anti-sweat panel, connecting parts, covers and assembly instruction.	HC 1540 HC 1541  HCB 1560 HCB 1561
	9900 183-00	Side by Side Kit Includes anti-sweat panel, connecting parts, covers and assembly instruction.	HC 2060 HC 2061  HCB 2060 HCB 2061
	9900 167-00	Door reverse kit	HC 1540 HC 1541  HCB 1560 HCB 1561
	9900 165-00	Door reverse kit	HC 2060 HC 2061  HCB 2060 HCB 2061
	7440 002-00	Water filter	HCB 1560 HCB 1561  HC 2060 HC 2061  HCB 2060 HCB 2061  HC 2062 HCB 2062
	9096 699-00	Door stop pins 90° Largedoor Includes 2 pins and assembly instruction.	HC 1540 HC 1541  HCB 1560 HCB 1561  HC 2060 HC 2061  HCB 2060 HCB 2061

Fully Integrated

Image	Article number	Name of the item	For use with model
	9096 214-00	Door stop pins 95° Frenchdoor. <b><i>One set is included with the appliance.</i></b> Includes 4 pins and assembly instruction.	HC 2062 HCB 2062



