

Quick Setup

IMPORTANT: Before using this product, make sure you read these instructions and the safety instructions in the online *User's Guide*.

Contents

Make sure your projector box includes all of these parts:

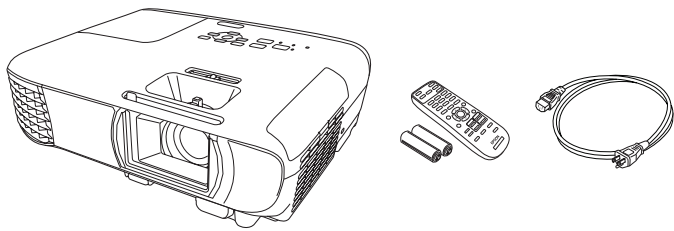

Connect the projector

Choose from the following connections. See the sections below or the online *User's Guide* for details.

Video device

Connect one end of an HDMI™ cable to one of the projector's HDMI ports and the other end to an HDMI port on your video device.

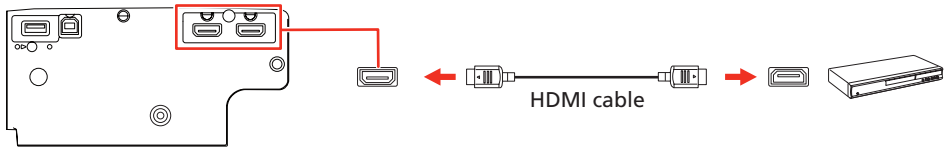

Note: If you connected a streaming device to an HDMI port, you can also connect it to the projector's USB-A (flat) port for power.

Computer

Connect one end of an HDMI cable to one of the projector's HDMI ports and the other end to an HDMI port on your computer.

Note: For more information on connecting the projector to your computer or other devices (camera, USB flash drive, etc.), see the online *User's Guide*.

Connect audio

Built-in speaker

The projector has a built-in speaker that can play audio from a video source (DVD player, streaming device, etc.) connected by an HDMI cable.

External speakers

You can connect the projector to external self-powered speakers through the **Audio Out** port.

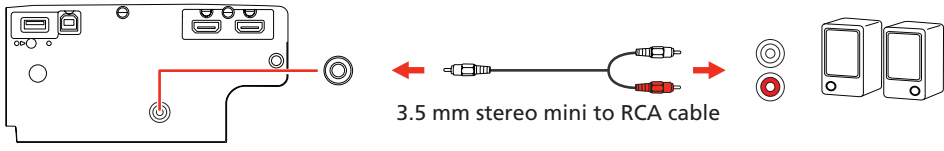

Note: The projector's internal speaker is disabled when you connect external speakers.

Using the remote control

Install the batteries as shown (two AA batteries).

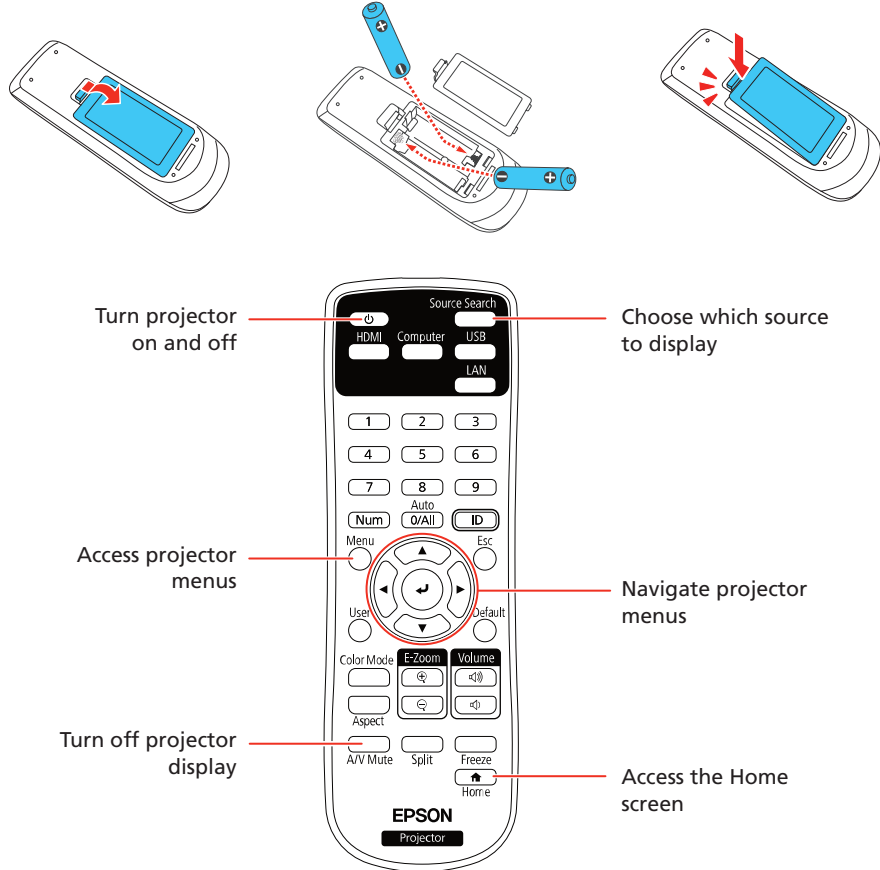

For more information on using the remote control, see the online *User's Guide*.

Turn on your equipment

- 1 Plug in the projector. The power light on the projector turns blue.

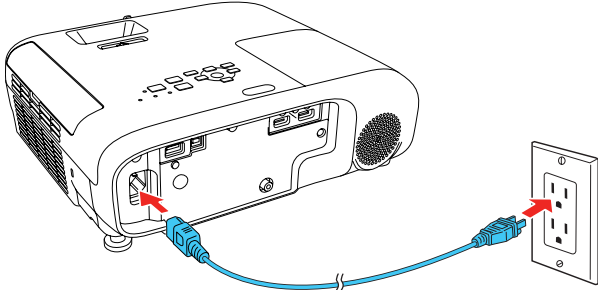

- 2 Open the A/V Mute slide all the way.

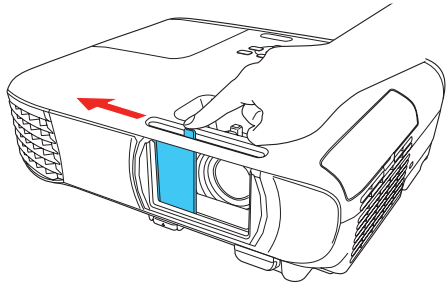

- 3 Press the power button on the projector or remote control. The projector beeps, the Status light flashes blue, and then stays on.

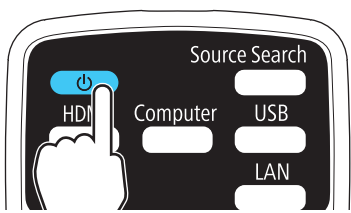

Note: To shut down the projector, press the power button twice.

- 4 When the Home screen appears, use the arrow and buttons on the projector or remote control to switch between projection sources and quickly access various options.

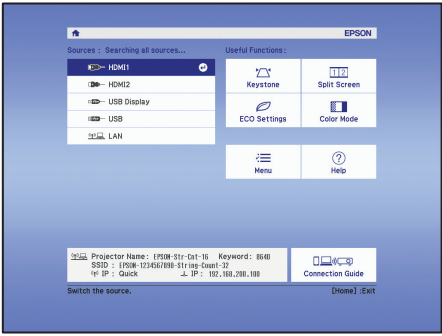

- 5 The default language of the menu system is English. To select another language, press the **Menu** button on the projector or remote control. Select **Extended**, select **Language**, then select your language. Press the **Menu** button to exit the menu system.

- 6 Turn on your computer or video source.

Adjust the image

- 1 If you don't see an image, press the **Source Search** button on the projector or remote control to select the image source.

Note: If you still see a blank screen or have other display problems, see "Troubleshooting."

- 2 To raise the image, press the foot release button and lift the front of the projector. Release the button to lock the foot in position.

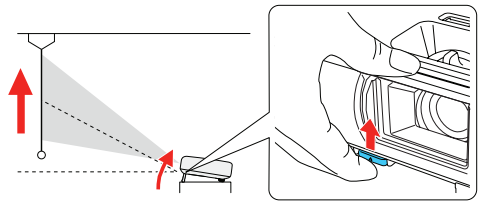

- 3 To reduce or enlarge the image, turn the zoom ring.

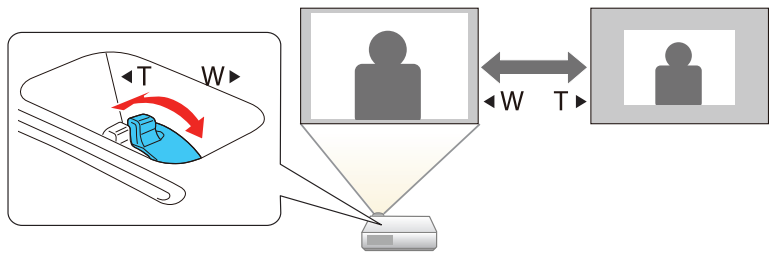

- 4 To sharpen the image, turn the focus ring.

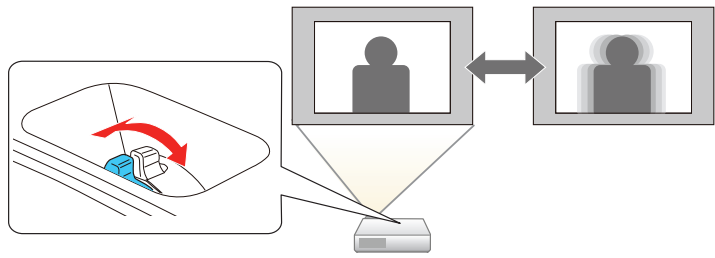

- 5 If your image looks like [trapezoid] or [trapezoid], you may have placed the projector off to one side of the screen at an angle. Place the projector directly in front of the center of the screen, facing the screen squarely. If you can't move the projector, use the horizontal keystone slider on the projector to correct the image shape.

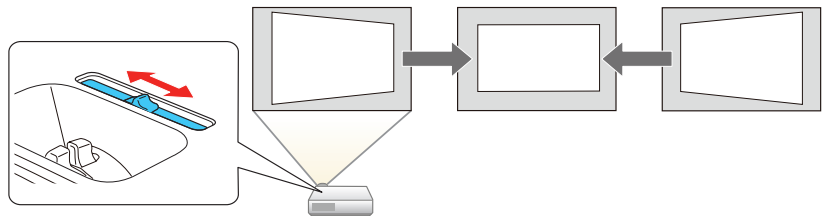

- 6 Your projector automatically adjusts an image that looks like [trapezoid] or [trapezoid], but if necessary you can press the [keystone] or [keystone] button on the projector to correct it.

Troubleshooting

- If you see a blank screen, check the following:
 - Make sure the A/V Mute slide is open.
 - Make sure the Status light on the projector is blue and not flashing.
 - Press the power button or the **A/V Mute** button on the remote control to wake to wake the projector from standby or sleep mode, if necessary.
- If you see a blank screen when a computer is connected, check the following:
 - On Windows, hold down the Windows key and press **P** at the same time, then click **Duplicate**.
 - If you are using a Mac laptop with macOS 13 or newer, select **System Settings > Displays**. Select the projector, then choose the mirror option for your display from the Use as pop-up menu.
 - On macOS 12, select **System Preferences > Displays > Display Settings**. Select the projector, then choose the mirror option for your display from the drop-down menu.
 - On macOS 11 and older, open **System Preferences** and select **Displays**. Click the **Arrangement** tab and select the **Mirror Displays** checkbox.
- If the projector does not respond to remote control commands, make sure the batteries in the remote control are installed correctly. Replace the batteries if necessary.

Registration

Scan the QR code to register for product updates and exclusive offers.



Where to get help

Manuals

For more information about using the projector, you can view or download the manuals from the Epson website, as described below.

Internet support

Visit <http://epson.com/support/hc980> (U.S.), <http://epson.ca/support/hc980> (Canada), or <http://latin.epson.com/support/hc980> (Latin America) to download software and utilities, view manuals, get FAQs and troubleshooting advice, or contact Epson.

Telephone support

To use the Epson PrivateLine™ Support service, call (800) 637-7661. This service is available for the duration of your warranty period. You may also speak with a support specialist by calling (562) 276-4394 (U.S.) or (905) 709-3839 (Canada).

Support hours are 7 a.m. to 4 p.m., Pacific Time, Monday through Friday. Days and hours of support are subject to change without notice. Toll or long distance charges may apply.

In Latin America, see the online *User's Guide* for technical support information.

Optional accessories

For a list of optional accessories, see the online *User's Guide*.

You can purchase screens or other accessories from an Epson-authorized reseller. To find the nearest reseller in the U.S. or Canada, call 800-GO-EPSON (800-463-7766). Or you can purchase online at <http://epsonstore.com> (U.S. sales) or <http://epsonstore.ca> (Canadian sales).

To find the nearest reseller in Latin America, go to <http://latin.epson.com>.





EPSON is a registered trademark of Seiko Epson Corporation.
PrivateLine is a trademark of Epson America, Inc.
Mac, macOS, and OS X are trademarks of Apple Inc., registered in the U.S. and other countries.
Windows is a trademark of the Microsoft group of companies.
General Notice: Other product names used herein are for identification purposes only and may be trademarks of their respective owners. Epson disclaims any and all rights in those marks.
This information is subject to change without notice.
© 2024 Epson America, Inc., 10/24