

# SIGNATURE

KITCHEN SUITE

## WALL OVEN PLANNING / INSTALLATION GUIDE



# WALL OVEN

## PRODUCT DIMENSIONS

### SINGLE WALL OVEN – SKSSV3001S

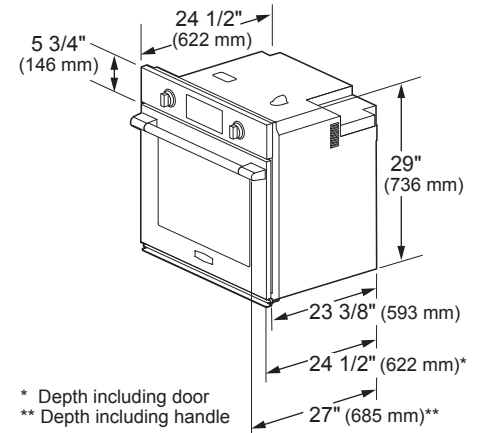
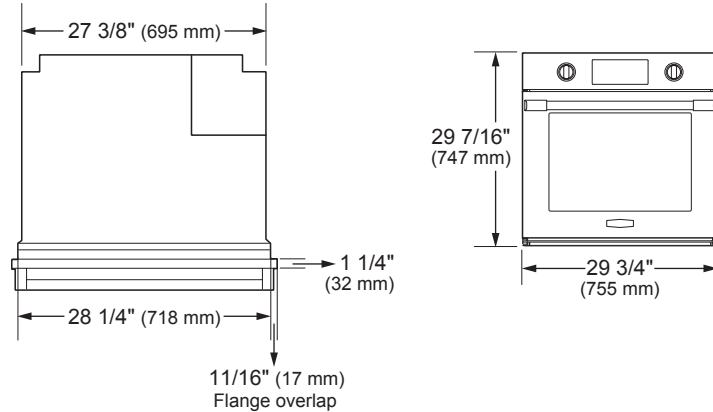

### DOUBLE WALL OVEN – SKSDV3002S

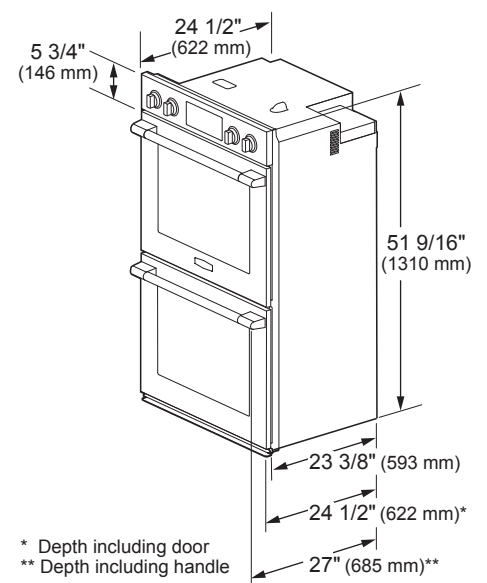
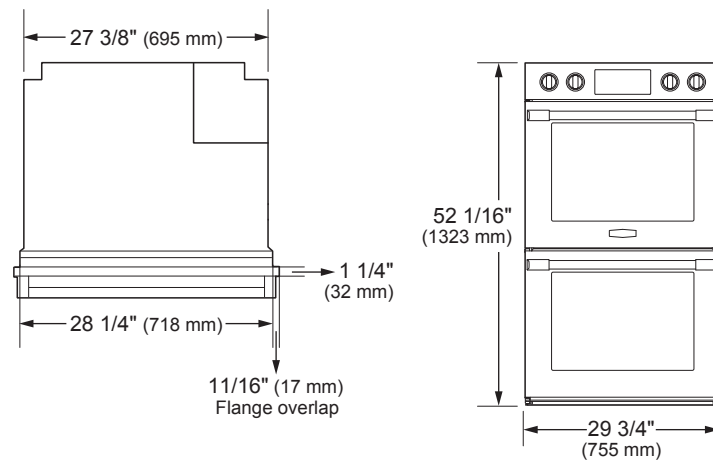

### COMBINATION WALL OVEN – SKSCV3002S

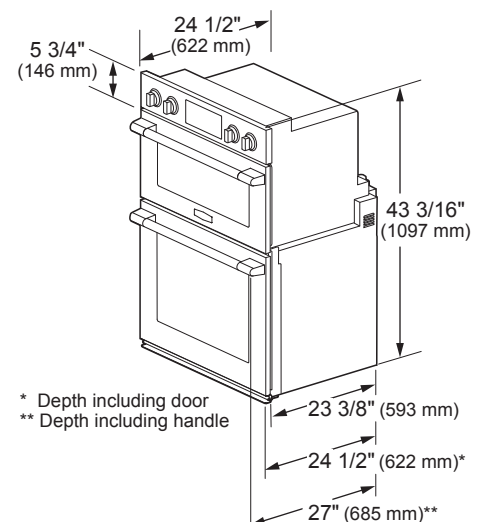
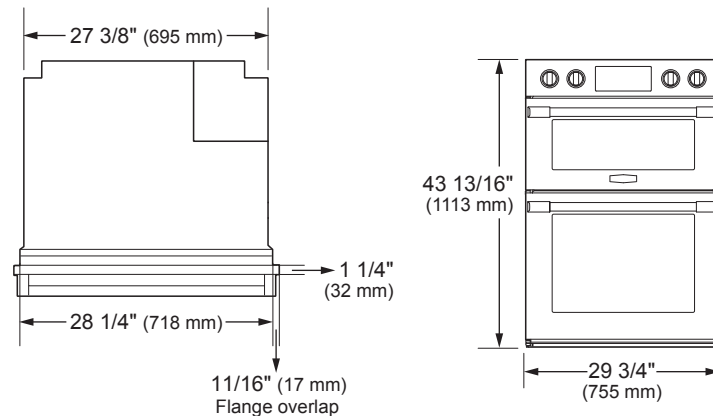

# WALL OVEN

## PROUD INSTALLATION

### SINGLE WALL OVEN – SKSSV3001S

#### CUTOUT DIMENSIONS – PROUD INSTALLATION IN WALL CABINET

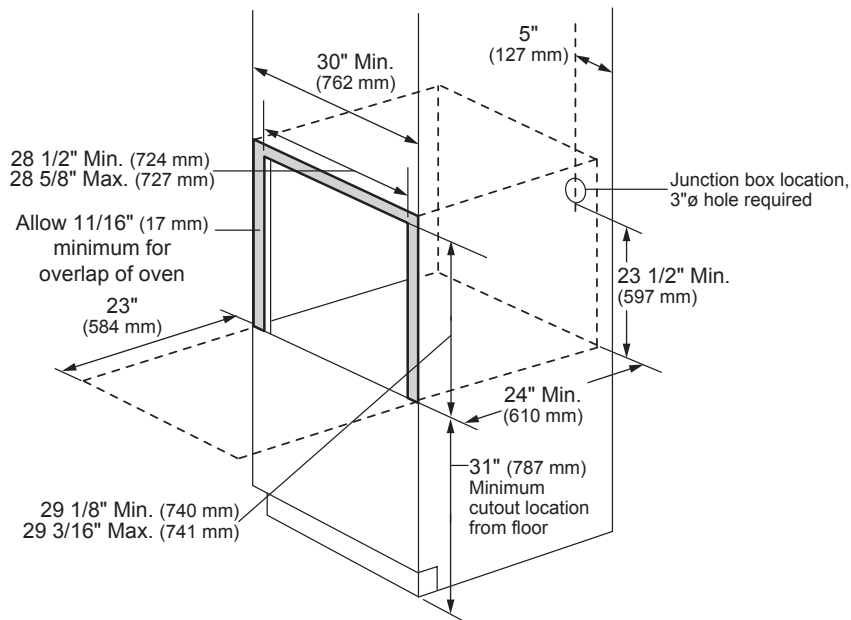

#### CUTOUT DIMENSIONS – UNDERCOUNTER INSTALLATION

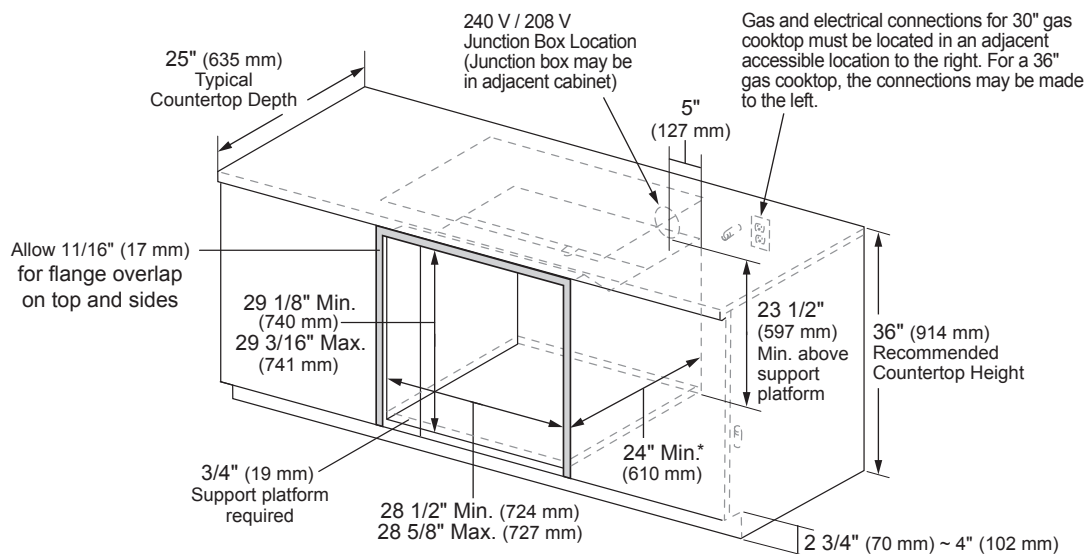

\*25" Min. (635 mm) cutout depth required for undercounter flush installation.  
Refer to installation art for flush installation in wall cabinet for required cutout dimensions.

# WALL OVEN

## PROUD INSTALLATION

DOUBLE WALL OVEN – SKSDV3002S

CUTOUT DIMENSIONS – PROUD INSTALLATION IN WALL CABINET

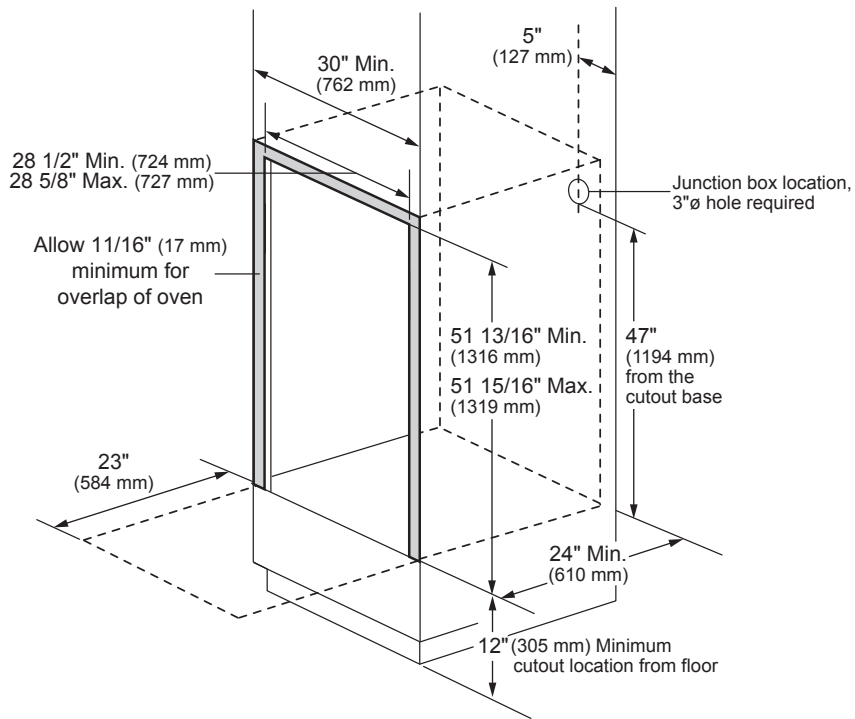

# WALL OVEN

## PROUD INSTALLATION

### COMBINATION WALL OVEN - SKSCV3002S

#### CUTOUT DIMENSIONS – PROUD INSTALLATION IN WALL CABINET

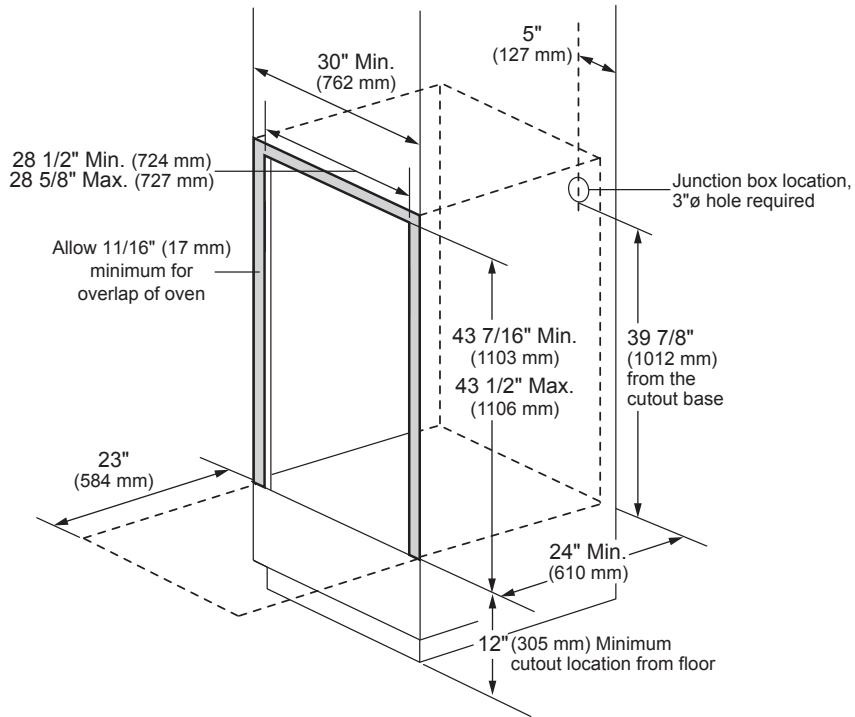

# WALL OVEN

## FLUSH INSTALLATION

SINGLE WALL OVEN – SKSSV3001S

CUTOUT DIMENSIONS – FLUSH INSTALLATION IN WALL CABINET

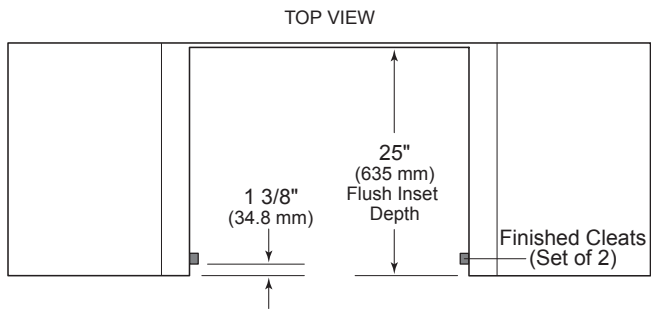
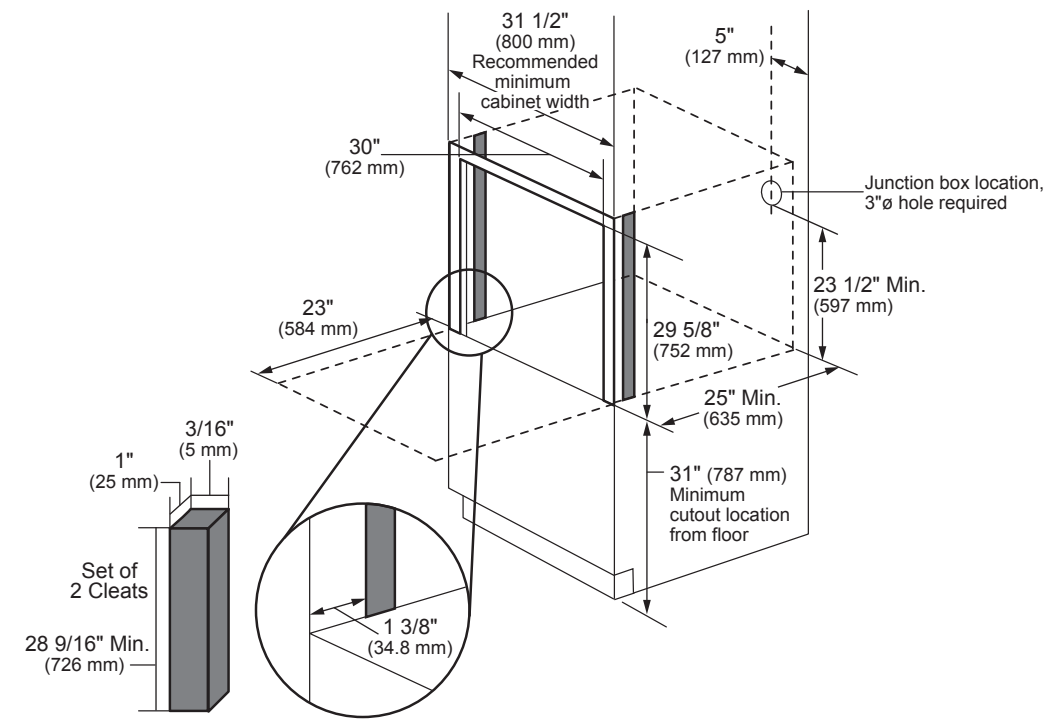

**Notes**

Cleats (spacers) must be recessed 1 3/8" (34.8 mm) from the front of the cabinet.

# WALL OVEN

## FLUSH INSTALLATION

DOUBLE WALL OVEN – SKSDV3002S

CUTOUT DIMENSIONS – FLUSH INSTALLATION IN WALL CABINET

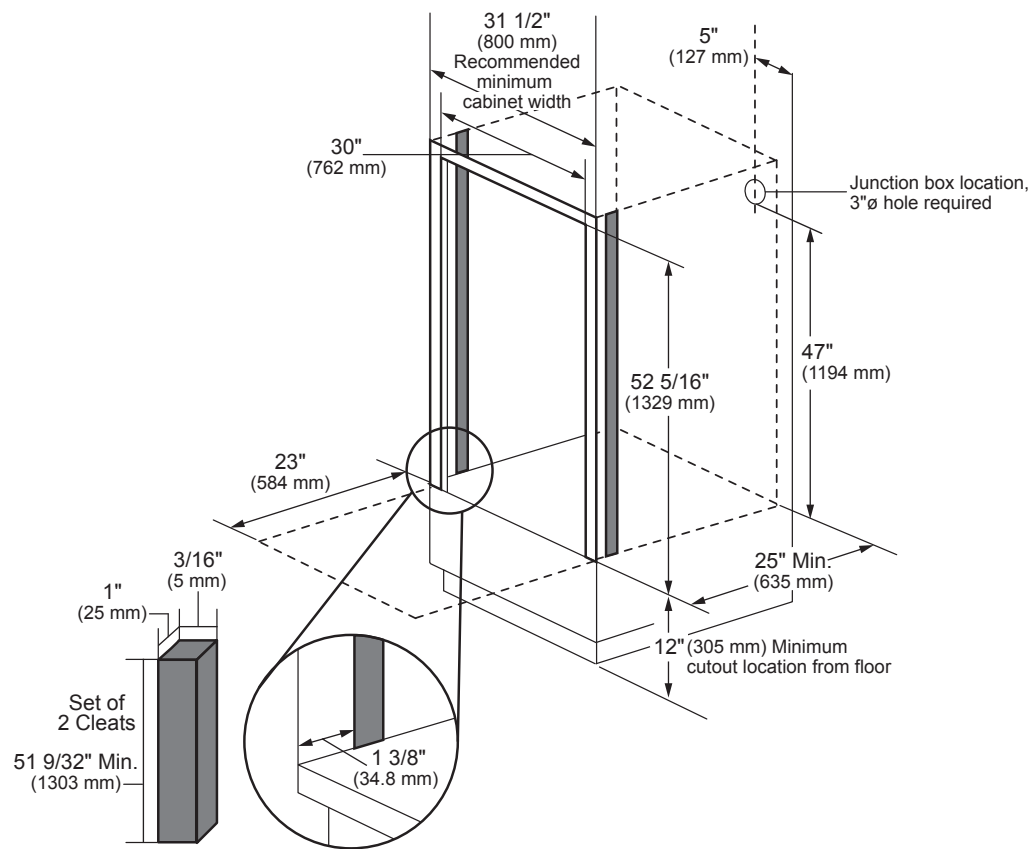

TOP VIEW

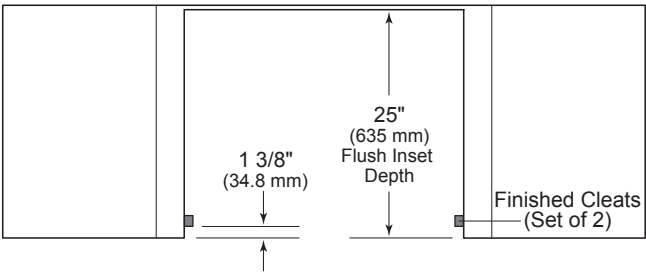

### Notes

Cleats (spacers) must be recessed 1 3/8" (34.8 mm) from the front of the cabinet.

# WALL OVEN

## FLUSH INSTALLATION

### COMBINATION WALL OVEN – SKSCV3002S

### CUTOUT DIMENSIONS – FLUSH INSTALLATION IN WALL CABINET

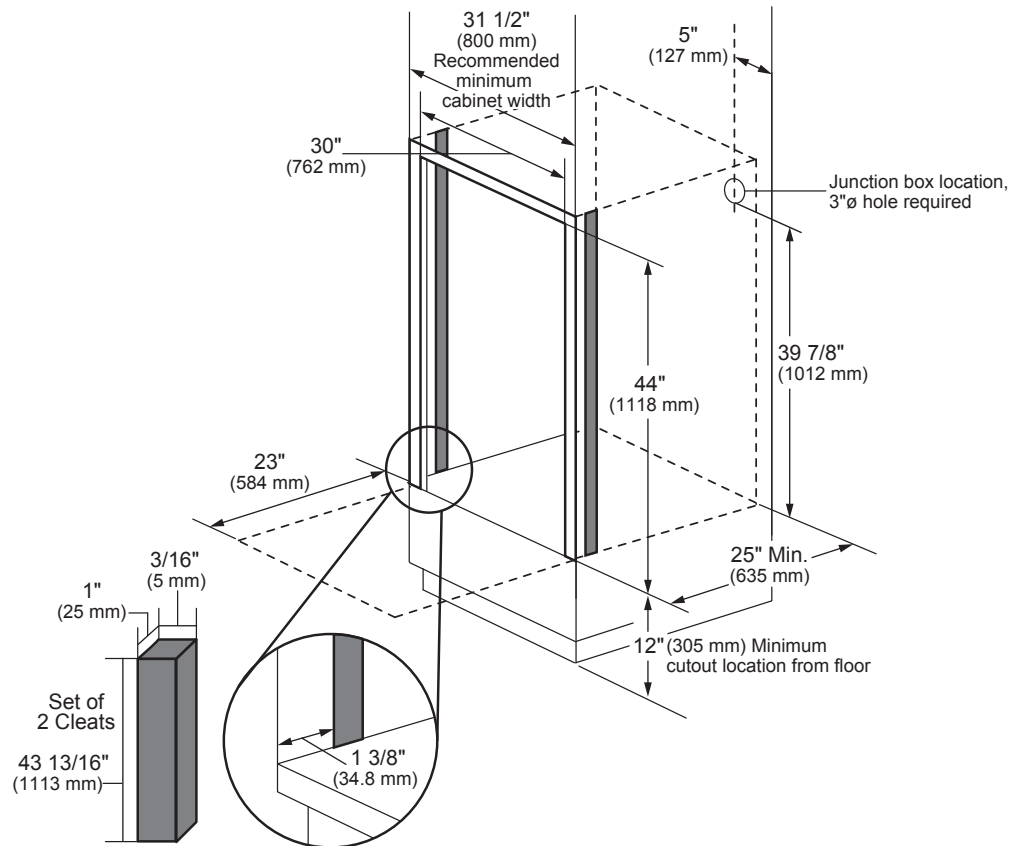

TOP VIEW

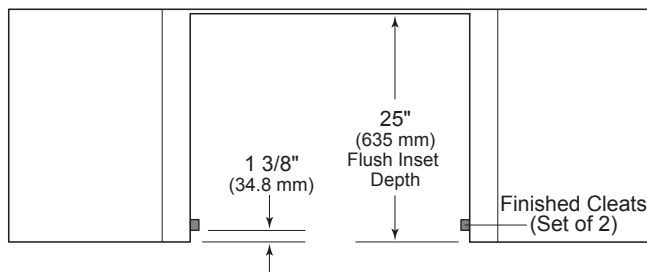

### Notes

Cleats (spacers) must be recessed 1 3/8" (34.8 mm) from the front of the cabinet.