

# Titan

## Massage Chair

3D Tesoro

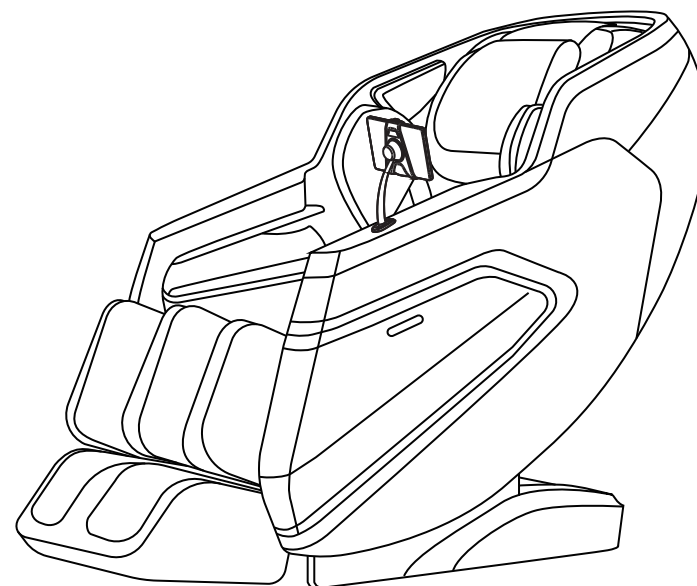

User Guide

To ensure proper use, please read this user manual carefully. After reading, keep it for future reference.  
We reserve the right to make final interpretations regarding the product design.  
Dimensions and specifications are subject to change without notice for ongoing product improvements.

## Contents

---

Safety .....	01-06
Preparation Before Use .....	07-09
Chair Moving .....	07
Chair Placement .....	07
Install Legrest .....	08
Install Backrest Pad and Pillow Pad .....	08
Controller Connection.....	09
Connect Power .....	09
Bluetooth pairing .....	09
Components .....	10-15
Outer Structure .....	10
Controller .....	11
Function of Controller .....	12-15
Cleaning and Maintenance .....	16
Troubleshoot .....	17
Specifications .....	18

# IMPORTANT SAFETY INSTRUCTIONS

This massage chair is household use only. When using an electrical appliance, basic precautions should always be followed, including the following:

Read all instructions before using this massage chair.

## **DANGER**-To reduce the risk of electric shock:

- 1) Always unplug this appliance from the electrical outlet immediately after using and before cleaning.
- 2) Never use pins or other metallic fasteners with this appliance.
- 3) Carefully examine the covering before each use. Discard the appliance if the covering shows any sign of deterioration, such as checking, blistering, or cracking.
- 4) Keep Dry - Do not operate in a wet or moist condition.

## **WARNING**-To reduce the risk of burns, fire, electric shock, or injury to persons:

- 1) An appliance should never be left unattended when plugged in. Unplug from outlet when not in use, and before putting on or taking off parts.
- 2) Do not operate under blanket or pillow. Excessive heating can occur and cause fire, electric shock, or injury to persons.
- 3) Close supervision is necessary when this appliance is used by, on, or near children, invalids, or disabled persons. Keep children away from extended foot support.
- 4) Use this appliance only for its intended use as described in this manual. Do not use attachments not recommended by the manufacturer.
- 5) Never operate this appliance if it has a damaged cord or plug, if it is not working properly, if it has been dropped or damaged, or dropped into water.  
Return the appliance to a service center for examination and repair.
- 6) Do not carry this appliance by supply cord or use cord as a handle.
- 7) Keep the cord away from heated surfaces.
- 8) Never operate the appliance with the air openings blocked. Keep the air openings free of lint, hair, and the like.
- 9) Never drop or insert any object into any opening.

- 10) Do not use outdoors.
- 11) Do not operate where aerosol (spray) products are being used or where oxygen is being administered.
- 12) To disconnect, turn all controls to the off position, then remove plug from outlet.
- 13) Temperatures sufficiently high to cause burns may occur regardless of the control setting. Do not use on an infant or invalid or on a sleeping or unconscious person. Do not use on insensitive skin or on a person with poor blood circulation. Check the skin in contact with the heated area of the appliance frequently to reduce the risk of blistering.
- 14) Do Not Crush - Avoid sharp folds.
- 15) Do not use massager in close proximity to loose clothing or jewelry.
- 16) Keep long hair away from massager while in use.
- 17) Connect this appliance to a properly grounded outlet only. See Grounding Instructions.
- 18) The apparatus shall not be exposed to dripping or splashing and that no objects filled with liquids, such as vases, shall be placed on the apparatus.
- 19) An apparatus with CLASS I construction shall be connected to a MAINS socket outlet with a protective earthing connection
- 20) The appliance coupler is used as the disconnect device, the disconnect device shall remain readily operable.
- 21) This appliance is not intended for use by persons (including children) with reduced physical, sensory or mental capabilities, or lack of experience and knowledge, unless they have been given supervision or instruction concerning use of the appliance by a person responsible for their safety.
- 22) If it is not in use for a long time or after use, please turn off the power and pull out the power plug.
- 23) Do not damage, break, over-bend, compress, tighten, wind, rotate or knot the power cord.
- 24) This appliance can be used by children aged from 8 years and above and persons with reduced physical, sensory or mental capabilities or lack of experience and knowledge if they have been given supervision or instruction concerning use of the appliance in a safe way and understand the hazards involved. Children shall not play with the appliance. Cleaning and user maintenance shall not be made by children without supervision.

## Safety

---

### SAVE THESE INSTRUCTIONS

This massage chair is intended for household use only.

#### ● Usage Environment

- Do not use the massage chair in an excessively humid or dusty environment as this may result in malfunction or electric shock.
- Do not use the massage chair in a room with a temperature of 104°F or higher.
- Do not expose the massage chair to heaters, stoves or direct sunlight.
- Place and use the massage chair on an even, non-slip floor.
- The massage chair is designed for home use and not for commercial purposes.

#### **Caution**

- The massage chair is to be used indoors only.
- If you use the massage chair in a cold room, do not increase the room temperature abruptly. It is recommended that you increase the temperature gradually to a normal level.
- If the massage chair is stored in a cold place and is being brought into a warm environment, it is advisable to wait one hour before use. This is because its performance may not be at optimum level, as there may be water droplets on the mechanical parts due to condensation. Using the massage chair under such conditions may result in malfunction.

### IMPORTANT SAFETY INSTRUCTIONS

#### ● Safety Precautions

- To ensure safe and correct use of the massage chair, do not operate it without reading this operation manual carefully.
- Do not use the massage chair when the upholstery or seat is removed. This may cause injury or malfunction.
- Do not use the massage chair in combination with other therapeutic equipment or electric blanket, etc., as this may result in ineffectiveness or injury.
- Do not use the massage chair an hour before or after eating as this may have adverse effects on the user.
- Do not allow children or pets to play around the massage chair, e.g., behind the backrest, under the seat or leg rest of the massage chair. This may result in injury.

## Safety

---

- Do not rest or place heavy objects on the armrests, leg rest or backrest as this may result in malfunction or injury.
- Do not use the massage chair when your body is wet.
- Do not operate the massage chair with wet hands.  
It is not recommended to use the massage for more than 30 minutes.
- Do not perform continuous massage on the same spot of your body for more than 5 minutes at a time as this may result in excessive stimulation and may have adverse effects.
- Do not insert your hand or foot along the paths of the massage rollers during use as this may cause injury.
- Stop operation immediately if you experience any discomfort.
- This product is not intended for self-treatment of conditions that should be managed by a qualified health care provider.
- People on medication or with medical conditions, please consult your doctor before use.
- Please do not use the product if you are not feeling well.
- Remove all scarves, neckties, necklaces and jewelry before using the massager.

#### ● People with Medical Conditions

Consult your doctor before use if you:

- are under medical rest as ordered by a doctor.
- have spinal disorders, an abnormal spinal condition or have suffered a spinal injury.
- have back problems.
- have diabetes, osteoporosis or sensory impairment.
- have joint dysfunction.
- have a pacemaker or other electronic medical devices.
- may be pregnant.
- have phlebitis or thrombosis.
- have an increased risk for blood clots.
- had recent surgery.
- have surgical pins, screws, or anything mechanical implanted in your body.

## Safety

### ● Instances When the massage chair Should Not Be Used

In the following events, please switch off the main power switch immediately and disconnect the power cord from the electrical outlet:

- If water is accidentally spilled onto the massage chair. This may result in electric shock or malfunction.
- If the fabric of the backrest is torn and the internal components are exposed.
- If pain or discomfort is felt during massage, stop operation immediately and consult your doctor.
- If you detect any malfunction or any other abnormal condition during operation.
- If there is a power failure. Injury may occur when power is restored unexpectedly.
- If there is lightning.

### ● Assembly and Repair of the massage chair

- Do not disassemble the backrest cover of the massage chair. Touching the internal components may result in malfunction or electric shock.
- The massage chair must only be professionally serviced or repaired. Do not attempt to disassemble or repair the massage chair yourself.

### ● Things to Note About the Power Plug and Cord

- Check that the Alternating Current (AC) voltage corresponds with the specifications indicated for the massage chair.
- Do not connect or disconnect the power plug from the electrical outlet with wet hands. This may result in malfunction or electric shock.
- When disconnecting the power plug, pull it by holding the plug, not the cord.
- Although operation will be stopped automatically by the Auto-Timer function, always remember to switch off the main power switch after use.
- Do not place the power cord under the massage chair or any other heavy objects.
- Do not wind the power cord around the massage chair as this may damage the cord and result in a fire or electric shock.
- Do not operate the massage chair with a damaged cord or extension cord.
- Do not use the massage chair if the electrical outlet is loose.
- If the power cord is damaged, it should be replaced by a qualified technician.

## Safety

### ● Grounding Instructions

This product must be grounded. If it should malfunction or breakdown, grounding provides a path of least resistance for electric current to reduce the risk of electric shock. This product is equipped with a cord having an equipment-grounding conductor and a grounding plug. The plug must be plugged into an appropriate outlet that is properly installed and grounded in accordance with all local codes and ordinances.

**DANGER** – Improper connection of the equipment-grounding conductor can result in a risk of electric shock. Check with a qualified electrician or serviceman if you are in doubt as to whether the product is properly grounded. Do not modify the plug provided with the product – if it will not fit the outlet, have a proper outlet installed by a qualified electrician. For a grounded, cord-connected product rated less than 15 A and intended for use on a nominal 120-V supply circuit:

This product is for use on a nominal 120-V circuit and has a grounding plug that looks like the plug illustrated in sketch A in above. Make sure that the product is connected to an outlet having the same configuration as the plug. No adapter should be used with this product.

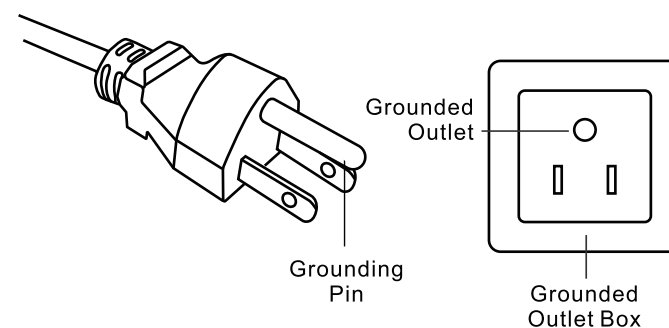

## Preparation Before Use

### Moving the Chair

- Turn off the main power switch and unplug the chair from the electrical outlet.
- Tilt the chair backward as shown in the picture below and roll it to the desired location.
- Place a protective covering on the floor before moving to help prevent damage.

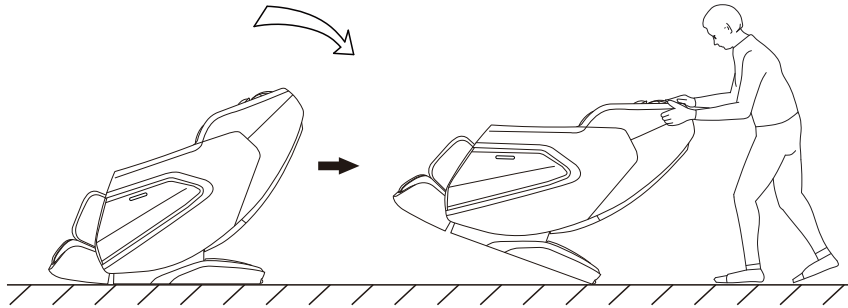

### Chair Placement

Ensure that there is more than 5cm clearance behind and more than 35cm clearance in front of the massage chair to allow the backrest to recline without obstruction during operation.

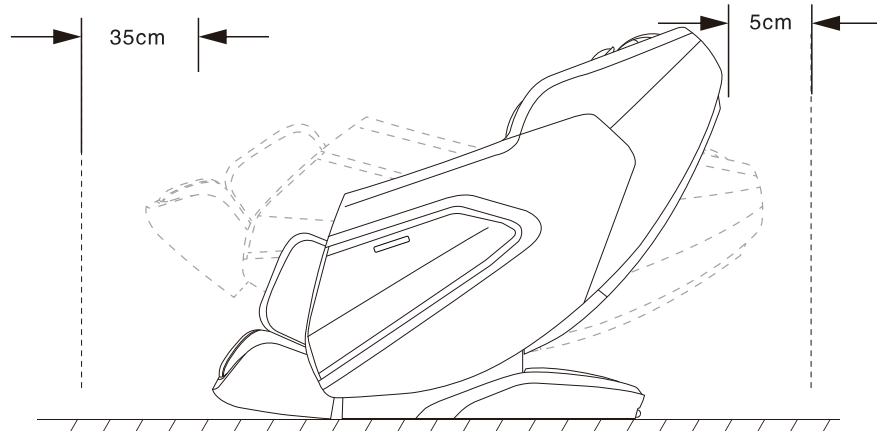

07

## Preparation Before Use

### Backrest and pillow pad installation

- Attach the upper backrest pad to backrest with zipper.
- Attach the pillow pad to backrest with velcro.

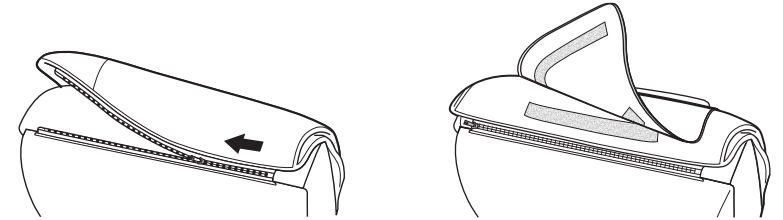

- Attach the left side of backrest pad to backrest with zipper, same as the other side.

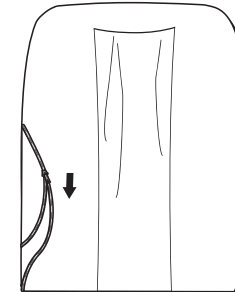

### Installation of manual bracket

- Aligned holes, tighten screws.
- Press down to align the snap.

Note: The arrow direction is towards the front of the handrail.

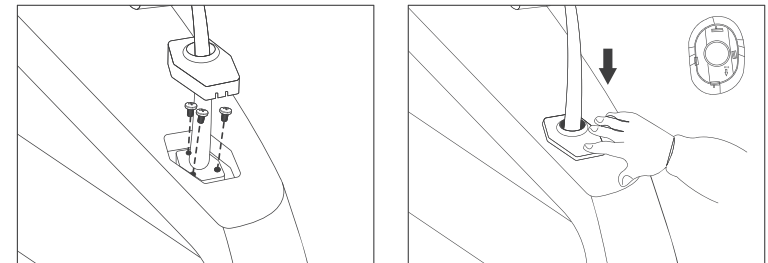

08

## Preparation Before Use

### Remote Controller Connection

- Connect the cable of remote controller with the cable under seat.

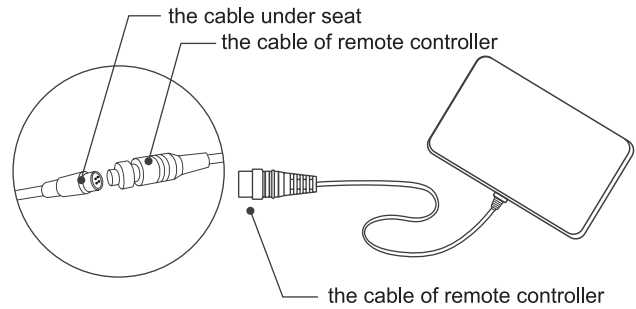

### Connect power

- Plug the power cord into power inlet and turn on the power switch.

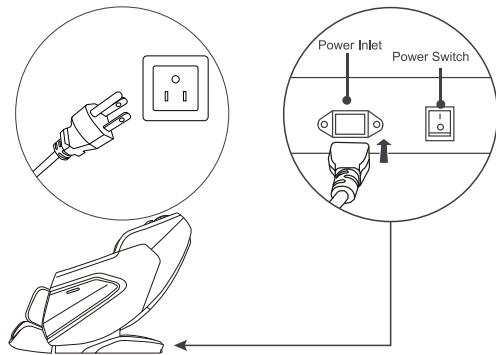

### Bluetooth Pairing

- In your phone's Bluetooth settings, select "3D Tesoro" from the device list to pair.

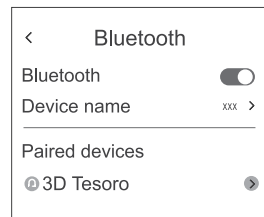

## Components

### Outer Structure

Shoulder  
Massage Unit

Shortcut Key

Arm  
Massage Unit

Leg  
Massage Unit

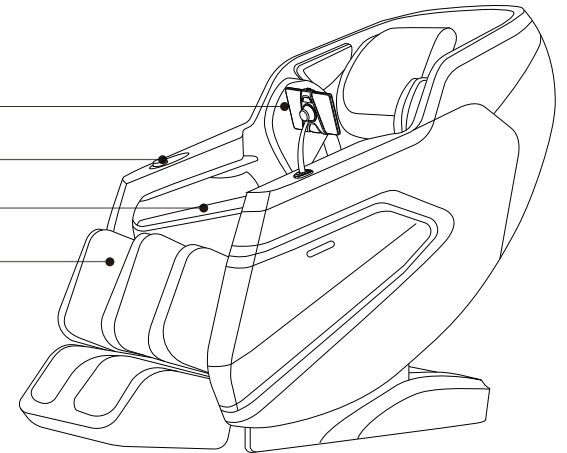

Pillow

Backrest pad

Armrest

Casters

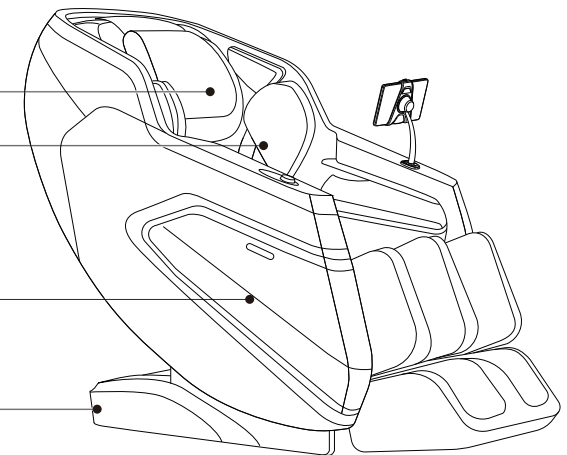

## Components

### Controller

(The specific display is subject to the actual product.)

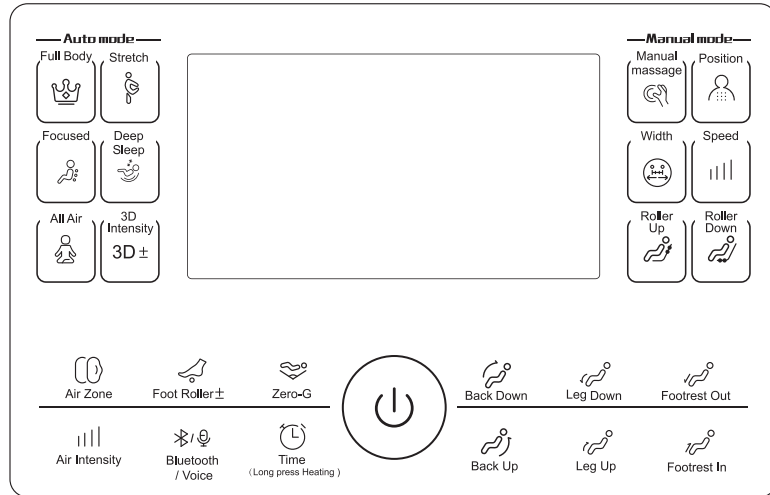

### ⚠ Caution

- Do not sit, step or place heavy objects on the controller.
- Do not drop the controller. It is recommended that the controller unit be placed in the controller side pocket when not in use.
- Do not exert excessive force on the controller.
- Do not handle the controller with wet hands.
- Do not operate the controller by using sharp-edged or hard objects. It may result in damage.

## Components

### Controller Intruction

Function	Icon	Description
Power		Press and hold the button to turn on/off the massage chair. Press the button shortly to pause/resume the massage function.
Full Body		Click the button to switch between the six automatic programs: Master/Refreshing/Relaxing/Sport Care/Soft and Spine Care.
Stretch		Press the button to turn the Stretch mode.
Focused		Click the button to switch between the three automatic programs: Neck & Shoulder/Waist & Back and Slim.
Deep Sleep		Press the button to enable deep sleep mode.
All Air		Press the button to activate the full-body airbag function.
3D Intensity		Press this button to adjust the 3D intensity, press one time to increase a level of strength. When it reaches the strongest strength level, press one time to return to the lowest strength level.
Manual massage		Press this button to switch to manual massage. You can choose different massage methods according to your body's needs.
Width		Adjust the back roller width for Tapping / Clapping / Rolling.
Position		Press this button to select "spot", "local" or "full body" massage. "Spot" massages the fixed points on the back. "Partial" massages the area between 2 selected spots on the back. "full body" massages the biggest area between the mechanism beginning and ending points. Long press "Mech Up"/"Mech Down" to adjust the massage points.
Speed		Press this key to adjust the massage speed of the mechanism. Each press to increase one speed level. It is adjustable up to 6 levels of speed.

## Components

Function	Icon	Description
Mech Up / Mech Down		In auto mode, when shoulder position is detected, long press this button to further adjust shoulder position up / down. In the manual mode, long press this button to adjust the position of the mechanism up /down.
Back up / Back down		Long press this button to adjust the up / down of the backrest, and release the button to lock the current angle of the backrest.
Leg up / Leg down		Long press this button to adjust the up / down of the Legrest, and release the button to lock the current angle of the Legrest.
Footrest In / Footrest Out		Long press this button to adjust footrest extend in/out.
Air Zone		Press this button to turn on/turn off airbag massage function/switch airbag position.
Air Intensity		When the air bag massage is on, press this button to adjust the air bag massage intensity. Press once to increase the intensity by one level until it hits the maximum intensity level, and then press this button to return to the lowest intensity level.
Foot Roller ±		Press to turn on/off the function and adjust the strength from level 1 to level 3.
Bluetooth / Voice		Bluetooth is enable by default, press the button to turn off/on the Bluetooth. Long press the button to turn off/on voice broadcast.
Zero-G		Press this button to activate the zero gravity position, which can be adjusted up to three stages. This function will be locked in the program with angle adjustment.
Time (Long press Heating)		Press this button to set the massage time. The selected time is 15-30 minutes. Long press to turn on the heating function.

## Components

### Control Display

(The specific display is subject to the actual product.)

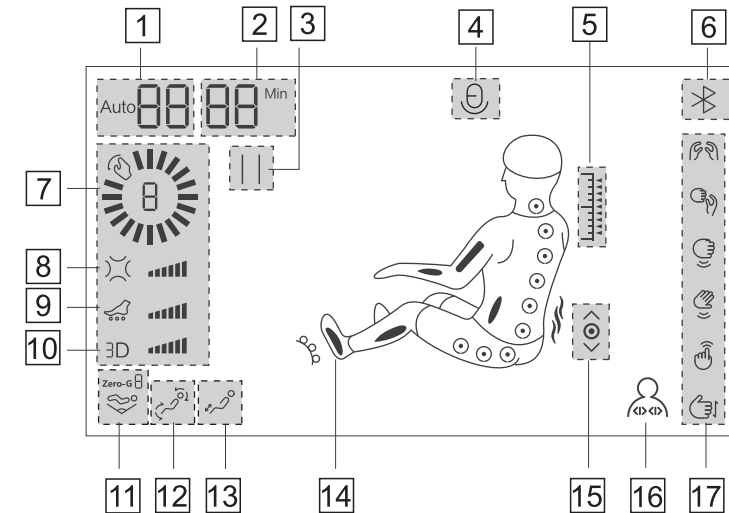

- 1** Auto/Manual Program Display Area      **2** Time      **3** Pause
- 4** Voice      **5** Auto Body Scanning: The corresponding area flashes.
- 6** Bluetooth Speaker      **7** Back Roller Speed      **8** Airbag Intensity
- 9** Foot Roller Speed      **10** 3D Intensity
- 11** Zero gravity display area:
- 12** Backrest Up/Down:
- 13** Extend up / Extend down:
- 14** Heating: Light up when in use Airbag massage: The corresponding area flashes   
Foot Roller: Light up when in use Back Roller: The corresponding area flashes.
- 15** Back Roller Display Area: Full Body Spot Local
- 16** Massage Width: Wide Medium Narrow
- 17** Massage Techniques: From top to bottom: Kneading-Knocking-Tapping-Clapping-Shiatsu-Rolling. The selected technique flashes when used.

## Components

Function	Description
Master	Master mode, full body massage, the strong intensity of roller and airbag massage.
Relaxing	Relaxing mode, full body massage, medium intensity for roller and airbag massage.
Sport Care	Full body massage, specially suited for athletes and fitness person.
Soft	Suitable for the elderly and children, full body massage, roller and airbag massage in the lightest way to improve back pain and leg cramp for the elderly.
Stretch	Full body massage that stretches the legs, back, and arms.
Deep Sleep	Full body massage, push rod up/down, slow swing function, light intensity for rollers.
Spa	The roller is not working, the full body airbag massage and the foot roller are as relaxing as the spa.
Refreshing	Full body massage, wakes up the body, stronger intensity for roller and airbag massage.
Spine Care	Full body massage, medium intensity for airbags, focus on shoulder and neck massage, improve long-term sedentary neck and shoulder pain for office workers.
Waist & Back	Partial massage that focuses on the back and back massage to improve back pain, while the roller focuses more on the waist back massage.
Neck & Shoulder	Partial massage that focuses on improving neck pain and shoulder muscle strain, while the roller is focusing more on the neck and shoulder massage.
Slim	Full body massage, helpful for slimming waist and hip.

## Cleaning and Maintenance

### 1. Storing the Massage Chair

- After each use, wipe the chair with a dry, soft, clean cloth.
- Keep the chair in a clean, dry place away from high humidity.
- If the chair will not be used for an extended period, unplug it from the outlet and cover it with a dust cover.

#### Caution:

- Do not store the chair in direct sunlight or high-temperature environments, as this may cause fading or damage to the upholstery.
- Avoid prolonged contact between the chair and vinyl surfaces or wallpaper, which could lead to discoloration.

### 2. Cleaning the Massage Chair

- Make sure the main power switch is off and the power plug is unplugged before cleaning.
- Wipe away dust and dirt with a dry, soft cloth after each use.
- For deeper cleaning, use a slightly damp cloth.
- Do not iron the upholstery.
- Do not wash the upholstery in a home washing machine, as this may damage the material.

#### Caution:

- Do not use harsh chemicals or abrasive cleaners such as benzene or thinner. These can cause fading or deterioration of the upholstery.

### 3. Cleaning the Controller

- Use only a clean, dry cloth to wipe the controller.

#### Caution:

- Do not use a wet cloth, as moisture can cause the controller to malfunction.

## Troubleshoot

If there is still an abnormality after the following checks, to prevent any accident, please stop using the massage chair immediately. Please unplug the power cord from the outlet and contact with the dealer or the nearby customer service center.

Problem	Possible cause/action	
The massage rollers move up and then stop.	<ul style="list-style-type: none"> <li>• In order not to affect the body, the automatic timer function will move the massage roller to the upper end when the massage is over .</li> </ul>	Inevitable in structure, not abnormal
Noise during the massage	<ul style="list-style-type: none"> <li>•The sound of massaging rollers ;</li> <li>•Friction sound of the massage wheel and fabric during kneading;</li> <li>•The sound of the massage wheel when lifting and kneading;</li> <li>•The sound during air pressure massage;</li> <li>•The sound of the inflator pump;</li> <li>•The sound of airbag exhausting;</li> <li>•The sound of the backrest up and down.</li> </ul>	
The massage rollers will stop during the massage.	<ul style="list-style-type: none"> <li>• If the force applied to the massage rollers is too large, the massage rollers will stop running.</li> <li>• Lift your body slightly when using it, or raise the backrest slightly. (especially those who weigh more than 220lb , please pay attention when using)</li> </ul>	After checking, if there is still an abnormality, please stop using the massage chair immediately.
Press the power button, but the massage chair doesn't work properly or cannot connect to the power.	<ul style="list-style-type: none"> <li>• Please check the following:               <ol style="list-style-type: none"> <li>1. Is the power plug fully inserted into the socket?</li> <li>2. Is the main power switch on the left rear of the unit turned on?</li> </ol> </li> </ul>	
The power cord and plug are abnormally hot.	<ul style="list-style-type: none"> <li>• Please stop using immediately.</li> </ul>	
Please contact with your dealer or customer service.		
Do not disassemble or repair it yourself or by non-professionals.		

## Specifications

Model Number	3D Tesoro
Rated Voltage	120V~
Rated Frequency	60Hz
Rated Power	120W
Upright position - Approximately	60.91×29.53×45.39in (L×W×H)
Reclined position - Approximately	66.93×29.53×33.46in (L×W×H)

