

1

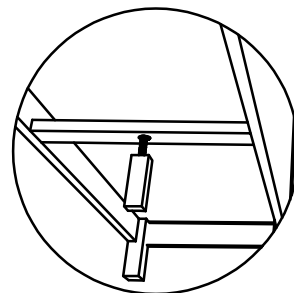
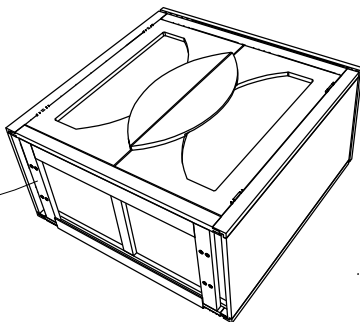
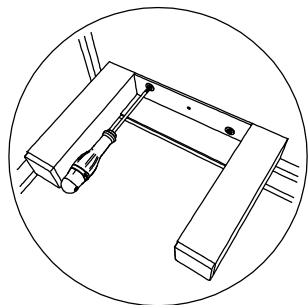
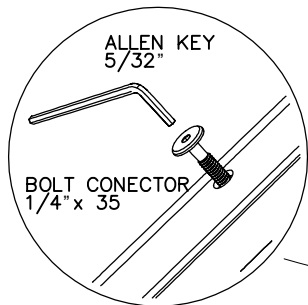
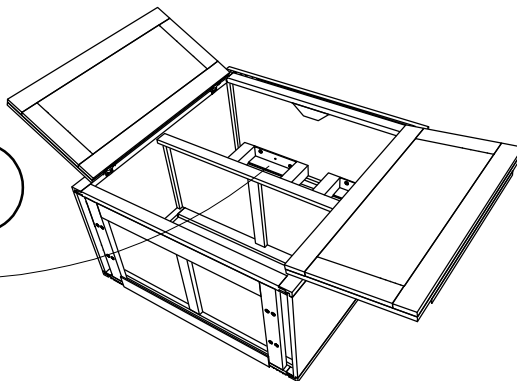

FIG. A



2



3

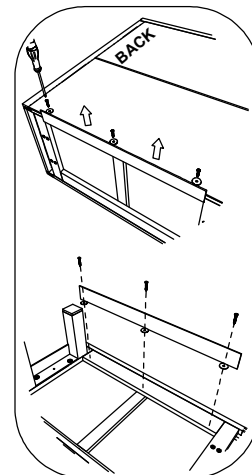
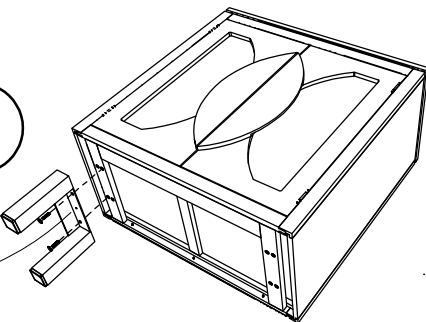
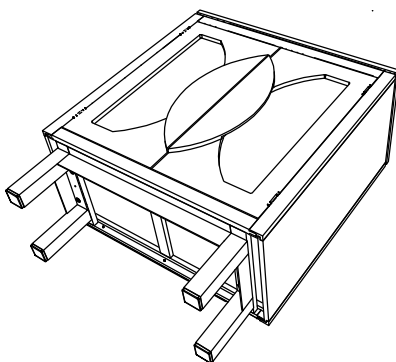

FIG. B

4



HARDWARE	
DESCRIPTION	# PCS
ALLEN KEY 5/32"	1
JOINT CONNECTOR ALLEN BOLT 1/4" X 35	4

INSTRUCTIONS:

- 1.- WITH SOMEONE'S HELP, LAY THE FURNITURE ON CLEAN FLOOR, WITH THE DRAWERS OR DOORS FACING UP AND LOCATE THE PRE-DRILLED HOLES ON THE BASE.(NOTE: IF YOUR FURNITURE HAS A THIRD LEG, SCREW IT IN THE MIDDLE OF THE BASE LIKE SHOWN IN THE FIGURE A.)
- 2.- UNSCREW THE LEGS FROM THE INSIDE OF THE FURNITURE. (NOTE: IF YOUR FURNITURE HAS A CROSSBAR LOCATED IN THE BACK, REMOVE IT AND SCREW IT WITH THE SAME BOLTS, AFTER THE FIRST LEG LIKE SHOWN IN THE FIG. B)
- 3.- MATCH THE LEGS HOLES TO THE PRE-DRILLED FURNITURE HOLES, PLACE THE THE BOLTS, AND SCREW TIGHTLY.
- 4.- REPEAT THE STEP THREE UNTIL ALL THE LEGS ARE RIGHT PLACED.

PRODUCT IMAGE SHOWN IS FOR ILLUSTRATIVE PURPOSES ONLY, SHOULD NOT BE TAKEN AS REFERENCE POINT



ASSEMBLY INSTRUCTIONS

I-MIX-C011