

Dimensions

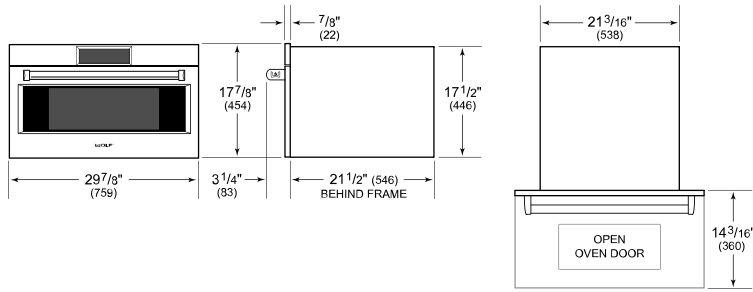

Standard Installation

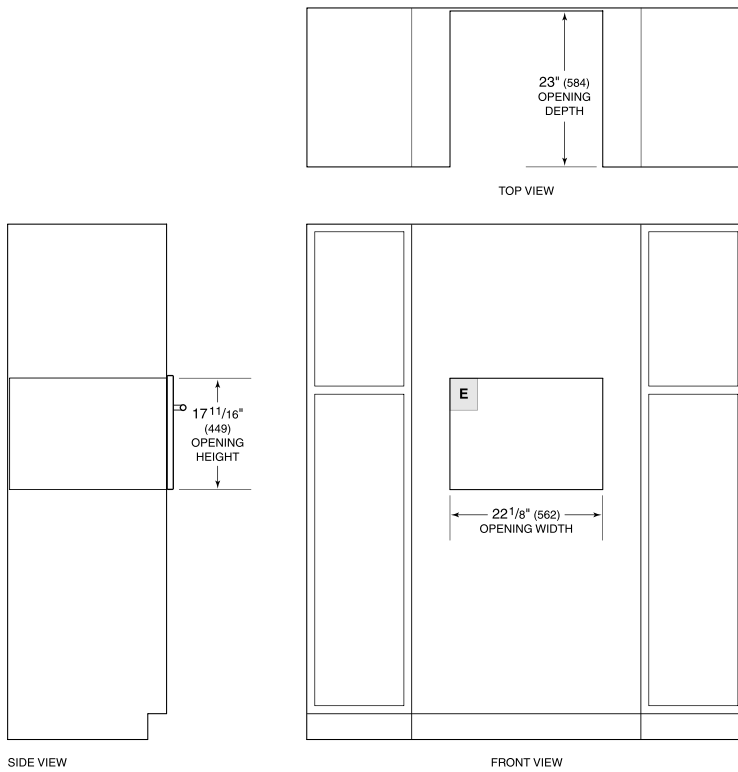

NOTE: 24" (610) and 30" (762) models require the same opening dimensions.

Electrical Requirements

Electrical Requirements

Electrical Supply grounded, 240/208 VAC, 60Hz

Electrical Service 15 amp dedicated circuit

Electrical Location Illustration

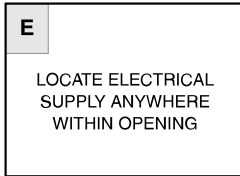

flush-installation

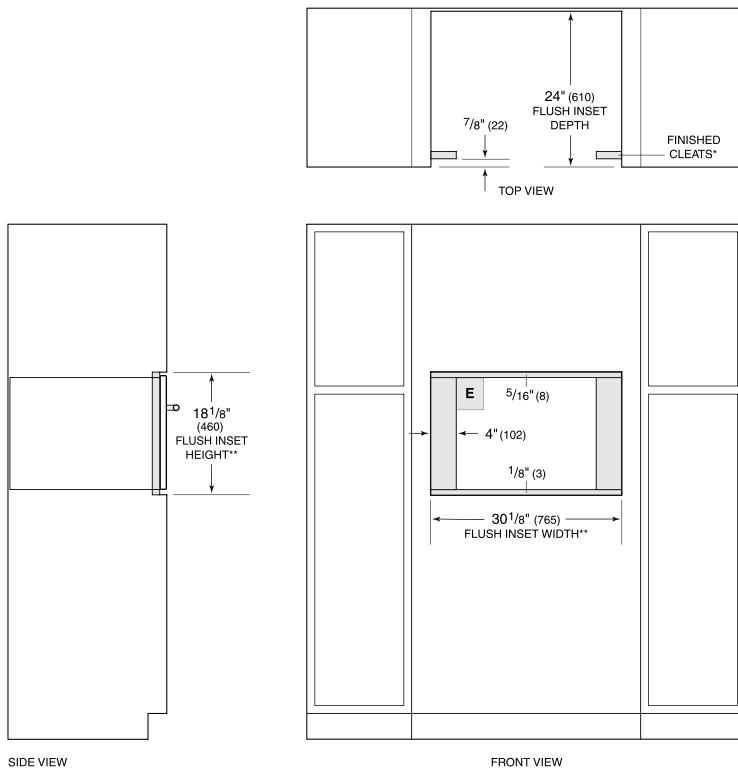

*Will be visible and should be finished to match cabinetry.
 **Dimension provides minimum reveals.