

Premium Bed Frame Assembly

USE WITH MODELS: PG33, PG46, PG50, PG60, PG66

NEED HELP?

1-800-444-8444

warranty@risehome.com

INCLUDED PARTS

FOR ALL SIZES

Side Rails with Headboard Brackets
2 pcs

Cross Rails
2 pcs

End Caps
2 pcs

FOR TWIN SIZE

Plastic Sockets
4 pcs

Glides
4 pcs

FOR FULL, QUEEN, KING, CAL-KING

Center Support Rail
1 pcs

Plastic Sockets
6 pcs

Glides
6 pcs

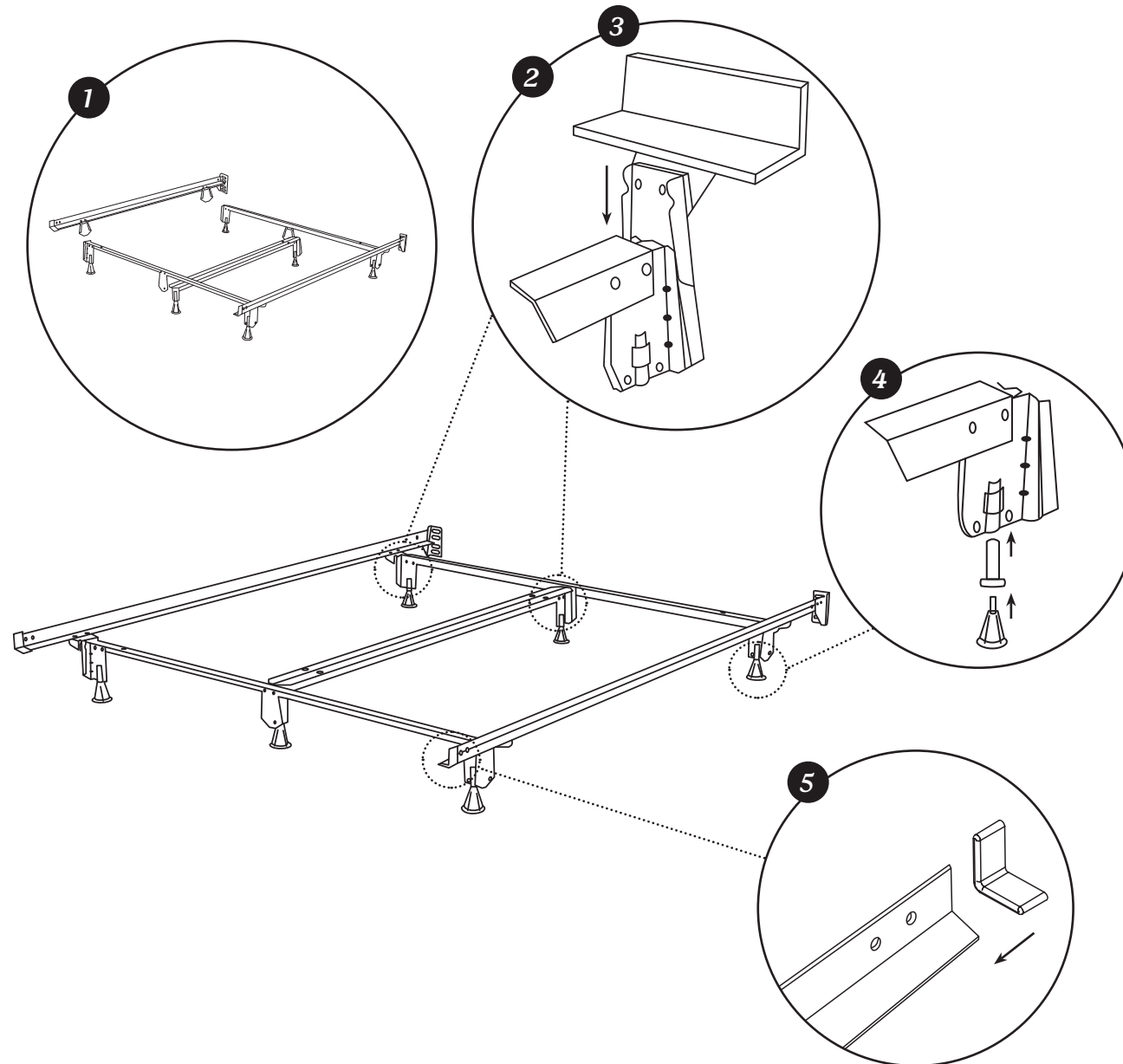

1. Set side rails out with the headboard brackets on the same end. Leave enough room for the cross rails to fit between them.
2. Slide the leg covers on the side rails over the inner legs on the cross rails.
3. **FOR FULL, QUEEN, KING AND CAL-KING SIZES:** Install the center support rail. Fit the center support legs into the leg covers on the center of the cross rails at the head and foot of the frame.
4. Insert plastic sockets into the legs on the cross rails and center rail. Then insert the glides into the plastic sockets.

NOTE: Make sure that the glide is fully seated in the plastic socket

The plastic sockets may already be attached to the legs, if so please discard the extra plastic sockets provided.

5. Slip the end caps over the foot ends of the side rails. Your bed frame is now ready to use.

SHOWN FOR REFERENCE: PG50, QUEEN

REV: 03.11.24