

Electrical Outlet Specifications and Requirements

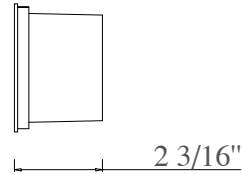
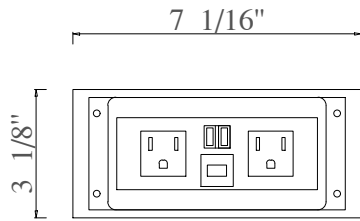

Intertek

5011080

Part: JM-ELECUSB18

REQUIRED ELECTRICAL SERVICE:

One dedicated circuit required, protected with a Class A Ground-Fault Circuit Interrupter (**GFCI**)

or

Residual Current Device (**RCD**)

SPECIFICATIONS:

120 V 15 A 60 Hz

IMPORTANT: James Martin recommends you always consult with a professional electrical contractor with questions regarding proper installation of this device in your home.

Plug the cord into a properly grounded outlet.

Use the cord clamps (provided in a red hardware bag) to secure the cord and remove slack.

Clamps are also included for securing the cord to the underside of the shelf.

CC=4PCS Cord Clamp



GG=4PCS 1-1/4" Long Screws

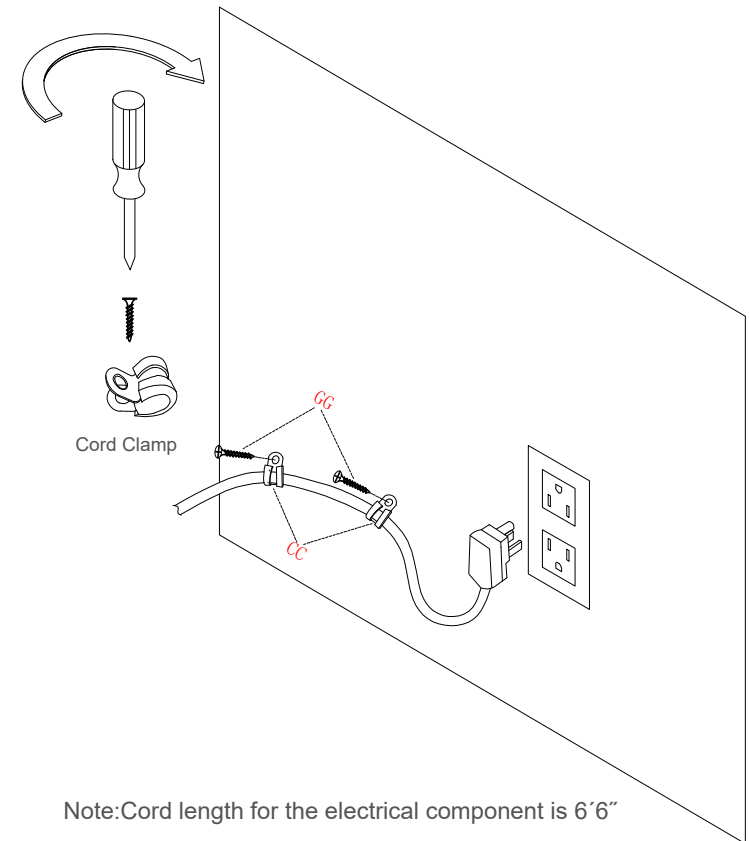

Note: Cord length for the electrical component is 6'6"

Version: 202408