

ASSEMBLY INSTRUCTIONS
COASTER FINE FURNITURE



Fine Furniture for every stage of life

753424
3PC OCCASIONAL SET

ITEM:753424

ASSEMBLY INSTRUCTIONS

ASSEMBLY TIPS:

1. Remove hardware from box and sort by size.
2. Please check to see that all hardware and parts are present prior to start of assembly.
3. Please follow attached instructions in the same sequence as numbered to assure fast & easy assembly.



WARNING!

1. Don't attempt to repair or modify parts that are broken or defective. Please contact the store immediately.
2. This product is for home use only and not intended for commercial establishments.



ASSEMBLY TIME

40 MINUTES

PARTS IDENTIFICATION

A LARGE TABLE
TOP

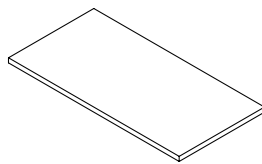

1 PC

B LARGE TABLE
LEG FRAME

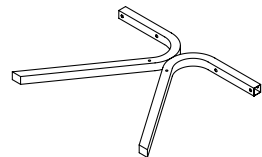

2 PCS

C LARGE TABLE
CROSSBAR

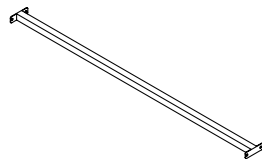

1 PC

D SMALL TABLE
TOP

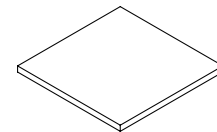

2 PCS

E SMALL TABLE
LEG FRAME

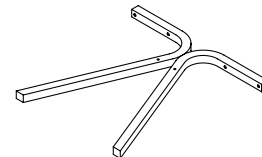

4 PCS

F SMALL TABLE
CROSSBAR

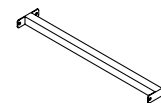

2 PCS

HARDWARE IDENTIFICATION

Z

NO	DESCRIPTION	FIGURE	Q'TY	NO	DESCRIPTION	FIGURE	Q'TY
1	BOLT Ø7x50mm BLK		24 PCS	4	ALLEN WRENCH 4mm SR		1 PC
2	BOLT M6x15mm BLK		12 PCS	5	PAD 30x20x3mm		12 PCS
3	FLOOR PROTECTOR 25x25mm		12 PCS				

NOTE:

Phillips head screw driver is required in the assembly process; however, manufacturer does not provide this item.

ITEM: **753424**

STEP 1

COASTER
FINE FURNITURE

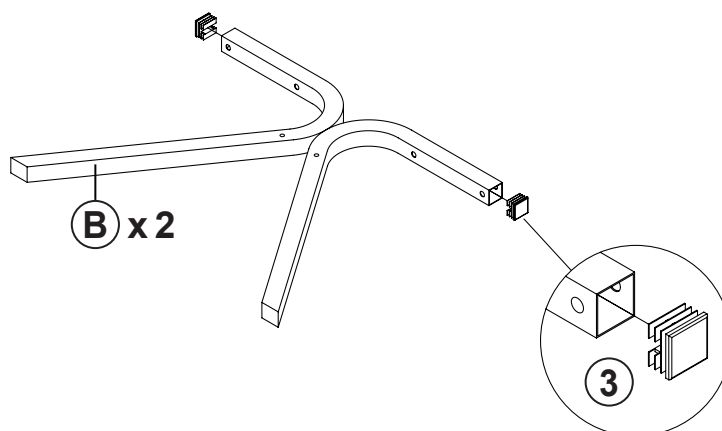
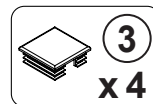

STEP 2

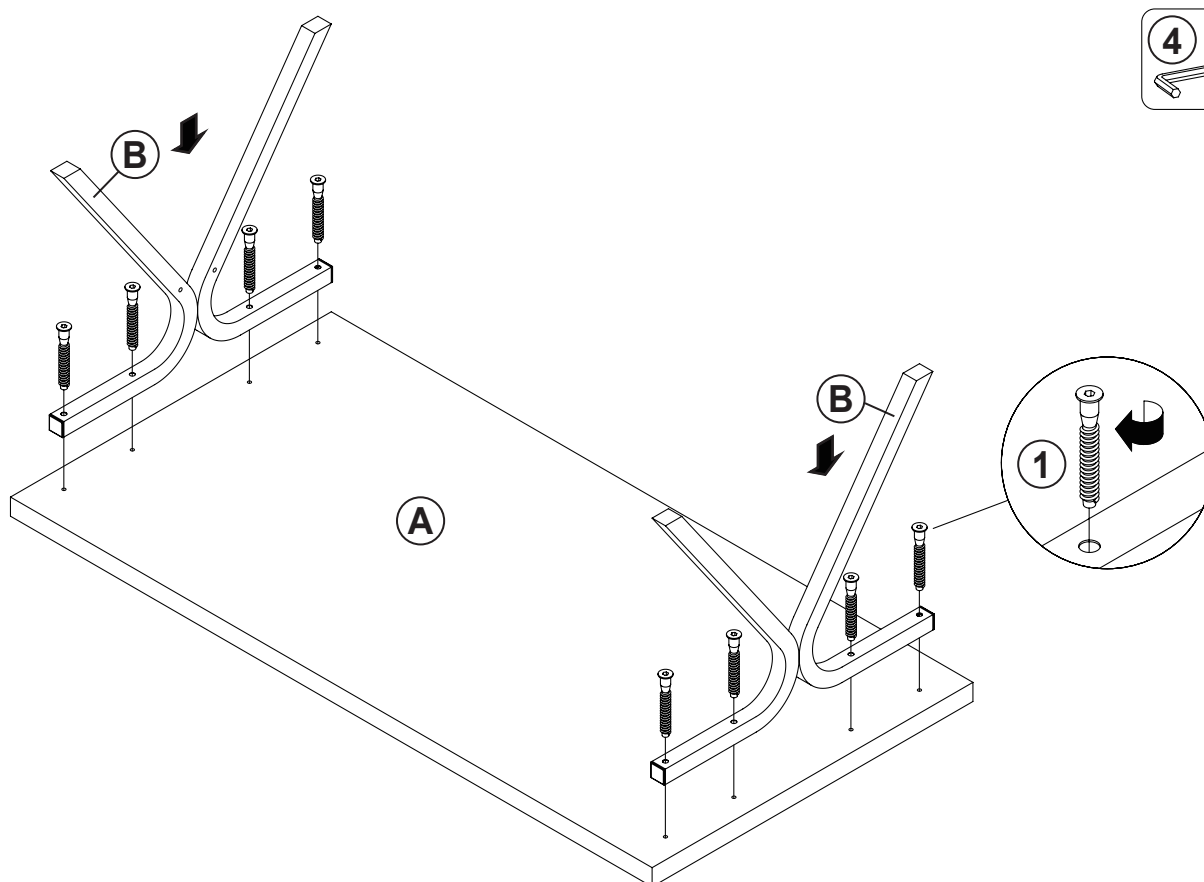
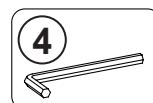
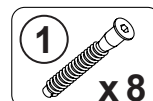

ITEM: **753424**

STEP 3

COASTER
FINE FURNITURE

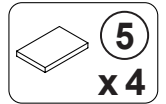
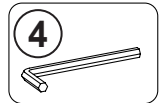
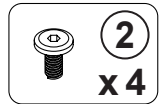
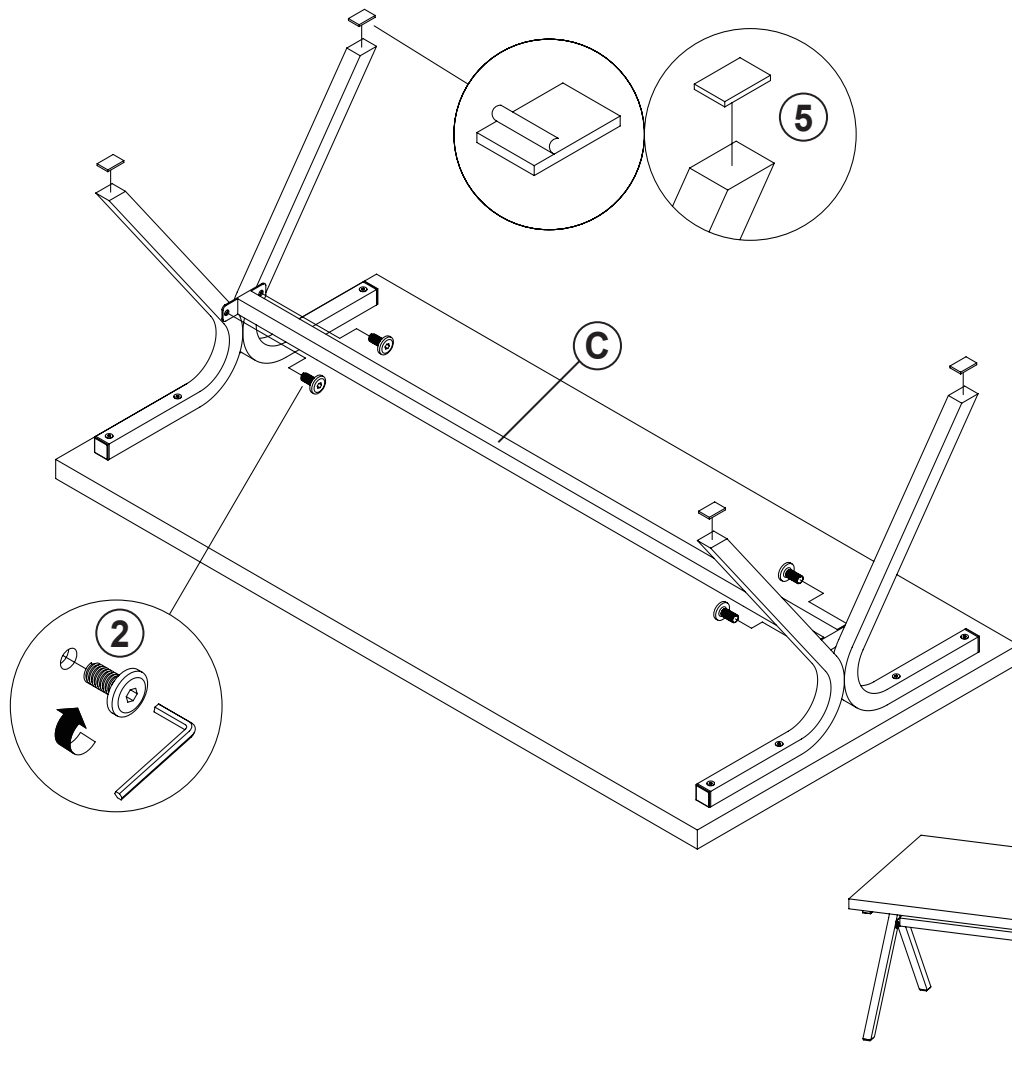

STEP 4

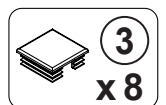
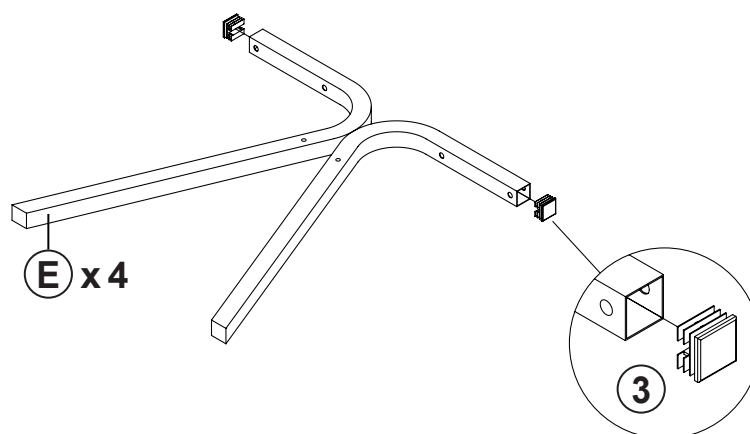

ITEM: **753424**

STEP 5

COASTER
FINE FURNITURE

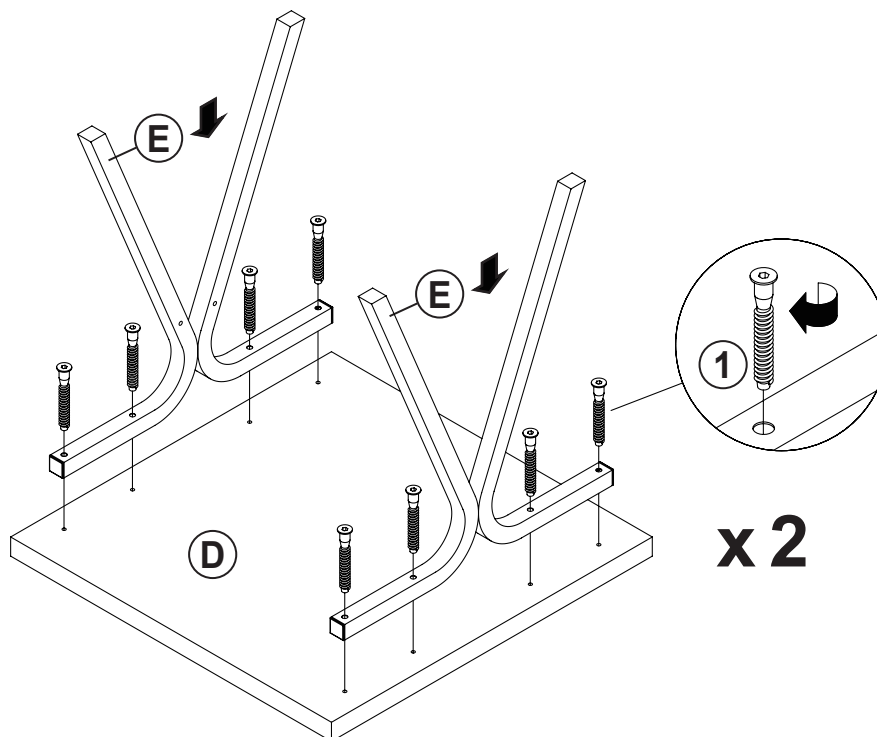
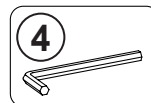
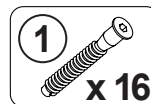

STEP 6

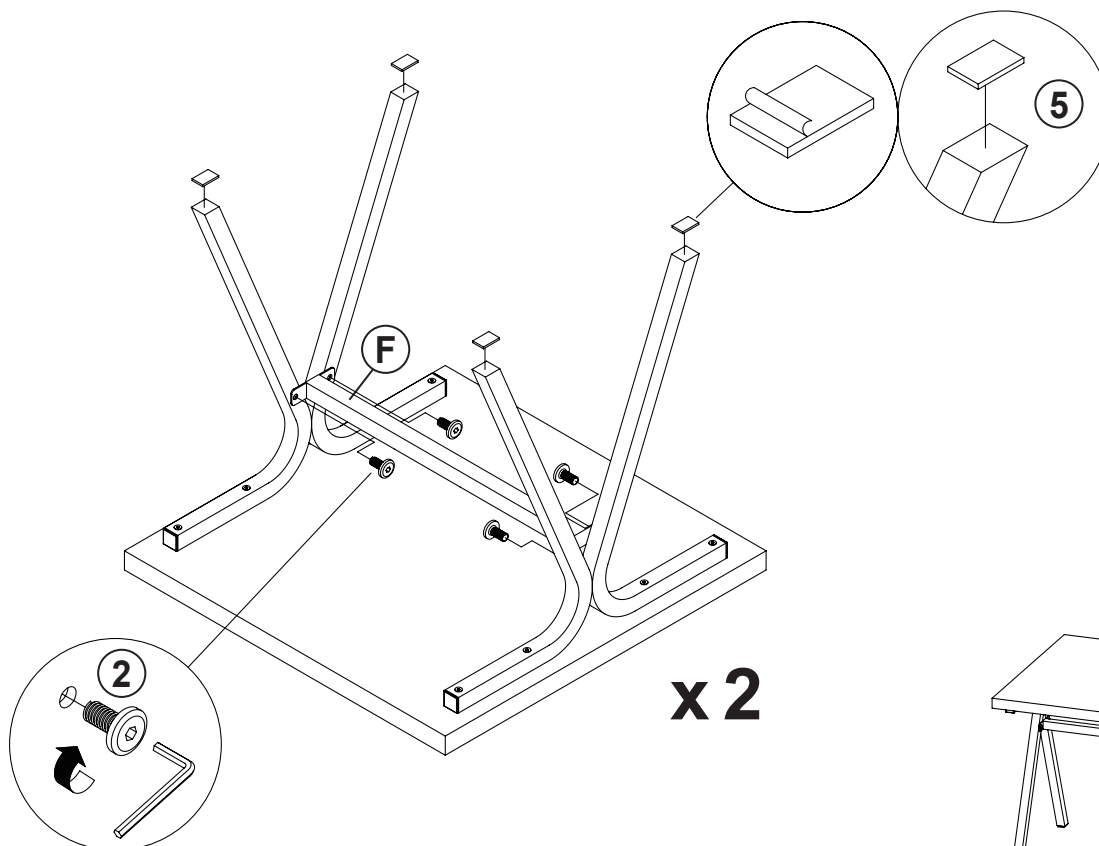
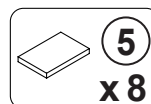
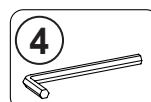
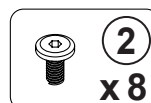

ITEM: 753424

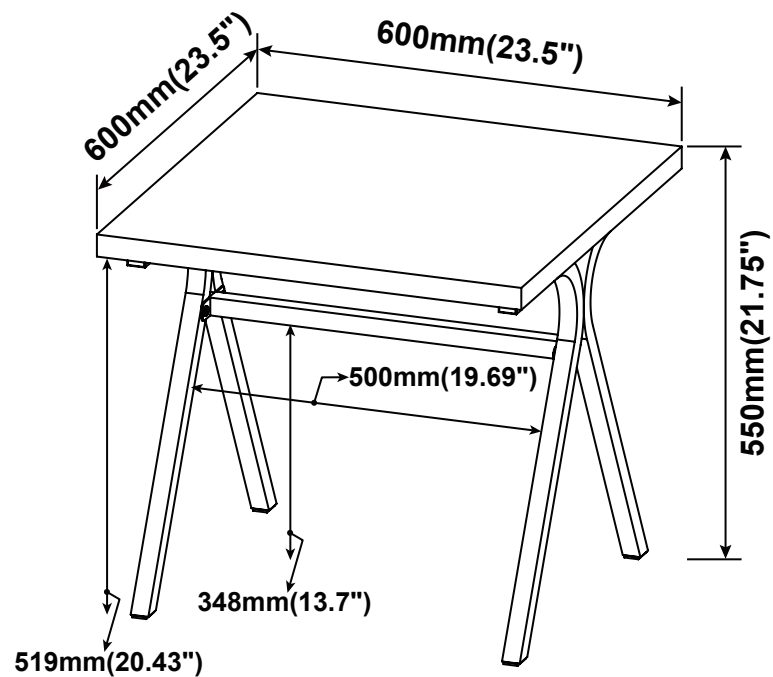
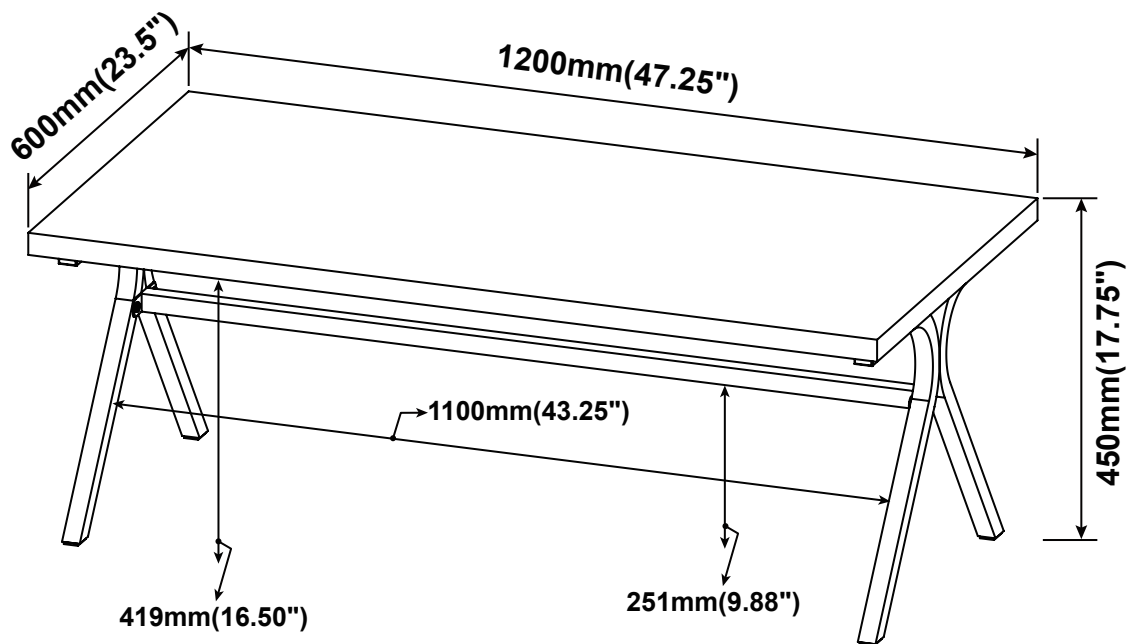

Note : Dimension tolerance $\pm 5\%$