

ASSEMBLY INSTRUCTIONS

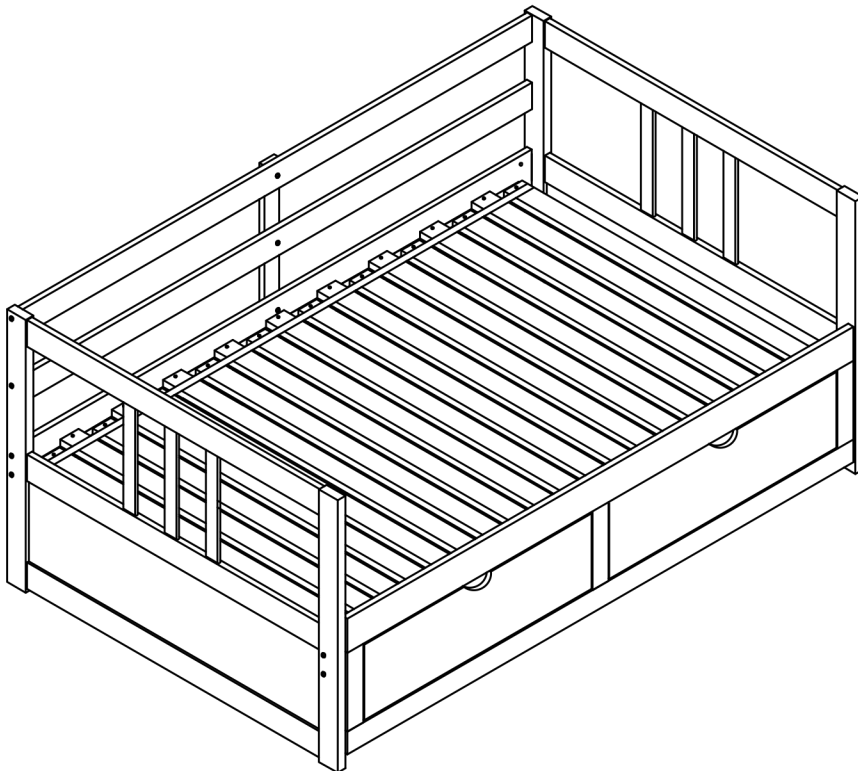

TOOLS REQUIRED



Allen Wrench

(Included)



Phillips
Screwdriver

(Not Included)



2 - People
Recommended

ASSEMBLY RATING



EASY ————— DIFFICULT

The Assembly Rating is a 5-point system showing the level of effort needed to assemble a specific product.



CHECK BEFORE STARTING

☐

Are you missing anything?

Double-check all parts, hardware and accessories listed on Page 6 are accounted for.

☐

Check out our Quick Tips!

We recommend reviewing the pre-assembly handouts. Even experts need a refresher now and then!

☐

Should we send any replacements?

Are there any irregularities or flaws in the parts? We can send replacements!

☐

Prep Time!

Please review the assembly instructions and all diagrams prior to assembling. Arrange parts as recommended on Page 7 and group identical hardware together to make assembling easier.

PRE ASSEMBLY INTRODUCTION

We understand building ready-to-assemble furniture can be a challenging experience for some. To help avoid confusion, we have provided some helpful tips that may speed up the process.



Teamwork

ALWAYS have at least two people to help with transporting and assembling the product to avoid potential injury and/or damage.

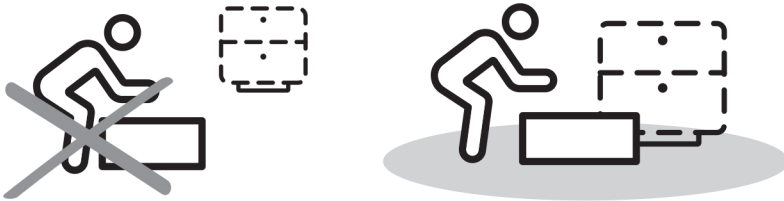

Suitable Location

Assembling near the area of the intended location is highly recommended.



Sufficient Space

Make sure you have enough space to move around during the assembly.

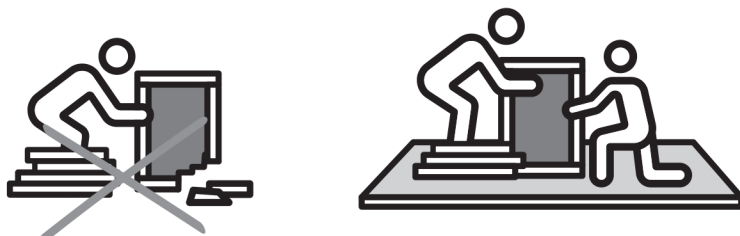

Avoid Scratches

Use cardboard, blankets or a carpeted area while assembling furniture to prevent scratches.

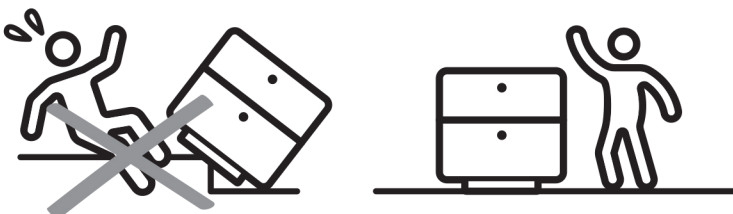

Flat Surface

Make sure the furniture rests on a flat and level surface with each leg evenly touching the floor.

ASSEMBLY AND CARE ADVICE



**FAILURE TO FOLLOW THE GUIDELINES BELOW MAY
RESULT IN INJURY AND/OR PROPERTY DAMAGE.**



Position each part correctly
and insert screws or bolts into
their respective holes.

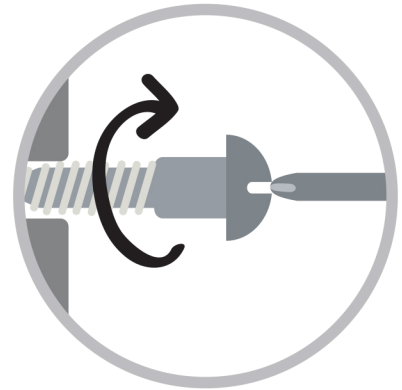

Turn clockwise to tighten and
only tighten when step is
completed or when instructed
to do so.



Save the instructions and store
any supplied tools for later
maintenance.

Use the appropriate hand tools
or power tools for assembly.
Select steps, such as tightening
screws and/or bolts, may require
hand tools to avoid causing
damage during assembly.

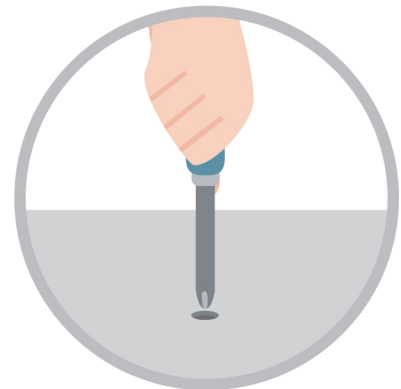

After two weeks, check and
tighten any loose hardware and
repeat again every six months
thereafter.

IT IS THE USER'S RESPONSIBILITY TO MAINTAIN THE FURNITURE. THE HARDWARE MAY LOOSEN OVER TIME AND MAY CAUSE THE FURNITURE TO BE WOBBLY AND UNABLE TO SUPPORT ITS INTENDED WEIGHT CAPACITY. THIS MAY LEAD TO COLLAPSE AND MAY CAUSE SERIOUS INJURY.

DAYBED



- Please keep instructions for future reference.
- Check the quantity and irregularity of parts and hardware before you start.

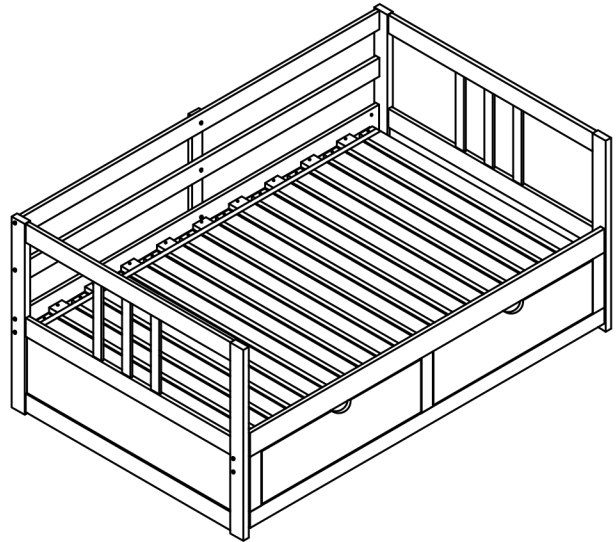

PARTS

#1 1pc

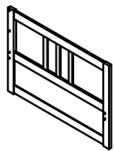

Left Headboard

#2 1pc

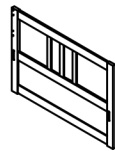

Right Headboard

#3 1pc



Back Side Rail

#4 1pc

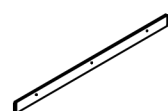

Front Side Rail

#5 2pcs

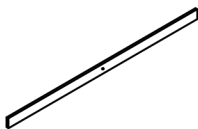

Back Guardrail

#6 1pc



Guardrail

#7 3pcs



Flap

#8 1pc



Flap

#9 1set

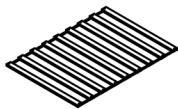

Twin Slats Kit
(9pcs)

#10 1set

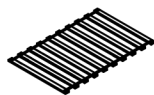

Twin Slats Kit
(10pcs)

#11 1pc

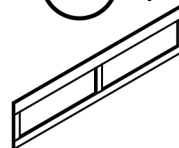

Trundle Front
Frame

#12 1pc



Trundle Back
Rail

#13 2pcs



Trundle Side
Panel (L&R)

#14 2pcs



Drawer Runner

#15 2pcs



Front Board

#16 2pcs

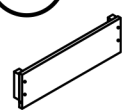

Left Board

PARTS

#17 2pcs

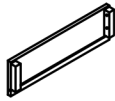

Right Board

#18 2pcs

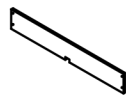

Back Board

#19 2pcs

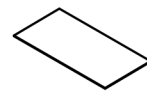

Bottom Board

HARDWARE

#A 12pcs



Bolt
Ø1/4" x 3-1/8"

#B 12pcs



Barrel Nut
Ø1/4" x 1/2"

#C 11pcs



Bolt
Ø1/4" x 1-3/16"

#D 3pcs



Hex Cap
Ø1/4" x 5/8"

#E 4pcs



Wood Dowel
Ø10x40mm

#F 8pcs



Wood Dowel
Ø6x30mm

#G 6pcs



Screw
#4 x 40mm

#H 42pcs



Screw
#4 x 30mm

#I 16pcs



Screw
#4 x 25mm

#J 8pcs

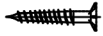

Screw
#4 x 20mm

#K 2pcs



Screw
#3 x 15mm

#L 4pcs



Screw
#3 x 12mm

#M 4pcs



Wheel

#N 2pcs



Scroll Bar

#O 1pc



Allen Wrench 4mm

Exploded View

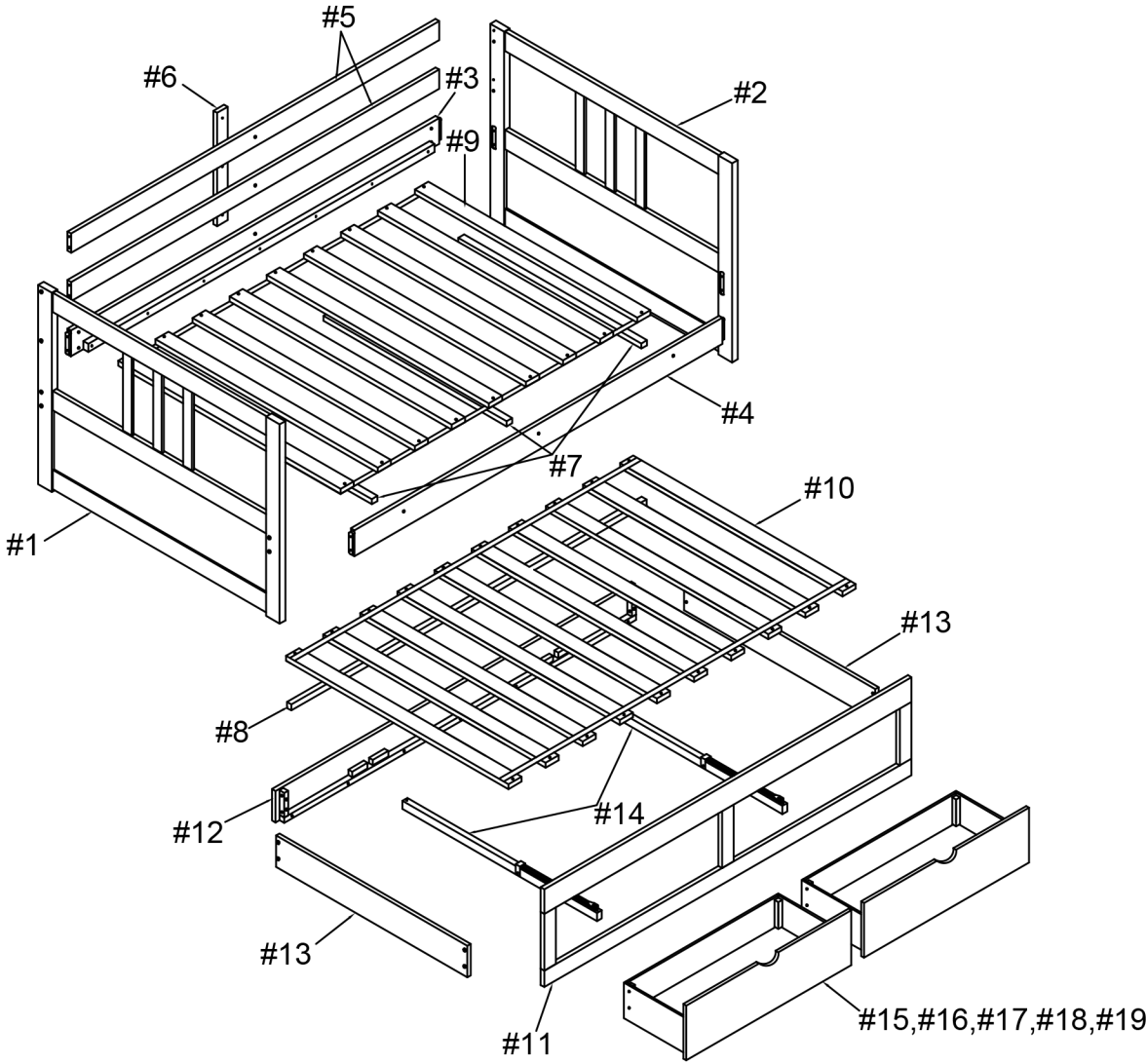

ASSEMBLY INSTRUCTIONS

1

Part #1 x1pc
 Part #2 x1pc
 Part #3 x1pc
 Part #4 x1pc
 Part #5 x2pcs
 Hardware #A x12pcs
 Hardware #B x12pcs
 Hardware #E x4pcs

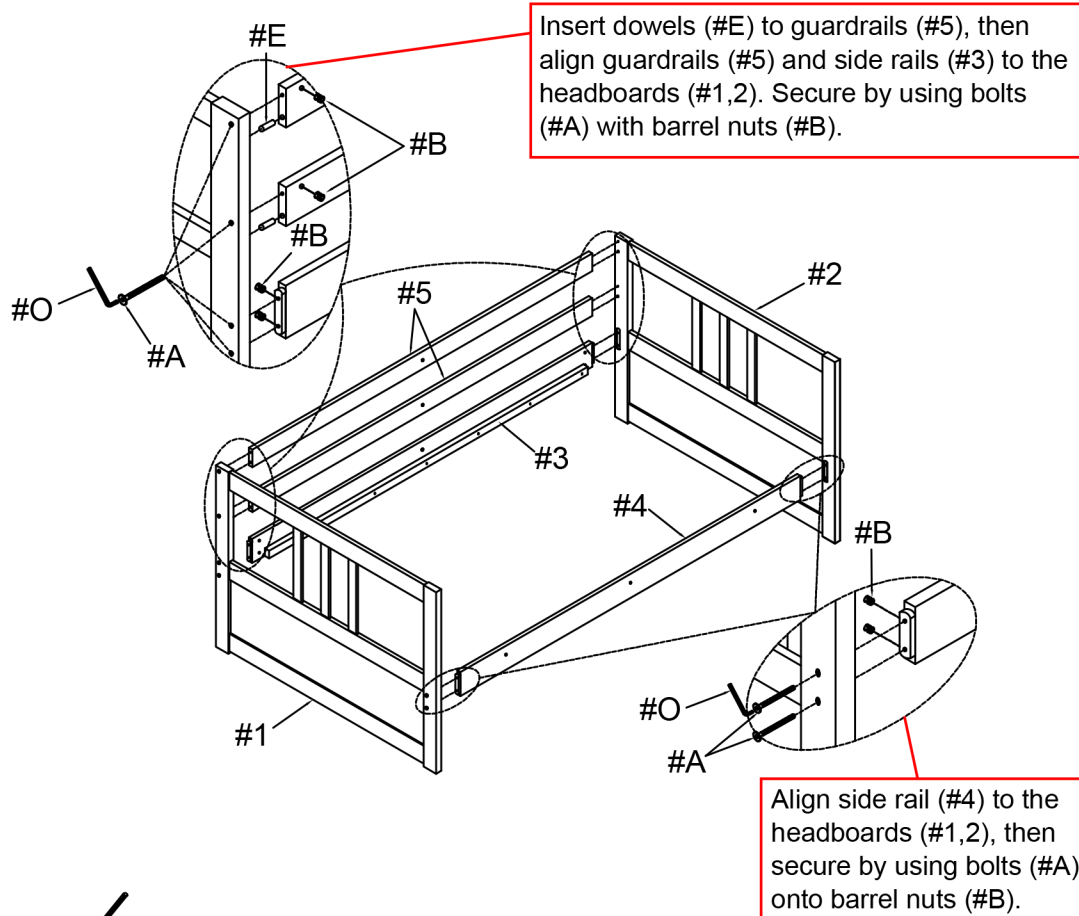

2

Part #6 x1pc
 Hardware #C x3pcs
 Hardware #D x3pcs

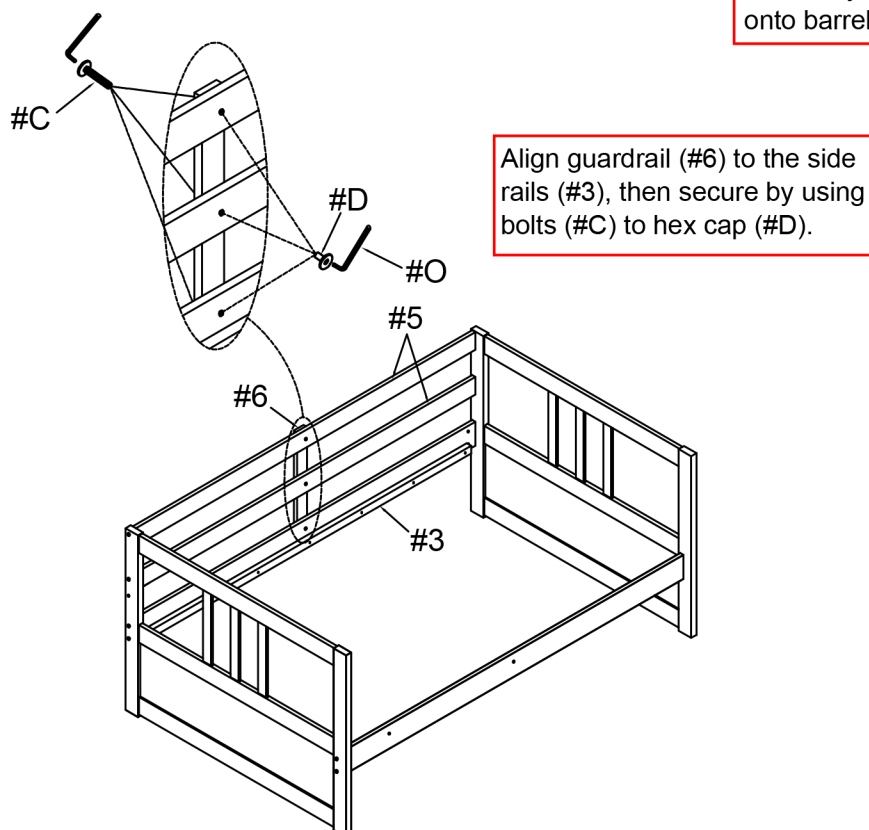

ASSEMBLY INSTRUCTIONS

3

Part #7 x3pcs

Hardware #G x6pcs

Align flaps (#7) to the side rails (#3,4), then secure by using screws (#G).

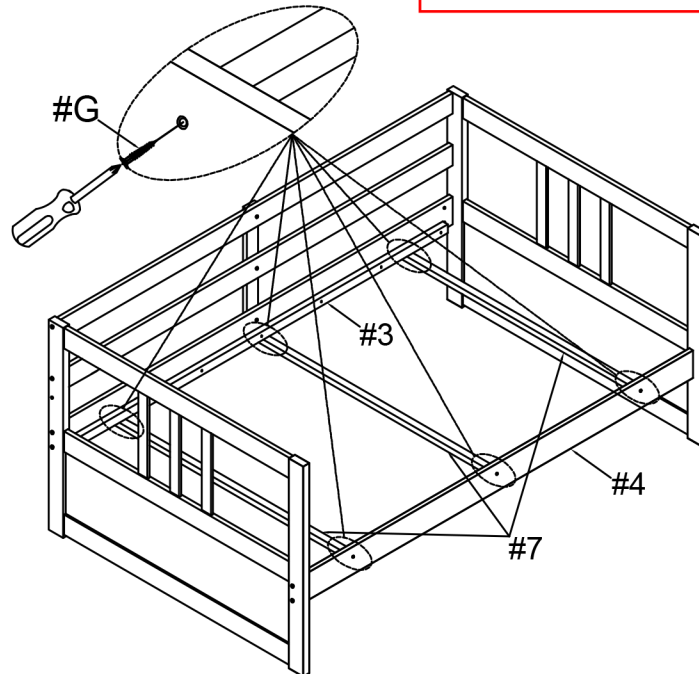

4

Part #8 x1pc

Align flap (#8) to the bed.

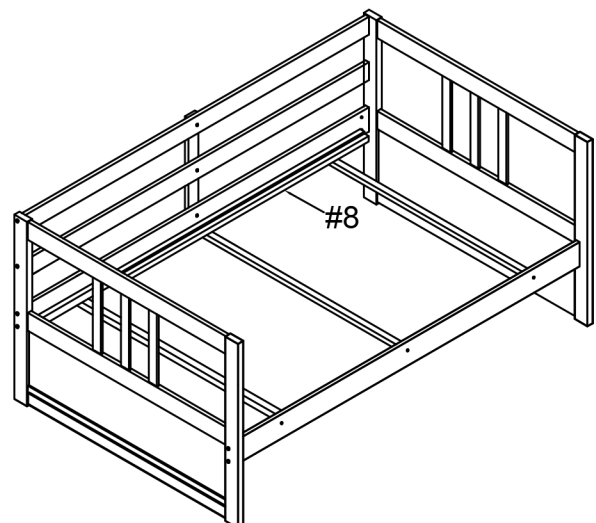
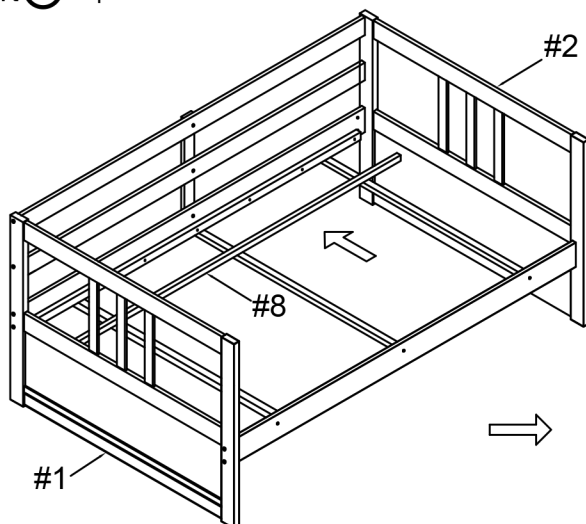

ASSEMBLY INSTRUCTIONS

5

Part #11 x1pc
Part #12 x1pc
Hardware #J x8pcs
Hardware #M x4pcs

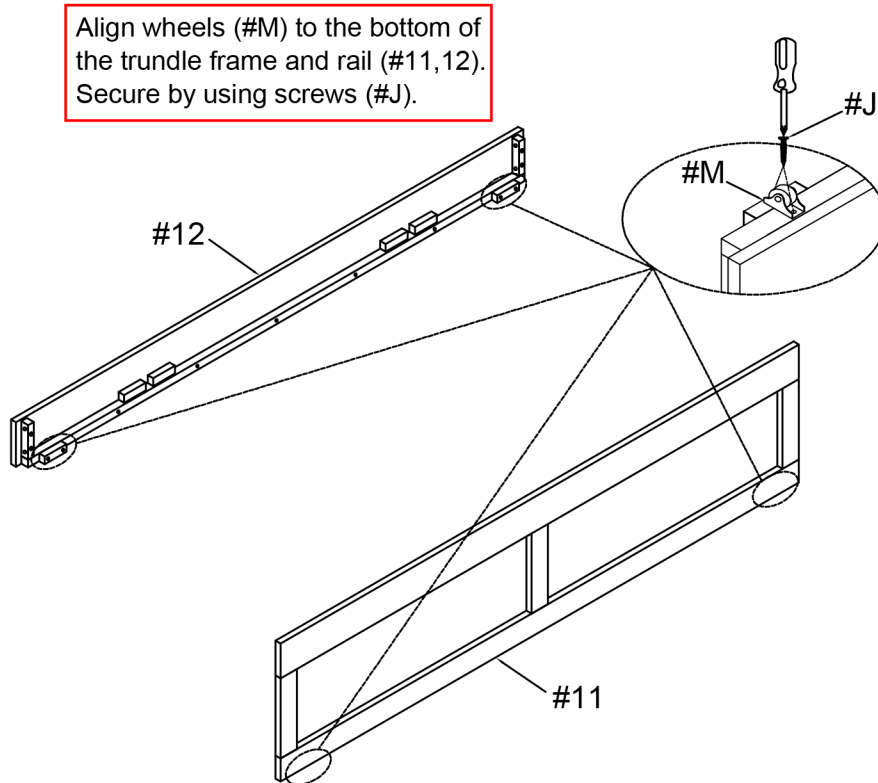

6

Part #13 x2pcs
Hardware #C x8pcs

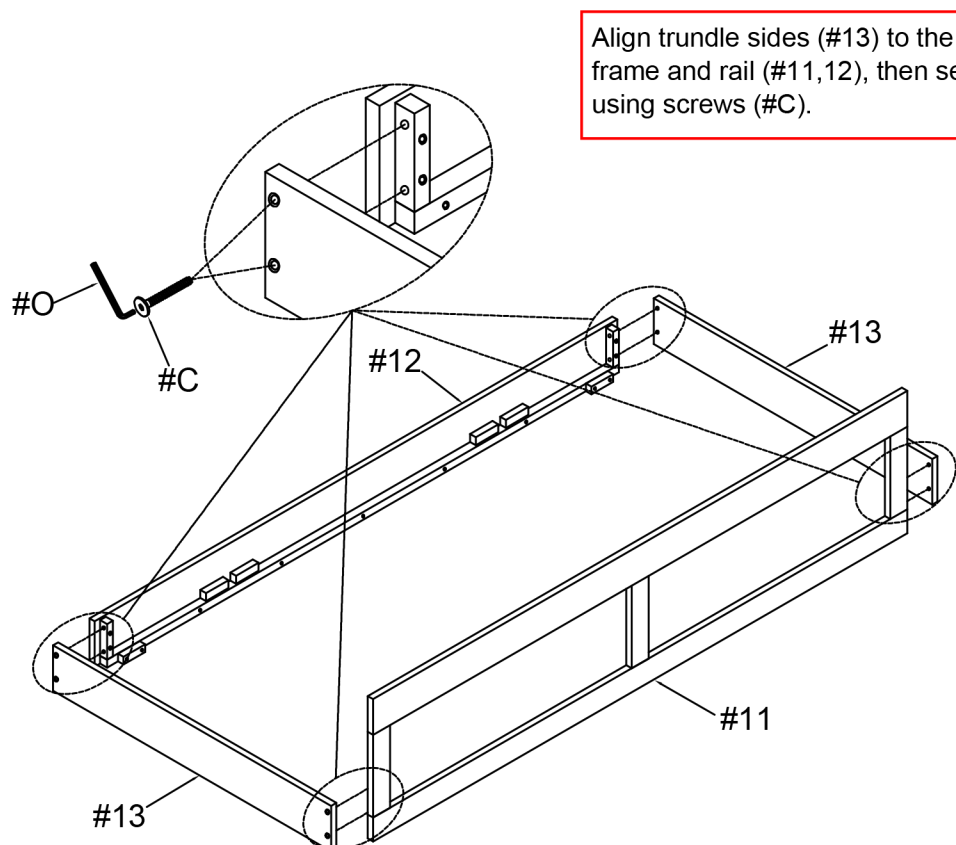

ASSEMBLY INSTRUCTIONS

7

Part #14 x2pcs
Hardware #H x4pcs

Align drawer runners (#14) to the trundle, then secure by using screws (#H).

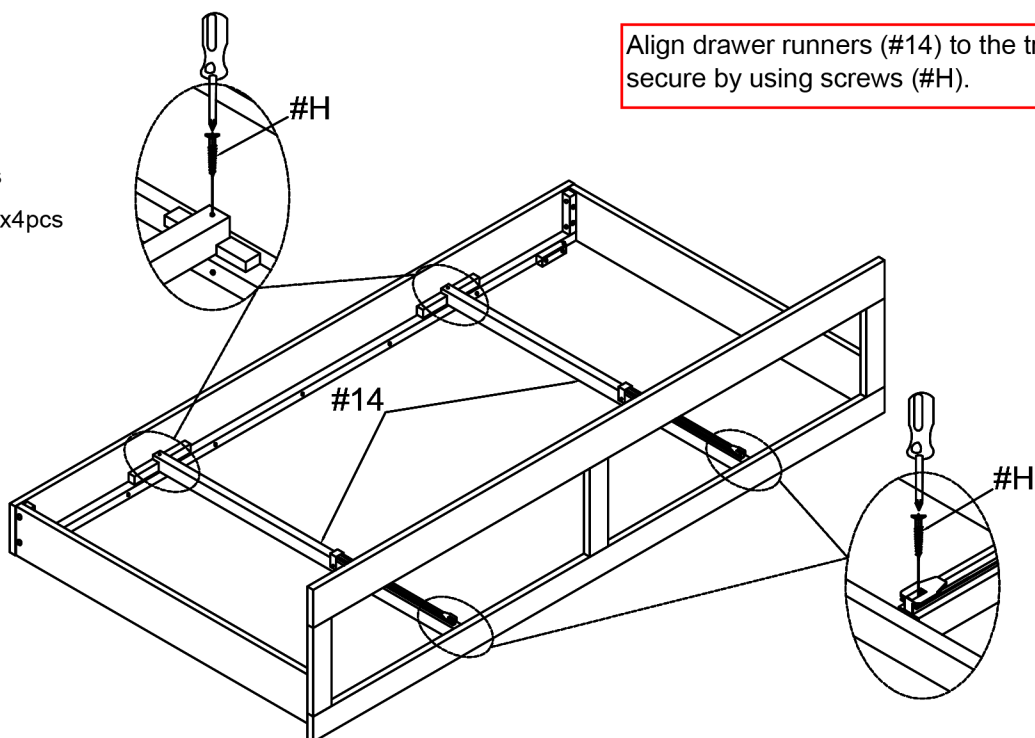

8

Part #15 x1pc
Part #16 x1pc
Part #17 x1pc
Part #19 x1pc
Hardware #F x4pcs
Hardware #I x4pcs

Insert dowels (#F) to the front board (#15), then align side boards (#16,17) with bottom board (#19) to the front board (#15). Secure by using screws (#I).

x 2

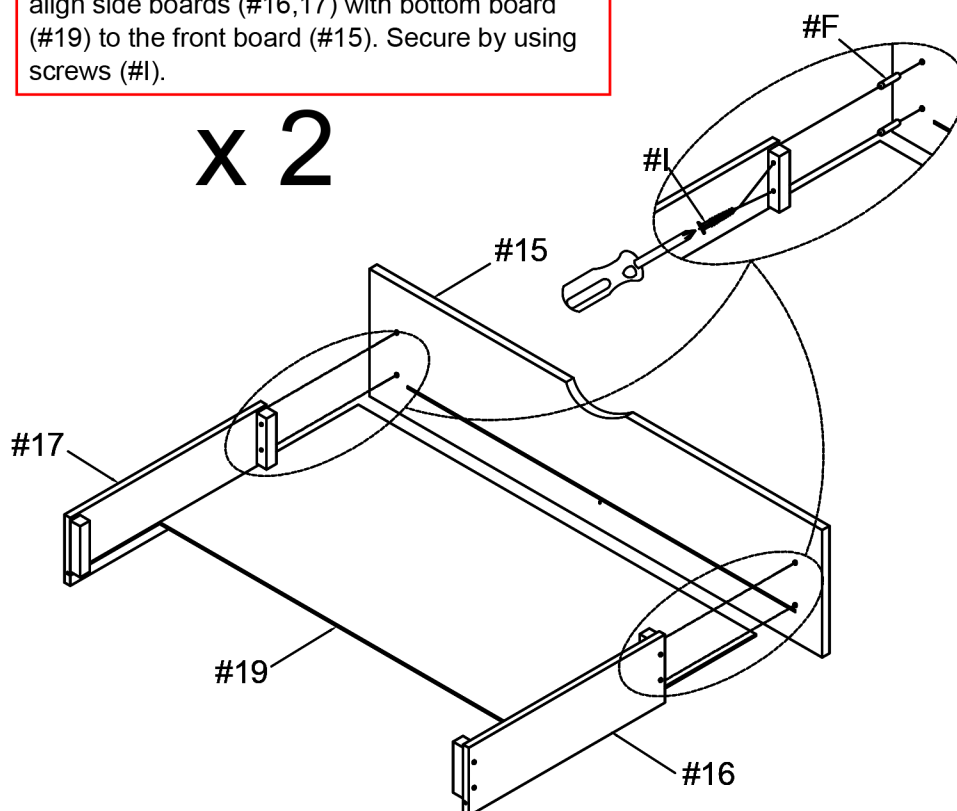

ASSEMBLY INSTRUCTIONS

9

Part **#18** x1pc
Hardware **#I** x4pcs

Align back board (#18) to the drawer, then secure by using screws (#I).

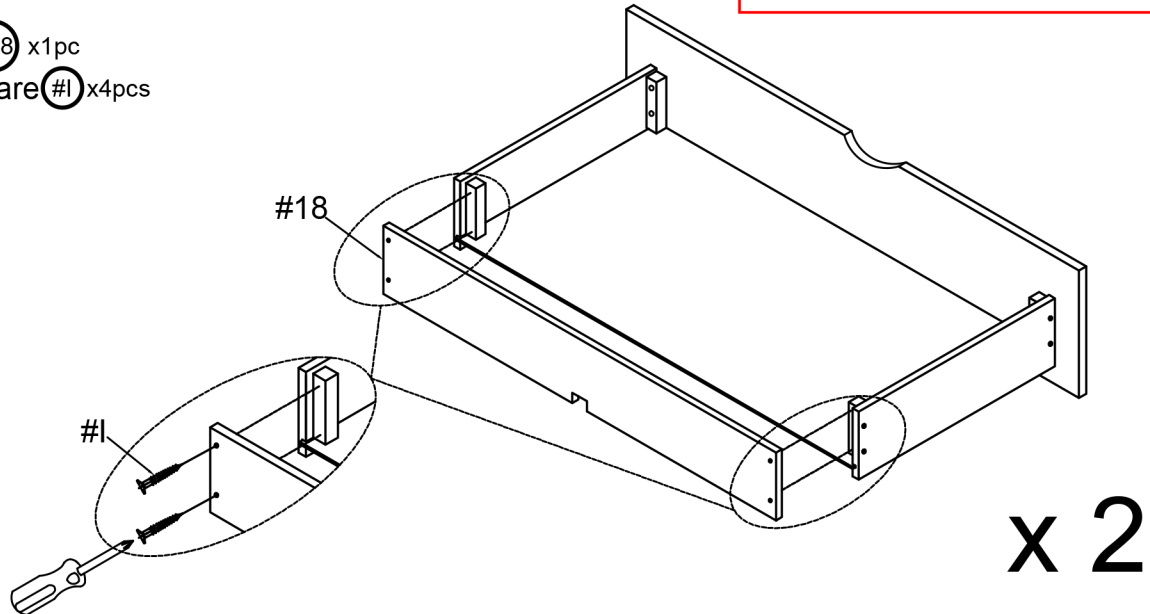

10

Hardware **#K** x1pc
Hardware **#L** x2pcs
Hardware **#N** x1pc

Align scroll bars (#N) to the bottom of the drawer, then secure by using screws (#K,L).

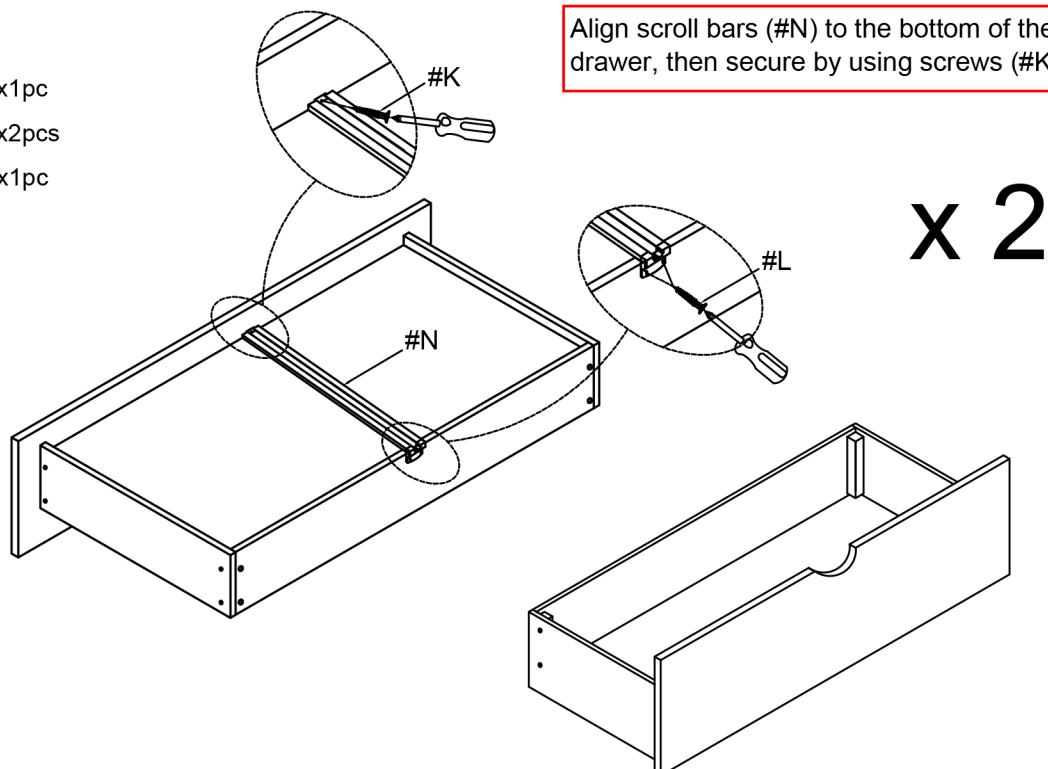

ASSEMBLY INSTRUCTIONS

11

Align and attach drawers to trundle. Please use slight force when pushing drawers into trundle.

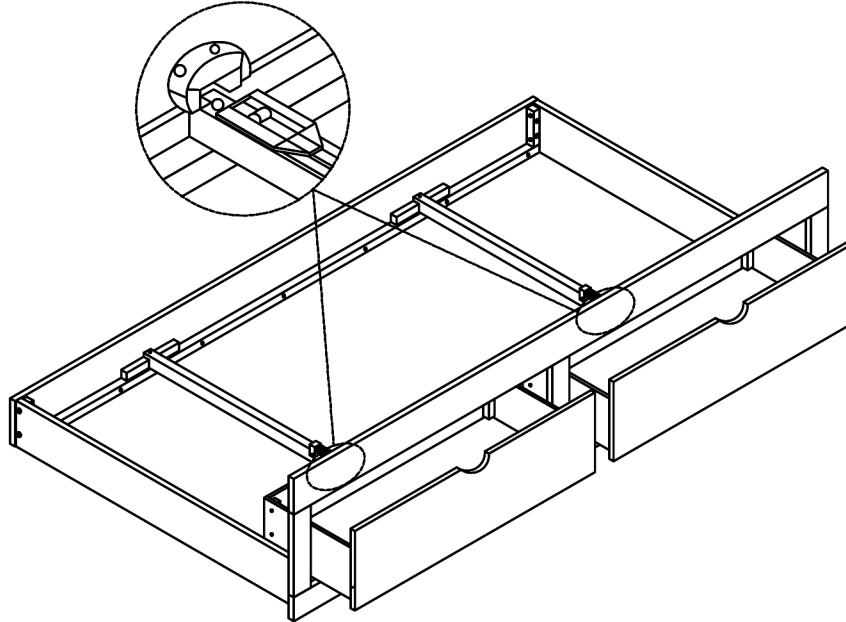

12

Part #9 x1set

Align slats (#9) to the bed. Make sure the slats (#9) closest to the headboards on both ends and all slats (#9) are 155mm away from each other.

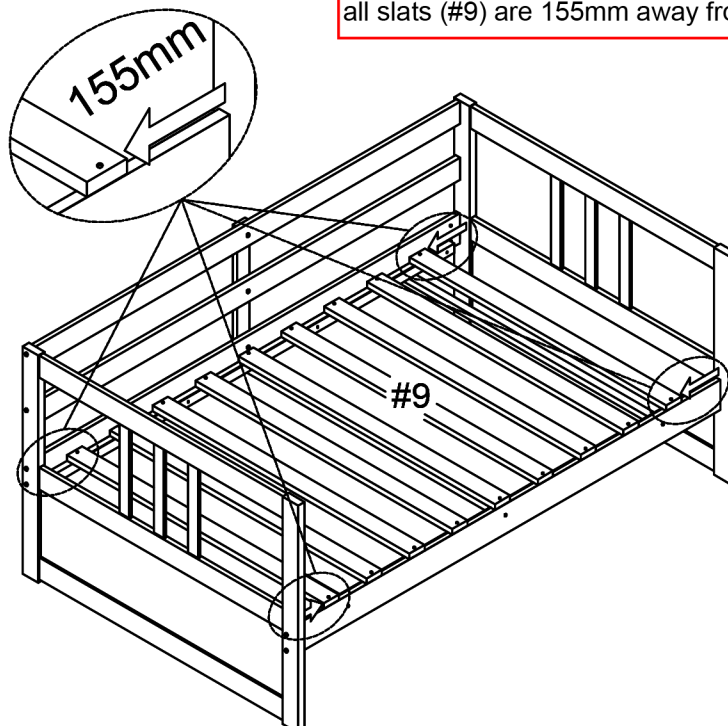

ASSEMBLY INSTRUCTIONS

13

Part **#9** x1pc

Hardware **#H** x18pcs

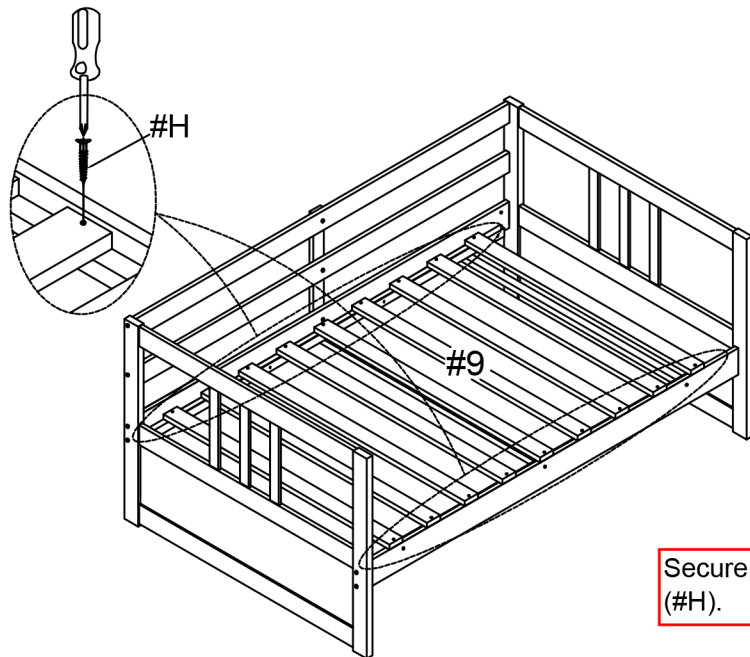

Secure slats (#9) by using screws (#H).

14

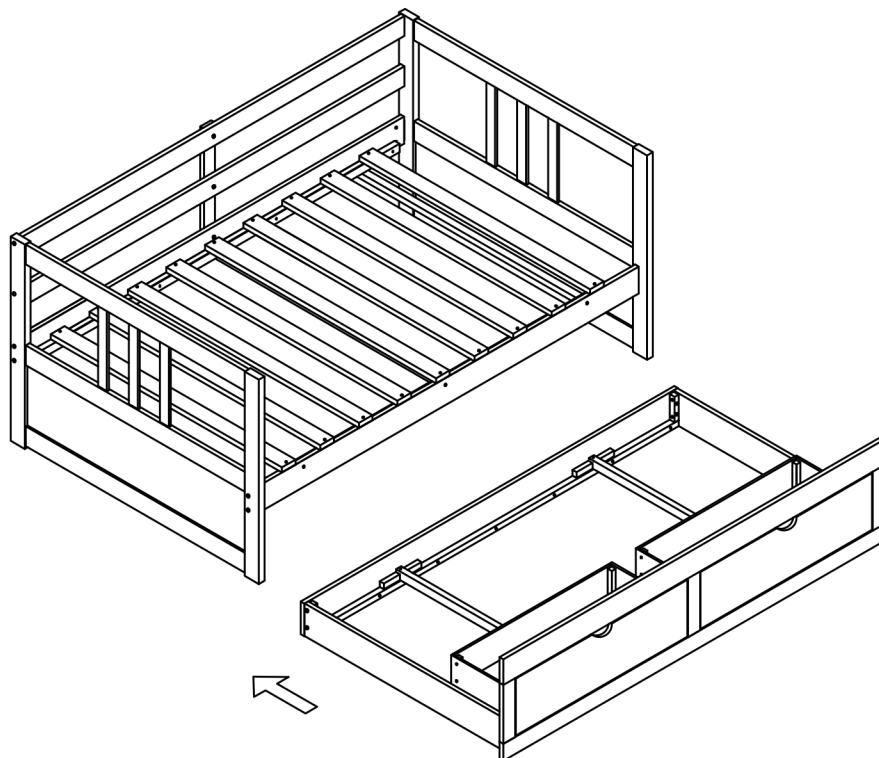

ASSEMBLY INSTRUCTIONS

15

Part **#10** x1set
Hardware **#H** x20pcs

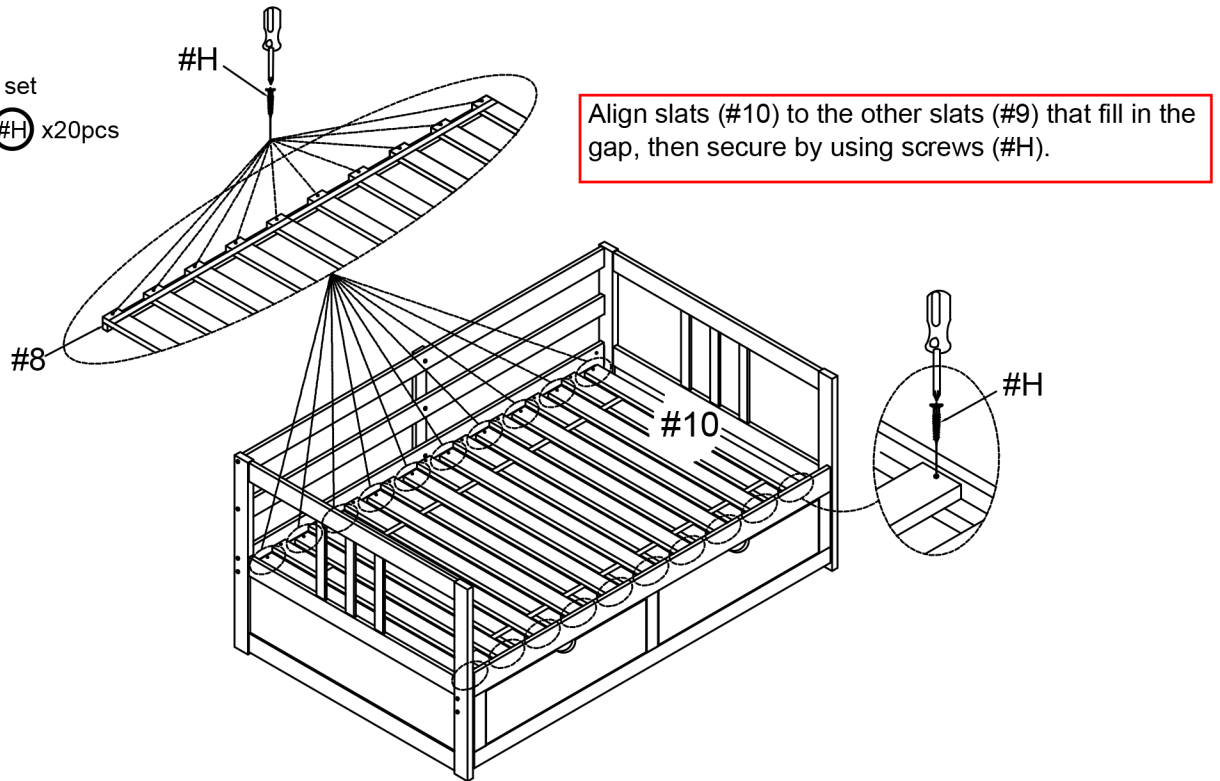

16

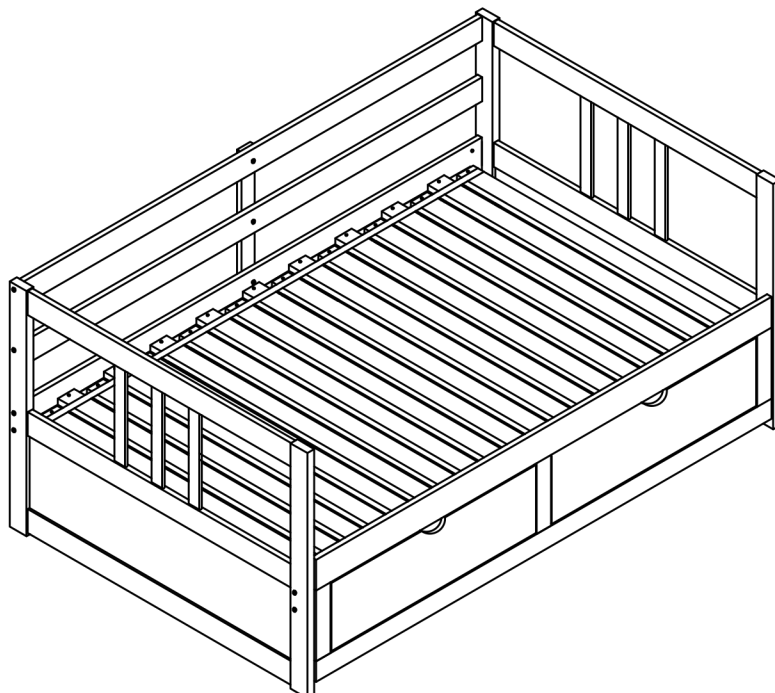

ASSEMBLY INSTRUCTIONS

17

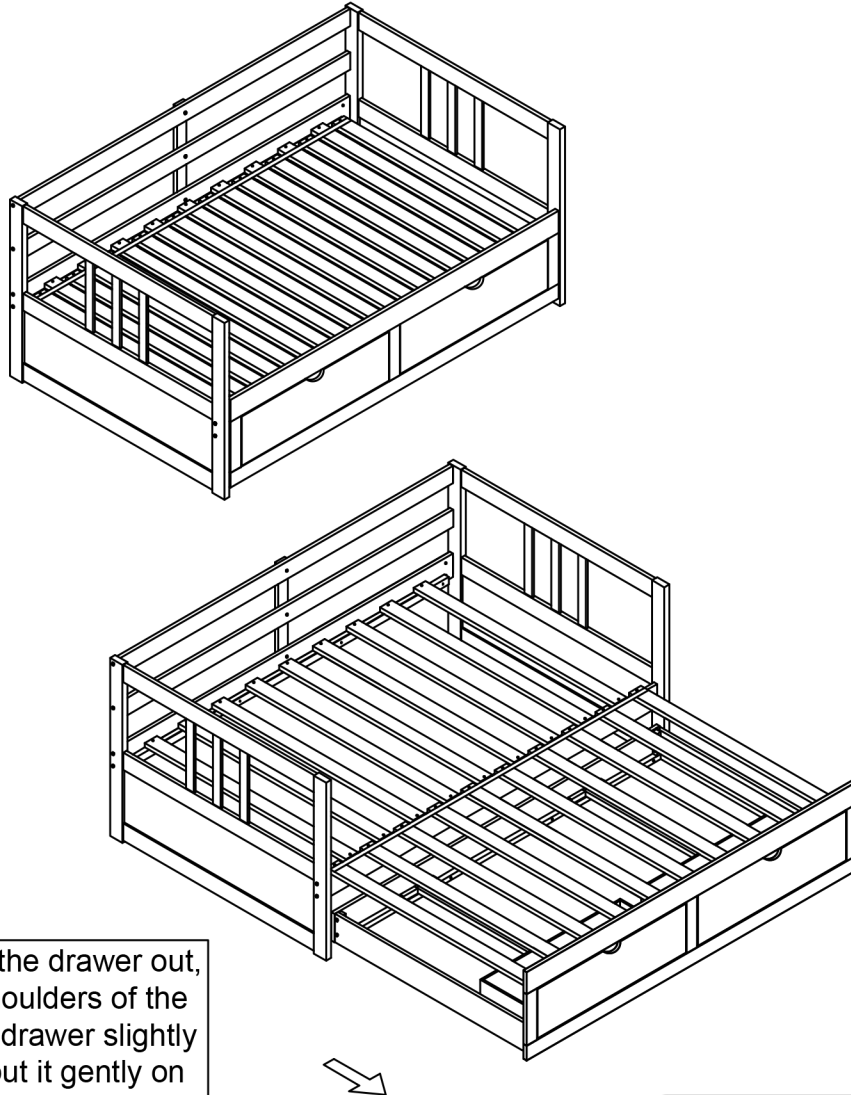

When we pull the drawer out, close to the shoulders of the bed, we lift the drawer slightly it all out, then put it gently on the floor .

ASSEMBLY COMPLETED



Please ensure the furniture rests on an even and flat surface. If the product wobbles or feels loose, double-check all bolts and/or screws are properly tightened and secured.

✓ Keep this handy!

Please retain this instruction manual and any order-related information for future reference.

✓ Lift, don't drag!

To avoid damage to product please always LIFT the product when transporting or adjusting the placement.