

Assembly Instructions for Dining Table

Remove protective materials and set parts on a flat, non-abrasive surface. Identify all parts packed in the carton against the parts list. Do not attempt to assemble the table if any parts are missing or damaged.

Parts List

A		1
B		1
C		4
D		2
E		6
F		12
G		8
H		12
I		12
J		1
K		1
L		1
M		6
N		8

Step 1

- A. Place Table Top (A) upside down on a non-abrasive surface to avoid scratches.
- B. Align Table Leg (C) or Center Support (D) into each tube. Add Bumper (E) to the underside of each piece (C, D).
- C. Secure Screw (M) through the aligned holes with Allen Wrench (K). Do not fully tighten screws.

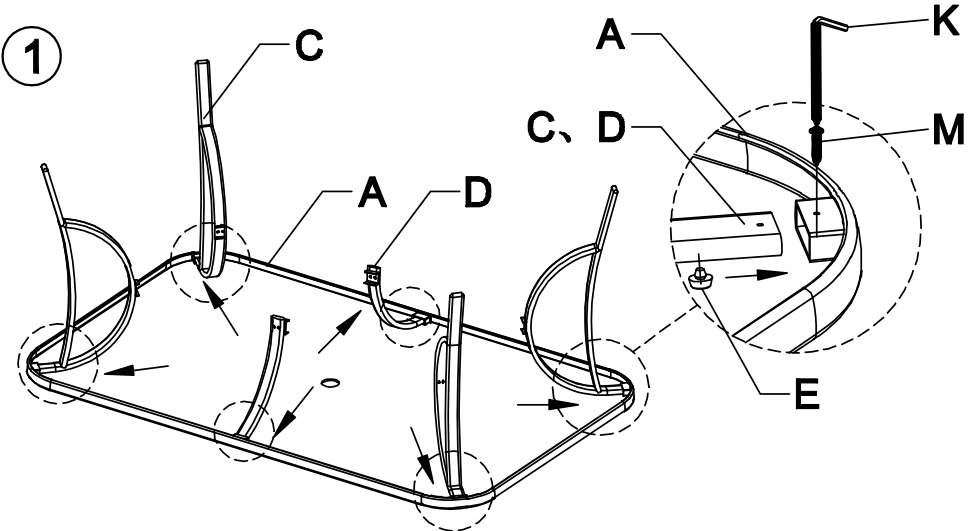

Step 2

- A. Align the Center Connector (B) within Legs (C) and Center Support (D).
- B. On each Leg (C), insert Bolt (F) through parts (C, B), Bracket (N) and secure against Nut (H) with Allen Wrench (K). Cover with Screw Cap (I).
- C. On each Center Support (D), insert Bolt (F) through parts (D, B), Washer (G) and secure against Nut (H) with Allen Wrench (K). Cover with Screw Cap (I).

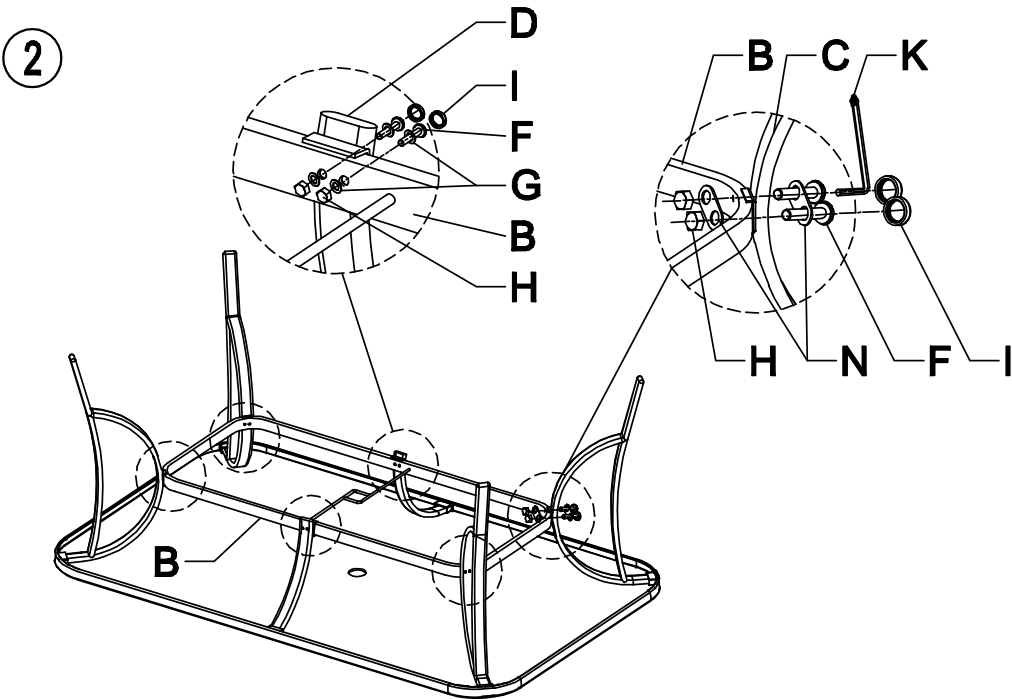

Step 3

With the help of another person, carefully turn the table upright. Tighten all Screws (M) from Step 1. Place the Hole Cover (J) into the center hole.

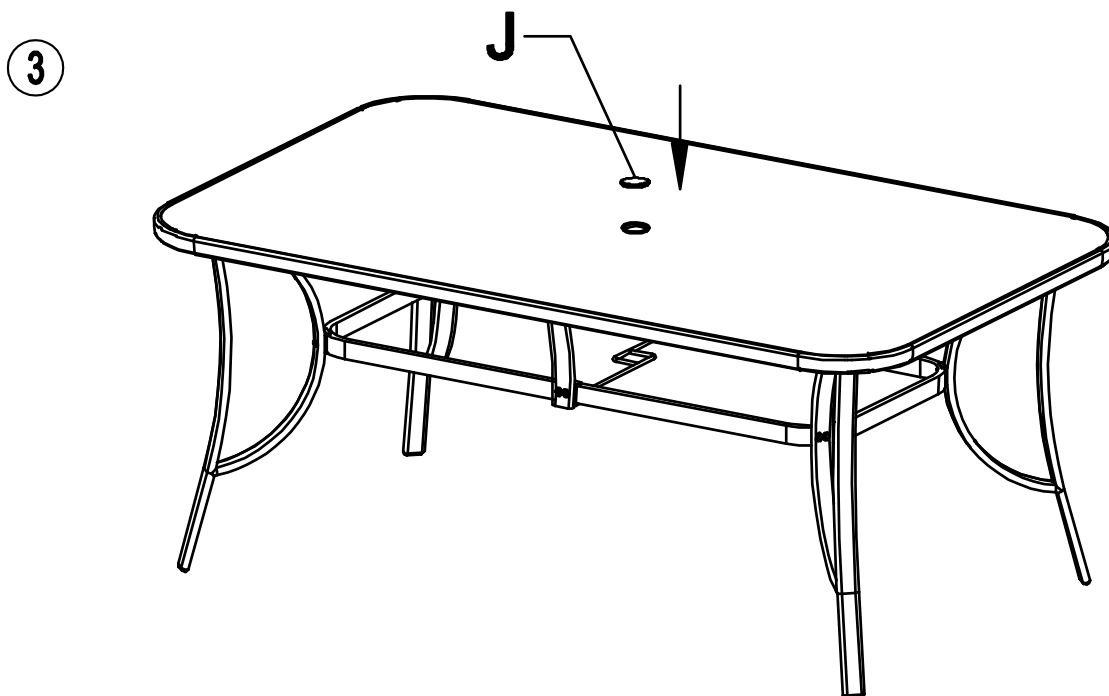

Your table is now ready to be used.

