

# **SETUP AND OPERATION GUIDE**

## ***360 Degree Power Swivel Recliner***



## TABLE OF CONTENTS

Important Safety Instructions	2
-------------------------------	---

### Assembly of Your Lift Chair or Recliner

Chair Assembly	3
Trouble Shooting	4
FCC Instructions	4
Customer Service	4

**Note:** When placing the furniture on non-carpeted flooring, it is recommended to use some type of floor protection such as an area rug or furniture pads under the chair glides. Area rugs and padding are not included with purchase.

**WARNING:** To avoid serious personal injury:

Carefully and strictly follow assembly instructions. Improper assembly of furniture can result in structural failure, instability of the product, or tip-over.

Monitor and carefully control the assembly components. These include small parts and hardware that may present a choking hazard to small children.

Assembled only by responsible adults and children should not be involved in the assembly process.

Where provided, wall mounting hardware should always be used as prescribed in these instructions to anchor furniture to walls. Proper use of the wall mounting hardware can significantly reduce the potential for furniture tip-over and crushing injuries.

# IMPORTANT SAFETY INSTRUCTIONS

READ ALL INSTRUCTIONS BEFORE USING.

WARNING: To reduce the risk of burns, fire, electric shock, or injury to persons:

1. DANGER: To reduce the risk of electric shock-Always unplug this furnishing from the electrical outlet before cleaning.
2. Unplug from outlet before putting on or taking off parts.
3. Close supervision is necessary when used by or near children, or disabled people.
4. Use this furnishing only for its intended use as described in these instructions.  
Do not use attachments not recommended by the manufacturer.
5. Never operate this furnishing if it has a damaged cord or plug, if it is not working properly, if it has been dropped or damaged, or dropped into water.
6. Keep the cord away from heated surfaces.
7. Never drop or insert any object into any opening.
8. Do not use outdoors. Just for household indoor use only.
9. To disconnect, turn all controls to the off position, then remove plug from outlet.
10. WARNING: Risk of injury - Keep children away from extended foot support.
11. WARNING: Risk of injury to Persons – do not use this furnishing to support video equipment such as televisions or computer monitors.

## SERVICING OF DOUBLE- INSULATED PRODUCTS.

In a double-insulated product, two systems of insulation are provided instead of grounding. No grounding. No grounding means is provided on a double-insulated product, nor is a means for grounding to be added to the product. Servicing a double-Insulated Product requires extreme care and knowledge of the system, and is to be done only by qualified service personnel. Replacement parts for a double-insulated product must be identical to the parts they replace.

**SAVE THESE INSTRUCTIONS.**

## CHAIR ASSEMBLY

### ATTACHING THE CHAIR BACK TO THE CHAIR BASE

Figure B

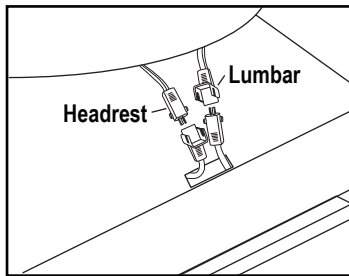

Figure A

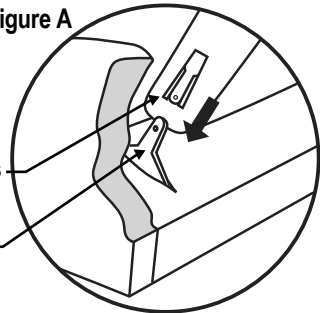

Figure C.1

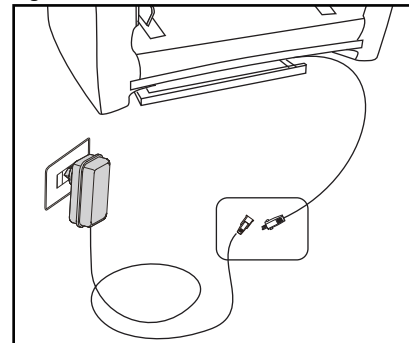
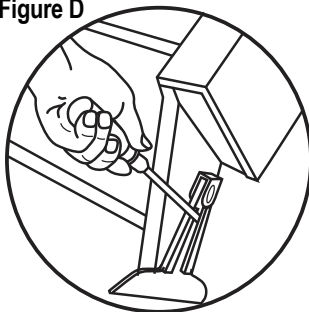

Figure D



Screwdriver required (not included)

Figure C.2

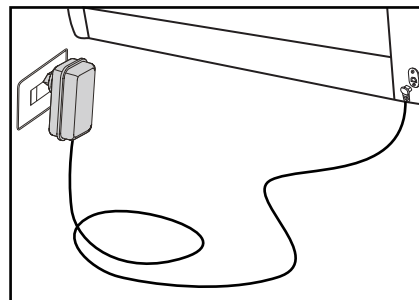
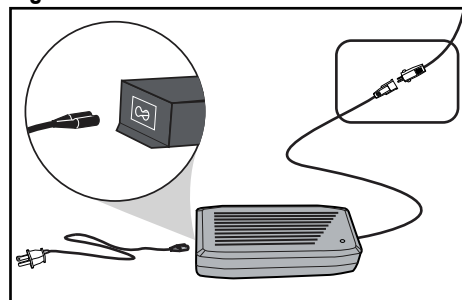

Figure C.3



Note: your unit may look different in appearance from the one shown in the illustrations on this instruction sheet.

**CAUTION:** PLEASE READ ALL INSTRUCTIONS CAREFULLY BEFORE STARTING ASSEMBLY PROCESS. IT IS RECOMMENDED TO USE TWO PEOPLE WHEN ASSEMBLING AND REMOVING THE INSIDE BACKS TO AND FROM THE BASE OF THE FURNITURE.

- STEP1: Slide inside back receivers onto the steel mechanism posts in the base of the chair. (Figure A)
- STEP2: Press both sides of the back firmly into place until the back automatically locks into track.
- STEP3: Connect the Headrest and Lumbar cable plugs (Figure B). Headrest-only models have only one set of cables. Connect the Air Massage, Power Supply, Heat and Vibrator cable plugs if available.
- STEP4: Connect the power cord (Figure C).
- STEP5: To remove the back from the base, use a screwdriver pressing outward on the black tab in the metal receivers on both sides of the chair back and lift the back from the base of the chair to release. (Figure D)

## TROUBLE SHOOTING

PROBLEM	POSSIBLE FACTORS	SOLUTIONS
Chair doesn't recline or lift	Transformer may not connected well	<ul style="list-style-type: none"><li>• Check the power supply has been correctly connected to socket</li><li>• Confirm the wire from chair to transformer is firmly connected</li></ul>
Headrest or Lumbar doesn't work	Headrest or lumbar motor may not connected well	<ul style="list-style-type: none"><li>• Check the headrest and lumbar motor has been correctly connected to socket</li></ul>
Headrest and lumbar work oppositely	Headrest and lumbar motor plug	<ul style="list-style-type: none"><li>• Check the headrest and lumbar motor has been correctly connected to socket</li></ul>
The side switch doesn't work	Side switch may not be connected well	<ul style="list-style-type: none"><li>• Check the side switch cord has been correctly connected to plug</li></ul>

## FCC INSTRUCTION

**CAUTION:** Changes or modifications not expressly approved by the party responsible for compliance could void the user's authority to operate the equipment.

**NOTE:** This equipment has been tested and found to comply with the limits for a Class B digital device, pursuant to Part 15 of the FCC Rules. These limits are designed to provide reasonable protection against harmful interference in a residential installation. This equipment generates, uses, and can radiate radio frequency energy and, if not installed and used in accordance with the instructions, may cause harmful interference to radio communications. However, there is no guarantee that interference will not occur in a particular installation. If this equipment does cause harmful interference to radio or television reception, which can be determined by turning the equipment off and on, the user is encouraged to try to correct the interference by one more of the following measures:

- Reorient or relocate the receiving antenna.
- Increase the distance between the equipment and receiver.
- Connect the equipment into an outlet on a circuit different from that to which the receiver is connected.
- Consult the dealer or an experienced radio/TV technician for help.

Product Protected By Following Patents:  
Patented Articulating Power Headrest & Lumbar  
US Patent: 10,736,423  
Patented 360° Power Swivel  
US Patent: 10,376,061



# **MOTO** **MOTION**

**FASHION. FORWARD. FURNITURE.**

## **Customer Service**

If you have any questions regarding the use of this unit or find that your unit need service, please contact your retailer.