

125-XX Comfort Series High-Back Multifunctional Fabric Swivel Task Chair

Parts Listing

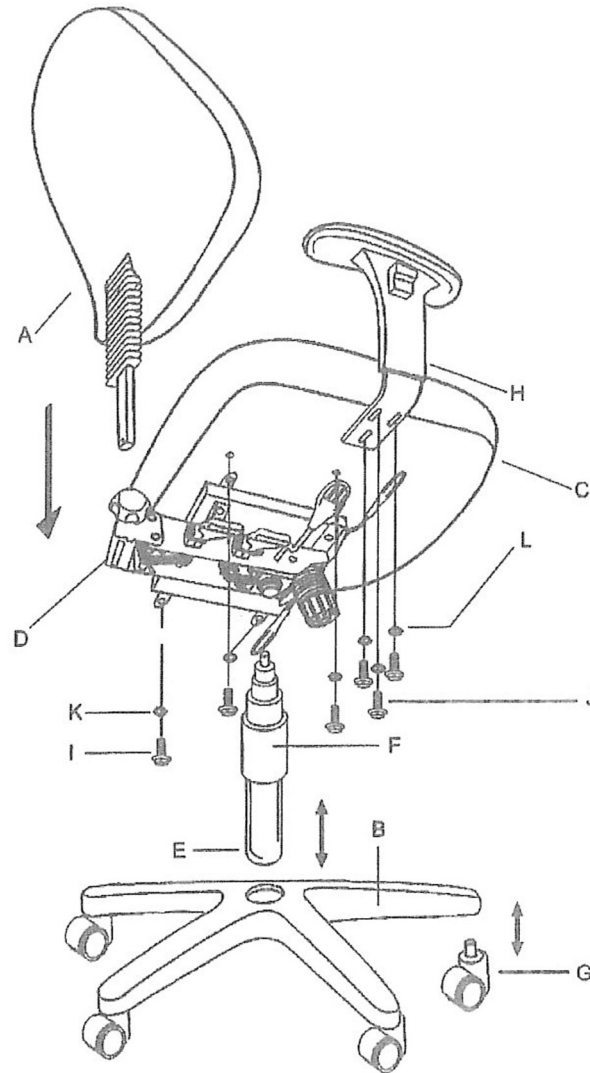
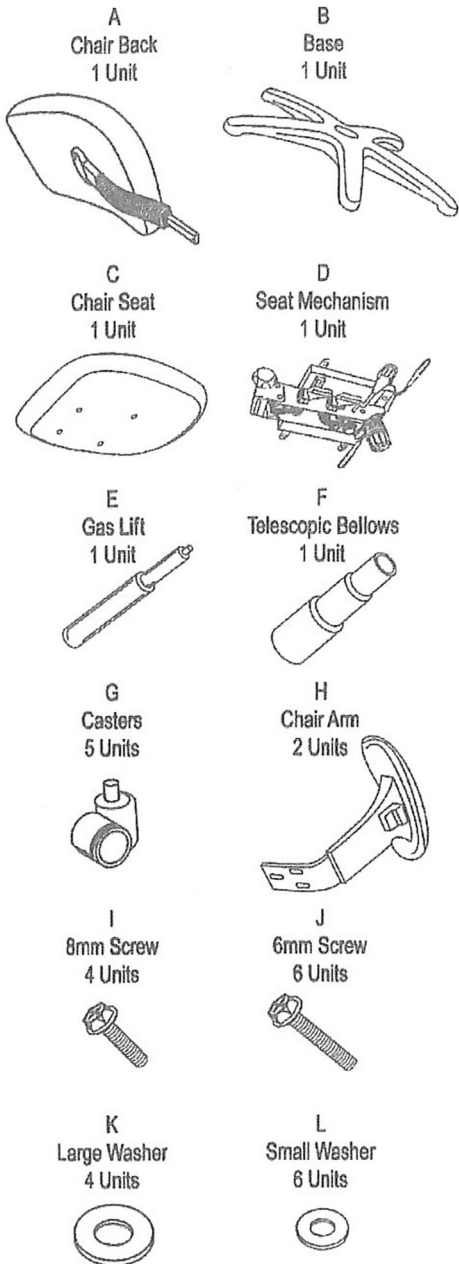

WEIGHT CAPACITY : 350 lbs.

Assembly Notes :

During assembly, hand tighten screw only when all screws are in place, you may then tighten all screws completely.

CAUTION :

1. Do not use this chair as a step ladder.
2. Check for loose screws and tighten them every 6 months.



Assembly Instructions

Tools needed : Phillips Head Screwdriver
Please read all instructions before assembly

- Step 1 : Insert Casters (G) into Base (B).
- Step 2 : Insert Gas lift (E) into Base (B).
- Step 3 : Cover Gas Lift (E) with 3 piece Telescopic Bellows (F).
- Step 4 : Place Chair Seat (C) on a level, non-abrasive surface and align pre-drilled holes in Seat Mechanism (D), with holes in Chair Seat.
- Step 5 : Place four Large Washers (K) onto four 8 mm Screws (I) and insert through the holes in the Seat Mechanism (D), and into the Chair Seat (C). Tighten with screwdriver.
- Step 6 : Attach adjustable arms (H) using three Small Washers (L) and six 6 mm Screws (J). At this stage, you have some adjustments to how close to the side of the seat the arms should be. Tighten firmly.
- Step 7 : Carefully place Chair Seat (C) with attached Seat Mechanism (D) onto the Gas Lift (E), aligning the holes in the Seat Mechanism with the Gas Lift. Press down on Chair Seat to secure onto Base.
- Step 8 : Slide Chair Back (A) with attached back support bar into the slot on Seat Mechanism (D).
- Step 9 : Hand tighten tension knob on Seat Mechanism (D) until the the Chair Back (A) is properly secured.
- Step 10 : Carefully sit on chair to make sure the Gas Lift (E) is properly inserted into the Base (B).

REGENCY | RGS
FURNITURE

Missing Parts? Assembly Questions?

Call us at 1-866-816-9822 or email help@regencyof.com for immediate assistance.

2375 Romig Road
Akron, Ohio 44320
United States

Toll Free: 1-866-816-9822
Office: 330-848-3700
Fax: 1-330-848-6260