

# **dji** RC PRO 2

## User Manual

v1.0 2025.05

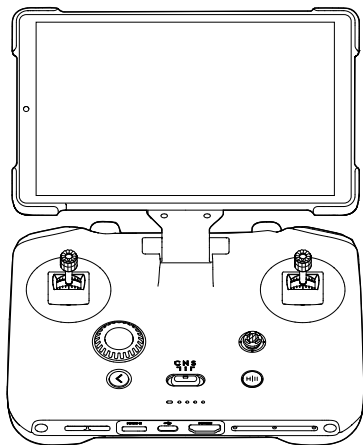



This document is copyrighted by DJI with all rights reserved. Unless otherwise authorized by DJI, you are not eligible to use or allow others to use the document or any part of the document by reproducing, transferring or selling the document. Only refer to this document and the content thereof as instructions to operate DJI products. The document should not be used for other purposes.

In the event of divergence among different versions, the English version shall prevail.

### **Searching for Keywords**

Search for keywords such as “battery” and “install” to find a topic. If you are using Adobe Acrobat Reader to read this document, press Ctrl+F on Windows or Command+F on Mac to begin a search.

### **Navigating to a Topic**

View a complete list of topics in the table of contents. Click on a topic to navigate to that section.

### **Printing this Document**

This document supports high resolution printing.

# Using this Manual

## Legend

⚠ Important

💡 Hints and Tips

📖 Reference

## Read Before Use

DJI™ provides you with tutorial videos and the following documents:

1. *Safety Guidelines*
2. *Quick Start Guide*
3. *User Manual*

It is recommended to watch all the tutorial videos and read the *Safety Guidelines* before using for the first time. Make sure to review the *Quick Start Guide* before using for the first time and refer to this *User Manual* for more information.

## Video Tutorials

Go to the address below or scan the QR code to watch the tutorial videos, which demonstrate how to use the product safely:



<https://www.dji.com/rc-pro-2/video>

# Contents

<b>Using this Manual</b>	<b>3</b>
Legend	3
Read Before Use	3
Video Tutorials	3
<b>1 Preparing the Remote Controller</b>	<b>5</b>
1.1 Powering On/Off	5
1.2 Activating the Remote Controller	6
1.3 Linking the Remote Controller	6
1.4 Charging the Battery	6
<b>2 Overview</b>	<b>8</b>
<b>3 Using the Remote Controller</b>	<b>9</b>
3.1 Remote Controller Operation	9
DJI Simulator	9
Controlling the Aircraft	9
Controlling the Gimbal and Camera	10
Flight Mode Switch	10
Flight Pause/RTH Button	11
Customizable Buttons	11
Dial	12
3.2 Sleep Mode	12
3.3 Operating the Touchscreen	12
3.4 Combination Buttons	13
3.5 Remote Controller LEDs	14
Remote Controller LEDs	14
Status LED	14
Battery Level LEDs	14
3.6 Remote Controller Alert	15
3.7 Recording Audio via App	15
3.8 Optimal Transmission Zone	15
3.9 HDMI Settings	16
<b>4 Appendix</b>	<b>17</b>
4.1 Specifications	17
4.2 Compatibility	17
4.3 Firmware Update	17
4.4 Aftersales Information	18

# 1 Preparing the Remote Controller

## 1.1 Powering On/Off

Unfold the antennas downward.

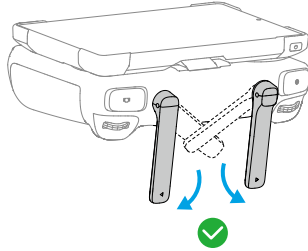

Extend the arm to power on.

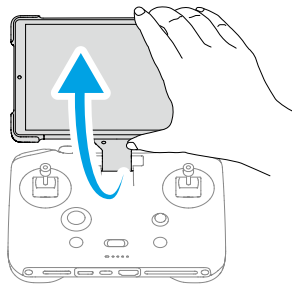

Press the power button once to check the current battery level.

Press, then press and hold to power the remote controller on or off.

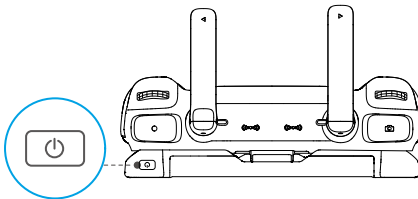

## 1.2 Activating the Remote Controller

The remote controller needs to be activated before using for the first time. Make sure the remote controller can connect to the internet during activation. Follow the steps below to activate the remote controller.

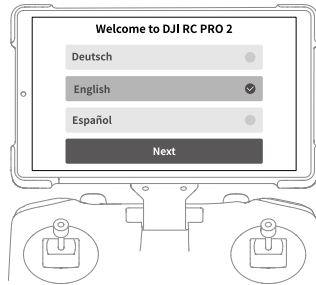

## 1.3 Linking the Remote Controller

The remote controller is already linked to the aircraft when purchased together as a combo. Otherwise, follow the steps below to link the remote controller and the aircraft after activation.

1. Power on the aircraft and the remote controller.
2. Launch DJI Fly.
3. In camera view, tap \*\*\* > **Control** > **Connect to Aircraft**. During linking, the status LED of the remote controller blinks blue and the remote controller beeps.
4. Press and hold the power button of the aircraft for more than four seconds. The aircraft beeps, and its battery level LEDs blink in sequence to indicate it is ready to link. The remote controller will beep twice, and its status LED will turn solid green to indicate linking is successful.



- Make sure the remote controller is within 0.5 m of the aircraft during linking.
  - The remote controller will automatically unlink from an aircraft if a new remote controller is linked to the same aircraft.
- 

## 1.4 Charging the Battery

Connect the charger to the USB-C port on the remote controller.

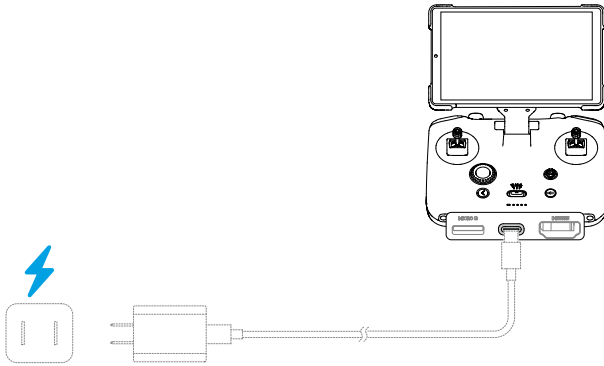

- 
- ⚠ • Fully charge the remote controller before each flight. The remote controller sounds an alert when the battery level is low.
  - Fully charge the battery at least once every three months to maintain the battery's health.
-

## 2 Overview

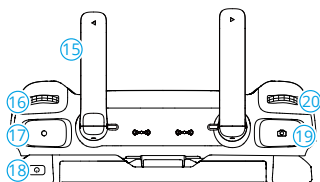
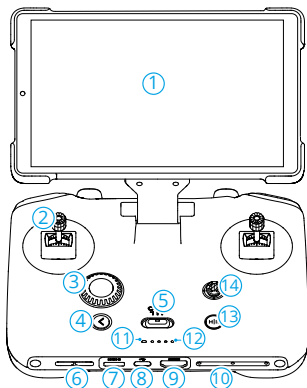

1. Touchscreen
2. Control Sticks
3. Dial
4. Back Button
5. Flight Mode Switch
6. Speaker
7. microSD Card Slot
8. USB-C Port
9. HDMI Port
10. Microphone
11. Status LED
12. Battery Level LEDs
13. Flight Pause/Return to Home (RTH) Button
14. 5D Button

15. Antennas
16. Gimbal Dial
17. Record Button
18. Power Button
19. Focus/Shutter Button
20. Camera Settings Dial
21. Customizable C2 Button
22. Customizable C1 Button

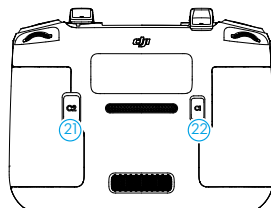

## 3 Using the Remote Controller

### 3.1 Remote Controller Operation

#### DJI Simulator

Before your first flight, practice flying using the DJI Simulator for flight safety. To access DJI Simulator, click  on the Home page of DJI Fly.

#### Controlling the Aircraft

The control sticks of the remote controller can be used to control the aircraft movements. The control sticks can be operated in Mode 1, Mode 2, or Mode 3, as shown below.

The default control mode of the remote controller is Mode 2. In this manual, Mode 2 is used as an example to illustrate how to use the control sticks. The more the stick is pushed away from the center, the faster the aircraft moves.

##### Mode 1

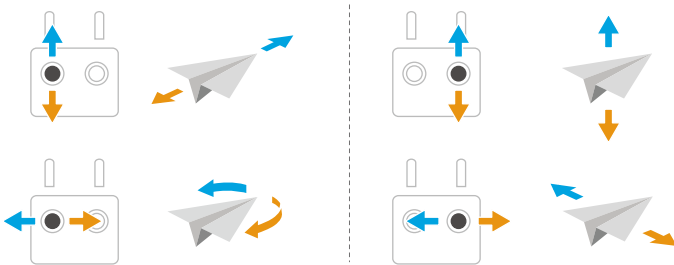

##### Mode 2

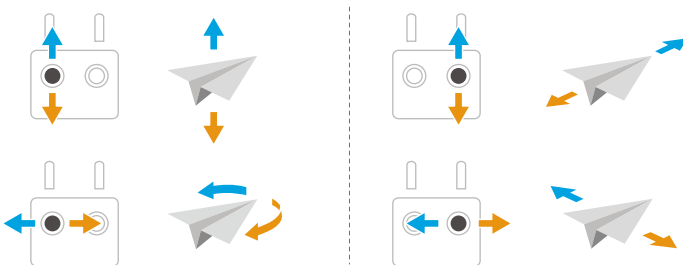

### Mode 3

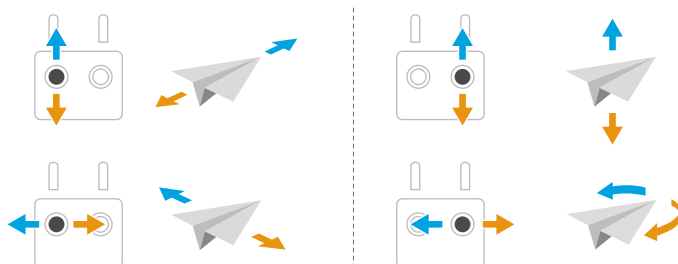

## Controlling the Gimbal and Camera

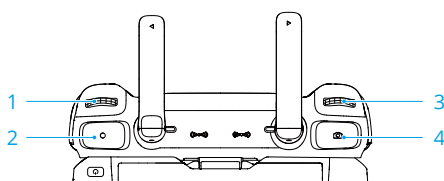

1. **Gimbal Dial:** Control the tilt of the gimbal.
2. **Record Button:** Press once to start or stop recording.
3. **Camera Control Dial:** Use to adjust the zoom by default. The dial function can be set to adjust the focal length, EV, shutter speed, and ISO.
4. **Focus/Shutter Button:** Press halfway down to auto-focus and press all the way down to take a photo.

- 
- If the aircraft supports both horizontal and vertical shooting, rotate the screen for a quick switch.
  - If the aircraft supports infinity gimbal feature, the camera control dial can be set to control the gimbal roll.
- 

## Flight Mode Switch

Toggle the switch to select the desired flight mode.

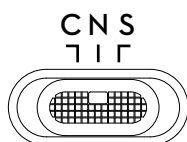

Position	Flight Mode
C	Cine Mode
N	Normal Mode
S	Sport Mode

## Flight Pause/RTH Button

Press once to make the aircraft brake and hover in place.

Press and hold the button until the remote controller beeps and starts RTH. The aircraft will return to the last recorded Home Point. Press the button again to cancel RTH and regain control of the aircraft.

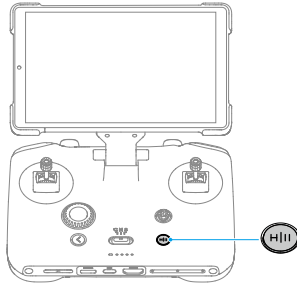

## Customizable Buttons

To view and set the button function, go to camera view in DJI Fly, and tap \*\*\* > Control > Button Customization.

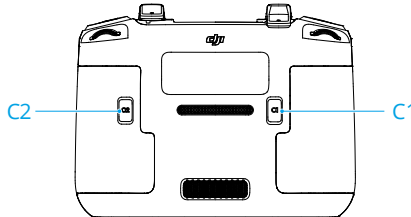

## Dial

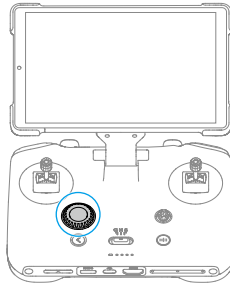

When the camera is set to AUTO mode, rotate the dial to adjust the EV value.

When the camera is set to PRO mode, press the dial to switch camera settings, and rotate to adjust parameters.

In the album, rotate the dial to move the selection box. Press the dial to preview the images or videos. Press and hold the dial to select multiple items.

### 3.2 Sleep Mode

Fold the arm or press the power button to turn off the screen. The remote controller will enter sleep mode after the screen is off for a certain period. In sleep mode, the remote controller will disconnect from the aircraft. To wake up the remote controller and restore the connection, extend the arm or press the power button. If not awakened within a certain period, the remote controller will automatically power off.

Go to Settings > Display to adjust the timeout settings.

### 3.3 Operating the Touchscreen

---

 • Note that the touchscreen is not waterproof. Operate with caution.

---

## Screen Gestures

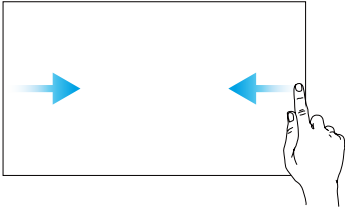

**Back:** Slide from the left or right to the center of the screen to return to the previous screen.

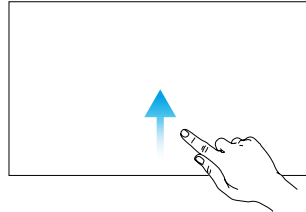

**Return to DJI Fly :** Slide up from the bottom of the screen to return to DJI Fly.

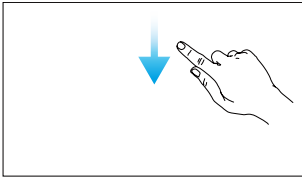

**Open the status bar:** Slide down from the top of the screen to open the status bar when in DJI Fly. The status bar displays the time, Wi-Fi signal, battery level of the remote controller, etc.

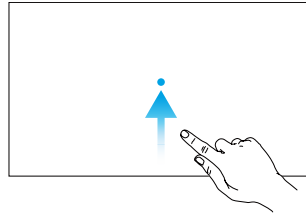

**Switch between opened apps:** Slide up from the bottom of the screen and hold to access recently opened apps when not on the home screen.

## 3.4 Combination Buttons

Some frequently used features can be activated by using combination buttons. To use combination buttons, press and hold the back button and operate the other button in the combination.

Combination Operation	Function
Back Button + Left Dial	Adjust Brightness
Back Button + Right Dial	Adjust Volume
Back Button + Record Button	Record Screen
Back Button + Shutter Button	Screenshot
Back Button + 5D Button	Toggle up - Home; Toggle down - Shortcut settings; Toggle left - Recently opened apps

## 3.5 Remote Controller LEDs

### Remote Controller LEDs

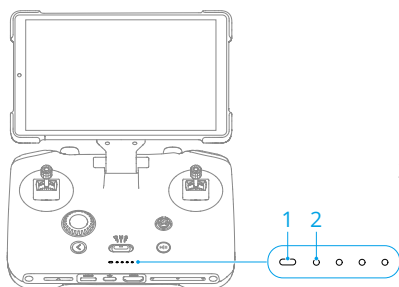

1. Status LED
2. Battery Level LEDs

### Status LED

Blinking Pattern	Descriptions
— Solid red	Disconnected from the aircraft.
..... Blinking red	The battery level of the aircraft is low.
..... Solid green	Connected with the aircraft.
— Pulsed blue	The remote controller is in sleep mode.
..... Blinking blue	The remote controller is linking to an aircraft.
— Solid yellow	Firmware update failed.
— Solid blue	Firmware update successful.
..... Blinking yellow	The battery level of the remote controller is low.
..... Blinking cyan	Control sticks not centered.

### Battery Level LEDs

Blinking Pattern	Battery Level
	76-100%
	51-75%
	26-50%
	0-25%

## 3.6 Remote Controller Alert



The remote controller beeps to indicate an error or warning. Pay attention when prompts appear on the touchscreen or in DJI Fly.

Slide down from the top of the screen and select Mute to disable all alerts, or slide the volume bar to 0 to disable some alerts.

The remote controller sounds an alert during RTH, which cannot be cancelled. The remote controller sounds an alert when the battery level of the remote controller is low. A low battery level alert can be cancelled by pressing the power button. When the battery level is critically low, the alert cannot be cancelled.

## 3.7 Recording Audio via App

In the camera view of the app, tap **\*\*\* > Camera** to enable app recording. Audio will be recorded using the built-in microphone or by a connected DJI Mic series microphone while the aircraft is recording a video. The microphone icon will be displayed in liveview.

- 
-  • DO NOT turn off the screen or switch to other apps during recording.
- 
-  • Audio recording can only be enabled or disabled before recording.
  - When viewing or downloading the videos in the Album view in DJI Fly, the audio recorded using the audio recording function will be automatically merged into the video file.
- 

## 3.8 Optimal Transmission Zone

The signal between the aircraft and the remote controller is most reliable when the antennas are positioned in relation to the aircraft as illustrated below. If the signal is weak, adjust the remote controller orientation, or fly the aircraft closer to the remote controller.

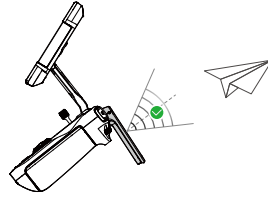
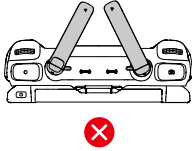
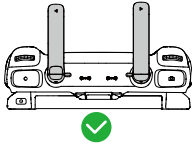

- 
- ⚠ • DO NOT use other wireless devices operating at the same frequency as the remote controller. Otherwise, the remote controller will experience interference.
  - A prompt will be displayed in DJI Fly if the transmission signal is weak during flight. Adjust the remote controller orientation according to the attitude indicator display to make sure that the aircraft is in the optimal transmission range.
- 

### 3.9 HDMI Settings

The touchscreen can be shared to a display after connecting the HDMI port of the remote controller.

The resolution can be set by entering  > Display > HDMI.

## 4 Appendix

### 4.1 Specifications

Visit the following website for specifications.

<https://www.dji.com/rc-pro-2/specs>

### 4.2 Compatibility

Visit the following website to get the information on compatible products.

<https://www.dji.com/rc-pro-2/faq>

### 4.3 Firmware Update

Use DJI Fly or DJI Assistant 2 (Consumer Drones Series) to update the aircraft and the remote controller firmware.

#### Using DJI Fly

When the aircraft is connected to the remote controller, run DJI Fly, and you will be notified if a new firmware update is available. Follow the on-screen instructions for update. Note that you cannot update the firmware if the remote controller is not linked to the aircraft. An internet connection is required.

#### Using DJI Assistant 2 (Consumer Drones Series)

Use DJI Assistant 2 (Consumer Drones Series) to update the aircraft and the remote controller separately.

1. Power on the device. Connect the device to a computer with a USB-C cable.
2. Launch DJI Assistant 2 (Consumer Drones Series) and log in with your DJI account.
3. Select the device and click **Firmware Update** on the left side of the screen.
4. Select the firmware version.
5. Wait for the firmware to download. The firmware update will start automatically. Wait for the firmware update to complete.



- The battery firmware is included in the aircraft firmware. Be sure to update all batteries.
- Make sure to follow all the steps to update the firmware, otherwise the update may fail.

- Make sure the computer is connected to the internet during the update.
  - DO NOT unplug the USB-C cable during an update.
  - The firmware update will take approximately 10 minutes. During the update process, it is normal for the gimbal to go limp, the aircraft status indicators to blink, and the aircraft to reboot. Wait patiently for the update to complete.
- 

Visit the following link and refer to the *Release Notes* for firmware update information:

<https://www.dji.com/rc-pro-2/downloads>

## 4.4 Aftersales Information

Visit <https://www.dji.com/support> to learn more about aftersales service policies, repair services, and support.



Contact  
DJI SUPPORT



The terms HDMI, HDMI High-Definition Multimedia Interface, HDMI trade dress and the HDMI Logos are trademarks or registered trademarks of HDMI Licensing Administrator, Inc.

This content is subject to change without notice.  
Download the latest version from



<https://www.dji.com/rc-pro-2/downloads>

If you have any questions about this document, please contact DJI by sending a message to [DocSupport@dji.com](mailto:DocSupport@dji.com).

DJI is a trademark of DJI.

Copyright © 2025 DJI All Rights Reserved.